



For 4 way cassette

Accessories

Bolt(M5XL35 MACHINE) (4)	Installation manual (1)
	

※ If the supplied bolt is lost, you may purchase M5 machine bolt (with length of the thread more than 20mm long) and a circular washer from any retail hardware store to replace the lost bolt.

1. Open the electrical component box cover.

- ▶ After untightening the screws, slide the electrical component box cover in the direction of the arrow as shown in the figure and pull it down.

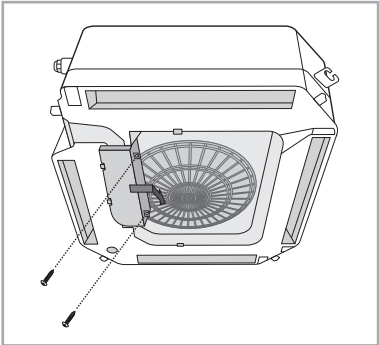

2. Pull both hooks in the direction of carved arrows and take the grille to open.

- ▶ Hooks are located below the Samsung logo on the grille.

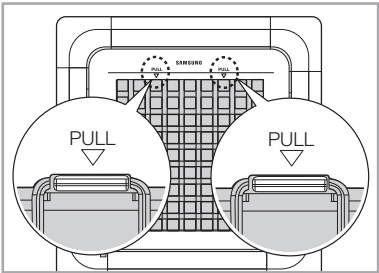

3. Install the panel using 2 hooks on the both sides of the indoor unit.

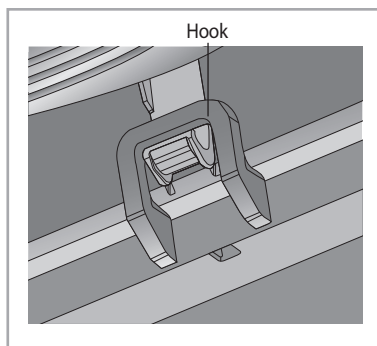

4. Detach the 4 corners of the panel. Use two grooves on the each corner of the panels when pulling them out.

- ▶ Handle the corner with digital display gently, since there are electrical cables connected to that corner.
- ▶ Each corner portion of the panel is easy for you to adjust the height, but a special tool should be used. Don't use directly hand.

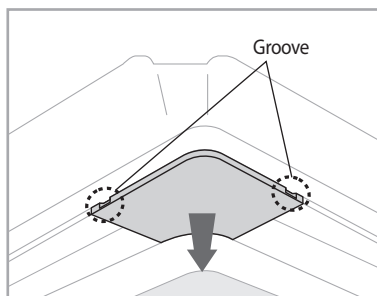

5. Fix the bolt to the panel.

- 1) Fix 4 bolts to the panel temporarily.
- 2) Fix them tightly not to make a gap between the panel and the ceiling.



- ▶ Adjustment of the indoor unit height from the holes in the corner of panel is possible.
- ▶ Pipe connecting area is not allowed to adjustment of the indoor unit height.

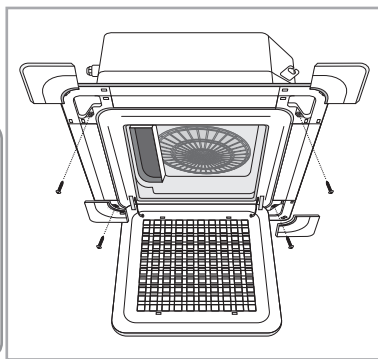
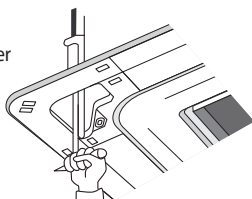

6. Connect 3 cables between the indoor unit and the panel.

- ▶ Make sure you check the number of pins on the two white terminal before connecting the cables.

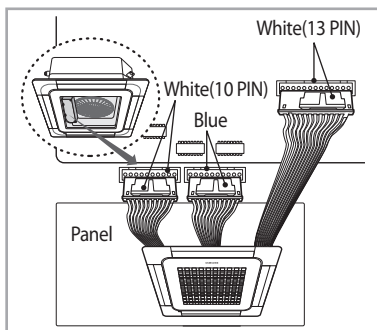

For 4 way cassette

7. Close the electrical component box cover and tighten the screws.

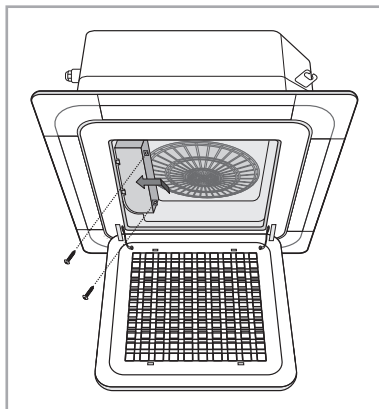

8. Attach and close the front grille.

- Make sure the hooks on the rear side of grille fits properly into the grooves on panel (1) and then push the panel to close (2).

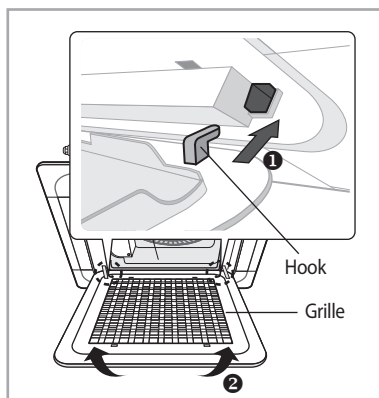

9. Check out that the panel is fixed to the indoor unit.

- Fix screws tightly between the panel and the surface of the ceiling. If the panel is installed incorrectly, air may leak.
- Do not block any discharge vents in the panel.

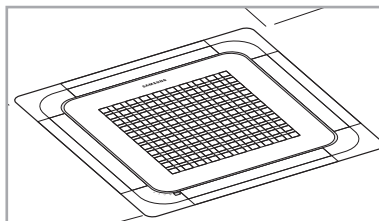

- If the angle on the air flow blades has been changed by user due to opening the front grille for installation or maintenance, you must turn off the circuit breaker and turn it on again before using the air conditioner. Otherwise, angles of the each angle can be different or some of the blade may not close when the product is off.

Memo



"EEE Yönetmeliğine Uygundur"
"This EEE is compliant with RoHS"

Panel (Mini-4 way cassette type)

Air Conditioner installation manual

**Planet
First**

100%
Recycled Paper

This manual is made with 100% recycled paper.



imagine the possibilities

Thank you for purchasing this Samsung product.
To receive more complete service, please
register your product at
www.samsung.com/register