



Smart AC application  
MIM-H03N

# Multi Wi-Fi kit user & installation manual

imagine the possibilities

Thank you for purchasing this Samsung  
product.

**SAMSUNG**





This product is the Smart Air conditioner which supports Samsung Smart Home Service.

## Contents

Safety precautions .....	3
Check before installing Wi-Fi kit .....	4
Parts .....	4
Exterior dimension .....	4
How to install Wi-Fi kit .....	5
Wi-Fi kit installation .....	5
Setting individual usage of indoor unit .....	12
Checking the Wi-Fi kit .....	14
Initializing user data .....	15
Updating the Wi-Fi kit by SD card .....	15
Setting the network .....	16
Specification of wired/wireless router for Samsung Smart Air conditioner .....	16
Starting Samsung Smart Home App .....	17
Downloading Samsung Smart Home App .....	17
Running the Samsung Smart Home App .....	18
Registering the product .....	19
Description of screens and main functions .....	21
Starting System Air conditioner App .....	24
Smart home device control .....	24
Indoor unit/ group list screen .....	25
Control screen .....	27
Setting the group .....	29
Editing the indoor unit list .....	32
Schedule .....	33
Energy monitor .....	35
Settings .....	36
Updating the Wi-Fi kit .....	37
Troubleshooting .....	38
Open Source Announcement .....	39
Declaration of Conformity .....	40





# Safety precautions

This installation manual explains how to install a Wi-Fi kit to an indoor unit of Samsung system air conditioners.

Read the installation manual thoroughly before installing the Wi-Fi kit.

(Refer to the appropriate manual for installing product or other optional parts.)



## WARNING

Hazards or unsafe practices that may result in **severe personal injury or death**.



## CAUTION

Hazards or unsafe practices that may result in **minor personal injury or property damage**.

### WARNING

- ▶ Contact service center for installation.
  - There is a risk of product malfunction, water leakage, electric shock or fire.
- ▶ Install the Wi-Fi kit securely in a place that can withstand the weight of the product.
  - If the installation location is not strong enough, Wi-Fi kit may fall and be damaged.
- ▶ Connect the power with rated voltage when installing.
  - If not, there is risk of fire or damage to the Wi-Fi kit.
- ▶ Do not attempt to move or re-install the Wi-Fi kit that is already installed.
  - There is risk of electric shock and fire.
- ▶ Do not attempt to modify or repair the Wi-Fi kit on your own.
  - There is potential risk of product damage, electric shock or fire. When repair is needed, consult service center.
- ▶ Check if the installation was done properly according to the installation manual.
  - If the Wi-Fi kit is installed incorrectly, there is risk of electric shock or fire.
- ▶ Make sure that all wiring work is done by a qualified person complying with regional standards and instructions in this manual.
  - If the installation is done by unqualified person, there is risk of product malfunction, electric shock or fire caused by incorrect installation.
- ▶ Contact the service center if you need to dispose the Wi-Fi kit.

### CAUTION





- ▶ Do not install the product in a place where it is or might be exposed to inflammable gas leakage.
  - There is risk of fire or explosion.
- ▶ Do not install the product in a place where it will be exposed to oil or vapor etc.
  - If the product is used in a place where it is exposed to oil, vapor or sulphur dioxide, parts of the product may get damaged or product may function abnormally.
- ▶ Make sure that water does not get into the Wi-Fi kit.
  - There is risk of electric shock and fire.
- ▶ Make sure there is no tension to the cable during installation.
  - Cable may get cut and cause fire.
- ▶ Install the product in a place with temperature between 0 °C~39 °C (32 °F~102 °F) with no direct sunlight.
  - If not, there is risk of electric shock or abnormal operation.
- ▶ Do not install the product in a place where special spray or acid/alkali solution is used.
  - There is risk of electric shock or abnormal operation.
- ▶ Do not press the button with sharp object.
  - There is risk of electric shock or damaging the parts.
- ▶ Do not connect the power cable to the communication cable terminal.
  - There is risk of fire.
- ▶ When installing the product in hospitals or other places, make sure that the product does not interrupt with other products.
  - Abnormal operation may occur.



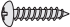

# Check before installing Wi-Fi kit

## Parts

Assy Wi-Fi kit	Cable tie (2)	Cable clamp (3)	M4×16 screw (5)
			
User & Installation manual	U- terminal (6)		
			



- Wi-Fi kit should be installed by a certified installer.
- Before installing a Wi-Fi kit, you should check whether the power of the kit is turned off.
- The wire of Wi-Fi kit should be installed in accordance with electric wiring regulation and should also be installed inside the wall so that it cannot be touched by users.

## Exterior dimension

Unit : mm (inches)

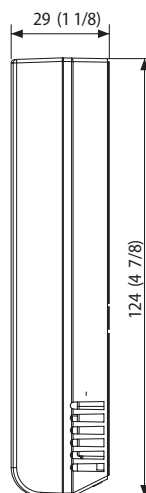
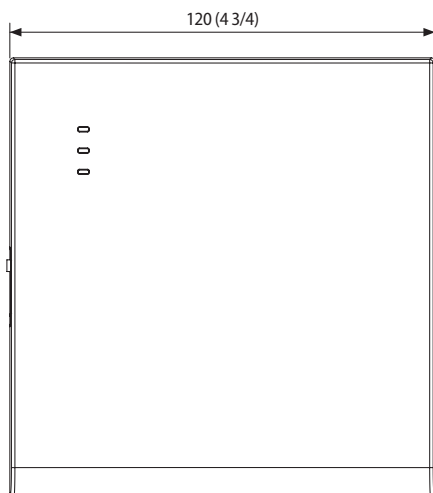





# How to install Wi-Fi kit

## Wi-Fi kit installation



- For smooth operation, install the Wi-Fi kit and the wireless router in open space with no obstacles between them. Operation may not be possible if the distance between the Wi-Fi kit and the wireless router is too far or if there's any obstacle between them.

- After pushing the two hooks on the bottom of the Wi-Fi kit at the same time, lift the front cover up and then detach it from the rear cover.

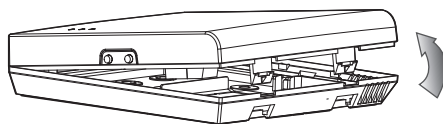
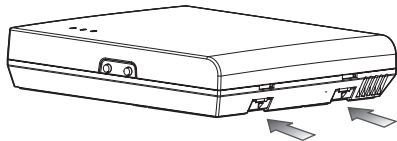

- \* Push the two hooks at the same time.



- It might be easier to disassemble the Wi-Fi kit if you put a flat-head screw driver into the square hole above the fixing hook.

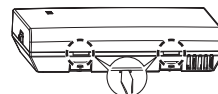

- Place the power wire and communication wire through openings in the rear cover.

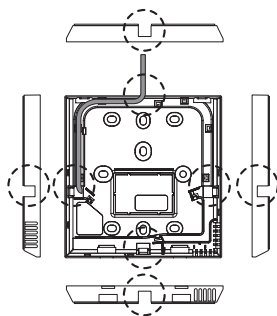

<When the cover is not recessed>

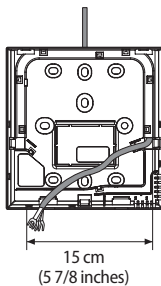

15 cm  
(5 7/8 inches)

The opening can be cut and removed if you need more space.

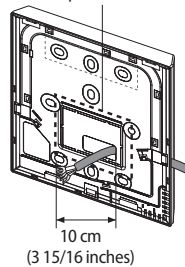

<When the cover is recessed>



## How to install Wi-Fi kit

- Use two or more screws to fix the rear cover of the Wi-Fi kit to a wall. Then, connect the power cable (V1, V2) and the communication cable to the terminals on the back of the front cover in appropriate length.
- When connecting the V1 and V2, tighten the screws for the terminal block (CNS) with a tightening torque of  $5 \pm 2$  N-cm. Size of the screw is M3 x 6.



NOTE

- Maximum number of indoor unit installation that can be connected to Wi-Fi kit is 16.
- One Wi-Fi kit can be registered with maximum 5 users.
  - If you register more than 5 users to single Wi-Fi kit, its operation may become slower.
- Each account (one mobile phone) can be registered with maximum 4 Wi-Fi kits.

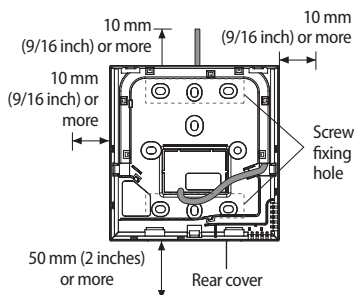

\* Before fixing the rear cover, allow 10mm or more space for upper, left, and right sides and 50mm space for bottom side.

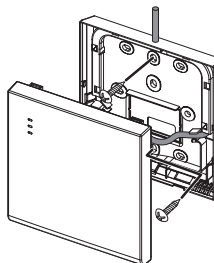

\* Fix the screws in the provided screw holes.

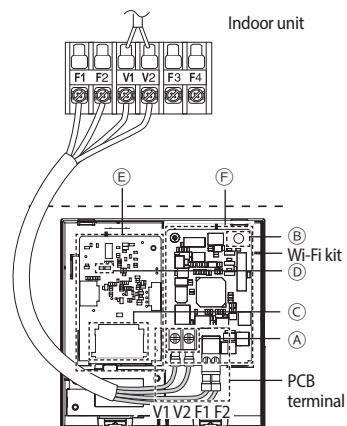

\* Do not tighten the PCB terminal with too much force.

Item	Contents
(A)	Power/communication connection terminal
(B)	Tracknig/Initializing button
(C)	SD Card Slot
(D)	LED
(E)	Network PBA
(F)	Interface module PBA





## 5. Reassemble the Wi-Fi kit.



NOTE

- Put the front cover of the kit into the upper grooves first and then fit it as shown in the picture. After assembling the Wi-Fi kit, please check if there is any gap because of the connection cable between front cover and rear cover.



### 1) When connected to a single outdoor unit (F1-F2)

#### \* Connection diagram of Wi-Fi kit

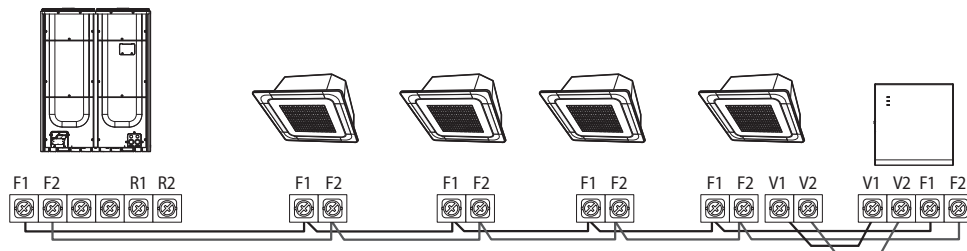

< Connecting the Wi-Fi kit to a multi type product >

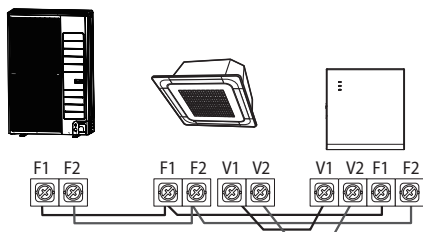

< Connecting the Wi-Fi kit to a single type product >

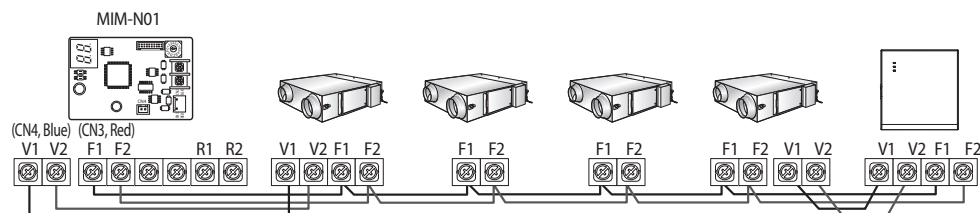

< Connecting the Wi-Fi kit to a ERV product >

ENGLISH



## How to install Wi-Fi kit

2) When connected to two or more outdoor units (R1-R2)

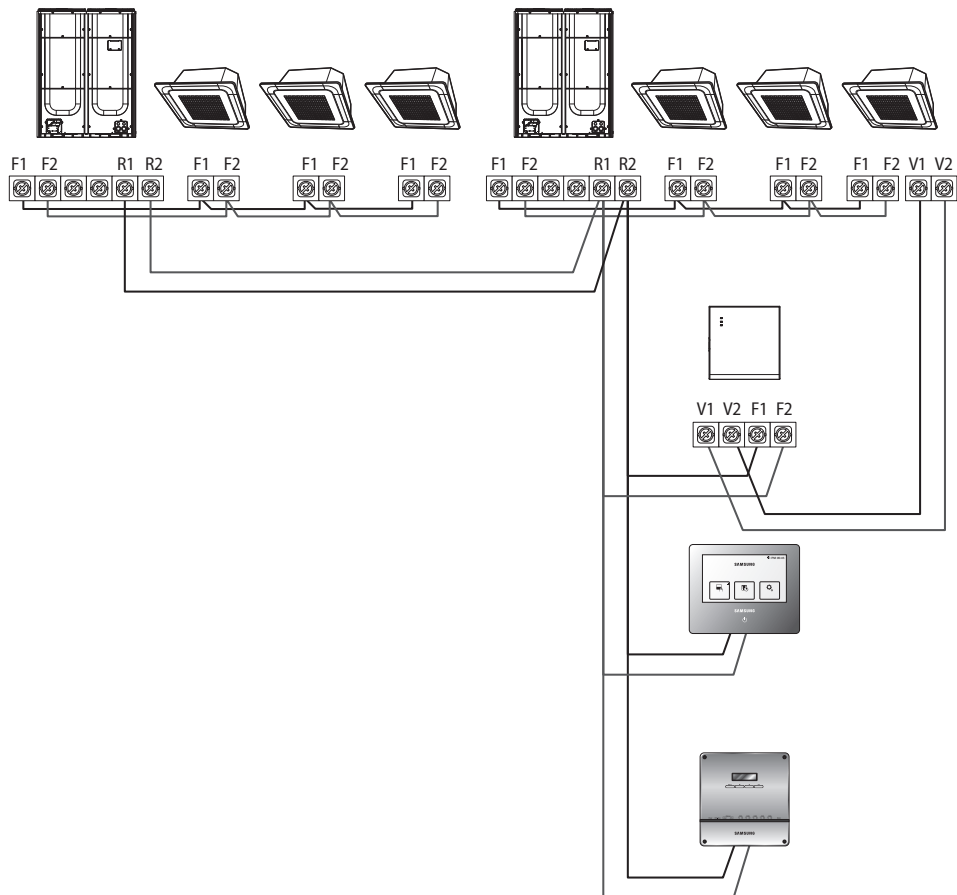

- Connect F1 and F2 of the Wi-Fi kit to R1 and R2 of the outdoor unit.
- Connect the power supply to V1 and V2 of the indoor unit.
- Can install together with other controllers such as touch centralized controller and DMS 2.5.



### 3) When installing with ERV (R1-R2)

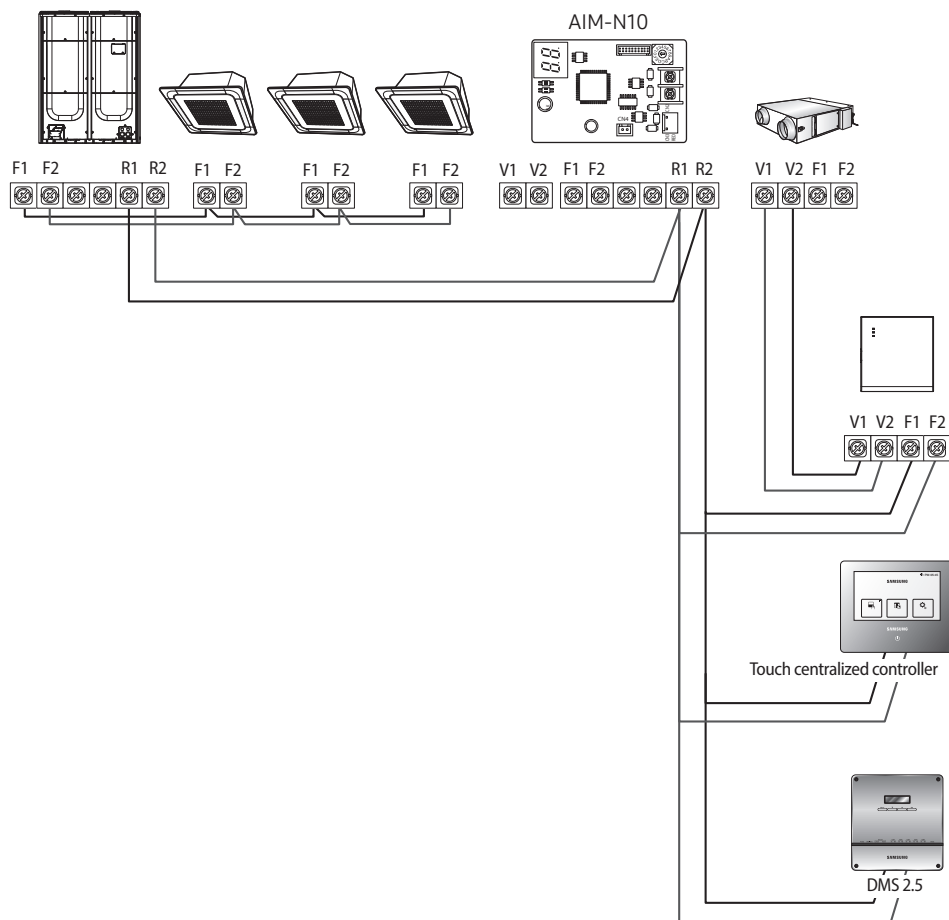

- Connect F1 and F2 of the Wi-Fi kit to R1 and R2 of the outdoor unit.
- Connect the power supply to V1 and V2 of the indoor unit or ERV.
- Can install together with other controllers such as Touch centralized controller and DMS 2.5.



CAUTION

- Up to 16 indoor and outdoor units can be connected.
- When it is connected to two or more outdoor units, some functions including energy monitor can be restricted.



## How to install Wi-Fi kit

- \* If an indoor unit does not have V1 and V2 terminal block, use the exterior control 2-wire for SUB PBA which is placed inside the indoor unit to supply power to the Wi-Fi kit.

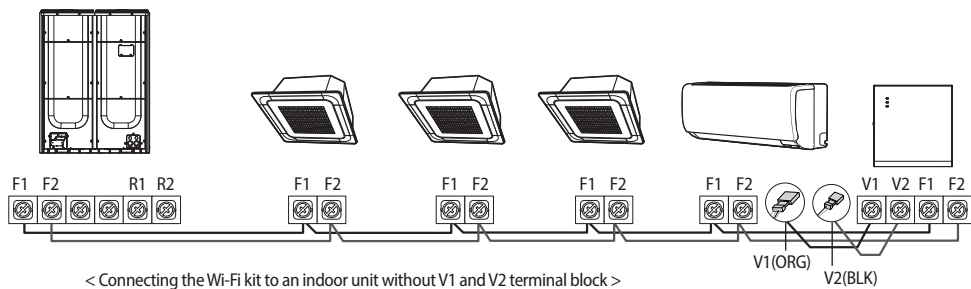
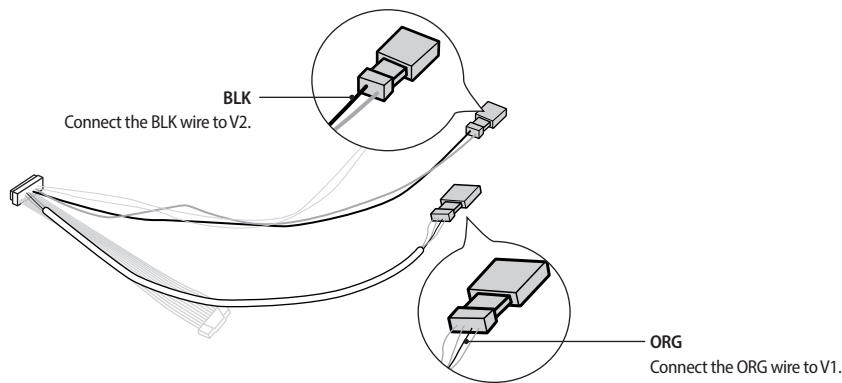



- When installing a Wi-Fi kit with 10 m (32.8 feet) or more wire, the communication wire and power wire of a Wi-Fi kit should be installed separately. (The Wi-Fi kit will malfunction because of electrical fault.)
- When installing a Wi-Fi kit on the wall, select proper thickness of wires in the consideration of the hole size for wire on the wall.
- Wire for Wi-Fi kit communication and power
  - When installing a Wi-Fi kit in a buried way, install the kit in accordance with U-terminal wiring Specification.
  - When installing a Wi-Fi kit with 4 core PVC cable, peel off 30 cm (0.98 feet) of the sheath before installing. (Recommendation: AWG22)
- Specification of compressed U-terminal for connecting Wi-Fi kit PCB

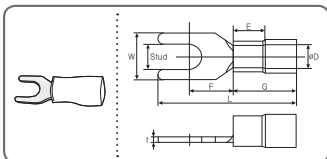

Wire range for connection		Rated size	Stud size	Basic size(mm)						
AWG	mm <sup>2</sup>	mm <sup>2</sup>	mm	t	ΦD	G	E	F	W	L
22~16	0.25~1.65	1.5	3	0.7	3.8	10.0	4.5	6.5	6.0	21.2

The maximum wiring length for communication and power : 50 m (164 feet)

- Tighten the fixing screws to the PCB terminal with less than 6N-cm torque. When the screws are tightened with more than 6N-cm torque, the screw thread will be damaged.
6. Run the Wi-Fi kit.
    - ▶ When the Wi-Fi kit is turned on, all the lamps are turned on until system operates.
    - ▶ After the system operates, tracking is performed automatically.
  7. Perform the tracking.
    - \* Tracking : You can search the devices connected to the Wi-Fi kit with the tracking function. The devices connected to Wi-Fi kit recognize that they are connected to the Wi-Fi kit. To monitor or control the system air conditioner with Wi-Fi kit, tracking should be performed.
      - ▶ When the Wi-Fi kit is turned on, the tracking is performed automatically. During the tracking, the lamp of the Wi-Fi kit ( ) blinks.
      - ▶ If the tracking is completed but the lamp ( ) blinks, it means the Wi-Fi kit does not find connected indoor units. In this case, check whether the connection of communication cable between indoor unit and outdoor unit is correct or is affected by noise.
      - ▶ If the configuration of indoor unit or outdoor unit is changed, tracking should be performed again manually by pressing the button (SW3) inside the Wi-Fi kit. ( )



- If you want to control the indoor unit with the Wi-Fi kit, indoor unit's centralized control usage option must be set to "Enable".



- If you want to control the indoor unit with the Wi-Fi kit, tracking must be done properly and connect the Wi-Fi kit to a wired/wireless router. Refer to "Registering the product" in page 15 to connect the Wi-Fi Kit to a wired/wireless router.
- When the tracking is completed correctly, the lamp ( ) is turned on until the process which connects the wired/wireless router to Wi-Fi kit is completed.
- OnOff controller cannot be used for centralized control while using multi tenant function.
- To use multi tenant function and centralized control simultaneously, please use Touch centralized controller.



# How to install Wi-Fi kit

## Setting individual usage of indoor unit



NOTE

- Multi tenant function is to set controlling and monitoring of indoor units assigned to one group channel address (RMC1) by identical tenant address of Wi-Fi kit.

For individual usage of indoor units connected to outdoor unit, installing multiple number of Wi-Fi kit allows classifying indoor units by group channel address (RMC1).

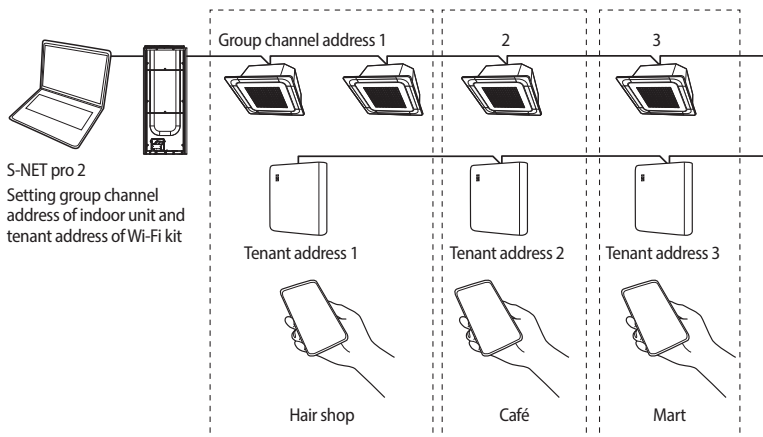

1. Install Wi-Fi kits as number of groups to use.
  - ▶ Maximum number of Wi-Fi kit that can be connected to outdoor unit module is 4.
  - ▶ Maximum number of indoor unit installation that can be connected to Wi-Fi kit is 16.
2. Set tenant address to each Wi-Fi kit by Wi-Fi kit setting function on installation program (S-NET pro 2).



NOTE

- You can change names of each Wi-Fi kit on your smartphone. (Refer to page 20.)
- You cannot change names of other connected smartphones.

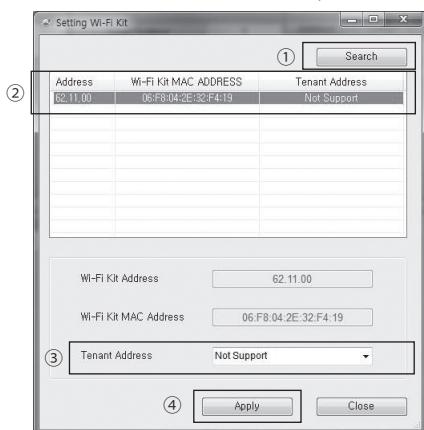

- 1) Click **Search** to find connected Wi-Fi kits.







- 2) Select one MAC address among searched Wi-Fi kits.
- MAC address can be found on the label inside of Wi-Fi kit.

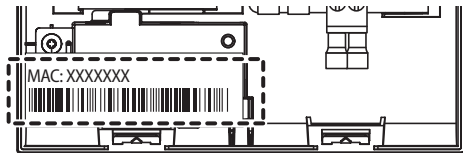

- 3) Set tenant address. (Not Support, 0~F)
- Enter tenant address to S-NET pro 2, and it will be applied as below.

Tenant address	Group channel address of indoor unit controlled by Wi-Fi kit
Not Support	Control all indoor units connected to outdoor unit
0	Control indoor units assigned to group channel address 0
1	Control indoor units assigned to group channel address 1
2	Control indoor units assigned to group channel address 2
3	Control indoor units assigned to group channel address 3
4	Control indoor units assigned to group channel address 4
5	Control indoor units assigned to group channel address 5
6	Control indoor units assigned to group channel address 6
7	Control indoor units assigned to group channel address 7
8	Control indoor units assigned to group channel address 8
9	Control indoor units assigned to group channel address 9
A	Control indoor units assigned to group channel address A
B	Control indoor units assigned to group channel address B
C	Control indoor units assigned to group channel address C
D	Control indoor units assigned to group channel address D
E	Control indoor units assigned to group channel address E
F	Control indoor units assigned to group channel address F

- Ex.) If tenant address 2 is entered on Wi-Fi kit by S-NET pro 2, only indoor units assigned to 2 for RMC1 will be the target of controlling and monitoring.
- 4) Click **Apply** and the tenant address will be saved on Wi-Fi kit.



NOTE

- Refer to "Setting an indoor unit address and installation option" in installation guide of indoor unit to set indoor unit group address. (SEG9: 1, SEG11: RMC1)
- If you want to reset the tenant address, please contact Samsung service center.
- To control all indoor units classified by tenant addresses with one smartphone, each Wi-Fi kit should be registered on the smartphone.
- When using multi tenant function by Wi-Fi kit, upper controllers other than OnOff controller (such as Touch centralized controller, DMS, etc.) can be installed at the same time.





# How to install Wi-Fi kit

## Checking the Wi-Fi kit

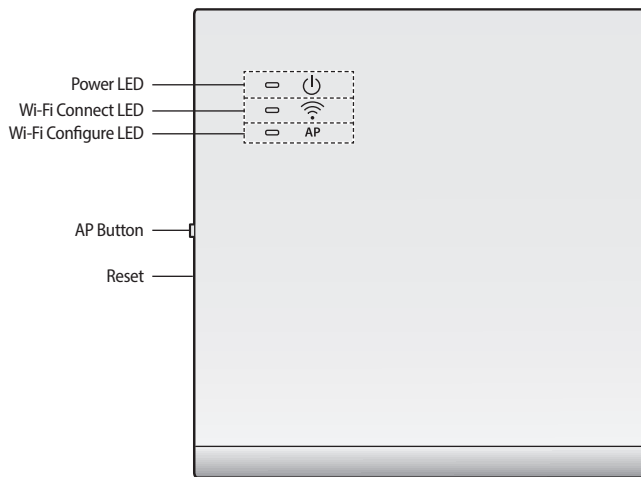

<Wi-Fi kit front view>

## LED display information

NO	LED information	Power	Wi-Fi Connect	Wi-Fi Configure
1	Initialized	ON	ON	ON
2	Normal	ON	ON	OFF
3	AP Connection OK. But, Internet is not Connected	ON	Blinking	OFF
4	Air conditioner searching OK, but AP connection is not completed.	ON	OFF	OFF
5	Wi-Fi Modem is in Malfunction	Blinking	Blinking	Blinking
6	Searching AP (AP mode)	ON	OFF	ON
7	Searching Air conditioner	Blinking	Blinking	OFF
8	No Air Conditioner Information	Blinking	OFF	OFF
9	Inspecting network PBA	ON	Blinking	Blinking
10	Requesting a token (AP mode)	ON	OFF	Blinking





## Initializing user data

- ▶ If you want to initialize all the user data to set the Wi-Fi kit as factory default status, press and hold the button (SW3) inside the Wi-Fi kit for 5 seconds. After releasing the button, all the lamps on the Wi-Fi kit are turned on and all the user data is deleted.

## Updating the Wi-Fi kit by SD card

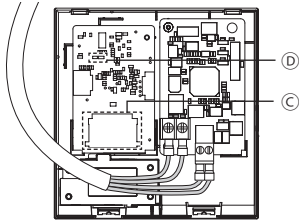

1. Make update directory in the SD card. Copy the latest S/W image and paste it into the update directory of the SD card.
2. Insert the SD card into the SD card slot which is located inside the Wi-Fi kit. (C)
3. Press the **Reset** button on the side of the Wi-Fi kit.
4. The lamp inside the Wi-Fi kit is turned on during the update. (D)
  - ▶ When the update is completed correctly, the lamp is turned off.
  - ▶ When the update is completed incorrectly, the lamp blinks.
5. When the update fails, the Wi-Fi kit returns to the previous version when it restarts. Retry the update but if it still does not work, take following measures.
  - ▶ Check the file for an error: change the update image (file)
  - ▶ Check the SD file for an error: change the SD card
  - ▶ Check the PBA for an error: change the PBA.



## Setting the network



NOTE

- This product supports DHCP (Dynamic Host Configuration Protocol) only. Before connecting the router to the Wi-Fi kit, check whether the DHCP server option function of your wired/wireless router is activated.
- Select a channel for wired/wireless router. The channel should be currently not in use.
- The cipher mode of wired/wireless router supports Open, WPA/TKIP or WPA2/AES. Except for the above modes, the Wi-Fi kit may not be connected to wired/wireless router. In case of 802.11n, WPA2/AES mode is recommended.
- The quality of wireless network connection can be affected by surrounding wireless circumstance.
- If an internet service provider permanently registered the user's PC or MAC address (Identification number) of the modem, the Wi-Fi kit may not be connected to the internet. Please contact the internet service provider and inquire about the internet connection process to connect a device (e.g. air conditioner) to the internet.
- If the internet service provider requires ID or password to be connected to the internet, the Wi-Fi kit may not be connected to the internet. In this case, you need to enter ID or password every time you connect the internet.
- Internet may not be available due to the firewall. Please contact the internet service provider and request the solution.
- Since some wired/wireless router can send abnormal DNS (Domain Name Server) even though internet is connected, the Wi-Fi kit may not be connected to internet. In this case, contact the suppliers of wired/wireless router or internet service provider.
- If you followed what the internet service provider directed but cannot be still connected to the internet, contact the Samsung service center.
- If the wired/wireless router is connected to the Wi-Fi kit but the router is not connected to the internet, the lamp of Wi-Fi kit  blinks.

### Specification of wired/wireless router for Samsung Smart Air conditioner

- ▶ Please refer to the user manual for installation of your wired/wireless router.
- ▶ Wi-Fi kit supports Wi-Fi 2.4 GHz only.
- ▶ Wi-Fi kit supports the IEEE802.11 b/g/n communication protocol. (Samsung Electronics recommends use of IEEE802.11n.)
- ▶ If the wired/wireless router is not Wi-Fi certified product, it may not be connected to the Wi-Fi kit.
- ▶ The certified wired/wireless router has Wi-Fi CERTIFIED logo on the product package or in the user manual.

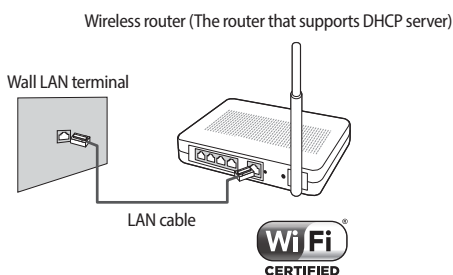



# Starting Samsung Smart Home App

## Downloading Samsung Smart Home App

- ▶ You can download the Samsung Smart Home App by searching "Samsung Smart Home" on Play store, Galaxy Apps and iPhone App Store.

### For android phone

- ▶ Korean key word : 삼성 스마트 홈
- ▶ English key word : Samsung Smart Home

### For iPhone

- ▶ Korean key word : 스마트 홈
- ▶ English key word : Smart Home



NOTE

- Samsung Smart Home App supports android operating system 4.0 (ICS) or higher and is optimized with Samsung Smart phones (Galaxy S or Note series). If you run the App using a Smart phone manufactured by other companies, some functions may operate differently.
- For iPhone users, the App supports iOS7 or higher.
- The UI of Samsung Smart Home App can be changed for improvement of usability and performance without advanced notice and may differ from images in this manual.



# Starting Samsung Smart Home App

## Running the Samsung Smart Home App

Smart Home

**Samsung Account**

ID

Password

☒ Remember my ID

☒ Show Password

Sign in

Create new account

Find your ID or Password

Before using the Samsung Smart Home App, register the Samsung account.

- ▶ If you are a Samsung Smart phone user, you can automatically log on to the App with the Samsung account.
- ▶ If you are not a Samsung Smart phone user, the login page appears every time you use the Samsung Smart Home App.

Copyright © Samsung Electronics Co., Ltd. All rights reserved.

Samsung account

GALAXY

Create a Samsung account to get the most out of your device.

- Back up your contacts, messages, and more.
- Find your device easily if you lose it.

[Learn more](#)

Sign in

Create account

Help



NOTE

- If you are a Samsung Smart phone user but don't have Samsung account, the Samsung account registration page appears every time you run the Samsung Smart Home App.
- If you don't have Samsung account, press the **Create account** button.

Settings

Services

**Select a country**

Search Text

Leiva

Lebanon

Levant

Libya

Lithuania

Save

Open Source License

- ▶ Search the country where the product will be used and press the **Save** button. It appears only one time at the first operation.



## Registering the product

Register the Wi-Fi kit on the Samsung Smart Home App.

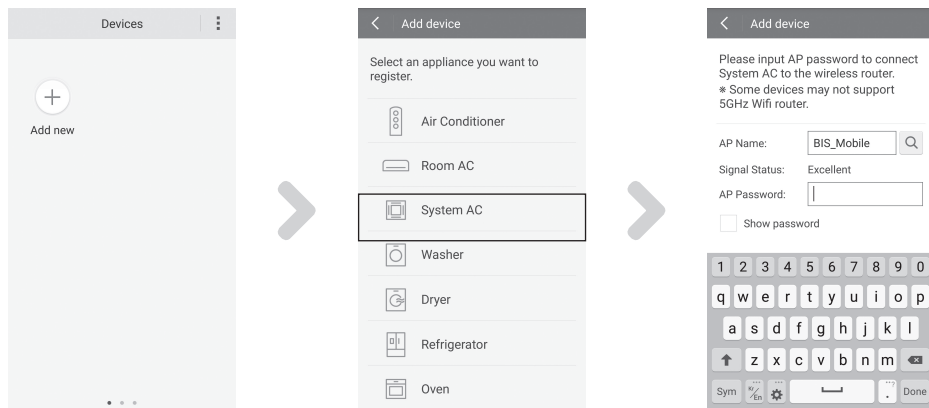

1. Press the **Add new** button.
2. Select **System AC**.
3. Enter the information of wireless router which will be connected and then press the **Next** button.
  - If you want to change the connected router, press the (🔍) icon and select the AP name of the wireless router.

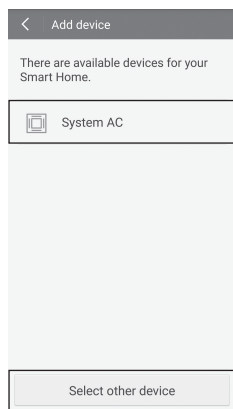

NOTE

- If the Wi-Fi kit has been connected to a wireless router, the following screen appears.
- If the screen displays the desired wireless router, select **System AC**.
  - At this time, the Power LED of the Wi-Fi kit lights and the Wi-Fi Connect LED is blinking. To change settings of the router or connect another Wi-Fi kit, select **Register other device**.

ENGLISH

# Starting Samsung Smart Home App

4. Press the AP button on the side of the Wi-Fi kit according to the guidance on the screen. Check that the AP lamp is turned on the Wi-Fi kit.

## 4-1. For an android phone

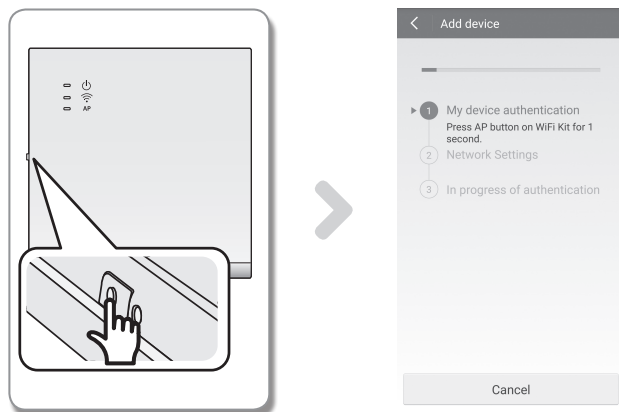

## 4-2. For an iPhone

- Press the Home button on the iPhone to exit the Samsung Smart Home App.
- Press **Settings** → **Wi-Fi** and select the DIRECT-SMARTDVM on the list of the wireless routers and enter 111122222.
- Check that the iPhone is connected to the DIRECT-SMARTDVM wireless router.
- Press the Home button on the iPhone to exit the Settings.
- Select the Samsung Smart Home App and select the **Next** on the Set AP mode screen.

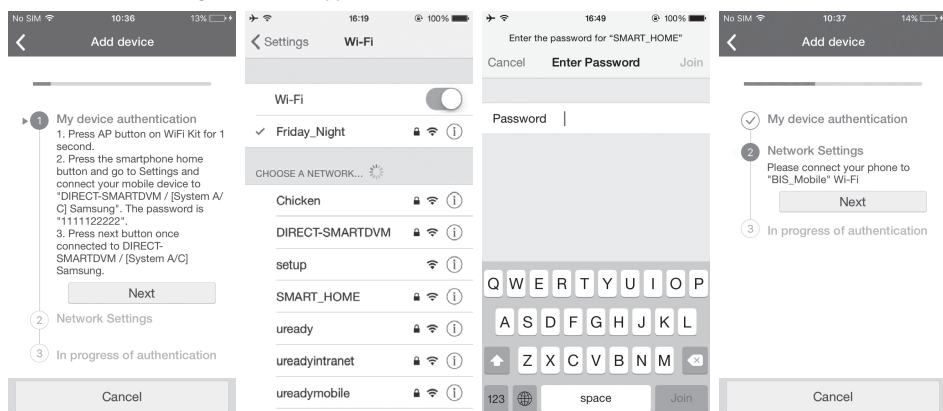





5. Network setting is automatically performed.

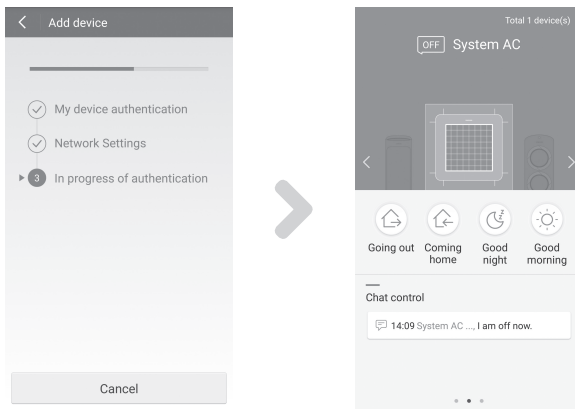

6. When the product registration is completed, the main screen of the Samsung Smart Home App appears.

- System AC icon is added on the device list.



- If the wired/wireless router is not Wi-Fi certified product, it may not be connected to Wi-Fi kit.
- If the router is installed near a microwave oven or a product (washing machine), smart control function may not work correctly due to electronic interference.
- If you fail to register during the registration process, retry the process from the first step. (Refer to the 'Registering the product' in page 15.)

## Description of screens and main functions

### Device screen

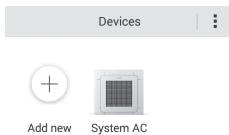

- After registering Samsung smart appliances to the Samsung Smart Home Service, you can control all of them remotely. Currently registered devices are displayed and you can register a device



# Starting Samsung Smart Home App

## Changing names of Wi-Fi kit

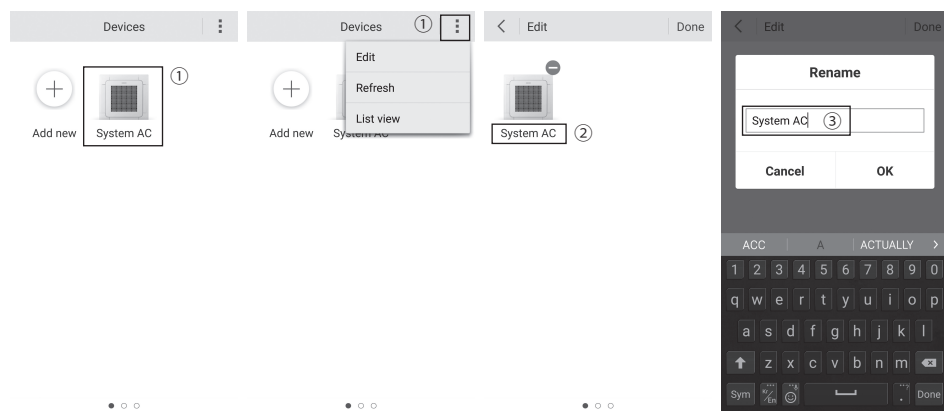

1. Press and hold Wi-Fi kit icon or press **Edit** button at top right on Devices screen.
2. When Edit screen appears, press the name of Wi-Fi kit that you want to change.
3. When Rename screen appears, enter a new name of Wi-Fi kit.

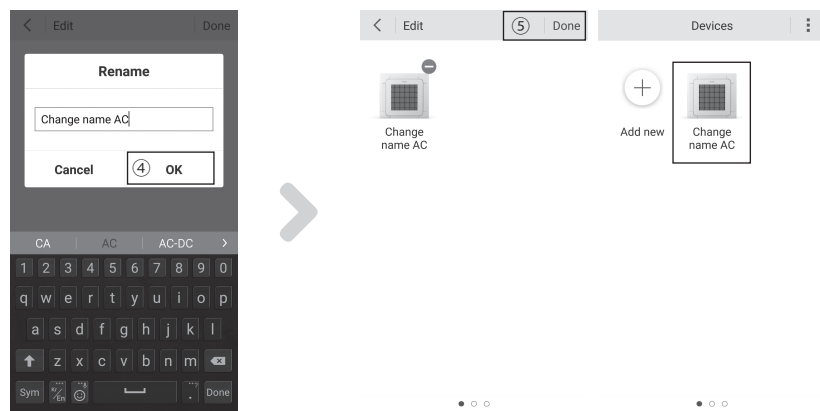

4. After entering the new name, press **OK** button.
5. Check if the name of the Wi-Fi kit is changed and press **Done** button.





## Main screen

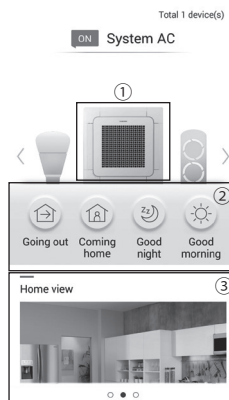

1. Select the icon of smart appliance (System AC) on the main screen to move to the screen of Smart Home Device Control.
2. You can perform integrated control of Samsung smart appliances by 4 types such as Going out, Coming home, Good night, and Good morning.
3. You can check indoor view with the Home view function.
  - Wi-Fi kit does not support the Home view function.

## Menu screen

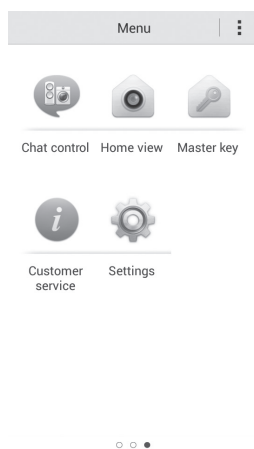

- You can control Samsung smart appliances with 5 menus.

<b>Chat control</b>	You can control smart appliances easily or check the status of the appliances.
<b>Home view</b>	You can check indoor view from outside by using the camera installed on the smart appliances. Wi-Fi kit does not support the Home view function.
<b>Master key</b>	You can control multiple smart appliances at the same time using the master keys such as Going out, Coming home, Good night, and Good morning.
<b>Customer service</b>	Wi-Fi kit does not support the Customer service function. When the product has a problem, Contact the Samsung service center.
<b>Settings</b>	You can control or check the service (device addition, country selection, etc.) and information (version information, open source).



# Starting System Air conditioner App

## Smart home device control

The Smart home device control functions of air conditioner such as Operation, Additional options, On/Off timer, Electric Power, Settings etc.

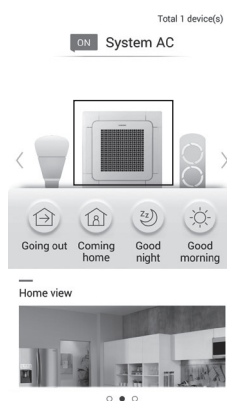

1. Select the System AC icon on the main screen of Samsung Smart Home App.



- To control ERV product, you have to install another Wi-Fi kit, then System AC will appear on the main screen of Samsung Smart Home App.

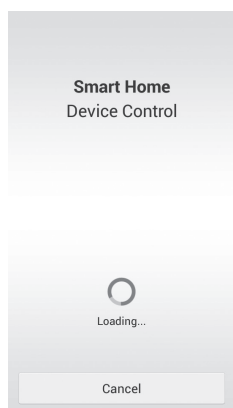

2. The loading screen of System Air Conditioner App appears.

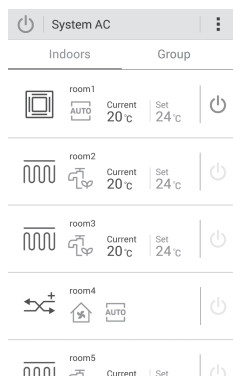

3. The list of indoor units installed with the Wi-Fi kit appears.

- If there are no indoor units connected to Wi-Fi kit, "No Indoor Units" appears and you cannot enter the System Air Conditioner App.



## Indoor unit/ group list screen

You can see the list of individual indoor units or group of indoor units with Wi-Fi kit.

### Indoor unit

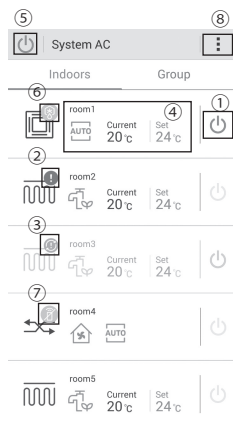

► Select **Indoors** button to see the list of all indoor units (with Wi-Fi kit).

Classification	Item	Description
①	Power / Device status	Turns on or off the air conditioner. When the air conditioner is turned on, (⏻) is displayed, when it is turned off, (⏻) is displayed.
②	Error status	When the air conditioner has error, (⚠) is displayed.
③	Communication error	When the air conditioner has communication error, (⚠) is displayed.
④	Temperature	Displays current or set temperature.
⑤	Power for all air conditioners	Turns on or off all the air conditioners.
⑥	Defrost	When the air conditioner is in defrost operation, (❄) is displayed.
⑦	Control restriction	When the Wi-Fi kit cannot control the air conditioner, (⚠) is displayed. You cannot control the air conditioner when this icon is displayed.
⑧	Menu	Moves to the Settings or Customer service menu.



CAUTION

- The icon of the indoor unit can be different depending on the models.
- Current temperature displayed on the screen may be different from actual room temperature depending on the installation and usage condition.



# Starting System Air conditioner App

## Group

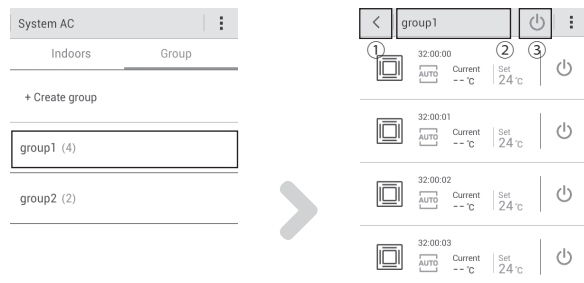

- ▶ Select **Group** button to see the list of group with indoor units created by the user.
- ▶ If you select one of the group from the list, you will see the list of indoor units within a group.

①	Back	Moves to the group list screen.
②	Name	The name of the selected group is displayed.
③	All power	Turn on or off all the air conditioners in the group.





## Control screen

### Indoor unit

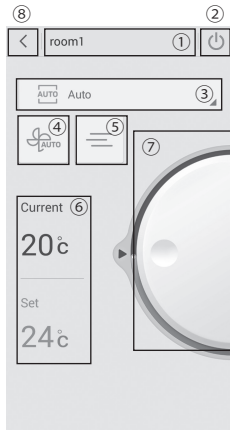

Classification	Item	Description
①	Name	The name of the selected air conditioner is displayed.
②	Power	Turns on or off the air conditioner.
③	Mode	Selects the desired operation.
④	Fan speed	Sets desired fan speed.
⑤	Fan direction	Sets desired fan direction.
⑥	Current temperature / Set temperature	Displays current and set temperature.
⑦	Temperature control	Controls indoor set temperature.
⑧	Back	Moves to the indoor unit list screen.

ENGLISH

### ERV

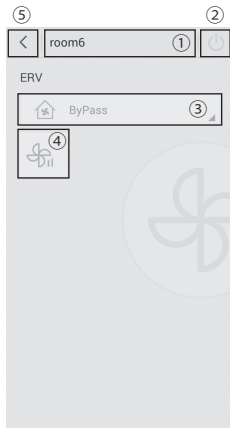

Classification	Item	Description
①	Name	The name of the selected ERV is displayed.
②	Power	Turns on or off the ERV.
③	Mode	Selects the desired operation.
④	Fan speed	Sets desired fan speed.
⑤	Back	Moves to the indoor unit list screen.

# Starting System Air conditioner App

## ERV Plus

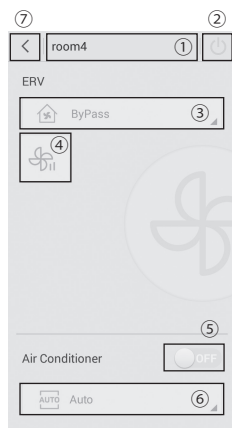

Classification	Item	Description
①	Name	The name of the selected ERV plus is displayed.
②	Power	Turns on or off the ERV plus
③	Mode	Selects the desired operation.
④	Fan speed	Sets desired fan speed.
⑤	Air conditioning power	Turns on or off the air conditioning function.
⑥	Air conditioning mode	Select the desired air conditioning mode.
⑦	Back	Moves to the indoor unit list screen.



NOTE

- You can control the air conditioner only when the ERV plus is operating.

## EHS

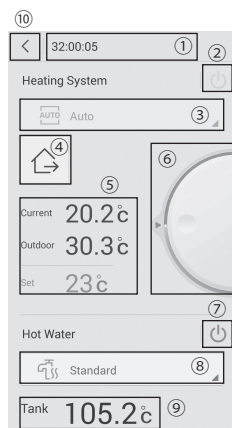

Classification	Item	Description
①	Name	The name of the selected EHS is displayed.
②	Power	Turns on or off the heating system.
③	Mode	Selects the desired operation mode of the heating system.
④	Going out	Sets Going out function.
⑤	Current/Outdoor/Set temperature	Displays current, outdoor, and set temperature.
⑥	Temperature control	Controls indoor set temperature.
⑦	Hot water power	Turn on or off Hot water.
⑧	Hot water mode	Selects the desired operation mode of Hot water.
⑨	Current tank temperature	Displays current tank temperature.
⑩	Back	Moves to the indoor unit list screen.



NOTE

- Control and monitoring can be delayed depending on network condition.
- Some indoor units may not support some of the functions.
  - Ex. 1) Set temperature is not displayed in Fan mode.
  - Ex. 2) Vertical air swing mode is not displayed for the indoor units that does not support vertical air swing.
  - Ex. 3) Fresh duct does not have the function to adjust the set temperature.



CAUTION

- If the cooling thermostat is installed, you cannot control the operation mode and temperature for the heating system and current temperature will not be displayed.
- If the hot water thermostat is installed, current temperature of the tank will not be displayed.





## Setting the group



1. Press the **Group** button to add/delete/edit the group.

### Creating the group

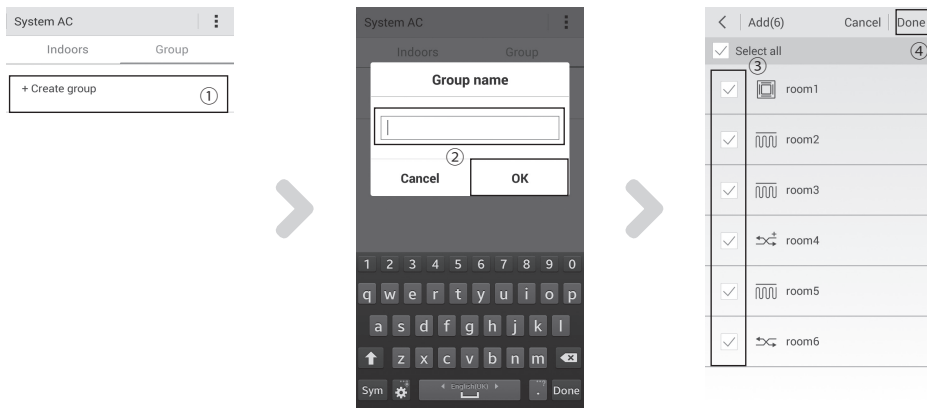

1. Press the **Create group** button.
2. Enter the name of the group and press **OK** button.
3. Select indoor units you wish to add to the group.
4. Press the **Done** button when you finish adding indoor units.
  - ▶ Added group will appear on the list.



# Starting System Air conditioner App

## Editing the group

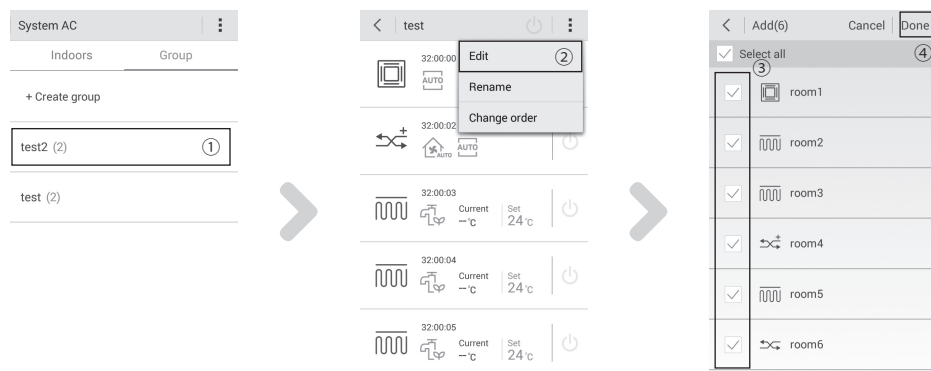

1. Select the group you wish to edit.
2. Press the **Menu** → **Edit** button.
3. Select or deselect the indoor unit you wish to add to, or deleted from the group.
4. Press the **Done** button when you finish editing the group.

## Renaming the group

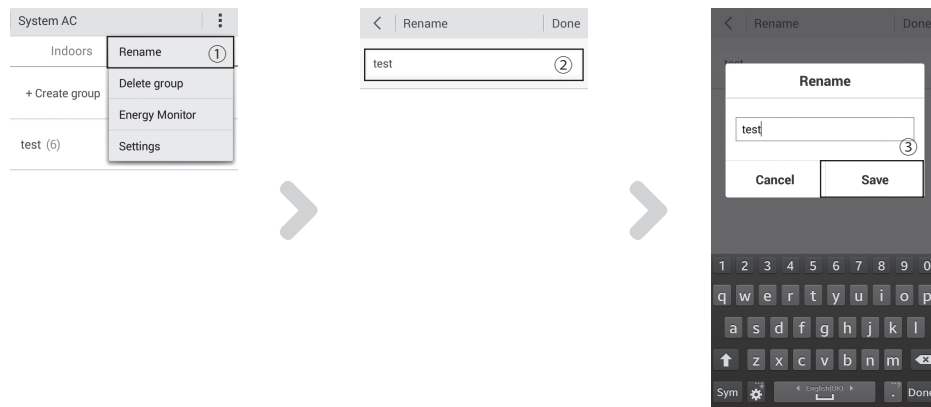

1. Press the **Menu** → **Rename** button.
2. Select the group you wish to rename.
3. Rename the group and press the **Save** button.





## Deleting the group

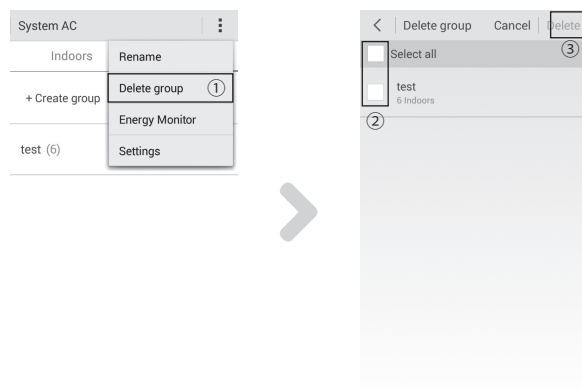

1. Press the **Menu** → **Delete group** button.
2. Select the group you wish to delete.
3. Press the **Delete** button to delete the selected group.

## Changing the order of group

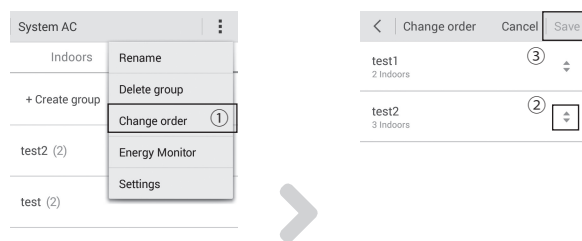

1. Press the **Menu** → **Change order** button.
2. Select the group and press it for 1 second and drag it to desired position to change the order.
3. Press the **Done** button when you finish changing the order of group.



# Starting System Air conditioner App

## Editing the indoor unit list

### Renaming the indoor unit

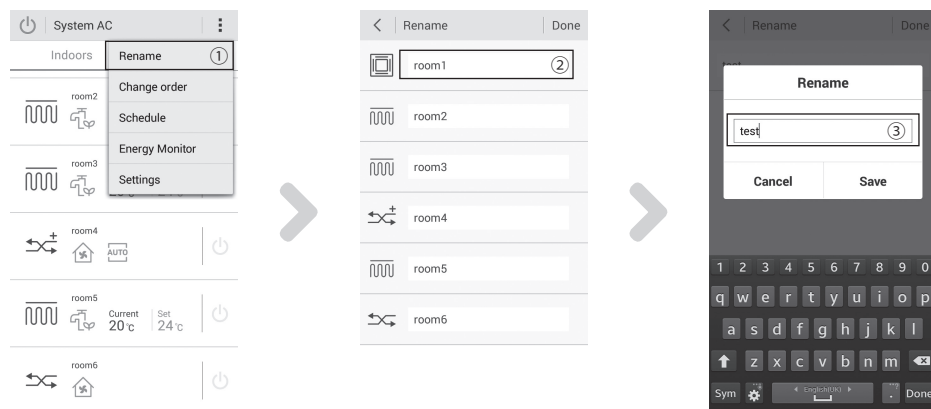

1. Press the **Menu** → **Rename** button.
2. Select the indoor unit you wish to rename.
3. Rename the indoor unit and press the **Save** button.

### Changing the order of indoor unit

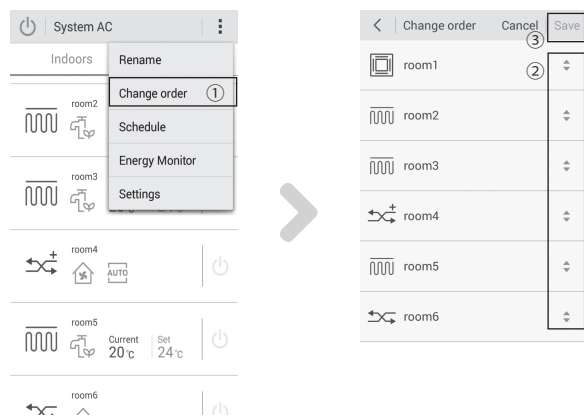

1. Press the **Menu** → **Change order** button.
2. Select the indoor unit and press it for 1 second and drag it to desired position to change the order.
3. Press the **Save** button when you finish changing the order of indoor unit.





## Schedule



- Before creating a schedule, you must synchronize the time. (**Menu** → **Settings** → **Sync Time**)  
If you do not synchronize the time, schedule may not work on desired time. You only have to synchronize the time once.

### Creating a schedule

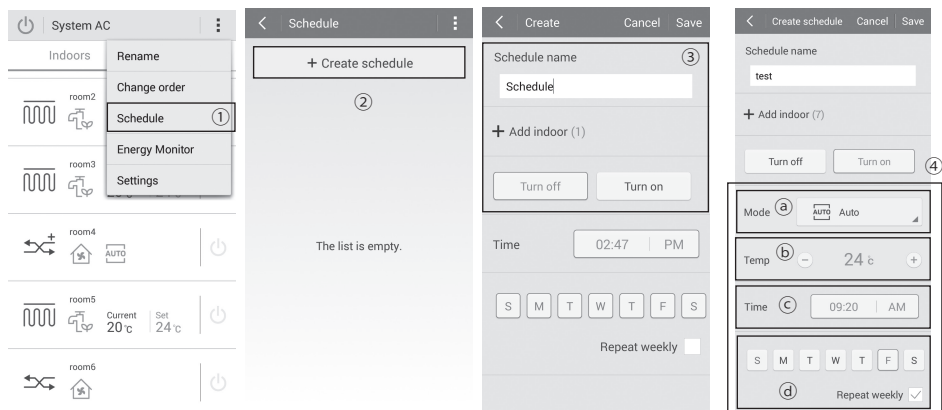

- Press the **Menu** → **Schedule** button.
- Press the **Create schedule** button.
- Set the detail settings.
  - Enter the name of the schedule.
  - Press the **Add indoor** button to select the indoor unit you wish to apply the schedule.
  - Select **Turn on** or **Turn off**.
    - Turn on / Turn off will be applied to all the air conditioners which was added when the schedule was created. Some of the indoor units may not operate as set on the schedule.
    - If you select **Turn on**, you can select operation mode and set temperature.
- Select the desired operation mode.
  - Set the temperature.
  - Set the time.
  - Set the day.



- Some of the operation modes that display in schedule setting may not be supported depending on the product.



## Starting System Air conditioner App

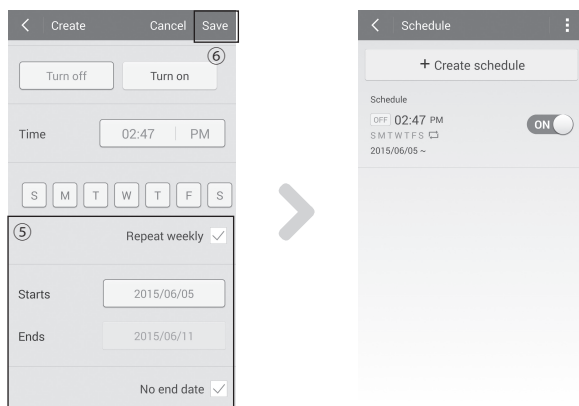

5. If you want the schedule to be repeated weekly, select **Repeat weekly** and set the starting and the end date.
  - ▶ If you want the schedule to be repeated indefinitely, select **No end date**.
6. Press the **Save** button the save the schedule.
  - ▶ Created schedule will appear on the schedule screen.

### Deleting a schedule

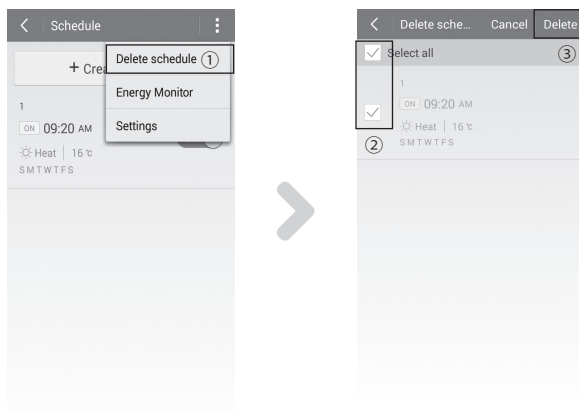

1. Press the **Menu** → **Delete schedule** button.
2. Select the schedule you wish to delete.
3. Press the **Delete** button.
  - Press the **OK** button when you get a confirmation message.





## Editing a schedule

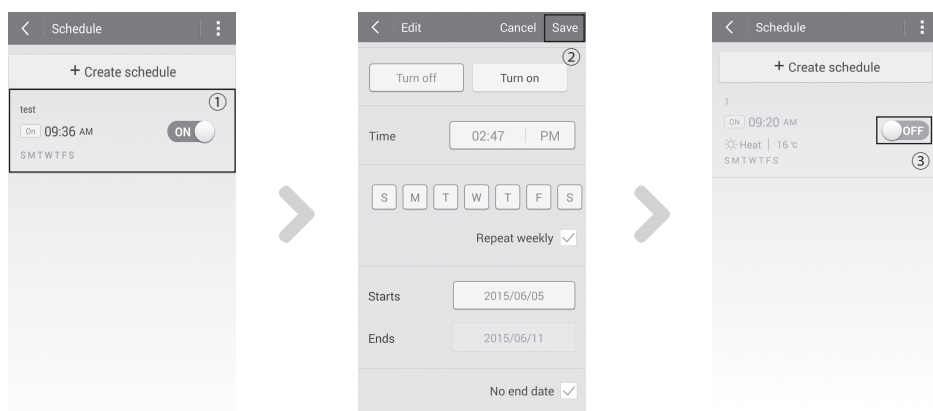

1. Press the schedule you wish to edit.
2. Change the setting and press the **Save** button.
3. If you do not want the schedule to be effective, you can switch the button on the right side of the schedule to OFF.

## Energy monitor

You can check the current/daily/weekly/monthly energy usage data.

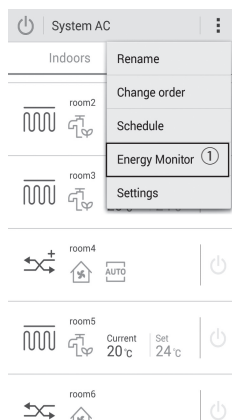

1. Press the **Menu** → **Energy Monitor** button.
  - ▶ You can check the current/daily/weekly/monthly energy usage data.



- Current and daily, weekly or monthly energy usage of the outdoor unit is just a reference data calculated by Samsung's own algorithm and it cannot be used as an legal basis.
- You can check the energy usage data up to past 6 months.



## Starting System Air conditioner App

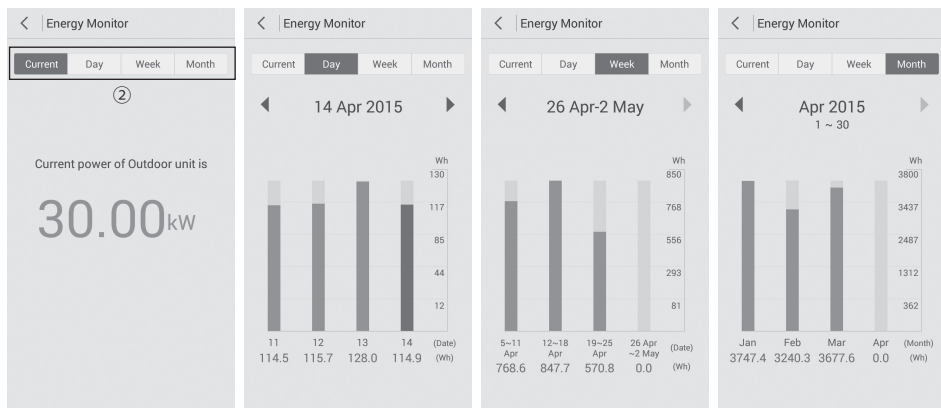

2. Select **Current/Day/Week/Month** button.
  - Press the arrow to check the data for previous period.



NOTE

- Energy Monitor displays power consumption which is different from power consumption shown on electricity bills.
- This function is only available for the products that provides energy usage data.
- When a Wi-Fi kit is connected to two or more outdoor units, the Energy Monitor does not appear.

## Settings

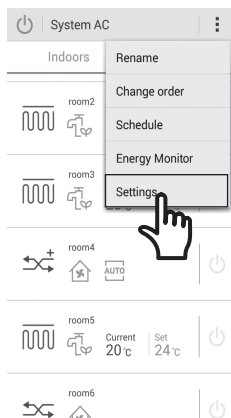

1. Press the **Menu → Settings** button.





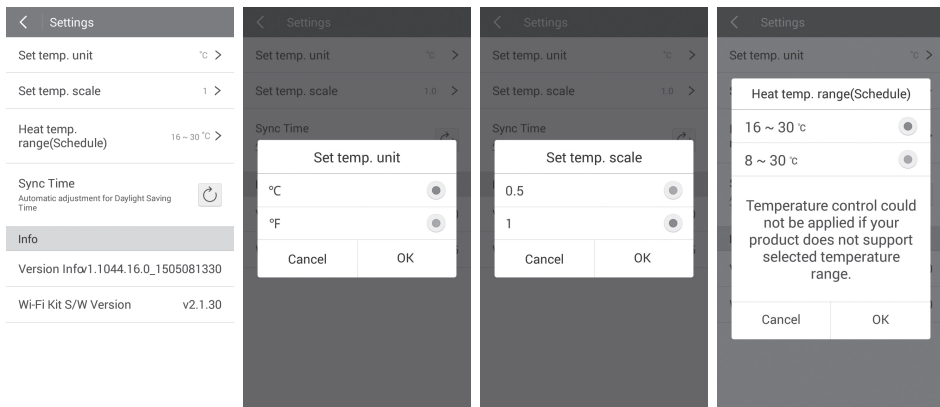

2. You can change the Set temperature unit, Set temperature scale, temperature range for heating, Synchronize time, or check the information of the Wi-Fi kit.
  - ▶ Temperature range can be set differently according to product.
  - ▶ Refer to the user manual of the product to check the temperature range.



- If the unit of set temperature is in Fahrenheit (°F), scale of set temperature is fixed at 1 degree.
- If you do not synchronize the time, schedule may not work on desired time.

## Updating the Wi-Fi kit

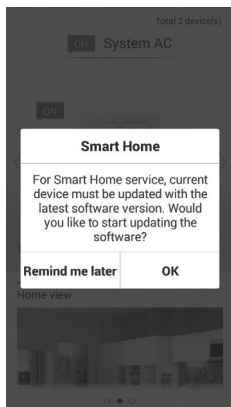



- ▶ You will be notified when there is an update for this application.
- ▶ If you press the **OK** button, Wi-Fi kit will be updated and you cannot control the indoor unit while it is being rebooted.



# Troubleshooting

Before you call a service center, please check the items in the table below.

Problem		Solution
Samsung Smart Home App cannot be searched on Play store, GALAXY Apps or iPhone App Store.		▶ Samsung Smart Home App supports android operating system 4.0 (ICS) or higher. For iPhone, the App supports iOS 7 or higher.
After installing Samsung Smart Home App, the air conditioner cannot be connected to the App.		Connect the air conditioner to wireless router by referring to "Registering the product" section in the user manual.
Samsung account cannot be accessed.		Check your ID and password on Samsung account screen.
A failure message appears when the device is being added.		▶ The failure might be temporary due to the distance between the wired or wireless router and the air conditioner or other problems. Try again later. ▶ Disconnect power to the air conditioner for 30 seconds. Reconnect power and try the setting again.
The control function of Samsung Smart Home App does not work.	Check that all the 3 Wi-Fi kit lamps are turned on.	Reset the Wi-Fi kit and check the kit again.
	Check whether only the  lamp of Wi-Fi kit is turned on.	Check whether you have entered correct password for the wired/ wireless router when adding the device. Check the status of wired/wireless router.
	Check whether the lamp of the  lamp of Wi-Fi kit blinks.	Check that the internet is correctly connected by using the wired/ wireless router.
	Check whether all the lamps of the Wi-Fi kit blinks.	The Wi-Fi kit has a problem. Contact the Samsung service center.
	Check whether the lamp  of Wi-Fi kit blinks.	The Wi-Fi kit is not correctly connected to the indoor unit. Contact the Samsung service center.
The indoor unit mode of multi product model that supports heating/cooling is displayed only one between heating and cooling.		▶ Heat pump model is displayed automatically restrictively to be able to select only the operating mode on outdoor unit, in order to prevent the mixed control. (* Mixed control: A situation when both cooling and heating mode is selected in each indoor units connected to same outdoor unit) 1. If you turn off the other indoor unit when you want to select the current working operation mode and the other operation mode, all operable modes are displayed. 2. If the master indoor unit is set up, change the operating mode of master indoor unit.
LED Status is still Initialized. (LED status should be changed within one minute)		1. Check whether the Communication cable is correctly connected between network PBA and interface module PBA. 2. Replace the Wi-Fi Kit if the problem is still same, even though connection is exactly correct.





# Open Source Announcement

The software included in this product contains open source software. You may obtain the complete corresponding source code for a period of three years after the last shipment of this product by sending an email to [mailto:oss.request@samsung.com](mailto:mailto:oss.request@samsung.com).

It is also possible to obtain the complete corresponding source code in a physical medium such as a CD-ROM; a minimal charge will be required.

The following URL <http://opensource.samsung.com/opensource/WIFIKIT/seq/0> leads to the download page of the source code made available and open source license information as related to this product. This offer is valid to anyone in receipt of this information.





# Declaration of Conformity

English	<p>Hereby, Samsung Electronics, declares that this Air conditioner is in compliance with the essential requirements and other relevant provisions of Directive 1999/5/EC.</p> <p>The official Declaration of conformity may be found at <a href="http://www.samsung.com">http://www.samsung.com</a>, go to Support &gt; Search Product Support and enter the model name.</p> <p>This equipment may be operated in all EU countries.</p> <p>In France, this equipment may only be used indoors.</p>
Czech	<p>Společnost Samsung Electronics tímto prohlašuje, že tento systém klimatizace splňuje základní požadavky a další související ustanovení Směrnice 1999/5/ES.</p> <p>Oficiální Prohlášení o shodě naleznete na webové stránce <a href="http://www.samsung.com">http://www.samsung.com</a>. Klepněte na nabídku Podpora &gt; Najít podporu k produktu a zadejte jméno modelu.</p> <p>Toto zařízení lze používat ve všech zemích EU.</p> <p>Ve Francii lze toto zařízení používat pouze ve vnitřních prostorách.</p>
Danish	<p>Samsung Electronics erklærer herved, at dette luftkonditioneringsanlæg overholder de grundlæggende krav og andre relevante bestemmelser i Direktiv 1999/5/EC.</p> <p>Den officielle overensstemmelseserklæring kan findes på <a href="http://www.samsung.com">http://www.samsung.com</a>, gå til Support Support) &gt; Search Product Support (Produktsøgning), og indtast modelnavnet.</p> <p>Dette udstyr må bruges i alle EU-lande.</p> <p>I Frankrig må dette udstyr dog kun bruges indendørs.</p>
German	<p>Samsung Electronics erklärt hiermit, dass dieses Klimagerät konform zu allen wesentlichen Anforderungen oder relevanten Bestimmungen der Richtlinie 1999/5/EG ist.</p> <p>Die offizielle Konformitätserklärung finden Sie unter <a href="http://www.samsung.com">http://www.samsung.com</a>. Wechseln Sie zu Support &gt; Produktsuche, und geben Sie den Modellnamen ein.</p> <p>Dieses Gerät darf in allen EU-Ländern betrieben werden.</p> <p>In Frankreich darf dieses Gerät nur in Gebäuden verwendet werden.</p>
Estonian	<p>Käesolevaga kinnitab ettevõtte Samsung Electronics selle kliimaseadme vastavust direktiivi 1999/5/EÜ põhinõuetele ja nimetatud direktiivist tulenevatele teistele asjakohastele sätetele.</p> <p>Ametliku vastavusdeklaratsiooni leiate aadressilt <a href="http://www.samsung.com">http://www.samsung.com</a>, minge jaotisesse Tugi &gt; Tootetoe otsing ning sisestage mudeli nimi.</p> <p>Seda seadet võib kasutada kõigis EL riikides.</p> <p>Prantsusmaal võib seda seadet kasutada üksnes siseruumides.</p>
Spanish	<p>Por el presente documento Samsung Electronics declara que este aparato de aire acondicionado cumple los requisitos fundamentales y demás disposiciones pertinentes de la Directiva 1999/5/CE.</p> <p>La Declaración de conformidad oficial se puede encontrar en <a href="http://www.samsung.com">http://www.samsung.com</a>; vaya Atención al cliente &gt; Soporte para productos e introduzca el nombre del modelo.</p> <p>Este equipo puede ser operado en todos los países de la unión europea.</p> <p>En Francia, este equipo sólo puede ser utilizado en interiores.</p>
Greek	<p>Με την παρούσα, η Samsung Electronics δηλώνει ότι αυτό το κλιματιστικό συμμορφώνεται με τις ουσιαστικές απαιτήσεις και τις λοιπές σχετικές διατάξεις της Οδηγίας 1999/5/EK.</p> <p>Μπορείτε να βρείτε την επίσημη Δήλωση συμμόρφωσης στη διαδικτυακή τοποθεσία <a href="http://www.samsung.com">http://www.samsung.com</a>.</p> <p>Μεταβείτε στο Υποστήριξη &gt; Αναζήτηση υποστήριξης προϊόντος και εισαγάγετε το όνομα μοντέλου.</p> <p>Ο παρών εξοπλισμός μπορεί να λειτουργήσει σε όλες τις χώρες της Ευρωπαϊκής Ένωσης.</p> <p>Στη Γαλλία, ο παρών εξοπλισμός μπορεί να χρησιμοποιηθεί μόνο σε εσωτερικό χώρο.</p>
French	<p>Par la présente, Samsung Electronics déclare que ce climatiseur est conforme aux exigences essentielles et autres dispositions applicables de la directive 1999/5/CE.</p> <p>La déclaration de conformité officielle est disponible à l'adresse <a href="http://www.samsung.com">http://www.samsung.com</a>. Accédez à Support (Assistance) &gt; Search Product Support (Assistance recherche produit) et saisissez le nom du modèle.</p> <p>Cet équipement peut fonctionner dans tous les pays de l'Union européenne.</p> <p>En France, toutefois, il ne peut être utilisé qu'à l'intérieur.</p>





Italian	<p>Samsung Electronics dichiara qui di seguito che i requisiti essenziali di questo Climatizzatore sono conformi alle prescrizioni ed alle altre imposizioni ad essi relative che sono contenute nella Direttiva 1999/5/EC.</p> <p>La Dichiarazione Ufficiale di Conformità è scaricabile dal sito web <a href="http://www.samsung.com">http://www.samsung.com</a>, entrando in Support o&gt; Supporto Ricerca Prodotti e digitandovi il modello dell'apparecchio.</p> <p>Questo dispositivo funziona in tutti i Paesi dell'UE.</p> <p>In Francia, questo dispositivo può essere utilizzato solo al chiuso.</p>
Latvian	<p>Ar šo Samsung Electronics deklarē, ka šis gaisa kondicionieris atbilst visām pamatprasībām un attiecīgajiem nosacījumiem, kas izklāstīti Direktīvā 1999/5/EK.</p> <p>Oficiālo atbilstības deklarāciju var atrast vietnē <a href="http://www.samsung.com">http://www.samsung.com</a>, izvēloties Atbalsts &gt; Atrast izstrādājuma atbalstu un ievadot modeļa nosaukumu.</p> <p>Šo aprīkojumu var lietot visās ES valstīs.</p> <p>Francijā šo aprīkojumu drīkst lietot tikai telpās.</p>
Lithuanian	<p>„Samsung Electronics“ patvirtina, kad šis oro kondicionierius atitinka pagrindinius Direktyvos 1999/5/EB reikalavimus ir kitas atitinkamas nuostatas.</p> <p>Oficialią atitikties deklaraciją galima rasti adresu <a href="http://www.samsung.com">http://www.samsung.com</a> (eikite į „Support“ &gt; „Search Product Support“ ir įveskite modelio pavadinimą).</p> <p>Šią įrangą galima naudoti visose ES šalyse.</p> <p>Prancūzijoje šią įrangą galima naudoti tik patalpose.</p>
Dutch	<p>Hierbij verklaart Samsung Electronics dat deze airconditioner voldoet aan de essentiële vereisten en overige relevante bepalingen van Richtlijn 1999/5/EG.</p> <p>De officiële conformiteitsverklaring kunt u vinden op <a href="http://www.samsung.com">http://www.samsung.com</a>. Ga naar Support (Ondersteuning) &gt; Search Product Supporten (Productondersteuning zoeken) en geef de naam van het model op.</p> <p>Deze apparatuur mag in alle EU-landen worden gebruikt.</p> <p>In Frankrijk mag deze apparatuur alleen binnenshuis worden gebruikt.</p>
Hungarian	<p>A Samsung Electronics ezennel kijelenti, hogy ez a Légkondicionáló berendezés megfelel az 1999/5/EK irányelv alapvető követelményeinek és egyéb rendelkezéseinek.</p> <p>A hivatalos Megfelelőségi nyilatkozat a <a href="http://www.samsung.com">http://www.samsung.com</a> honlapon olvasható. Ehhez lépjen a Támogatás oldalra, és a Keres mezőben adja meg a modellszámot.</p> <p>Ez a berendezés az Európai Unió minden országában üzemeltethető.</p> <p>Franciaországban ez a készülék csak beltérben használható.</p>
Polish	<p>Firma Samsung Electronics oświadcza, że niniejszy klimatyzator spełnia najważniejsze wymagania i inne odpowiednie postanowienia Dyrektywy 1999/5/WE.</p> <p>Oficjalna Deklaracja zgodności znajduje się na stronie <a href="http://www.samsung.com">http://www.samsung.com</a>. Należy kliknąć kolejno Pomoc &gt; Wyszukaj pomoc dla produktu i wprowadzić nazwę modelu.</p> <p>Z tego urządzenia można korzystać we wszystkich krajach Unii Europejskiej.</p> <p>We Francji z tego urządzenia można korzystać wewnątrz budynków.</p>
Portuguese	<p>A Samsung Electronics declara que este aparelho de ar condicionado está em conformidade com os requisitos essenciais e outras provisões relevantes da Directiva 1999/5/CE.</p> <p>A Declaração de Conformidade oficial pode ser consultada em <a href="http://www.samsung.com">http://www.samsung.com</a>. Para aceder, vá para Support &gt; Search Product Support e escreva o nome do modelo.</p> <p>Esse equipamento pode ser utilizado em todos os países da EU.</p> <p>Na França, esse equipamento só poderá ser utilizado em espaços interiores.</p>
Slovenian	<p>Samsung Electronics izjavlja, da ta klimatska naprava izpolnjuje bistvene zahteve in druga ustrezna določila Direktive 1999/5/ES.</p> <p>Ta uradna izjava o skladnosti je na voljo na <a href="http://www.samsung.com">http://www.samsung.com</a>. Pomaknite se na Support (Podpora) &gt; Search Product Support (Iskanje po podpori za izdelke) in vnesite ime modela.</p> <p>To opremo lahko uporabljate v vseh državah EU.</p> <p>V Franciji lahko to opremo uporabljate le znotraj.</p>





# Declaration of Conformity

Slovak	<p>Spoločnosť Samsung Electronics týmto vyhlasuje, že táto klimatizácia je v súlade s nevyhnutnými požiadavkami a príslušnými ustanoveniami smernice 1999/5/ES.</p> <p>Oficiálne vyhlásenie o zhode nájdete na lokalite <a href="http://www.samsung.com">http://www.samsung.com</a>, prejdite na možnosť Podpora &gt; Vyhladať podporu k produktu a zadajte názov modelu.</p> <p>Toto zariadenie môže byť v prevádzke vo všetkých európskych krajinách.</p> <p>Vo Francúzsku môžete toto zariadenie používať iba vo vnútri.</p>
Finnish	<p>Samsung vakuuttaa, että tämä ilmastointilaitte on direktiivin 1999/5/EY oleellisten vaatimusten ja muiden määräysten mukainen.</p> <p>Virallinen vaatimustenmukaisuusvakuutus on osoitteessa <a href="http://www.samsung.com">http://www.samsung.com</a>. Siirry kohtaan Support (Tuki) &gt; Search Product Support (Etsi tuotetukea), ja anna laitteen mallin nimi.</p> <p>Tätä laitetta voidaan käyttää kaikissa Euroopan unionin maissa.</p> <p>Ranskassa tätä laitetta voidaan käyttää vain sisätiloissa.</p>
Swedish	<p>Härmed intygar Samsung Electronics att denna luftkonditionering uppfyller de väsentliga kraven och övriga relevanta bestämmelser som framgår av direktiv 1999/5/EG.</p> <p>Den officiella försäkran om överensstämmelse finns på <a href="http://www.samsung.com">http://www.samsung.com</a>, under Support &gt; Search Product Support (Sök i produktsupport) och ange modellnamnet.</p> <p>Den här utrustningen får användas i alla EU-länder.</p> <p>Den här utrustningen får endast användas inomhus i Frankrike.</p>
Bulgarian	<p>С настоящето Samsung Electronics декларира, че този климатик е в съответствие с основните изисквания и други приложими разпоредби на Директива 1999/5/ЕС.</p> <p>Официалната Декларация за съответствие може да се намери на <a href="http://www.samsung.com">http://www.samsung.com</a>, отидете на Поддръжка &gt; Намери и въведете името на модела.</p> <p>С това оборудване може да се работи във всички държави от ЕС.</p> <p>Във Франция това оборудване може да се използва само на закрито.</p>
Romanian	<p>Prin prezenta, Samsung Electronics declară că acest aparat de aer condiționat este în conformitate cu cerințele esențiale și alte prevederi relevante ale Directivei 1999/5/CE.</p> <p>Declarația oficială de conformitate poate fi găsită pe site-ul <a href="http://www.samsung.com">http://www.samsung.com</a>, accesând Support (Suport) &gt; Search Product Support (Găsiți) și introducând numele de model.</p> <p>Acest echipament poate fi folosit în toate statele UE.</p> <p>În Franța, acest echipament poate fi folosit doar în interior.</p>
Norwegian	<p>Samsung erklærer herved at denne luftkondisjoneringsenheten er i samsvar med de avgjørende kravene og andre relevante vilkår i direktiv 1999/5/EC.</p> <p>Den offisielle samsvarserklæringen er å finne på <a href="http://www.samsung.com">http://www.samsung.com</a>. Gå til Support &gt; Search Product Support (Søk etter produktsupport), og skriv inn modellnavnet.</p> <p>Dette utstyret kan brukes i alle EU-land.</p> <p>I Frankrike kan dette utstyret kun brukes innendørs.</p>
Turkish	<p>Bu belge ile Samsung Electronics, bu Klimanın, 1999/5/EC Yönetmeliğinin temel gerekliliklerine ve ilgili hükümlerine uygun olduğunu beyan eder.</p> <p>Uygunluğun resmi Deklarasyonu <a href="http://www.samsung.com">http://www.samsung.com</a> sitesinde bulunabilir, Destek &gt; Ürün Desteği Ara bölümüne giderek model adını yazınız.</p> <p>Bu cihaz tüm AB ülkelerinde kullanılabilir.</p> <p>Fransa'da bu cihaz sadece iç mekanlarda kullanılabilir.</p>
Russian	<p>Настоящим компания Samsung Electronics заявляет, что данный кондиционер воздуха соответствует основным требованиям и другим соответствующим положениям Директивы 1999/5/ЕС.</p> <p>С официальной декларацией о соответствии можно ознакомиться на сайте <a href="http://www.samsung.com">http://www.samsung.com</a>, откройте "Поддержка" &gt; "Найти свой продукт" и введите название модели.</p> <p>Данное оборудование можно использовать без ограничений в большинстве стран ЕС.</p> <p>но нельзя использовать вне помещения во Франции.</p>





Ukrainian	<p>Компанія Samsung Electronics стверджує, що цей кондиціонер відповідає важливим вимогам та іншим відповідним положенням Директиви 1999/5/EC.</p> <p>Офіційну Декларацію щодо сумісності можна прочитати за адресою <a href="http://www.samsung.com">http://www.samsung.com</a>; перейдіть до пункту «Підтримка &gt; Пошук з підтримки продукту» і введіть номер моделі.</p> <p>Це обладнання можна використовувати в усіх країнах ЄС.</p> <p>У Франції це обладнання можна використовувати лише на вулиці.</p>
Serbian	<p>Ovim putem kompanija Samsung Electronics izjavljuje da je ovaj klima uređaj usklađen sa osnovnim zahtevima i drugim primenljivim odredbama direktive 1999/5/EC.</p> <p>Zvanična izjava o usklađenosti dostupna je na Web lokaciji <a href="http://www.samsung.com">http://www.samsung.com</a>, izaberite Podrška &gt; Pretraga podrške za proizvode i unesite naziv modela.</p> <p>Ova oprema se može koristiti u svim zemljama EU.</p> <p>U Francuskoj ova oprema može da se koristi samo unutar prostorija.</p>
Croatian	<p>Samsung Electronics ovime izjavljuje da je ovaj klima uređaj usklađen s osnovnim zahtjevima i drugim relevantnim odredbama Direktive 1999/5/EZ.</p> <p>Službenu Izjavu o sukladnosti možete pronaći na adresi <a href="http://www.samsung.com">http://www.samsung.com</a>: prijedite na Podrška &gt; Pronađite podršku za proizvod i zatim unesite naziv modela.</p> <p>Ova oprema može se koristiti u svim državama članicama EU.</p> <p>U Francuskoj se ovaj uređaj može koristiti samo u zatvorenom prostoru.</p>



MEMO

---







ENGLISH



MEMO

---





## Declaration of Conformity

### Product details

For the following

Product : Multi WiFi-KIT

Model(s) : MIM-H03N



### Declaration & Applicable standards

We hereby declare under our sole responsibility that the product above is in compliance with the essential requirements of the R&TTE Directive (1995/5/EC) by application of

EN 60950-1:2006 +A11:2009 +A1:2010 +A12:2011+A2:2013

EN 300 328 v.1.8.1

EN 301 489-1 v.1.9.2

EN 301 489-17 v.2.2.1

EN 62311:2008

and the Directive (2011/65/EU) on the restriction of the use of certain hazardous substances in electrical and electronic equipment by application of EN 50581:2012.

### Representative in the EU

Samsung Electronics Euro QA Lab.  
Blackbushe Business Park  
Saxony Way, Yateley, Hampshire  
GU46 6GG, UK

Year of affixing CE marking : 2015

15 May, 2015

(Place and date of issue)

Stephen Colclough / EU Representative

(Name and signature of authorized person)

\* This is not the address of Samsung Service Centre. For the address or the phone number of Samsung Service Centre, see the warranty card or contact the retailer where you purchased your product.



**SAMSUNG**



W011 15

**Smart air conditioner APP can be altered without notice for quality improvement and also be deleted depending on the circumstances of manufacturing firms.**

