

SAMSUNG

LED TV

User Manual

SERIES 5

UA32K5T00AR UA40K5T00AR UA43K5T00AR UA49K5T00AR UA55K5T00AR

Figures and illustrations in this User Manual are provided for reference only and may differ from actual product appearance. Product design and specifications may be changed without notice.

Still image warning

Avoid displaying still images (like jpeg picture files) or still image element (like TV programme logo, panorama or 4:3 image format, stock or news bar at screen bottom etc.) on the screen. Constant displaying of still picture can cause ghosting of LED screen, which will affect image quality. To reduce risk of this effect, please follow below recommendation:

- Avoid displaying the same TV channel for long periods.
- Always try to display any image on full screen, use TV set picture format menu for best possible match.
- Reduce brightness and contrast values to minimum required to achieve desired picture quality, exceeded values may speed up the burnout process.
- Frequently use all TV features designed to reduce image retention and screen burnout, refer to proper user manual section for details.

For personal and non-commercial use only.
Usage is subject to following the guidelines in the User Manual and may not be available in all regions.

Contact SAMSUNG WORLD WIDE

If you have any questions or comments relating to Samsung products, please contact the SAMSUNG customer care centre.

Country	Customer Care Centre	Web Site
Vietnam	1800 588 889	www.samsung.com/vn/support
Thailand	0-2689-3232, 1800-29-3232	www.samsung.com/th/support
Myanmar	+95-1-2399-888	www.samsung.com/th/support
Malaysia	1800-88-9999, 603-77137477 (Overseas contact)	www.samsung.com/my/support
Philippines	1-800-10-726-7864 (PLDT Toll Free), 1-800-8-726-7864 (Globe Landline and Mobile), 02-422-2111 (Standard Landline)	www.samsung.com/ph/support
India	1800 3000 8282 - Toll Free, 1800 266 8282 - Toll Free	www.samsung.com/in/support
Bangladesh	0961-2300300, 0800-0300300 (Toll Free)	www.samsung.com/in/support
Sri Lanka	0117540540, 0115900000	www.samsung.com/support
Egypt	080050-7267864, 16580	www.samsung.com/eg/support

ALGERIA	3004 (Toll Free)	www.samsung.com/n_/_africa/_support
IRAN	021-8255 (CE)	www.samsung.com/iran/_support
Saudi Arabia	800 247 3457 (800 247 HELPI)	www.samsung.com/sa/_home
PAKISTAN	0800-Samsung (72678)	www.samsung.com/pk/support
TUNISIA	800 1000 12	www.samsung.com/n_/_africa/_support
U.A.E	800-SAMSUNG (800 - 726 7864)	
OMAN	800-SAMSUNG (800 - 726 7864)	www.samsung.com/ae/_support
KUWAIT	183-CALL (183-2255)	www.samsung.com/ae/_a/_support
BAHRAIN	8000-GSAM (8000-4726)	support (Arabic)
QATAR	800-CALL (800-2255)	
JORDAN	0800-22273, 062 5777444	www.samsung.com/levant
SYRIA	961 1484 999	
LEBANON	0800-726-7864	
MOROCCO	080100 22 55	www.samsung.com/n_/_africa/_support
SOUTH AFRICA	0860 SAMSUNG (726 7864)	
Botswana	08007260000	
NAMIBIA	08 197 267 864	
ZAMBIA	0211 350370	www.samsung.com/support
REUNION	0262 50 88 80	
ANGOLA	917 267 864	
Mozambique	847267864 / 827267864	
NIGERIA	0800-726-7864	
GHANA	0800-10077, 0302-200077	www.samsung.com/africa/_en/_support
COTE D'IVOIRE	8000 0077	
SENEGAL	800-00-0077	www.samsung.com/africa/_fr/_support
CAMEROON	67095-0077	
KEWIK	0800-545 545	
UGANDA	0800 300 300	
TANZANIA	0685 889 900	
RWANDA	9999	www.samsung.com/support
BURUNDI	200	
DRC	499999	
SUDAN	1969	



- 1 -

Changing the Input Source

Source List

Use to select TV or other external input sources such as DVD / Blu-ray players / cable box / STB satellite receiver connected to the TV.

1. Press the SOURCE button.
2. Select a desired external input source.
 - TV / AV / Component / HDMI / HDMI2 / DVIYou can only choose external devices that are connected to the TV. In the Source List, connected inputs will be highlighted.

Remote Control

- ☞ This remote control has Braille points on the Power, Channel, Volume, and Enter buttons and can be used by visually impaired persons.
- ☞ Depending on the country and model.

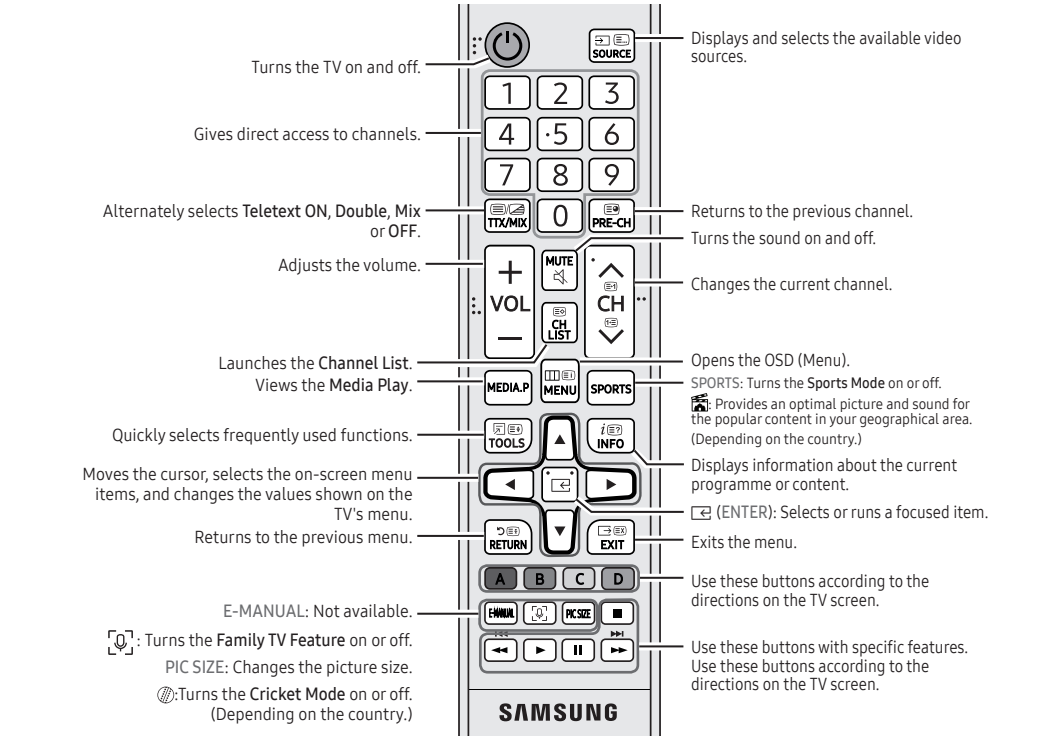

Installing batteries (Battery size: AAA)

- ☞ Use the remote control within 7 m from TV.
- ☞ Bright light may affect the performance of the remote control. Avoid using nearby special fluorescent light or neon signs.
- ☞ The colour and shape may vary depending on the model.

- 5 -

Important Safety Instructions

Warning! Important Safety Instructions

(Please read the Safety Instructions before using your TV.)

CAUTION

RISK OF ELECTRIC SHOCK DO NOT OPEN

CAUTION: TO REDUCE THE RISK OF ELECTRIC SHOCK, DO NOT REMOVE COVER (OR BACK). THERE ARE NO USER SERVICEABLE PARTS INSIDE. REFER ALL SERVICING TO QUALIFIED PERSONNEL.

This symbol indicates that high voltage is present inside. It is dangerous to make any kind of contact with any internal part of this product.

This symbol indicates that this product has included important literature concerning operation and maintenance.

Class II product. This symbol indicates that it does not require a safety connection to electrical earth (ground).

AC voltage: This symbol indicates that the rated voltage marked with the symbol is AC voltage.

DC voltage: This symbol indicates that the rated voltage marked with the symbol is DC voltage.

Caution, Consult Instructions for use: This symbol instructs the user to consult the user manual for further safety related information.

The slots and openings in the cabinet and in the back or bottom are provided for necessary ventilation. To ensure reliable operation of this apparatus and to protect it from overheating, these slots and openings must never be blocked or covered.

Do not place this apparatus in a confined space, such as a bookcase or built-in cabinet, unless proper ventilation is provided.

Do not place this apparatus near a radiator or heat register, or where it is exposed to direct sunlight.

Do not place vessels (vases etc.) containing water on this apparatus, as this can result in a fire or electric shock.

Do not expose this apparatus to rain or place it near water (near a bathtub, washbowl, kitchen sink, or laundry tub, in a wet basement, or near a swimming pool etc.). If this apparatus accidentally gets wet, unplug it and contact an authorised dealer immediately.

This apparatus uses batteries. In your community, there might be environmental regulations that require you to dispose of these batteries properly. Please contact your local authorities for disposal or recycling information.

Do not overload wall outlets, extension cords or adaptors beyond their capacity, since this can result in a fire or electric shock.

Power-supply cords should be placed so that they are not likely to be walked on or pinched by items placed upon or against them. Pay particular attention to cords at the plug end, at wall outlets, and at the point where they exit from the appliance.

To protect this apparatus from a lightning storm, or when left unattended and unused for long periods of time, unplug it from the wall outlet and disconnect the antenna or cable system. This will prevent damage to the set due to lightning and power line surges.

Before connecting the AC power cord to the DC adaptor outlet, make sure that the voltage designation of the DC adaptor corresponds to the local electrical supply. Never insert anything metallic into the open parts of this apparatus. This may cause a danger of electric shock.

To avoid electric shock, never touch the inside of this apparatus. Only a qualified technician should open this apparatus.

Be sure to plug in the power cord until it is firmly seated. When unplugging the power cord from a wall outlet, always pull on the power cord's plug. Never unplug it by pulling on the power cord. Do not touch the power cord with wet hands.

If this apparatus does not operate normally - in particular, if there are any unusual sounds or smells coming from it - unplug it immediately and contact an authorised dealer or service centre.

Be sure to pull the power plug out of the outlet if the TV is to remain unused or if you are to leave the house for an extended period of time (especially when children, elderly or disabled people will be left alone in the house).

Accumulated dust can cause an electric shock, an electric leakage, or a fire by causing the power cord to generate sparks and heat or by causing the insulation to deteriorate.

Be sure to contact an authorised service centre for information if you intend to install your TV in a location with heavy dust, high or low temperatures, high humidity, chemical substances, or where it will operate 24 hours a day such as in an aerial port, a train station, etc. Failure to do so may lead to serious damage to your TV.

Use only a properly grounded plug and wall outlet.

An improper ground may cause electric shock or equipment damage. (Class I Equipment only.)

To turn off this apparatus completely, disconnect it from the wall outlet. Be sure to have the wall outlet and power plug readily accessible.

Store the accessories (battery, etc.) in a location safely out of the reach of children.

Do not drop or strike the product. If the product is damaged, disconnect the power cord and contact a service centre.

To clean this apparatus, unplug the power cord from the wall outlet and wipe the product with a soft, dry cloth. Do not use any chemicals such as wax, benzene, alcohol, thinners, insecticide, aerial fresheners, lubricants, or detergents. These chemicals can damage the appearance of the TV or erase the printing on the product.

Do not expose this apparatus to dripping or splashing.

Do not dispose of batteries in a fire.

Do not short-circuit, disassemble, or overheat the batteries.

There is danger of an explosion if you replace the batteries used in the remote with the wrong type of battery. Replace only with the same or equivalent type.

When using the AC plug that is a dedicated adapter plug provided from Samsung, pay attention to the following:

Insert the AC plug into the adapter until a "click" sound is heard.

Never remove the AC plug after insertion. (Cannot be removed)

Do not insert only the AC plug into an outlet.

Do not use the provided AC plug with other devices.

Do not insert plugs other than the provided AC plug into the adapter.

When removing the adapter from an outlet, pull its body vertically.

Do not insert the adapter into the outlet on the ceiling.

Do not drop objects or apply shock on the adapter.

Do not rotate it over the range indicated on the adapter.

It may cause electric shock or fire.

Remove the vinyl cover of the adapter before using the adapter. Otherwise, this may result fire.

To reduce the risk of fire or electric shock, do not expose this apparatus to rain or moisture.

Apparatus shall not be exposed to dripping or splashing and no objects filled with liquids, such as vases, shall not be placed on the apparatus.

WARNING: FOR INDOOR USE ONLY

- 2 -

Channel Menu

Seeing Channels

Channel List

Add, delete or set favourite channels and use the programme guide for analogue broadcasts. Select a channel in the All Channels menu, Added Channels, Favourite Channels or Programmed screen by pressing the ▲/▼ buttons, and pressing the ENTER button. Then you can watch the selected channel.

- ☞ All Channels: Shows all currently available channels.
- ☞ Added Channels: Shows all added channels.
- ☞ Favourite Channels: Shows all favourite channels.
- ☞ Programmed: Shows all currently reserved programmes.
- ☞ Using the remote control buttons with the Channel List.
- ☞ Green (Zoom): Enlarges or shrinks a channel number.
- ☞ Yellow (Select): Selects multiple channel lists. Select desired channels and press the Yellow button to set all the selected channels at the same time. The ✓ mark appears to the left of the selected channels.
- ☞ (E) (Tools): Displays the Channel List option menu. (The Options menu may differ depending on the situation.)

Channel Status Display Icons

Icons	Operations
Power	A channel selected.
Source	A channel set as a favourite.
Reserved	A reserved programme.
Programmed	A programme currently being broadcast.

Retuning Channels

Area

You can change the desired area.

Auto Store

(Depending on the country)
Scans for a channel automatically and stores in the TV.

Manual Store

Scans for a channel manually and stores in the TV.
SPORTS: Turns the Sports Mode on or off.
Provides an optimal picture and sound for the popular content in your geographical area. (Depending on the country.)

☞ Programme, Colour System, Sound System, Channel, Search, Store: If there is an abnormal sound or no sound, reset the sound standard required.

Channel List Option Menu

Set each channel using the Channel List menu options. Option menu items may differ depending on the channel status.

- Add / Delete: Delete or add a channel to display the channels you want.
- All deleted channels will be shown on the All Channels menu.
- A grey-coloured channel indicates the channel has been deleted.
- The Add menu only appears for deleted channels.
- Delete a channel from the Added Channels or Favourite Channels menu in the same manner.

- Add to Favourite / Delete from Favourite: Set channels you watch frequently as Favourites.
- Timer Viewing: You can set a desired channel to be displayed automatically at the set time; even when you are watching another channel. Set the current time first to use this function.
- Only memorised channels can be reserved.
- Reserved programmes will be displayed in the Programmed menu.
- Edit Channel Name: (analogue channels only) Assign your own channel name.
- Select All: Select all the channels in the channel list.
- Deselect All: Deselect all the selected channels.
- Auto Store: Scans for a channel automatically and stores in the TV.

- ☞ Programmed (In Channel List)
- ☞ You can view, modify or delete a show you have reserved to watch.
- ☞ Change Info: Change a show you have reserved to watch.
- ☞ Cancel Schedule: Cancel a show you have reserved to watch.
- ☞ Information: Display a show you have reserved to watch. (You can also change the reservation information.)

- Select All / Deselect All: You can select or deselect all channels in the channel list.

Channel Mode

Change the channel mode directly between Added Channels and Favourite Channels.

- The Favourite Channels is enabled only when you set Add to Favourite.

Fine Tune

If the reception is clear, you do not have to fine tune the channel, as this is done automatically during the search and store operation. If the signal is weak or distorted, fine tune the channel manually.

- ☞ Fine tuned channels that have been saved are marked with an asterisk (*) on the right-hand side of the channel number in the channel banner.
- ☞ This is available for analogue broadcasts only.

Picture Menu

Mode

- ☞ Select your preferred picture type.
- Dynamic: Suitable for a bright room.
- Standard: Suitable for a normal environment.
- Movie: Suitable for watching movies in a dark room.

Backlight / Contrast / Brightness / Sharpness / Colour / Tint (G/R)

Your television has several setting options for picture quality control.

- ☞ In analogue TV, AV modes of the PAL system, the Tint (G/R) function is not available.
- ☞ When connecting a PC, you can only make changes to Backlight, Contrast, Brightness and Sharpness.
- ☞ Settings can be adjusted and stored for each external device connected to the TV.
- ☞ Lowering picture brightness reduces power consumption.

Picture Options

- Colour Tone: Select the colour temperature.
- ☞ Warm will be deactivated when the picture mode is Dynamic.
- Size: Your cable box/satellite receiver may have its own set of screen sizes as well. However, we highly recommend you use 16:9 mode most of the time.
- 16:9: Sets the picture to 16:9 wide mode.
- Wide Zoom: Magnifies the picture size more than 4:3.
- 4:3: Sets the picture to basic (4:3) mode.
- Zoom: Zoom out 16:9 wide mode vertically to fit the screen size.
- ☞ Do not watch in 4:3 format for a long time. Traces of borders displayed on the left, right and centre of the screen may cause image retention (screen burn) which are not covered by the warranty.
- Screen Fit: Displays the full image without any cut-off when the HDMI (720p/1080i/1080p) signals are inputted.
- Custom: Magnifies or shrinks 16:9 pictures vertically and/or horizontally. A magnified or shrunk picture can be moved left, right, up, and down.

NOTE

- ☞ Depending on the input source, the picture size options may vary.
- ☞ The available items may differ depending on the selected mode.
- ☞ Settings can be adjusted and stored for each external device connected to an input on the TV.
- ☞ Digital Clean View: (Auto / Off / Low / Medium / High) If the broadcast signal received by your TV is weak, you can activate the Digital Clean View feature to reduce any static and ghosting that may appear on the screen.
- ☞ When the signal is weak, try other options until the best picture is displayed.
- ☞ HDMI Black Level: Selects the black level on the screen to adjust the screen depth.
- ☞ Available only in HDMI mode (RGB signals).
- ☞ Film Mode: (Auto / Off) Sets the TV to automatically sense and process film signals from all sources and adjust the picture for optimum quality.
- ☞ Available in TV mode, AV, COMPONENT (480i / 1080i) and HDMI (480i / 1080i).
- ☞ Motion Lighting: Reduce power consumption by brightness control adapted motion.
- ☞ Only available in Standard mode.
- ☞ Analogue Clean View: Reduces diagonal noise in picture caused by the crosstalk of signals.

WARNING - TO PREVENT THE SPREAD OF FIRE, KEEP CANDLES OR OTHER ITEMS WITH OPEN FLAMES AWAY FROM THIS PRODUCT AT ALL TIMES.

Getting Started

Accessories

- Remote Control & Batteries (AAA x 2)
- User Manual
- AC PLUG-CONVERSION (Depending on the country and model)
- Regulatory Guide / Warranty Card (Not available in some locations)
- Power Cord (Depending on the country and model)

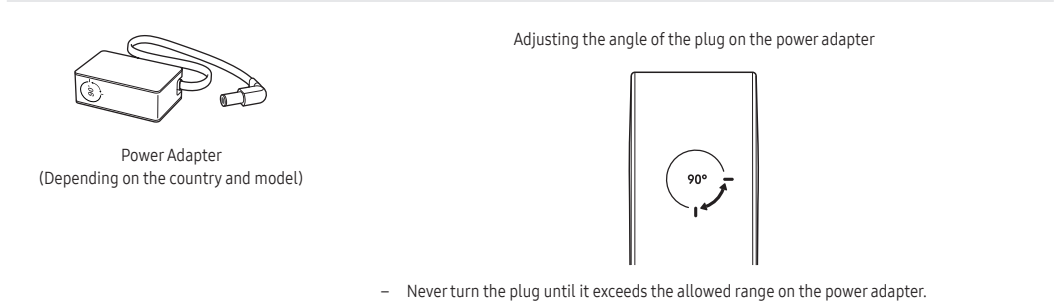

Input Cables (Sold Separately)

- Composite (AV)
- Coaxial (RF)
- HDMI-DVI
- Component
- HDMI

TV Controller (Panel Key)

You can turn on the TV with the TV Controller button at the bottom of the TV, and then use the Control menu. The Control menu appears when the button is pressed while the TV is On. For more information about its usage, refer to the figure below.

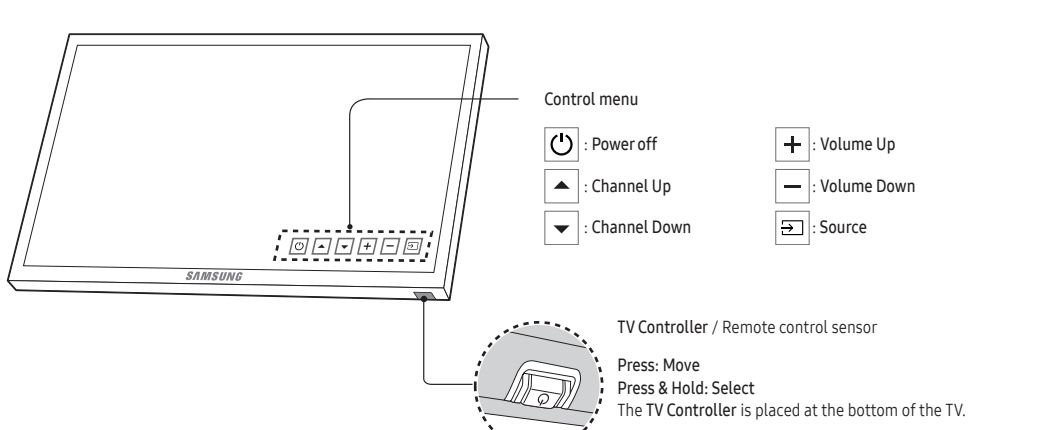

Plug & Play (Initial Setup)

When you turn the TV on for the first time, a sequence of screens and on-screen prompts will assist you in configuring the TV's basic settings. Plug the power cord into a wall outlet, and then press the POWER button to turn on the TV. Set the initial setup following instructions that the TV guides.

- ☞ If you are not using a cable box or satellite box, make you sure have connected the TV to an Aerial or cable connection before you turn on the TV.
- ☞ Connecting the Power cord and antenna. (refer to 'Connections')

Picture Off

The screen is turned off but the sound remains on. Press any button except the power key or volume button to turn on the screen.

Picture Reset

Resets your current picture mode to its default settings.

- Reset Picture Mode: Returns all picture values in the currently.

Sound Menu

Mode

- Standard: Selects the normal sound mode.
- 100Hz / 300Hz / 144z / 3KHz / 10KHz (Bandwidth Adjustment): Adjusts the level of specific bandwidth frequencies.
- Movie: Provides the best sound for movies.
- Clear Voice: Emphasises voices over other sounds.

Equalizer

(Standard sound mode only)

- Balance: Adjusts the balance between the right and left speaker.
- 100Hz / 300Hz / 144z / 3KHz / 10KHz (Bandwidth Adjustment): Adjusts the level of specific bandwidth frequencies.
- Reset: Resets the Equalizer to its default settings.

Auto Volume

Because each broadcasting station has its own signal conditions, the volume may fluctuate each time channel is changed. This feature lets you automatically adjust the volume of the desired channel by lowering the sound output when the modulation signal is high or by raising the sound output when the modulation signal is low.

Speaker Select

A sound echo may occur due to a difference in decoding speed between the main speaker and the audio receiver. In this case, set the TV to External Speaker.

- ☞ When you set Speaker Select to External Speaker, the TV's speakers are turned off. You will hear sound through the external speakers only.
- ☞ When you set Speaker Select to TV Speaker, both the TV's speakers and the external speakers are on. You will hear sound through both.
- ☞ When Speaker Select is set to External Speaker, the volume and MUTE buttons will not operate and the sound settings will be limited.
- ☞ If there is no video signal, both speakers will be mute.

TV Installation Type

This is the feature that set sound filter to fit into the installation condition of TV. Adjust TV Sound to suit either stand or Wall Mount installation.

HDMI Audio Format

Sets the audio input signal format suitable for the external device connected to the TV's HDMI port.

Sound Reset

- Reset All: Reset all settings to the factory defaults.

Selecting the Sound Mode

When you set to Dual I-Dual II, the current sound mode is displayed on the screen.

	Audio Type	Dual I-II	Default
A2 Stereo	Stereo	Stereo → Mono	Automatic change
	Dual	Dual I → Dual II	Dual I
NICAM Stereo	Mono	Mono	Automatic change
	Stereo	Mono → Stereo	Dual I
	Dual	Mono → Dual I	Dual I

- ☞ If the stereo signal is weak and an automatic switching, occurs, then switch to the mono.
- ☞ Only activated in stereo sound signal.
- ☞ This function is available for all input sources.
- ☞ Energy Saving: This adjusts the brightness of the TV in order to reduce power consumption.
- ☞ Eco Sensor (Depending on the country and model): To enhance your power savings, the picture settings will automatically adapt to the light in the room.
- ☞ If you adjust the Backlight, the Eco Sensor will be set to Off.
- ☞ Min. Backlight: When Eco Sensor is On, the minimum screen brightness can be adjusted manually.
- ☞ If Eco Sensor is On, the display brightness may change (become slightly darker or brighter) depending on the surrounding light intensity.
- ☞ No Signal Power Off: To avoid unnecessary energy consumption, set how long you want the TV to remain on if it's not receiving a signal.
- ☞ Disabled when the PC is in power saving mode.
- ☞ Auto Power Off: The TV will be automatically turned off when no user operation is received for 4 hours.
- ☞ If the Auto Power Off option is set to Off, the TV will stay on even if no operations are performed on the TV.

- 7 -

Connections

- For better picture and audio quality, connect to a digital device using an HDMI cable.
- The picture may not display normally (if at all) or the audio may not work if an external device that uses an older version of HDMI mode is connected to the TV. If such a problem occurs, ask the manufacturer of the external device to upgrade the HDMI version and, if out of date, request an upgrade.
- Be sure to purchase a certified HDMI cable. Otherwise, the picture may not display or a connection error may occur.
- PC / DVI AUDIO IN input is not supported.
- For HDMI/DVI cable connection, you must use the HDMI INPUT 2 (DVI) port.
- Connecting through the HDMI cable may not be supported depending on the PC.
- If an HDMI to DVI cable is connected to the HDMI INPUT 2 (DVI) port, the audio does not work.
- For Set-top box connection using HDMI cable, we highly recommend you to connect the HDMI INPUT1 (STB) port.

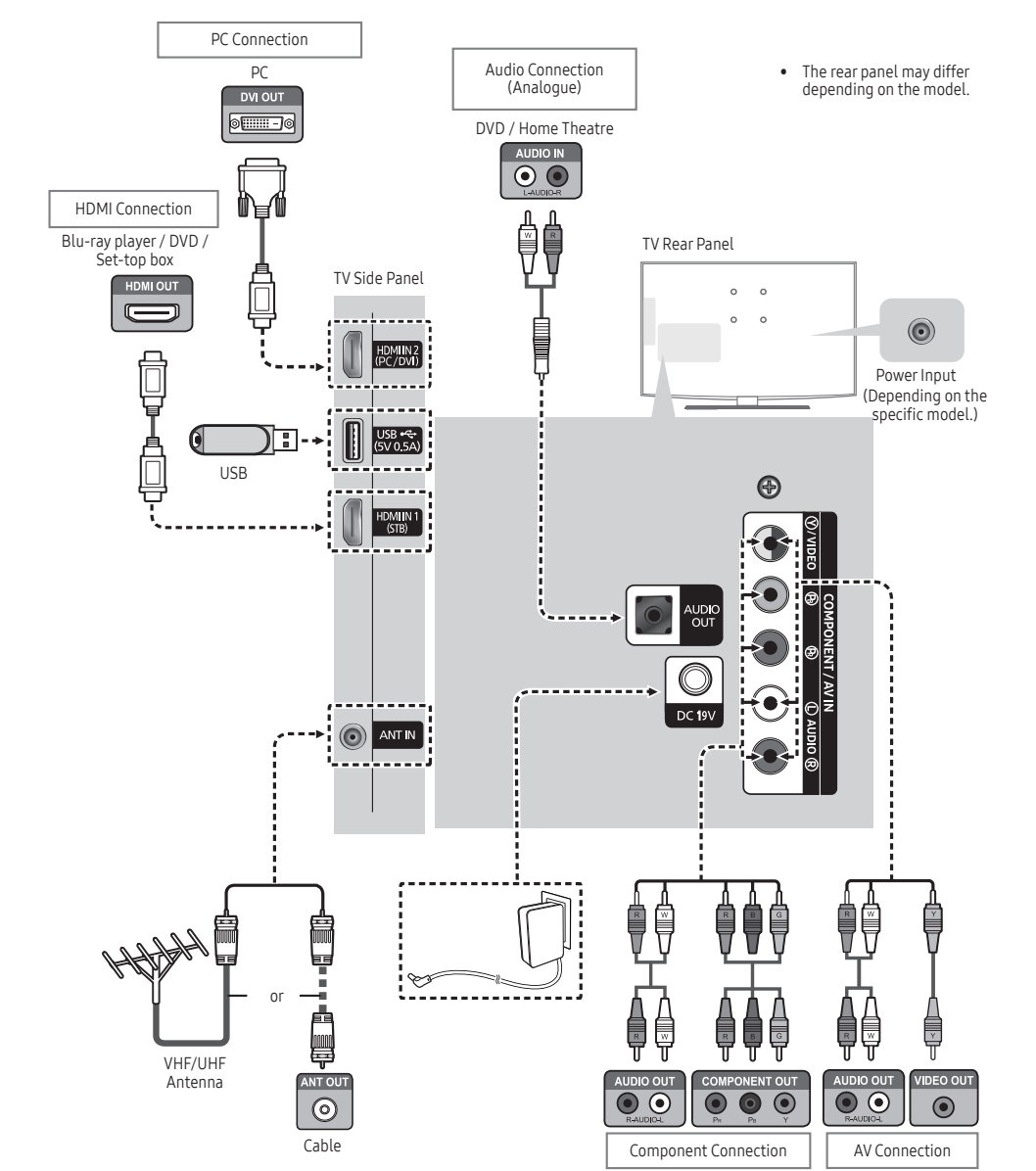

Auto Protection Time

If the screen remains idle with a still image for a certain period of time (Off, 2 hours, 4 hours, 8 hours, 10 hours) defined by the user, the screen saver is activated to prevent the formation of ghost images on the screen.

DivX® Video On Demand

Shows the registration code authorised for the TV. If you connect to the DivX web site and register with 10-digit registration code, you can download the VOD activation file. Once you play it using Media Play, the registration is completed.

- ☞ For more information on DivX® VOD, visit <http://vod.divx.com>.

Application Menu

Using the Media Play

Enjoy photos, music and/or movie files saved on a USB Mass Storage Class (MSC) device.

Connecting a USB Device

1. Turn on your TV.
2. Connect a USB device containing photo, music and/or movie files to the USB jack on the side of the TV.
3. When USB is connected to the TV, you can select Media Play.
- ☞ The maximum displayed number of partition is 4.

Using the Media Play Menu

1. Press the MENU button. Press the ▲ or ▼ button to select Application, then press the ENTER button.
2. Press the ▲ or ▼ button to select Media Play (USB), then press the ENTER button.
3. Press the ◀ or ▶ button to select an icon (Videos, Music, Photos), then press the ENTER button.
- ☞ It might not work properly with unlicensed multimedia files.
- ☞ If you want to view detailed information of the file being played, press TOOLS button in the file list, and then select Information.

Need-to-Know List before using Media Play (USB)

- Supported file systems are FAT and NTFS.
- Certain types of USB Digital camera and audio devices may not be compatible with this TV.
- Media Play only supports USB Mass Storage Class (MSC) devices. MSC is a Mass Storage Class Bulk-Only Transport device. Examples of MSC are Thumb drives and Flash Card Readers. Devices should be connected directly to the TV's USB port. Does not support smart devices connected in MTP or PTP protocol.
- If Game Mode is On: Picture Mode is set to Game Mode and Sound Mode is set to Game Mode.

Boot Logo

Displays Samsung logo when the TV is turned on.

Eco Solution

- Energy Saving: This adjusts the brightness of the TV in order to reduce power consumption.
- Eco Sensor (Depending on the country and model): To enhance your power savings, the picture settings will automatically adapt to the light in the room.
- ☞ If you adjust the Backlight, the Eco Sensor will be set to Off.
- ☞ Min. Backlight: When Eco Sensor is On, the minimum screen brightness can be adjusted manually.
- ☞ If Eco Sensor is On, the display brightness may change (become slightly darker or brighter) depending on the surrounding light intensity.
- No Signal Power Off: To avoid unnecessary energy consumption, set how long you want the TV to remain on if it's not receiving a signal.
- ☞ Disabled when the PC is in power saving mode.
- Auto Power Off: The TV will be automatically turned off when no user operation is received for 4 hours.
- ☞ If the Auto Power Off option is set to Off, the TV will stay on even if no operations are performed on the TV.
- Before connecting your device to the TV, please back up your files to prevent them from damage or loss of data. SAMSUNG is not responsible for any data file damage or data loss.
- A USB device that requires high power may not be supported.
- Do not disconnect the USB device while it is loading.
- The higher the resolution of the image, the longer it takes to display on the screen.
- The maximum supported JPEG resolution is 15360 x 8640 pixels.
- If a file is corrupted or the TV does not support the file type, the "Not Supported File Format" message appears.
- If a USB extension cable is used, the USB device may not be recognised or the files on the device may not be read.
- The TV cannot play MP3 files with DRM that have been downloaded from a for-pay site. Digital Rights Management (DRM) is a technology

- Supported Video Formats

File Extension	Container	Video Codec	Resolution	Frame Rate (fps)	Bit Rate (Mbps)	Audio Codec
*.mp4	MP4	DivX 3.11/4.12/5.x/6.0	1920 × 1080	6 ~ 30	20Mbps	MP3 / ADPCM / AAC
		H.264	1920 × 1080	6 ~ 30	20Mbps	
		VC-1	1920 × 1080	6 ~ 30	20Mbps	
		MJPEGL	640 × 480	6 ~ 30	10Mbps	
*.avi *.mkv	AVI MKV	DivX 3.11/4.12/5.x/6.0	1920 × 1080	6 ~ 30	20Mbps	MP3 / AC3 / LPCM / ADPCM / DTS
		MPEG 1/2/4	1920 × 1080	6 ~ 30	20Mbps	
		H.264	1920 × 1080	6 ~ 30	20Mbps	
		MJPEGL	640 × 480	6 ~ 30	10Mbps	
*.asf *.wmv	ASF	DivX 3.11/4.12/5.x/6.0	1920 × 1080	6 ~ 30	20Mbps	MP3 / AC3 / LPCM / ADPCM / WMA / WMA Pro
		MPEG 1/2/4	1920 × 1080	6 ~ 30	20Mbps	
		H.264	1920 × 1080	6 ~ 30	20Mbps	
		MPEG-2 TS	1920 × 1080	6 ~ 30	20Mbps	
*.ts *.mpg *.ip	TS	H.264	1920 × 1080	6 ~ 30	20Mbps	AC3 / AAC / MP3 / DD+
		MPEG1	1920 × 1080	6 ~ 30	20Mbps	
*.dat *.mpg *.mpeg *.vob	PS	MPEG2	1920 × 1080	6 ~ 30	20Mbps	AC3 / MPEG / LPCM / AAC
		H.264	1920 × 1080	6 ~ 30	20Mbps	
*.3gp	3GPP	MPEG 1/2/4	1920 × 1080	6 ~ 30	20Mbps	MP3
*.flv	flash formats	H.264	1920 × 1080	6 ~ 30	20Mbps	MP3
		Sorenson H.263	1920 × 1080	6 ~ 30	20Mbps	

Display Modes (HDMI/DVI Input)

Optimal resolution for 5 series:

- 32inches:1366 x 768@60Hz
- Other inches:1920 x 1080@60Hz

See specification page for full available resolution.

Mode	Resolution	Horizontal Frequency (KHz)	Vertical Frequency (Hz)	Pixel Clock Frequency (MHz)	Sync Polarity (H / V)	1366 × 768	1920 × 1080
IBM	720 × 400	31.469	70.087	28.322	-/+	✓	✓
	640 × 480	35.000	66.667	30.240	-/-	✓	✓
MAC	832 × 624	49.726	74.551	52.284	-/-	✓	✓
	1152 × 870	68.681	75.062	100.000	-/-	✓	✓
VESA DMT	640 × 480	31.469	59.940	25.175	-/-	✓	✓
	640 × 480	37.861	72.809	31.500	-/-	✓	✓
	640 × 480	37.500	75.000	31.500	-/-	✓	✓
	800 × 600	37.879	60.317	40.000	+/+	✓	✓
	800 × 600	48.077	72.188	50.000	+/+	✓	✓
	800 × 600	46.875	75.000	49.500	+/+	✓	✓
	1024 × 768	48.363	60.004	65.000	-/-	✓	✓
	1024 × 768	56.476	70.069	75.000	-/-	✓	✓
	1024 × 768	60.023	75.029	78.750	+/+	✓	✓
	1152 × 864	67.500	75.000	108.000	+/+	✓	✓
	1280 × 720	45.000	60.000	74.250	+/+	✓	✓
	1280 × 800	49.702	59.810	83.500	-/+	✓	✓
VESA DMT	1280 × 1024	63.981	60.020	108.000	+/+	✓	✓
	1280 × 1024	79.976	75.025	135.000	+/+	✓	✓
	1366 × 768	47.712	59.790	85.500	+/+	✓	✓
	1440 × 900	55.935	59.887	106.500	-/+	✓	✓
	1600 × 900RB	60.000	60.000	108.000	+/+	✓	✓
	1680 × 1050	65.290	59.954	146.250	-/+	✓	✓
	1920 × 1080	67.500	60.000	148.500	+/+	✓	✓
	1920 × 1080	67.500	60.000	148.500	+/+	✓	✓
	1920 × 1080	67.500	60.000	148.500	+/+	✓	✓
	1920 × 1080	67.500	60.000	148.500	+/+	✓	✓

Other Restrictions

- Video content will not play, or not play correctly, if there is an error in the content or the container.
- Sound or video may not work if the contents have a standard bit rate / frame rate above the compatible Frame/sec listed in the table.
- If the Index Table is in error, the Seek (Jump) function is not supported.
- The menu may take longer to appear if the video's bit rate exceeds 10Mbps.
- Video content can not be played, if there are many contents in one file.

Troubleshooting

If you have any questions about the TV, first refer to this list. If none of these troubleshooting tips apply, please visit "www.samsung.com," then click on Support, or contact the call centre listed on the back-cover of this manual.

Problem	Possible Solution
Picture Quality	
The TV image does not look as good as it did in the store.	<ul style="list-style-type: none">If you have an analogue cable/set top box, upgrade to a digital set top box. Use HDMI or Component cables to deliver HD (high definition) picture quality.Antenna connection: Try HD stations after performing Auto tuning.<ul style="list-style-type: none">Many HD channels are up scaled from SD (Standard Definition) contents.Adjust the Cable/Set top box video output resolution to 1080i or 720p.Make sure you are watching the TV at the minimum recommended distance based on the size and definition of the signal.
The picture is distorted; macro block error, small block, dots, pixelisation.	<ul style="list-style-type: none">Compression of video contents may cause picture distortion especially in fast moving pictures such as sports and action movies.Low signal level or bad quality can cause picture distortion. This is not a TV issue.Mobile phones used close to the TV (cca up to 1m) may cause noise in picture on analogue and digital TV.
Colour is wrong or missing.	<ul style="list-style-type: none">If you're using a Component connection, make sure the component cables are connected to the correct jacks. Incorrect or loose connections may cause colour problems or a blank screen.
There is poor colour or brightness.	<ul style="list-style-type: none">Adjust the Picture options in the TV menu. (go to Picture Mode / Colour / Brightness / Sharpness)Try resetting the picture to view the default picture settings. (go to MENU - Picture - Picture Reset)
There is a dotted line on the edge of the screen.	<ul style="list-style-type: none">If the picture size is set to Screen Fit, change it to 16:9.Change cable/satellite box resolution.
The picture is black and white.	<ul style="list-style-type: none">If you are using an AV composite input, connect the video cable (yellow) to the Green jack of component input 1 on the TV.
When changing channels, the picture freezes or is distorted or delayed.	<ul style="list-style-type: none">If connected with a cable box, please try to reset the cable box. Reconnect the AC cord and wait until the cable box reboots. It may take up to 20 minutes.Set the output resolution of the cable box to 1080i or 720p.
Sound Quality	
There is no sound or the sound is too low at maximum volume.	<ul style="list-style-type: none">Please check the volume of external device connected to your TV.
The picture is good but there is no sound.	<ul style="list-style-type: none">Set the Speaker Select option to TV Speaker in the sound menu.If you are using an external device, make sure the audio cables are connected to the correct audio input jacks on the TV.If you are using an external device, check the device's audio output option (ex. you may need to change your cable box's audio option to HDMI when you have a HDMI connected to your TV).If you are using a HDMI cable, a separate audio cable is required.If your TV has a headphone jack, make sure there is nothing plugged into it.
The speakers are making an inappropriate noise.	<ul style="list-style-type: none">Check the cable connections. Make sure a video cable is not connected to an audio input.For antenna or cable connections, check the signal strength. Low signal level may cause sound distortion.
No Picture, No Video	
The TV will not turn on.	<ul style="list-style-type: none">Make sure the AC power cord is securely plugged in to the wall outlet and the TV.Make sure the wall outlet is working.Try pressing the POWER button on the TV to make sure the problem is not the remote. If the TV turns on, refer to "The remote control does not work" below.
The TV turns off automatically.	<ul style="list-style-type: none">Ensure the Sleep Timer is set to Off in the Time menu.If your PC is connected to the TV, check your PC power settings.Make sure the AC power cord is plugged in securely to the wall outlet and the TV.When watching TV from an aerial or cable connection, the TV will turn off after 10 ~ 15 minutes if there is no signal.
There is no picture/video.	<ul style="list-style-type: none">Check cable connections (remove and reconnect all cables connected to the TV and external devices).Set your external device's (Cable/Set top Box, DVD, Blu-ray etc) video outputs to match the connections to the TV input. For example, if an external device's output is HDMI, it should be connected to an HDMI input on the TV.Make sure your connected devices are powered on.Be sure to select the TV's correct source by pressing the SOURCE button on the TV remote.

Video Decoder	■ Playing Multiple Files
Supports up to H.264, Level 4.1	Playing selected video/music/photo files
H.264 FMO / ASD / RS, VC1 SP / MP / AP L4 and AVCHD are not supported.	1. Press the Yellow button in the file list to select the desired file.
MPEG4 SP ASP :	2. Repeat the above operation to select multiple files.
– Below 1280 × 720: 60 frame max	☞ The " " mark appears to the left of the selected files.
– Above 1280 × 720: 30 frame max	☞ To cancel a selection, press the Yellow button again.
H.263 is not supported.	☞ To deselect all selected files, press the TOOLS button and select Deselect All .
GMC is not supported.	■ Playing the video/music/photo file group
■ Audio Decoder	While a file list is displayed, move to any file in desired group.
Supports up to WMA7, 8, 9 STD, 9 PRO, 10 PRO	■ Media Play - Additional Functions
WMA 9 PRO and WMA 10 PRO support 5.1 channel. (LBR mode of WMA Pro is not supported)	Videos/Music/Photos Play Option menus
WMA Lossless is not supported.	When playing a file, press the TOOLS button.
■ Music	
1. Press the ◀ or ▶ button to select Music , then press the ENTER button in the Media Play menu.	
2. Press the ◀/▶/▲/▼ buttons to select the desired Music in the file list.	
3. Press the ENTER button or ▶ (Play) button.	
☞ During music playback, you can search using the ◀ and ▶ button.	
☞ [REW] (REW) and [FF] (FF) buttons do not function during play.	
☞ You may select the files with MP3 file extension. Other file extensions are not displayed, even if they are saved on the same USB device.	
☞ If the need to change Equalizer - when playing MP3, then exit Media Play , adjust the Equalizer in the Sound menu. (An over-modulated MP3 file may cause a sound problem.)	
■ Photos	
1. Press the ◀ or ▶ button to select Photos , then press the ENTER button in the Media Play menu.	
2. Press the ◀/▶/▲/▼ buttons to select the desired photo in the file list.	
3. Press the ENTER button or ▶ (Play) button.	
☞ While a photo list is displayed, press the ▶ (Play) / ENTER button on the remote control to start the slide show.	
☞ All files in the file list section will be displayed in the slide show.	
☞ During the slide show, files are displayed in order.	
☞ During the slide show, you can adjust the slide show speed using [REW] (REW) or [FF] (FF) button.	
☞ You can move to other file using ◀ or ▶ button.	
☞ Press TOOLS button and select Background Music . Music files can be automatically played during the Slide Show if the Background Music is set to On.	
☞ The Mode in Background Music cannot be changed until the BGM has finished loading.	
• Supported Photo Formats	

Image	Photo	Resolution
JPEG	Base-line	15360 × 8704
	Progressive	1024 × 768

☞ CMYK, YCCCK Colour space JPEG are not supported.

All care protection

- All care protection will update Picture quality every 5,000 hours.
- All care protection pop-up menu will show every 5,000 hours, Max 3 times. (5,000/10,000/15,000 hours)
- The notification or pop-up menu will be closed by time out (30sec.) or selecting any key on the remote except power key.
 - When user turns the power off and then on again, pop-up menu for requesting update is provided again.
 - Pop-up menu is provided only 3 times including initial pop-up menu.
 - Pop-up menu will show only at TV on time.

Using the Sports Mode

Sports Mode 10055

This mode provides optimised condition for watching sports games.

■ Zoom: Pause playback and dived the picture into 9 parts. Select a part to zoom it in. Press this button again to resume.

- ☞ When the **Sports Mode** is On, the picture and sound modes are set to **Stadium** automatically.
- ☞ If you turn the TV off while watching **Sports Mode**, the **Sports Mode** will be disable.
- ☞ Mode name may vary depending on nations. **Cricket Mode**, **Soccer Mode**, **Sports Mode**.

PAK Cinema Mode

Using the PAK Cinema Mode

When you set **PAK Cinema Mode** to On, the TV provides an optimal picture and sound for popular content.

☞ This function is not available on certain models in specific geographical areas.

- ☞ **Cricket Mode**, **Game Mode**, **PAK Cinema Mode** can not be operated at the same time.

Family TV Feature 10055

This mode provides a way to capture the images and audio. Press [F] and the **Family TV Feature** mode will be turned on, or press MENU button, enter Support Menu select **Family TV Feature**. Press again the **Family TV Feature** mode will be turned off.

- ☞ Before enabling the **Family TV Feature** mode, the USB device should be connected first.
- ☞ **Media Play** mode not available.
- ☞ **Sports Mode** and **Game Mode** can not be operated at the same time.

Sound Recording

After turning on the **Joy Plus Feature** mode, press [D] to make a recording of the current sound, press [D] again to stop the recording. Items are stored in **Music** folder in **Media Play**.

If you press any key, Audio Recording will be stopped.

Screen Capture

After turning on the **Joy Plus Feature** mode, press [C] to make a current screen capture. Items are stored in **Photos** folder in **Media Play**.

Story Replay

- To start Story Replay while watching TV, press [B]. This records audio in real-time, and captures the screen every 5 seconds in the meanwhile.
- To stop Story Replay, press [B]. The recording is stored as a .p1e on the USB device connected to the TV. Thumbnails of the story recordings are then shown on the screen.
- Select the thumbnail screen to play the saved files on Media Play.

You cannot change the channel or source to an external device. To change the channel or the source to an external device, first stop story recording.

Story Replay feature is just an application provided by Samsung and Samsung does not take any responsibility of its use by the user. The use/ intended use of the application is for the personal or private use of the user only. User shall be responsible for complying with all other laws of the land while using the application and shall further be liable for any damage, penalty, legal action arising out of misuse of application, including without limitation, infringement of Intellectual Property Rights.

View Content

Press [F] to get into **Media Play**. Press ◀ or ▶ button to select **Music** and **Story Replay** for items of recording or **Photos** for items of capturing.

- ☞ **Joy Plus Feature** are for personal use only, not for commercial purpose and/or communication to the public.
- ☞ The user may not use these features for commercial purposes without prior approval from the copyright owners and/or to use it unlawfully.
- ☞ Samsung does not accept responsibility for any misuse of the service.

Default Recording Device

You can set the default device for saving captured image files and recorded audio files.

☞ This function is only available when the USB device is connected the TV, and **Family TV Feature** mode is on.

Support Menu

Self Diagnosis

Self Diagnosis might take few seconds, this is part of the normal operation of the TV.

- **Picture Test**: Use to check for picture problems.
- **Sound Test**: Use the built-in melody sound to check for sound problems.
- ☞ If you hear no sound from the TV's speakers, before performing the sound test, make sure **Speaker Select** is set to **TV Speaker** in the **Sound** menu.
- ☞ The melody will be heard during the test even if the sound is muted by pressing the MUTE button.
- **Reset**: Resets all settings to the factory defaults except network settings.
- ☞ The PIN input screen appears before the setup screen.
- ☞ Enter your 4-digit PIN. Change the PIN using the **Change PIN** option.
- ☞ Choose to restore factory settings, TV will automatically shut down, and then restart.

Use Mode

You can select the **Use Mode** suitable for your place. We strongly recommend you select **Home Use**.

- **Home Use**: **Home Use** is the default setting.
- **Store Demo**: **Store Demo** is for retail environments only. If you select **Store Demo**, some functions will not work, and the picture settings will be reset every 5 minutes.

Software Upgrade

Software Upgrade can be performed by downloading the latest firmware from "www.samsung.co" to a USB memory device.

HD Connection Guide

You can read a guide to connect external devices for HD sources.

Contact Samsung

View this information when your TV does not work properly or when you want to upgrade the software. You can find information regarding our call centres, and how to download products and software.

Other Information

Installing the Wall Mount

The wall mount kit (sold separately) allows you to mount the TV on the wall. For detailed information on installing the wall mount, see the instructions provided with the wall mount. Contact a technician for assistance when installing the wall mount bracket. We do not advice you to do it yourself. Samsung Electronics is not responsible for any damage to the product or injury to yourself or others if you select to install the TV on your own.

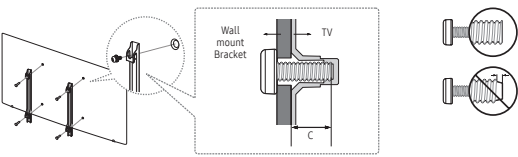

Storage and Maintenance

- ☞ If you remove the attached sticker on the TV sreen, clean the residues and then watch TV.

Do not spray water directly onto the product. Any liquid that goes into the product may cause a failure, fire, or electric shock.	Clean the product with a soft cloth dampened with in a small amount of water. Do not use a flammable liquid (e.g. benzene, thinners) or a cleaning agent.
Licence	
This DivX Certified® device has passed rigorous testing to ensure it plays DivX® video. To play purchased DivX movies, first register your device at vod.divx.com. Find your registration code in the DivX VOD section of your device setup menu. DivX Certified® to play DivX® video up to HD 1080p, including premium content. DivX®, DivX Certified® and associated logos are trademarks of DivX, LLC and are used under license. Covered by one or more of the following U.S. patents: 7,295,673; 7,460,668; 7,515,710; 8,656,183; 8,731,369; RE45,052.	
Manufactured under license from Dolby Laboratories. Dolby and the double-D symbol are trademarks of Dolby Laboratories.	
For DTS patents, see http://patents.dts.com. Manufactured under license from DTS Licensing Limited. DTS, the Symbol, & DTS and the Symbol together are registered trademarks, and DTS 2.0+ Digital Out is a trademark of DTS, Inc. © DTS, Inc. All Rights Reserved.	
The terms HDMI and HDMI High-Definition Multimedia Interface, and the HDMI Logo are trademarks or registered trademarks of HDMI Licensing LLC in the United States and other countries.	
Open Source License Notice Open Source used in this product can be found on the following webpage. (http://opensource.samsung.com) Open Source License Notice is written only English.	

Recommendation - Jordan Only



Hereby, Samsung Electronics, declares that this equipment is in compliance with the essential requirements and other relevant provisions of Directive 1999/5/EC.

The original Declaration of Conformity may be found at http://www.samsung.com, go to Support > Search Product Support and enter the model name. This equipment may be operated in Jordan.

Wall Mount Kit Specifications (VESA)

- ☞ The wall mount kit is not supplied, but sold separately.
- ☞ Install your wall mount on a solid wall perpendicular to the floor. When attaching to other building materials, please contact your nearest dealer. If you install the TV on a ceiling or slanted wall, it may fall and result in severe personal injury.
- ☞ Standard dimensions for wall mount kits are shown in the table below.
- ☞ When purchasing our wall mount kit, a detailed installation manual and all parts necessary for assembly are provided.
- ☞ Do not use screws that do not comply with the VESA standard screw specifications.
- ☞ Do not use screws longer than the standard dimension, as they may cause damage to the inside of the TV set.
- ☞ For wall mounts that do not comply with the VESA standard screw specifications, the length of the screws may differ depending on the wall mount specifications.
- ☞ Do not fasten the screws too firmly. This may damage the product or cause the product to fall, leading to personal injury. Samsung is not liable for these kinds of accidents.
- ☞ Samsung is not liable for product damage or personal injury when a non-VESA or non-specified wall mount is used or the consumer fails to follow the product installation instructions.
- ☞ Do not mount the TV at more than a 15 degree tilt.
- ☞ Always have two people mount the TV on a wall.
- ☞ If you are installing a third-party wall mount, note that the length of the screws you can use to attach the TV to the wall mount is shown in column C in the table below.

Product Family	Models	VESA screw hole specs (A × B) in millimeters	C (mm)	Standard Screw	Quantity
LED-TV	UA32KS100	100 x 100	19 ~ 20	M4	4
	UA40KS100	200 x 200		M8	
	UA49KS100				
	UA55KS100				

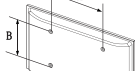



Do not install your Wall Mount Kit while your TV is turned on. It may result in personal injury due to electric shock.

These are general instructions. For exact instructions, see the User manual supplied with the locking device.

The locking device has to be purchased separately.

The location of the Kensington slot may be different depending on the TV model.

❑ Securing the Installation Space

Keep the required distances between the product and other objects (e.g. walls) to ensure proper ventilation.

Failing to do so may result in fire or a problem with the product due to an increase in the internal temperature of the product.

- ❑ When using a stand or wall-mount, use parts provided by Samsung Electronics only.
- ❑ If you use parts provided by another manufacturer, it may result in a problem with the product or an injury due to the product falling.
- ❑ The appearance may differ depending on the product.

Securing the TV to the Wall

Caution: Pulling, pushing, or climbing onto the TV may cause the TV to fall. In particular, ensure that your children do not hang