



WD18H7*****

WD17H7*****

Washing Machine

User manual

Imagine the possibilities

Thank you for purchasing this Samsung product.

SAMSUNG

Content

Safety information	3
What you need to know about the safety instructions	3
Important safety symbols	3
Important safety precautions	4
Installation	12
What's included	12
Installation requirements	13
Step-by-step installation	15
Before you start	20
Run Calibration (recommended)	20
Laundry guidelines	21
Detergent drawer guidelines	23
Operations	25
Control panel	25
Simple steps to start	27
Program overview	28
Options	30
User convenience & maintenance	31
Settings	32
Smart check	33
Maintenance	34
Eco Drum Clean	34
Drying Drum	34
Emergency drain	35
Cleaning	36
Recovery from freezing	38
Care against an extended time of disuse	38
Troubleshooting	39
Checkpoints	39
Information codes	40
Specifications	41
Protecting the environment	41
Fabric care chart	42
Specification sheet	43

Safety information

Congratulations on your new Samsung washing machine. This manual contains important information on the installation, use and care of your appliance. Please take some time to read this manual to take full advantage of your washing machine's many benefits and features.

What you need to know about the safety instructions





Please read this manual thoroughly to ensure that you know how to safely and efficiently operate the extensive features and functions of your new appliance. Please store the manual in a safe location close to the appliance for future reference. Use this appliance only for its intended purpose as described in this instruction manual.

Warnings and Important Safety Instructions in this manual do not cover all possible conditions and situations that may occur. It is your responsibility to use common sense, caution and care when installing, maintaining and operating your washing machine.

Because the following operating instructions cover various models, the characteristics of your washing machine may differ slightly from those described in this manual and not all warning signs may be applicable. If you have any questions or concerns, contact your nearest service centre or find help and information online at www.samsung.com.

Important safety symbols

What the icons and signs in this user manual mean:

	WARNING: Hazards or unsafe practices that may result in severe personal injury, death and/or property damage.
	CAUTION: Hazards or unsafe practices that may result in personal injury and/or property damage.
	NOTE
	Read the instructions

These warning signs are here to prevent injury to yourself and others.

Please follow them explicitly.

After reading this manual, store it in a safe place for future reference.

Read all instructions before using the appliance.

As with any equipment that uses electricity and moving parts, potential hazards exist. To safely operate this appliance, familiarize yourself with its operation and exercise care when using it.

Important safety precautions

⚠ WARNING: To reduce the risk of fire, electric shock, or injury to persons when using your appliance, follow basic precautions, including the following:

1. This appliance is not to be used by persons (including children) with reduced physical, sensory or mental capabilities, or lack of experience and knowledge, unless they have been given supervision or instruction concerning use of the appliance by a person responsible for their safety.
2. **For use in Europe:** This appliance can be used by children aged from 8 years and above and persons with reduced physical, sensory or mental capabilities or lack of experience and knowledge if they have been given supervision or instruction concerning use of the appliance in a safe way and understand the hazards involved. Children shall not play with the appliance. Cleaning and user maintenance shall not be made by children without supervision.
3. Children should be supervised to ensure that they do not play with the appliance.
4. If the supply cord is damaged, it must be replaced by the manufacturer, its service agent or similarly qualified persons in order to avoid a hazard.
5. The new hose-sets supplied with the appliance are to be used and that old hose-sets should not be reused.
6. For appliances with ventilation openings in the base, that a carpet must not obstruct the openings.
7. **For use in Europe:** Children of less than 3 years should be kept away unless continuously supervised.
8. **CAUTION:** In order to avoid a hazard due to inadvertent resetting of the thermal cut-out, this appliance must not be supplied through an external switching device, such as a timer, or connected to a circuit that is regularly switched on and off by the utility.
9. The tumble dryer is not to be used if industrial chemicals have been used for cleaning.

10. The lint trap has to be cleaned frequently, if applicable.
11. Lint must not be allowed to accumulate around the tumble dryer.
(not applicable for appliances intended to be vented to the exterior of the building)
12. Adequate ventilation has to be provided to avoid the back flow of gases into the room from appliances burning other fuels, including open fires.
13. Do not dry unwashed items in the tumble dryer.
14. Items that have been soiled with substances such as cooking oil, acetone, alcohol, petrol, kerosene, spot removers, turpentine, waxes and wax removers should be washed in hot water with an extra amount of detergent before being dried in the tumble dryer.
15. Items such as foam rubber (latex foam), shower caps, waterproof textiles, rubber backed articles and clothes or pillows fitted with foam rubber pads should not be dried in the tumble dryer.
16. Fabric softeners, or similar products, should be used as specified by the fabric softener instructions.
17. The final part of a tumble dryer cycle occurs without heat (cool down cycle) to ensure that the items are left at a temperature that ensures that the items will not be damaged.
18. Remove all objects from pockets such as lighters and matches.
19. **WARNING:** Never stop a tumble dryer before the end of the drying cycle unless all items are quickly removed and spread out so that the heat is dissipated.
20. Exhaust air must not be discharged into a flue which is used for exhausting fumes from appliances burning gas or other fuels.
21. The appliance must not be installed behind a lockable door, a sliding door or a door with a hinge on the opposite side to that of the tumble dryer, in such a way that a full opening of the tumble dryer door is restricted.

WARNING: Critical installation WARNINGS

The installation of this appliance must be performed by a qualified technician or service company.

- Failure to do so may result in electric shock, fire, an explosion, problems with the product, or injury.

The appliance is heavy, therefore take care when lifting it.

Plug the power cord into an AC 220 ~ 240 V / 50 Hz wall socket or higher and use the socket for this appliance only. Never use an extension cord.

- Sharing a wall socket with other appliances using a power strip or extending the power cord may result in electric shock or fire.
- Ensure that the power voltage, frequency, and current are the same as those of the product specifications. Failure to do so may result in electric shock or fire. Plug the power plug into the wall socket firmly.

Remove all foreign substances such as dust or water from the power plug terminals and contact points using a dry cloth on a regular basis.

- Unplug the power plug and clean it with a dry cloth.
- Failure to do so may result in electric shock or fire.

Plug the power plug into the wall socket so that the cord is running towards the floor.

- If you plug the power plug into the socket in the opposite direction, the electric wires within the cable may be damaged and this may result in electric shock or fire.

Keep all packaging materials out of the reach of children as these may be dangerous.

- If a child places a bag over its head, it may suffocate.

When the appliance, power plug or power cord is damaged, contact your nearest service centre.

This appliance must be properly grounded.

Do not ground the appliance to a gas pipe, plastic water pipe, or telephone line.

- This may result in electric shock, fire, an explosion, or problems with the product.
- Never plug the power cord into a socket that is not grounded correctly and make sure that it is in accordance with local and national regulations.

Do not install this appliance near a heater or any inflammable material.

Do not install this appliance in a humid, oily or dusty location, or in a location exposed to direct sunlight or water (rain drops).

Do not install this appliance in a location exposed to low temperatures.

- Frost may cause the tubes to burst.

Do not install this appliance in a location where gas may leak.

- This may result in electric shock or fire.

Do not use an electric transformer.

- This may result in electric shock or fire.

Do not use a damaged power plug, damaged power cord, or loose wall socket.

- This may result in electric shock or fire.

Do not pull or excessively bend the power cord.

Do not twist or tie the power cord.

Do not hook the power cord over a metal object, place a heavy object on the power cord, insert the power cord between objects, or push the power cord into the space behind the appliance.

- This may result in electric shock or fire.

Do not pull the power cord when unplugging the power plug.

- Unplug the power plug by holding the plug.
- Failure to do so may result in electric shock or fire.

This appliance should be positioned so that the power plug, the water supply taps, and the drain pipes are accessible.

CAUTION: Installation CAUTIONS

This appliance should be positioned in such a way that the power plug is easily accessible.

- Failure to do so may result in electric shock or fire due to electric leakage.

Install your appliance on a solid, level floor that can support its weight.

- Failure to do so may result in abnormal vibrations, movement, noise, or problems with the product.

WARNING: Critical usage WARNINGS

If the appliance is flooded, turn off the water & power supplies immediately and contact your nearest service centre.

- Do not touch the power plug with wet hands.
- Failure to do so may result in electric shock.

If the appliance generates a strange noise, a burning smell, or smoke, unplug the power plug immediately and contact your nearest service centre.

- Failure to do so may result in electric shock or fire.

In the event of a gas leak (such as propane gas, LP gas, etc.), ventilate immediately without touching the power plug. Do not touch the appliance or power cord.

- Do not use a ventilating fan.
- A spark may result in an explosion or fire.

Do not let children play in or on the washing machine. In addition, when disposing of the appliance, remove the washing machine door lever.

- If trapped inside the product, children may suffocate to death.

Make sure to remove the packaging (sponge, styrofoam) attached to the bottom of the washing machine before using it.

Do not wash items contaminated with gasoline, kerosene, benzene, paint thinner, alcohol or other inflammable or explosive substances.

- This may result in electric shock, fire, or an explosion.

Do not open the washing machine door by force while it is operating (high-temperature washing/drying/spinning).

- Water flowing out of the washing machine may result in burns or cause the floor to be slippery. This may result in injury.
- Opening the door by force may result in damage to the product or injury.

Do not insert your hand under the washing machine while an operation is in progress.

- This may result in injury.

Do not touch the power plug with wet hands.

- This may result in electric shock.

Do not turn the appliance off by unplugging the power plug while an operation is in progress.

- Plugging the power plug into the wall socket again may cause a spark and result in electric shock or fire.

Do not let children or the infirm use this washing machine without proper supervision. Do not let children climb in or onto the appliance.

- This may result in electric shock, burns or injury.

Do not insert your hand or a metal object under the washing machine while it is operating.

- This may result in injury.

Do not unplug the appliance by pulling the power cord. Always grip the plug firmly and pull it straight out of the outlet.

- Damage to the power cord may cause a short-circuit, fire and/or electric shock.

Do not attempt to repair, disassemble, or modify the appliance yourself.

- Do not use a fuse (such as copper, steel wire, etc.) other than a standard fuse.
- When the appliance needs to be repaired or reinstalled, contact your nearest service centre.
- Failure to do so may result in electric shock, fire, problems with the product, or injury.

If the water supply hose comes loose from the water tap and floods the appliance, unplug the power plug.

- Failure to do so may result in electric shock or fire.

Unplug the power plug when the appliance is not being used for long periods of time or during a thunder or lightning storm.

- Failure to do so may result in electric shock or fire.

If any foreign substance enters into the appliance, unplug the power plug and contact your nearest Samsung Customer Service.

- This may result in electric shock or fire.

Do not let children (or pets) play in or on your product. The product door does not open easily from the inside and children may be seriously injured if trapped inside.

CAUTION: Usage CAUTIONS

When the washing machine is contaminated by a foreign substance such as detergent, dirt, food waste, etc., unplug the power plug and clean the washing machine using a damp, soft cloth.

- Failure to do so may result in discolouration, deformation, damage, or rust.

The front glass may be broken by a strong impact. Take care when using the washing machine.

- If the glass is broken, it may result in injury.

After a water supply failure or when reconnecting the water supply hose, open the water tap slowly.

Open the water tap slowly after a long period of non-use.

- The air pressure in the water supply hose or the water pipe may damage a product part or result in a water leak.

If a draining error occurs during an operation, check if there is a draining problem.

- If the washing machine is used when it is flooded because of a draining problem, it may result in electric shock or fire.

Insert the laundry into the washing machine completely so that the laundry does not get caught in the door.

- If laundry gets caught in the door, it may result in damage to the laundry or the washing machine, or result in a water leak.

Turn the water supply off when the washing machine is not being used.

Ensure that the screws on the water supply hose connector are properly tightened.

- Failure to do so may result in property damage or injury.

Ensure that the rubber seal and front door glass are not contaminated by a foreign substance (e.g. waste, thread, hair, etc.).

- If a foreign substance is caught in the door or the door is not completely closed, it may cause a water leak.

Open the water tap and check if the water supply hose connector is firmly tightened and that there is no water leak before using the product.

- If the screws on the water supply hose connector are loose, it may result in a water leak.

The product you have purchased is designed for domestic use only.

Using the product for business purposes qualifies as a product misuse. In this case, the product will not be covered by the standard warranty provided by Samsung and no responsibility can be attributed to Samsung for malfunctions or damages resulting from such misuse.

Do not stand on the appliance or place objects (such as laundry, lighted candles, lighted cigarettes, dishes, chemicals, metal objects, etc.) on the appliance.

- This may result in electric shock, fire, problems with the product, or injury.

Do not spray volatile material such as insecticide onto the surface of the appliance.

- As well as being harmful to humans, this may result in electric shock, fire or problems with the product.

Do not place objects that generate electromagnetic fields near the washing machine.

- This may result in injury due to a malfunction.

Water drained during a high-temperature wash or drying cycle is hot. Do not touch the water.

- This may result in burns or injury.

Do not wash, spin, or dry water-proof seats, mats, or clothing (*) unless your appliance has a special cycle for washing these items.

(*): Woollen bedding, rain covers, fishing vests, ski pants, sleeping bags, diaper covers, sweat suits, and bicycle, motor cycle and car covers, etc.

- Do not wash thick or hard mats even if the washing machine mark is on the care label. This may result in injury or damage to the washing machine, walls, floor, or clothing due to abnormal vibrations.
- Do not wash throw rugs or doormats with rubber backing. The rubber backing may come off and stick to inside the drum, and this may result in malfunction such as a drainage error.

Do not operate the washing machine when the detergent drawer is removed.

- This may result in electric shock or injury due to a water leak.

Do not touch the insides of the drum during or just after drying as it is hot.

- This may result in burns.

Do not insert your hand into the detergent drawer.

- This may result in injury as your hand may be caught by the detergent input device.

Do not place any objects (such as shoes, food waste, animals) other than laundry into the washing machine.

- This may result in damage to the washing machine, or injury and death in the case of pets due to the abnormal vibrations.

Do not press the buttons using sharp objects such as pins, knives, fingernails, etc.

- This may result in electric shock or injury.

Do not wash laundry contaminated by oils, creams or lotions usually found in skincare shops or massage clinics.

- This may cause the rubber seal to become deformed and result in a water leak.

Do not leave metal objects such as safety pins, hair pins or bleach in the drum for long periods of time.

- This may cause the drum to rust.
- If rust starts appearing on the surface of the drum, apply a (neutral) cleansing agent to the surface and use a sponge to clean it. Never use a metal brush.

Do not use dry cleaning detergent directly and do not wash, rinse, or spin laundry contaminated by dry cleaning detergent.

- This may result in spontaneous combustion or ignition due to the heat from the oxidation of the oil.

Do not use water from water cooling/heating devices.

- This may result in problems with the washing machine.

Do not use natural hand-washing soap for the washing machine.

- If it hardens and accumulates inside the washing machine, it may result in problems with the product, discolouration, rust, or bad odours.

Place socks and brassieres in a washing net and wash them with the other laundry.

Do not wash large laundry items such as bedding in the washing net.

- Failure to do so may result in injury due to abnormal vibrations.

Do not use hardened detergent.

- If it accumulates inside the washing machine, it may result in a water leak.

Make sure that the pockets of all the clothing items to be washed are empty.

- Hard, sharp objects such as coins, safety pins, nails, screws, or stones can cause extensive damage to the appliance.

Do not wash clothing with large buckles, buttons or other heavy metal objects.

Sort the laundry by color on the basis of its colorfastness and select the recommended cycle, water temperature and additional functions.

- This may result in discoloration or fabric damage.

Take care that children's fingers are not caught in the door when you close it.

- Failure to do so may result in injury.

⚠ WARNING: Critical cleaning WARNINGS

Do not clean the appliance by spraying water directly onto it.

Do not use the a strong acidic cleaning agent.

Do not use benzene, thinner or alcohol to clean the appliance.

- This may result in discolouration, deformation, damage, electric shock or fire.

Before cleaning or performing maintenance, unplug the appliance from the wall socket.

- Failure to do so may result in electric shock or fire.

Installation

Follow these instructions carefully to ensure proper installation of the washing machine and to prevent accidents when doing laundry.

What's included

Make sure all the parts are included in the product package. If you have a problem with the washing machine or the parts, contact a local Samsung customer centre or the retailer.

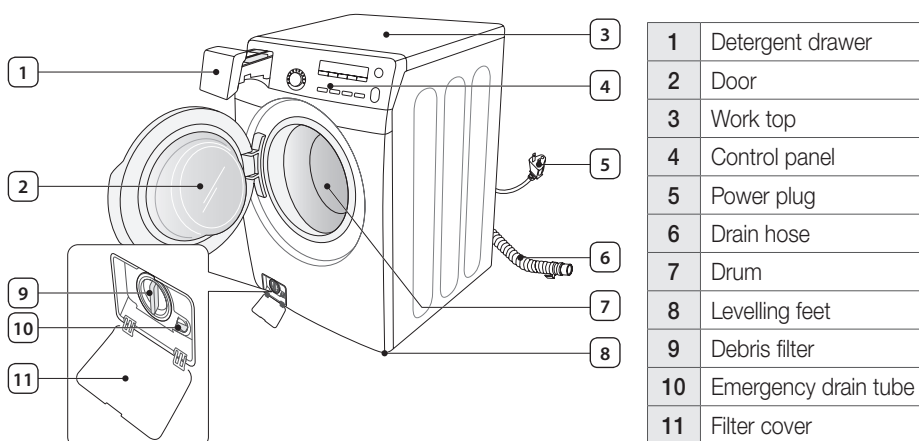

Spanner



Bolt caps



Drain hose



Hose guide



Cold water supply hose



Hot water supply hose



Hose zip tie



Bolt caps : The provided number (3 to 6) of bolt caps depends on the model.

Hot water supply hose: Applicable models only.

Installation requirements

Electrical supply and grounding

- AC 220 ~ 240 V / 50 Hz fuse or circuit breaker is required
- Use an individual branch circuit specific to the washing machine

To ensure proper grounding, the washing machine comes with a power cord featuring a three-prong grounding plug for use in a properly installed and grounded outlet.

Check with a qualified electrician or service person if you are not sure about the grounding.

Do not modify the provided plug. If it does not fit the outlet, call a qualified electrician to install a proper outlet.



WARNING

- Do NOT use an extension cord.
- Use only the power cord that comes with the washing machine.
- Do NOT connect the ground wire to plastic plumbing, gas lines, or hot water pipes.
- Improperly connected grounding conductors may cause electric shock.

Water supply

A proper water pressure for this washing machine is between 137 kPa and 800 kPa. Water pressure less than 137 kPa may cause the water valve not to close completely. Or, it may take longer to fill the drum, causing the washing machine to turn off. Water taps must be within 120 cm from the rear of the washing machine so that the provided inlet hoses reach the washing machine.

To reduce the risk of leaks

- Make sure water taps are easily accessible.
- Turn off the taps when the washing machine is not in use.
- Check for any leaks at the water inlet hose fittings on a regular basis.



CAUTION

Before using the washing machine for the first time, check all connections at the water valve and taps for any leaks.

Drain

Samsung recommends a standpipe in height of 60~90 cm. The drain hose must be connected through the hose clip to the standpipe, and the standpipe must fully cover the drain hose.

Flooring

For best performance, the washing machine must be installed on a solid floor. Wood floors may need to be reinforced to minimize vibration and/or unbalanced loads. Carpeting and soft tile surfaces are not a good resistance to vibrations and may cause the washing machine to move slightly during the spin cycle.



CAUTION

Do NOT install the washing machine on a platform or a poorly supported structure.

Water temperature

Do not install the washing machine in areas where water may freeze as the washing machine always retains some water in its water valves, pumps, and/or hoses. Frozen water left in the connection parts may cause damage to belts, the pump, and other components of the washing machine.

Alcove or closet installation

Minimum clearance for stable operation:

Sides	25 mm	Rear	50 mm
Top	25 mm	Front	550 mm

If both the washing machine and a dryer are installed in the same location, the front of the alcove or closet must have at least a 550 mm unobstructed air opening. Your washing machine alone does not require a specific air opening.

Step-by-step installation

STEP 1 - Select a location

Location requirements:

- Solid, level surface without carpeting or flooring that may obstruct ventilation
- Away from direct sunlight
- Adequate room for ventilation and wiring
- The ambient temperature is always higher than the freezing point (0 °C)
- Away from a heat source

STEP 2 – Remove the shipping bolts

Unpack the product package and remove all shipping bolts.

1. Loosen all shipping bolts on the rear of the machine using the supplied spanner.

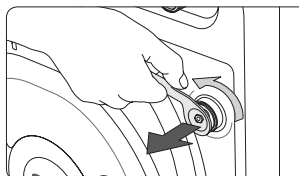

2. Fill the holes with the supplied plastic bolt caps. Keep the shipping bolts for future use.

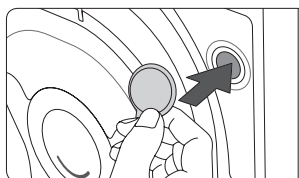

WARNING

Packaging materials can be dangerous to children. Dispose all packaging material (plastic bags, polystyrene, etc.) out of children's reach.

STEP 3 - Adjust the levelling feet

1. Gently slide the washing machine into position. Excessive force may damage the levelling feet.
2. Level the washing machine by manually adjusting the levelling feet. The levelling feet can be loosened using the provided spanner.
3. When levelling is complete, tighten the nuts using a screwdriver as shown.

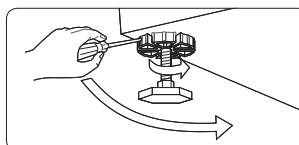
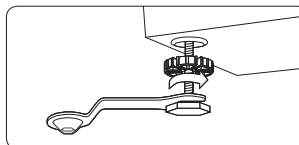

When installing the washing machine, ensure that the power plug, and the water supply and drain hoses are easily accessible.

STEP 4 - Connect the water hose

Connect the water supply hose to the water tap.

1. Remove the **adaptor (A)** from the **water supply hose (B)**.

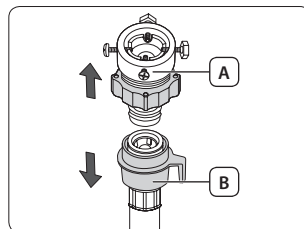

2. Use a Philips screwdriver to loosen four screws on the adaptor.

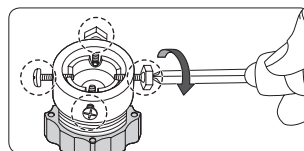

3. Hold the adaptor and turn **part (C)** in the arrow direction to loosen it by 5 mm (*).

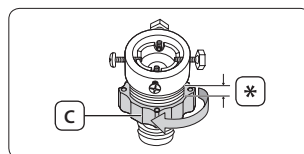

4. Insert the adaptor into the water tap, and tighten the screws while lifting up the adaptor.
5. Turn **part (C)** in the arrow direction to tighten it.

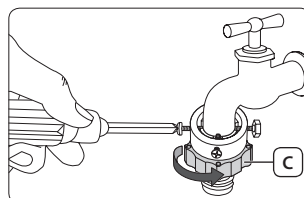

6. While holding down **part (E)**, connect the water supply hose to the adaptor. Then, release **part (E)**. The hose fits into the adaptor with a clicking sound.

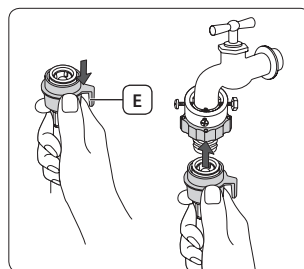

7. Connect the other end of the water supply hose to the inlet valve on the back of the washing machine. Turn the hose clockwise to tighten.

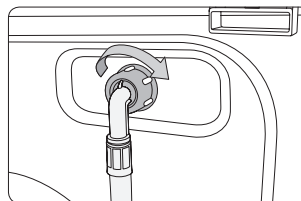

8. Open the water tap and check if there are any leaks around the connection areas. If there are water leaks, repeat the steps above.

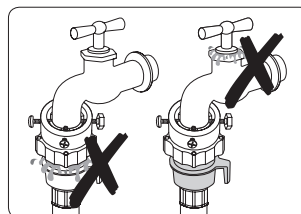

- If using a screw type of water tap, connect the water hose to the water tap as shown.

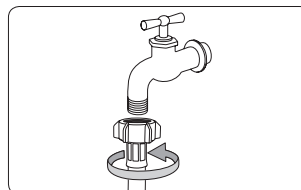

WARNING

Stop using the washing machine if there is a water leak, and contact a local Samsung service centre. Otherwise, this may cause electric shock.



CAUTION

Do not stretch the water supply hose by force. If the hose is too short, replace the hose with a longer, high-pressure hose.



- After connecting the water supply hose to the adaptor, check if it is connected properly by pulling the water supply hose downwards.
- Use a popular type of water taps. If the tap is square-shaped or too big, remove the spacer ring before inserting the tap into the adaptor.

For models with an additional hot water inlet:

1. Connect the red end of the hot water supply hose to the hot water inlet on the back of the machine.
2. Connect the other end of the hot water supply hose to the hot water tap.

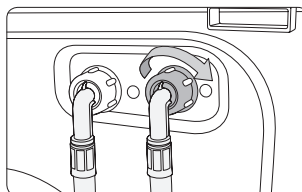

Aqua hose (applicable models only)

The aqua hose alerts users of a risk of water leaks. It senses the water flow and turns red on the centre **indicator (A)** in case of a leak.

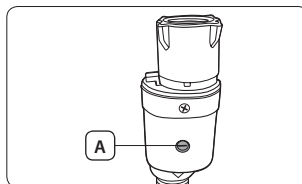

STEP 5 - Connect the drain hose

The drain hose can be positioned in three ways:

1. Press the catches of the **clamp (A)** and insert the drain hose into the clamp.
2. Insert the drain hose into the **extension hose (C)** of the washing machine firmly by pressing the catches of the clamp. Then release them to fix the **drain hose (B)**.
3. Fully insert the end of the drain hose into the drain hole.

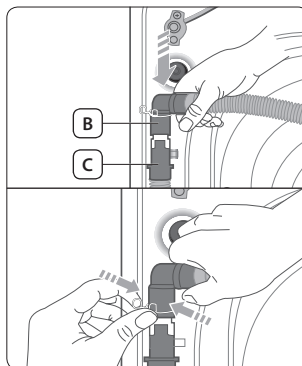
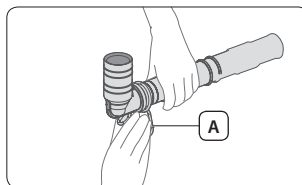

The drain outlet of the washer may be on the left or right depending on the model.

STEP 6 - Position the drain hose

The drain hose can be positioned in three ways:

In a sink drain pipe

The drain pipe must be above the sink siphon so that the end of the hose is at least 60 cm above the floor.

In a drain pipe

The drain pipe should be between 60 cm and 90 cm high (*). It is advisable to use a 65 cm high vertical pipe. Make sure the drain hose is connected to the stand pipe at a slant.

Drain standpipe requirements:

- Minimum diameter of 5 cm
- Minimum carry-away capacity of 60 litres per minute

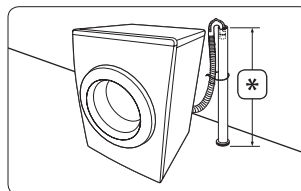

STEP 7 – Turn on the washing machine

Plug the power cord into a wall socket featuring an AC 220 ~ 240 V / 50 Hz approved electrical outlet protected by a fuse or circuit breaker. Then, press the **POWER** button to turn on the washing machine.

Before you start

Run Calibration (recommended)

Calibration ensures accurate weight detection by the washing machine. Make sure the drum is empty before running Calibration.

1. Press the **POWER** button to turn on the washing machine.
2. Press and hold both the **Temp.** and **Delay End** buttons for 3 seconds.
3. Press the **START/PAUSE** button to activate Calibration mode.
4. The drum spins to the left and right several times. It takes several minutes to complete the Calibration.
5. When the Calibration is complete, the "END" message appears on the display.



If the door is unlocked, the machine turn off automatically.

Laundry guidelines

STEP 1 - Sort

Sort the laundry according to these criteria:

- **Care Label:** Sort the laundry into cottons, mixed fibres, synthetics, silks, wools, and rayon.
- **Colour:** Separate whites from colours.
- **Size:** Mixing different-sized items together in the drum improves the washing performance.
- **Sensitivity:** Wash delicate items separately using an Easy Iron option for pure, new woollen items, curtains, and silk items. Check the labels on the items.



Make sure to check the care label on the clothing, and sort them accordingly before starting the wash.

STEP 2 - Empty pockets

Empty all the pockets of your laundry items

- Metal objects such as coins, pins, and buckles on clothing may damage other laundry items as well as the drum.

Turn clothing with buttons and embroideries inside out

- If pants or jacket zippers are open while washing, the drum may be damaged. Zippers should be closed and fixed with a string.
- Clothing with long strings may become entangled with other clothes. Make sure to tie the strings before starting the wash.

STEP 3 - Use a laundry net

- Brassieres (water washable) must be placed in a laundry net. Metal parts of the brassieres may break through and tear other laundry items.
- Small, light clothing such as socks, gloves, stockings, and handkerchiefs may become caught around the door. Place them inside a fine laundry net.
- Do not wash the laundry net by itself without other laundry. This may cause abnormal vibrations that could move the washing machine and result in injury.

STEP 4- Prewash (if necessary)

Select the Prewash option for the selected course if the laundry is heavily soiled. Do not use the Prewash option when detergent is manually added into the drum.

STEP 5- Determine the load capacity

Do not overload the washing machine. Overloading may cause the washing machine to not wash properly. For the load capacity for the type of clothing, see page 28.



When washing bedding or bedding covers, the wash time may be lengthened or the spin efficiency may be reduced. For bedding or bedding covers, the recommended maximum spin cycle speed is 800 rpm, and the load capacity is 2.0 kg or less.



CAUTION

If the laundry is unbalanced and the “UE” error code is displayed, redistribute the load. Unbalanced laundry may reduce the spinning performance.

STEP 6- Apply a proper detergent type

The type of detergent depends on the type of fabric (cotton, synthetic, delicate items, wool), colour, wash temperature, and degree of soiling. Always use “low suds” laundry detergent, which is designed for automatic washing machines.



- Follow the detergent manufacturer’s recommendations based on the weight of the laundry, the degree of soiling, and the hardness of the water in your local area. If you are not sure about the water hardness, contact a local water authority.
- Do not use detergent that tends to be hardened or solidified. This detergent may remain after the rinse cycle, blocking the drain outlet.



CAUTION

When washing wool using the wool course, use only a neutral liquid detergent. If used with the Wool course, powder detergent may remain on the laundry and discolour the laundry.

Detergent drawer guidelines

The washing machine provides a four-compartment dispenser: two compartments for manual input, and the other two for auto dispensing. With Auto Detergent and Auto Softener enabled, the washing machine dispenses an adequate amount of detergent or fabric softener for each load. See below for details:

A	Detergent: Use this to add powder or liquid detergent manually.
B	Softener: Use this to add fabric softener manually.
C	Auto Detergent: Use liquid detergent only.
D	Auto Softener: Use fabric softener only.

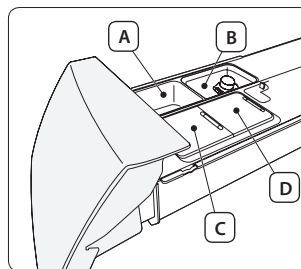

CAUTION

- Do not open the detergent drawer while the washing machine is operating.
- Do not use the following types of detergent:
 - Tablet or capsule types
 - Ball or net types
- To prevent the compartment clogging, concentrated or highly-enriched agents (fabric softener or detergent) must be diluted with water before being applied.
- Before moving the washing machine, make sure to empty the detergent drawer that might contain detergent and/or fabric softener. The content in the drawer may spill out on the floor.

BEFORE YOU START

To refill the detergent or fabric softener

1. Slide open the detergent drawer.
2. Apply an appropriate amount of detergent to the **Auto Detergent compartment (C)**. And apply an appropriate amount of fabric softener to the **Auto Softener compartment (D)** if necessary.
3. Slide the detergent drawer inward. Make sure the door is closed.

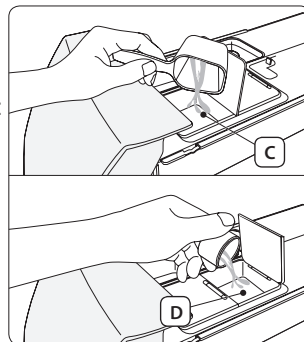

CAUTION

Do not exceed the **max line (*)** which is marked on the compartment.

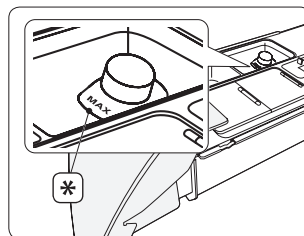

Operations

Control panel

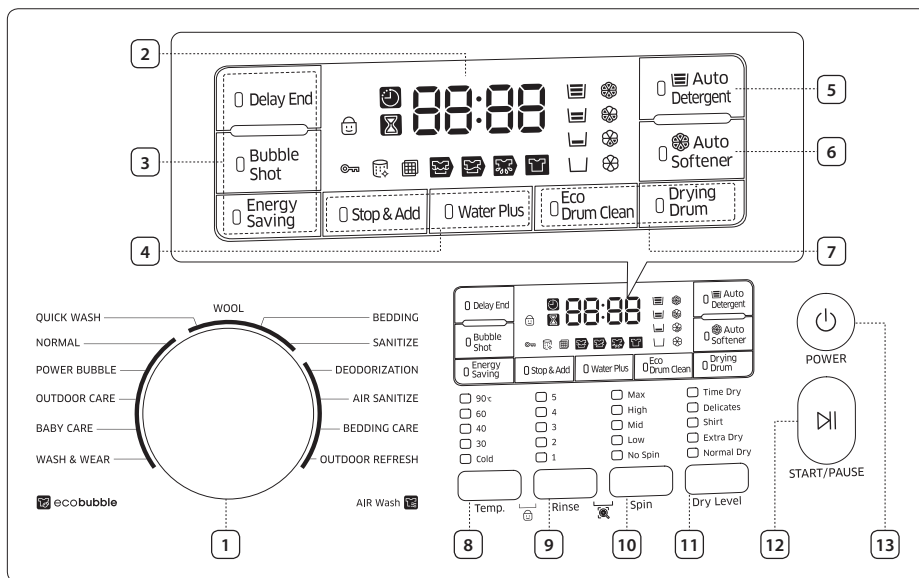

1	Program Selector	Select the tumble pattern and spin speed for the cycle.
2	Display	Provides instructions and diagnostics while keeping you updated on the program status and time information.
3	Options	Select a preferred option for the selected program. Available options are: Delay End , Bubble Shot and Energy Saving
4	User convenience	Special functions for user convenience. Available functions are: Stop & Add and Water Plus
5	Auto Detergent	The washing machine dispenses detergent automatically according to the load.
6	Auto Softener	The washing machine dispenses fabric softener automatically according to the load.
7	Maintenance	Useful for cleaning the drum. Two functions are provided: Eco Drum Clean and Drying Drum
8	Temp.	Press to select a water temperature: Cold Water, 30 °C, 40 °C, 60 °C and 90 °C.
9	Rinse	Press to add additional rinse cycles. The maximum number of rinse cycles is five.

10	Spin	<p>Press to select a speed for the spin cycle.</p> <ul style="list-style-type: none"> • No Spin: The laundry remains in the drum with no spinning after the final drain.
11	Dry Level	<p>Press to select a dry level: Normal Dry > Extra Dry > Shirt > Delicates > Time Dry (30 min. > 1:00 h > 1:30 h > 2:00 h > 2:30 h) > Disable or Off > Normal Dry</p> <ul style="list-style-type: none"> • Normal Dry: Use to dry laundry such as cotton, underwear, and linen. • Extra Dry: Useful to dry heavy garments such as jeans and towel. • Shirt: Use this if you want to finish the drying cycle in a moist state, which is ideal for easy ironing. • Delicates: Use to dry heat-sensitive garments. This protects the fibers of the garment by drying it at low temperatures. • Time Dry: Use to dry the laundry for a specified period of time according to the material, load and moisture.
12	START/PAUSE	Start or stop operation.
13	POWER	Press to turn on/off the washing machine. If the washing machine leaves inactive for more than 10 minutes, it will turn off automatically.

Simple steps to start

Standard steps

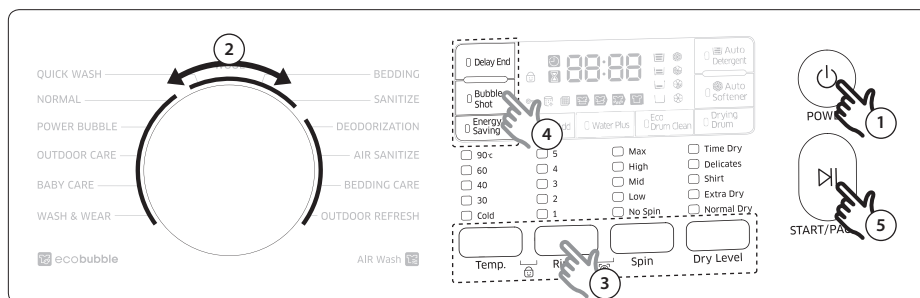

1. Press the **POWER** button to turn on the washing machine.
2. Turn the **Program Selector** to select a program.
3. Change the program settings (**Temp.**, **Rinse**, **Spin** and **Dry Level**) as necessary.
4. Select a preferred option(s) for the program. The corresponding indicator(s) will light up with the estimated running time on the display.
5. Press the **START/PAUSE** button.

Drying only

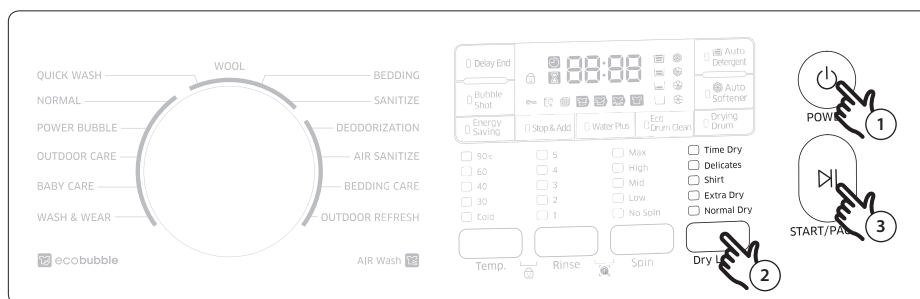

Follow these steps to dry the laundry that has finished washing or just gets wet.

1. Press the **POWER** button to turn on the washing machine.
2. Press the **Dry Level** button repeatedly until a desired dry level is set.
3. Press the **START/PAUSE** button.

To change the course during operation

1. Press the **START/PAUSE** button to stop operation.
2. Select a different program.
3. Press the **START/PAUSE** button again to start the new program.

Program overview

Standard programs

Program	Description & Max load (kg)	
NORMAL	<ul style="list-style-type: none">For average or lightly soiled cottons, bed linens, table linens, underwear, towels, or shirts.The washing time and the number of rinse cycles are automatically adjusted according to the load.	Max
POWER BUBBLE	<ul style="list-style-type: none">For badly soiled laundry.	17
OUTDOOR CARE	<ul style="list-style-type: none">For outdoor clothes, skiwear, and sportswear that are made of functional materials such as spandex, stretch, and micro-fiber.	3
BABY CARE	<ul style="list-style-type: none">Features a high-temperature wash and extra rinses to ensure that no detergent residues remains.	9
WASH&WEAR	<ul style="list-style-type: none">Specific to quickly wash and dry relatively clean laundry from washing to drying.	1
QUICK WASH	<ul style="list-style-type: none">Specific to less soiled garments with less than a 5.0 kg load.It takes at least 19 minutes, depending on the conditions such as the water pressure, water hardness, and/or extra options selected.A recommended amount of detergent is less than 20 g (for a 5.0 kg load)	5
WOOL	<ul style="list-style-type: none">Specific for machine-washable wool for loads less than 4.0 kg.This features gentle cradling and soaking to protect the wool fibers from shrinkage/distortion.Neutral detergent is recommended.	4
BEDDING	<ul style="list-style-type: none">For bed spreads, bed sheets, bedding covers, etc.For best results, wash only a single type of bedding and make sure the load weighs less than 4.0 kg.	4
SANITIZE	<ul style="list-style-type: none">For colorfast fabrics and heavily soiled garments, this program heats the supplied water up to 90 °C to eliminate bacteria.If you stop running the program while the washing machine is heating the water, the door will remain locked for your safety.	9

AIR Wash programs

AIR Wash refreshes garments through Samsung's unique air-washing technology without the need for water. AIR Wash is not a drying cycle. Use this only for dried garments.

Program	Description & Max load (kg)	
DEODORIZATION	<ul style="list-style-type: none"> Removes bad odors from the laundry. 	1
AIR SANITIZE	<ul style="list-style-type: none"> Removes bad odors and bacteria from the laundry. 	1
BEDDING CARE	<ul style="list-style-type: none"> Removes bad odors, bacteria, and dust from the laundry. 	1
OUTDOOR REFRESH	<ul style="list-style-type: none"> This helps restore the water repellency for waterproof breathable garment. 	2



CAUTION

Do not use any AIR Wash programs for the following items:

- Heat-sensitive garments made from leather, mink, fur, or silk.
- Underwear trimmed with laces or doll cushions, or trims on dress suits may become loose.
- Clothes trimmed with buttons can break.
- Clothes full of starch may become deformed
- Hard bedding
- Wooden pillows and neck rests
- Pillows or blankets filled with plastic beads or buckwheat
- Electric blankets, furry or bulky blankets
- Latex pillows
- on-waterproof breathable garments (risk of damage to the fibers)



For ripped, scratched or chemically-contaminated garments, the water repellency restoration efficiency can be reduced.

Options

Delay End

You can set the washing machine to finish your wash automatically at a later time, choosing a delay of between 1 to 19 hours (in 1 hour increments). The hour displayed indicates the time the wash will finish.

1. Turn the **Program Selector** to select a program. Then change the program settings if necessary.
2. Press the **Delay End** button repeatedly until a desired end time is set.
3. Press the **START/PAUSE** button.
The corresponding indicator turns on with the clock running.
4. To cancel the Delay End, restart the washing machine by pressing the POWER button.

Use case

You want to finish a two-hour course 3 hours later from now. For this, you add the Delay End option to the current course with the 3-hour setting, and press the START/PAUSE button at 2:00 p.m. Then, what happens? The washing machine starts operating at 3:00 p.m., and ends at 5:00 p.m. Provided below is the time line for this example.



Bubble Shot

Bubble Shot creates bubbles inside the drum that help the detergent penetrate into the fabric faster and more effectively. Bubble Shot produces cleaner results in less time and protects the fabric from being damaged.



- Bubble Shot is active by default for all washing programs.
- You cannot deactivate Bubble Shot for POWER BUBBLE, OUTDOOR CARE, WASH&WEAR, WOOL, and QUICK WASH.
- Once a washing program starts, the Bubble Shot cannot be activated/deactivated.
- Do not apply detergent excessively. A specified amount of detergent will generate sufficient bubbles.
- Clean the debris filter regularly to help generate sufficient bubbles.
- The size and quantity of the bubble depends on the detergent and laundry.
- Although bubbles are generated immediately after a program starts, it may take several minutes for them to become visible.

Energy Saving

This changes the program settings to reduce the overall power consumption.

This is not available when you set the water temperature to Cold.

User convenience & maintenance

Stop & Add

This allows you to add/remove laundry even after the wash has started, as long as the corresponding indicator is lit.

Water Plus

This adds extra water immediately before the rinse cycle to improve rinsing effects.

Eco Drum Clean

Clean the drum by removing dirt and bacteria from the drum.









- Run this once every 40 washes with no detergent or bleach applied.
- Make sure the drum is empty with no cleaning agents.

Drying Drum

Clean and dry the drum using the hot air after washing is complete.

Settings

Auto Detergent/Auto Softener

1. Press the **Auto Detergent** button to cycle through the following settings:
Standard  > Extra  > Disable  > Economy 
Press the **Auto Softener** button to cycle through the following settings:
Standard  > Extra  > Disable  > Economy 
 2. Hold down both the **Auto Detergent** and **Auto Softener** buttons for 3 seconds. Then, press the **Auto Detergent** or **Auto Softener** button to set the concentration level:
1 (Normal) > 2 (2X concentration) > 3 (3X concentration)
 3. Hold down the **Auto Detergent** and **Auto Softener** buttons again for 3 seconds to confirm your changes.
-  • If the **Auto Detergent** indicator blinks, refill the **Auto Detergent compartment** with the detergent.
 - If the **Auto Softener** indicator blinks, refill the **Auto Softener compartment** with the fabric softener.
 - If you select WOOL or OUTDOOR CARE, the **Auto Detergent/Auto Softener** will be disabled automatically. However, you can enable the function(s) manually after selecting a program.

Child Lock

- To prevent accidents by children or infants, Child Lock locks all buttons except for the **POWER** button.
 - To activate or deactivate Child Lock, hold down the **Temp.** and **Rinse** buttons simultaneously for 3 seconds.
-  When the Child Lock is activated, it doesn't lock any button until the washing machine starts washing. However, once washing begins, only the **POWER** button is available.

Smart check

To enable this function, you must first download the **Samsung Smart Washer** at the Play Store or the Apple Store, and install it on a mobile device featuring the camera operation.

The Smart Check function has been optimized for:

Galaxy & iPhone series (cannot be supported for some models)

1. Press and hold the **Rinse** and **Spin** buttons simultaneously for 3 seconds to enter the Smart Check mode.
 2. The washing machine starts the self-diagnosis procedure, and display an error code if an error is found.
 3. Run the **Samsung Smart Washer** app on your mobile device, and tap Smart Check.
 4. Present the mobile device to the washing machine's display panel so that the mobile device and the washing machine face each other. Then, the error code will be recognized automatically by the app.
 5. When the error code is recognized correctly, the app provides detailed information for the error with further actions.
- 
- The function name, Smart Check, may differ depending on the language.
 - If the washing machine reflects light on the display, the app may fail to recognize the error code.
 - If the app fails to recognize the Smart Check code consecutively, enter the error code manually onto the app screen.

Maintenance

Keep the washing machine clean to prevent deteriorated performance and to preserve its life cycle.

Eco Drum Clean

Perform this course regularly to clean the drum and to remove bacteria from it.

1. Press the **POWER** button to turn on washing machine.
2. Press the **Eco Drum Clean** button.
3. Press the **START/PAUSE** button.



The water temperature for Eco Drum Clean is set to 60 °C, which cannot be changed.



CAUTION

Do not use any cleaning agents for cleaning the drum. Chemical residue in the drum deteriorates the washing performance.

Eco Drum Clean reminder

- The Eco Drum Clean reminder  appears on the display once every 40 washes. It is advisable to perform the Eco Drum Clean regularly.
- When you first see this reminder, you can ignore the reminder for 6 consecutive times. From the 7th wash, the reminder does not appear. However, it appears again on the second 40th wash.

Drying Drum

Clean and dry the drum using the hot air after washing is complete.

1. Press the **POWER** button to turn on washing machine.
2. Press the **Drying Drum** button.
3. Press the **START/PAUSE** button.

Emergency drain

In case of a power failure, drain the water inside the drum before taking out the laundry.

1. Unplug the power cord of the washing machine from the main socket.
2. Gently press the top area of the filter cover to open.

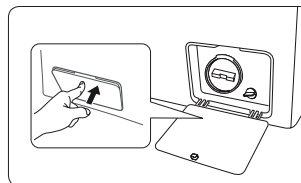

3. Gently pull out the emergency drain tube.

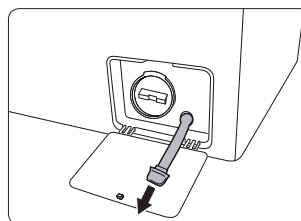

4. While holding the end of the drain tube, open the tube cap.

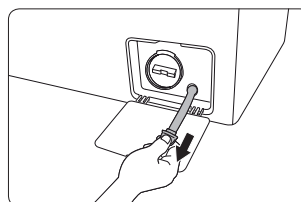

5. Let the water run into a container.
6. Close the tube cap, and reinsert the drain tube.
7. Close the filter cover.

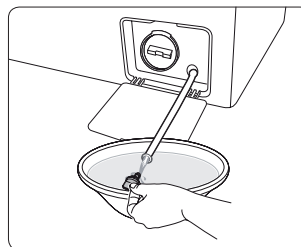

Cleaning

Surface of the washing machine

Use a soft cloth with a nonabrasive household detergent. Do not spray water onto the washing machine.

Debris filter

It is advisable to clean the debris filter 5 or 6 times a year to prevent its clogging. A clogged debris filter may reduce the bubble effect.

1. Turn off the washing machine, and unplug the power cord.
2. Drain the remaining water inside the drum by referring to **"Emergency drain"** on page 35.
3. Gently press the top area of the filter cover to open.
4. Turn the debris filter cap to the left, and drain off the remaining water.
5. Remove the debris filter.
6. Clean the debris filter using soft brushes. Make sure the drain pump propeller inside the filter is unclogged.
7. Reinsert the debris filter, and turn the filter cap to the right.

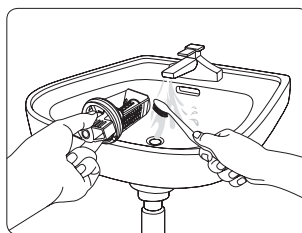
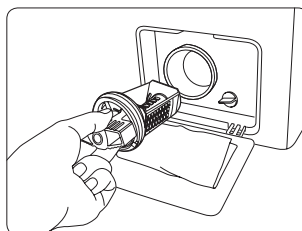

- To open the safety filter cap, push in and turn it anticlockwise. The spring of the cap helps to open the cap.
- To close the safety filter cap, turn it clockwise. The spring makes a rattling sound, which is normal.

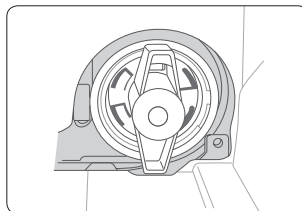

- If the debris filter is clogged, an error code of **"5E"** appears on the screen.



CAUTION

- Make sure the filter cap is closed properly after cleaning the filter. Otherwise, this may cause a leak.
- Make sure the filter is inserted properly after cleaning it. Otherwise, this may cause an operational failure or a leak.

Detergent Drawer

1. While holding down the **release lever (A)** on the inner of the drawer, slide open the drawer.
2. Remove the compartment cover by holding and pulling back **part (B)**.

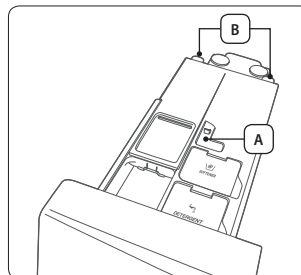

3. Remove the **Liquid softener container (C)** as shown.

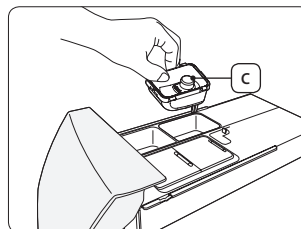

4. Clean the drawer components in flowing water using a soft brush.

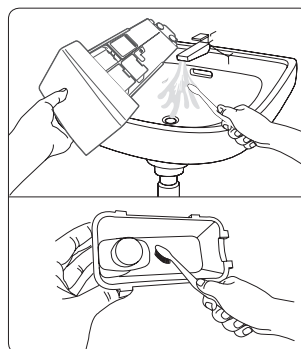

5. Clean the drawer recess using a soft brush.
6. Assemble the compartment cover firmly with the detergent drawer.
7. Slide the drawer inward to close it.

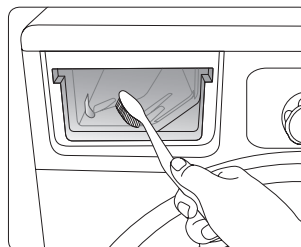

To remove remaining detergent, perform the **QUICK WASH** course with the drum being empty.

Recovery from freezing

The washing machine may freeze when it drops below 0 °C.

1. Turn off the washing machine, and unplug the power cord.
2. Pour warm water over the water tap to loosen the water supply hose.
3. Disconnect the water supply hose, and soak it in warm water.
4. Pour warm water into the drum and leave it for about 10 minutes.
5. Reconnect the water supply hose to the water tap.



If the washing machine still doesn't operate normally, repeat the above steps until it operates normally.

Care against an extended time of disuse

Avoid leaving the washing machine unused for an extended time.

If this is the case, drain the washing machine and unplug the power cord.

1. Turn the Course Selector to select a **QUICK WASH**.
2. Empty the drum, and press **START/PAUSE** button.
3. When the course is complete, close the water tap and disconnect the water supply hose.
4. Turn off the washing machine, and unplug the power cord.
5. Open the door to let air circulate through the drum.

Troubleshooting

Checkpoints

If you encounter a problem with the washing machine, first check the table below and try the suggestions.

Problem	Action
The washing machine won't start.	<ul style="list-style-type: none">• Make sure the washing machine is plugged in.• Make sure the door is properly closed.• Make sure the water tap is open.• Press the START/PAUSE button again.
Water supply is insufficient, or no water is supplied.	<ul style="list-style-type: none">• Open the water tap fully.• Make sure the water supply hose is not frozen.• Make sure the water supply hose is not kinked or clogged.• Clean the filter on the water supply hose.
Has detergent remaining in the detergent drawer after the wash cycle is complete	<ul style="list-style-type: none">• Make sure your washing machine is running with sufficient water pressure.• Make sure the detergent is added to the center of the detergent drawer.
The washing machine vibrates badly or makes noise.	<ul style="list-style-type: none">• Make sure the washing machine is installed on a level floor. If the floor is not level, use the levelling feet to adjust the level.• Make sure that the shipping bolts are removed.• Make sure the washing machine is not touching any other object.• Make sure the laundry load is balanced.
The washing machine does not drain and/or spin.	<ul style="list-style-type: none">• Make sure the drain hose is straightened all the way to the drain system.• Make sure the debris filter is not clogged.
The door won't open.	<ul style="list-style-type: none">• Press the START/PAUSE button to stop the washing machine.• The door stays locked as long as the washing machine is still hot inside after a heating operation.• Deactivate the Child Lock if activated.

If a problem persists, contact a local Samsung service centre.

Information codes

If the washing machine fails to operate, you may see an information code on the screen. Check the table below and try the suggestions.

Problem	Action
dE	<ul style="list-style-type: none">• Make sure the door is properly closed.• Make sure laundry is not caught in the door.
4E	<ul style="list-style-type: none">• Make sure the water tap is open.• Make sure the washing machine is operating with sufficient water pressure,• Clean the mesh filter as it may be clogged.
5E	<ul style="list-style-type: none">• Clean the debris filter as it may be clogged.• Make sure the drain hose is not kinked all the way to the drain system.
UE	<ul style="list-style-type: none">• The laundry load is unbalanced. Spread the laundry evenly.
CE/3E	<ul style="list-style-type: none">• This is not user-repairable. Contact a local Samsung service centre.

If any information code keeps appearing on the screen, contact a local Samsung service centre.

























Specifications

Protecting the environment

- This appliance is manufactured from recyclable materials. If you decide to dispose of this appliance, please observe local waste disposal regulations. Cut off the power cord so that the appliance cannot be connected to a power source. Remove the door so that animals and small children cannot get trapped inside the appliance.
- Do not exceed the detergent quantities recommended in the detergent manufacturer's instructions.
- Use stain removal products and bleaches before the wash cycle only when strictly necessary.
- Save water and electricity by only washing full loads (the exact amount depends upon the program used).

Fabric care chart

The following symbols provide garment care directions. The care labels include four symbols in this order: washing, bleaching, drying and ironing (and dry cleaning when necessary). The use of symbols ensures consistency among garment manufacturers of domestic and imported items. Follow the care label directions to maximize garment life and reduce laundry problems.

	Resistant material		Do not iron
	Delicate fabric		Can be dry cleaned using any solvent
	Item can be washed at 95 °C		Dry Clean
	Item can be washed at 60 °C		Dry clean with perchloride, lighter fuel, pure alcohol or R113 only
	Item can be washed at 40 °C		Dry clean with aviation fuel, pure alcohol or R113 only
	Item can be washed at 30 °C		Do not dry clean
	Hand wash only		Dry flat
	Dry clean only		Can be hung to dry
	Can be bleached in cold water		Dry on clothes hanger
	Do not bleach		Tumble dry, normal heat
	Can be ironed at 200 °C max		Tumble dry, reduced heat
	Can be ironed at 150 °C max		Do not tumble dry
	Can be ironed at 100 °C max		

Specification sheet

TYPE		FRONT LOADING WASHING MACHINE	
MODEL NAME		WD18H7*****	WD17H7*****
DIMENSIONS		W686× D811×H990 (mm)	
WATER PRESSURE		50 kPa ~ 800 kPa	
NET WEIGHT		105 kg	
WASH AND SPIN CAPACITY		18.0 kg	17.0 kg
DRY CAPACITY		10.0 kg	9.0 kg
POWER CONSUMPTION	WASHING	220 ~ 240 V	250 ~ 300 W
	WASHING AND HEATING		2200 ~ 2400 W
	DRYING		2100 ~ 2300 W
	SPIN		600 W
	PUMPING		35 W
PACKAGE WEIGHT		PAPER	1.3 kg
		PLASTIC	1.8 kg
SPIN REVOLUTIONS		1100 rpm	

The appearance and specifications of the product are subject to change without prior notice for purposes of product enhancement.

SAMSUNG

QUESTIONS OR COMMENTS?

COUNTRY	CALL	OR VISIT US ONLINE AT
NIGERIA	0800-726-7864	www.samsung.com/africa_en/support
SOUTH AFRICA	0860 SAMSUNG (726 7864)	www.samsung.com/support



DC68-03464H-02