



SM-R130

User Manual

Table of Contents

Read me first

Getting started

- 4 About Gear Circle
- 5 Package contents
- 5 Device layout
- 7 Charging the battery
- 9 Turning the Circle on and off
- 10 Wearing the Circle
- 12 Adjusting the volume

Connecting via Bluetooth

- 13 Bluetooth
- 14 Connecting to other devices
- 16 Connecting to two devices
- 17 Reconnecting and disconnecting devices

Using the Circle

- 18 Wearing status of the Circle
- 19 Calls
- 21 Playing music
- 21 Launching S Voice

Using the Samsung Gear app

- 22 Launching the Samsung Gear app
- 23 Connecting with a wearable device
- 23 Gear SoundAlive
- 24 Notifications
- 24 Settings
- 25 User manual

Appendix

- 26 Troubleshooting
- 28 Removing the battery (non-removable type)

Read me first

Please read this manual before using the device to ensure safe and proper use.

- Descriptions are based on the device's default settings.
- Images may differ in appearance from the actual product. Content is subject to change without prior notice.

Instructional icons



Warning: situations that could cause injury to yourself or others



Caution: situations that could cause damage to your device or other equipment



Notice: essential information for using the device



Note: notes, usage tips, or additional information

Getting started

About Gear Circle

With this Bluetooth headset (also referred to as Circle), you can connect with Bluetooth-enabled devices, such as smartphones and tablets. You can answer calls and play music from the connected devices.

You can also use the following features:

- The neckband vibrates to notify you of incoming calls and provides a comfortable fit.
- The earphones contain magnets so that they can be connected. You can end calls and stop listening to music by connecting the earphones together.
- You can answer incoming calls by disconnecting the earphones.
- You can use additional features, such as adjusting the sound effect or setting the notification feature, by connecting the Circle to other devices using the Samsung Gear app.
- The Circle can be connected with two devices simultaneously.
- The Circle delivers clear sound by reducing background noise.



- The Circle is compatible with devices that support Bluetooth connections.
- Some features may not be available for some connected devices.

Package contents

Check the product box for the following items:

- Device
- Earbud tips (3 pairs, S/M/L)
- Neck guides (for outdoor activities, S/M/L)
- Charger
- Quick start guide



- The items supplied with the device and any available accessories may vary depending on the region or service provider.
- The supplied items are designed only for this device and may not be compatible with other devices.
- Appearances and specifications are subject to change without prior notice.

Device layout

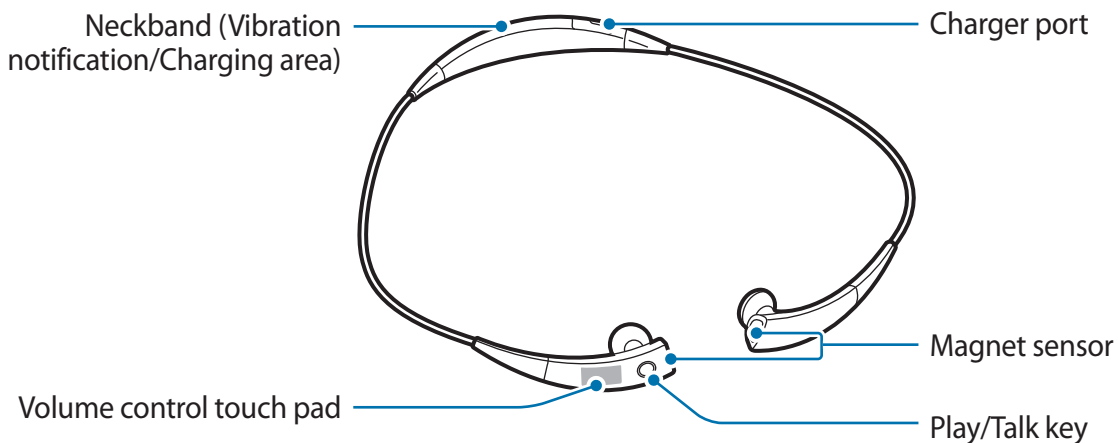

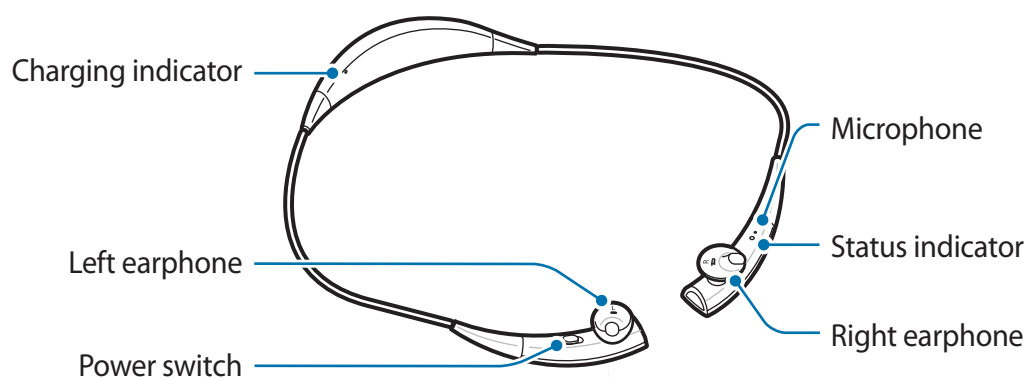

Controls

Name	Function
Power switch	<ul style="list-style-type: none"> Slide up or down to turn the Circle on or off.
Play/Talk key	<ul style="list-style-type: none"> Press to answer or end a call. Press to play music or pause playback. Press to re-enter Bluetooth pairing mode. Press twice to skip to the next song. Press and hold for 1 second to reject a call or to launch S Voice. Press and hold for 3 seconds to enter Bluetooth pairing mode.
Volume control touch pad	<ul style="list-style-type: none"> Swipe upwards or downwards to adjust the volume during media playback or a call. Swipe upwards or downwards to stop the Circle vibration when a call comes in.

Status indicator

Status	Colour
Bluetooth pairing mode	<ul style="list-style-type: none">• Blinking green, blue, and red
Power on	<ul style="list-style-type: none">• Blinking blue 3 times
Power off	<ul style="list-style-type: none">• Blinking red 3 times
Incoming call	<ul style="list-style-type: none">• Blinking blue

Charging indicator

Status	Colour
Charging	<ul style="list-style-type: none">• Red
Fully charged	<ul style="list-style-type: none">• Green

Charging the battery

Charge the battery before using the Circle for the first time or when the Circle has been unused for extended periods. A computer can be also used to charge the Circle by connecting them via the USB cable.



Use only Samsung-approved chargers, batteries, and cables. Unapproved chargers or cables can cause the battery to explode or damage the headset.



If the battery is completely discharged, the headset cannot be turned on immediately when the charger is connected. Allow a depleted battery to charge for a few minutes before turning on the headset.

- 1 Open the charger port cover.
- 2 Plug the small end of the charger into the charger port of the Circle.

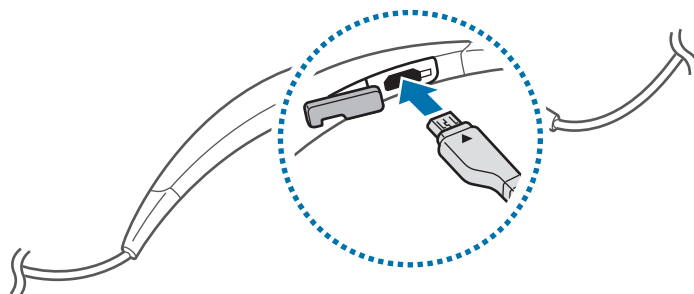

Connecting the charger improperly may cause serious damage to the device. Any damage caused by misuse is not covered by the warranty.

- 3 Plug the large end of the charger into an electric socket.



- While charging, the device may heat up. This is normal and should not affect the device's lifespan or performance. If the battery gets hotter than usual, the charger may stop charging.
- If the device is not charging properly, take the device and the charger to a Samsung Service Centre.

- 4 After fully charging, disconnect the Circle from the charger. First unplug the charger from the Circle, and then unplug it from the electric socket.



To save energy, unplug the charger when not in use. The charger does not have a power switch, so you must unplug the charger from the electric socket when not in use to avoid wasting power. The charger should remain close to the electric socket and easily accessible while charging.

Viewing the battery power level

When you connect the Circle to other devices using the Samsung Gear app, you can view the Circle's battery power level on the Samsung Gear's main screen. Refer to [Launching the Samsung Gear app](#) for more information.



- When the battery power is low, the Circle beeps and the status indicator flashes red.
- Calls on the Circle will automatically transfer to the connected device if the Circle is turned off.
- The Circle can be used while it is charging, but it may take longer to fully charge the battery.

Turning the Circle on and off

Slide the Power switch up to turn on the Circle. The status indicator will flash blue 3 times.

To turn off the Circle, slide the Power switch down. After the status indicator flashes red 3 times, the Circle will turn off.

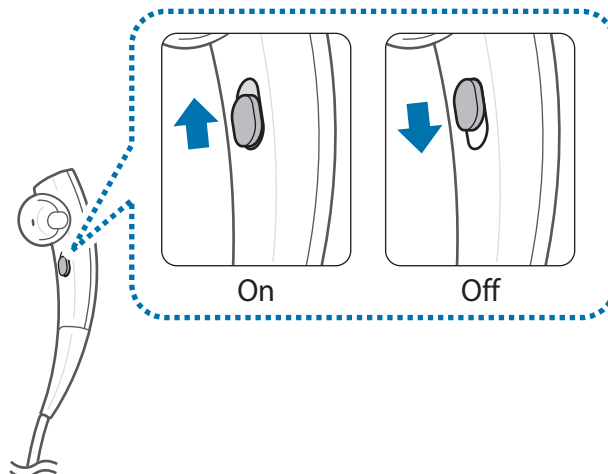

Follow all posted warnings and directions from authorised personnel in areas where the use of wireless devices is restricted, such as aeroplanes and hospitals.

Wearing the Circle

- 1 Select a set of the provided earbud tips that fit your ears.
- 2 Select the earbud tip for the left or right ear.
Each earbud tip is marked with L for the left ear and R for the right ear.
- 3 Cover the latch at the bottom of the earphone with the earbud tip.

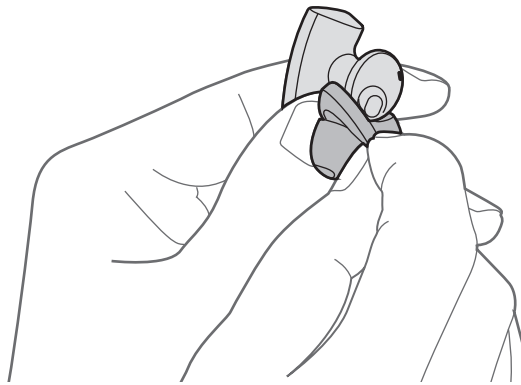

- 4 Hold the bottom of the earphone and cover the rest of the earphone with the earbud tip.



- Do not put the earphones in your ears without earbud tips.
- Do not pull the earbud tip excessively. The earbud tip may tear.

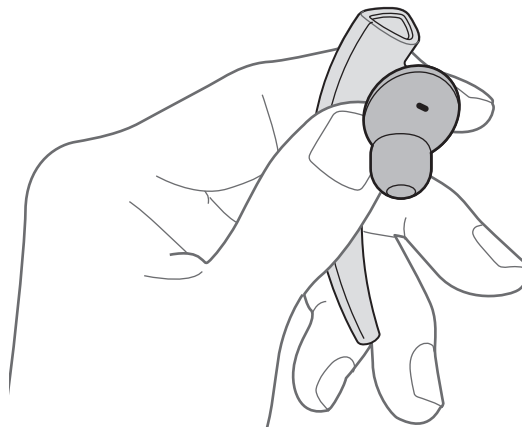

- 5 Turn the earphone upside down and check the covering. Cover the other earphone with an earbud tip.
- 6 Wear the Circle as shown in the image below.



Using the neck guide

Wearing the Circle using the neck guide (for outdoor activities) will prevent the neckband from falling off of your neck.

- 1 Insert the neckband into the neck guide.

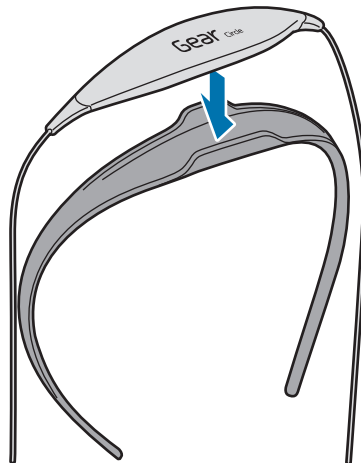

2 Wear the Circle as show in the image below.



Adjusting the volume

Swipe upwards on the Volume control touch pad to increase the sound while you are wearing the earphones.

Swipe downwards on the Volume control touch pad to decrease the sound while you are wearing the earphones.

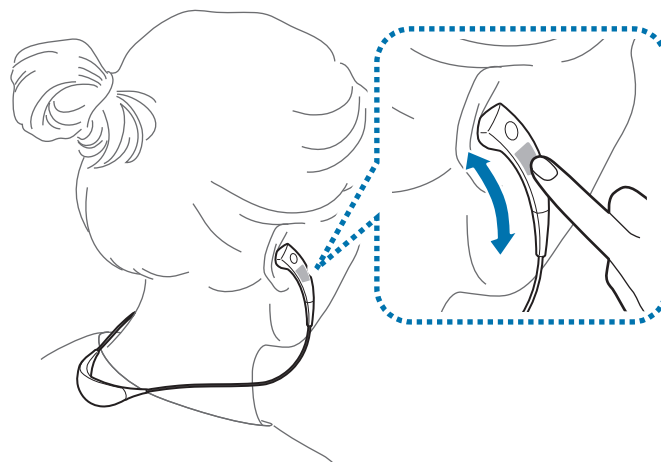

- The Volume control touch pad cannot be used while the earphones are connected.
- When the volume reaches its maximum or minimum value, the Circle will vibrate.

Connecting via Bluetooth

Bluetooth

About Bluetooth

Bluetooth is a wireless technology standard that uses a 2.4 GHz frequency to connect to various devices over short distances. It can connect and exchange data with other Bluetooth enabled devices, such as mobile devices, computers, printers, and other digital home appliances, without connecting via cables.

Notices for using Bluetooth

- To avoid problems when connecting your device to another device, place the devices close to each other.
- Ensure that your device and the other Bluetooth device are within the Bluetooth connection range (10 m). The distance may vary depending on the environment the devices are used in.
- Ensure that there are no obstacles between the headset and a connected device, including human bodies, walls, corners, or fences.
- Do not touch the Bluetooth antenna of a connected device.
- Bluetooth uses the same frequency as some industrial, scientific, medical, and low power products and interference may occur when making connections near these types of products.
- Some devices, especially those that are not tested or approved by the Bluetooth SIG, may be incompatible with the headset.
- Do not use the Bluetooth feature for illegal purposes (for example, pirating copies of files or illegally tapping communications for commercial purposes).

Connecting to other devices

To use the Circle, you must pair it with another device. After pairing with a device, the Circle will automatically connect to the device in the future.

You can connect the Circle to other devices using the Samsung Gear app or via Bluetooth.

Connecting devices using the Samsung Gear app

Install the Samsung Gear app on the other device and connect the Circle to the device.



The Samsung Gear app is available for Samsung smartphones that have more than 1 GB of memory and runs Android 4.2.2 or higher.

- 1 **Other device** Download the Samsung Gear app from **GALAXY Apps**. You can also visit apps.samsung.com/gear to download the Samsung Gear app.
- 2 **Other device** Turn on the Bluetooth feature.
- 3 **Circle** Turn on the Circle.
When you turn on the Circle for the first time, the Circle automatically enters Bluetooth pairing mode. The status indicator flashes green, blue, and then red for 3 minutes.
- 4 **Other device** On the Apps screen, tap **Samsung Gear**.
- 5 **Other device** From the search results, tap **Gear Circle**.

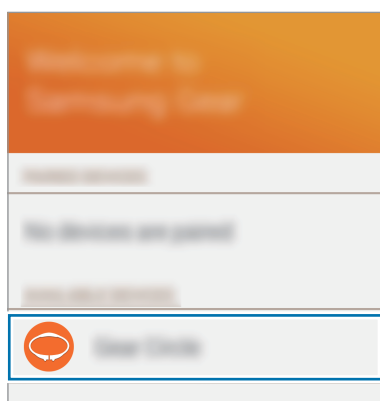

6 Other device Read and agree to the terms and conditions, and then tap **Finish**.

When the devices are connected properly, the Circle will beep and vibrate.

Connecting devices via Bluetooth

1 Circle Turn on the Circle.

When you turn on the Circle for the first time, the Circle automatically enters Bluetooth pairing mode. The status indicator flashes green, blue, and then red for 3 minutes.

2 Other device Turn on the Bluetooth feature.

3 Other device Access the Bluetooth menu and search for Bluetooth devices.

4 Other device From the search results, tap **Gear Circle**.

When the devices are connected properly, the Circle will beep and vibrate.



- Place the Circle near to the device to connect.
- If the Circle does not enter Bluetooth pairing mode, separate the earphones and press and hold the Play/Talk key for 3 seconds. While the earphones are connected to each other, the Circle cannot enter Bluetooth pairing mode.
- You can connect to another device only after disconnecting a previously connected device. If the Circle is already connected to another device, end the connection and restart the pairing.
- The method for connecting via Bluetooth may vary depending on the connected devices. For more information, refer to the user manual of the connected device.

Connecting to two devices

The Circle can connect to two Bluetooth-enabled devices at the same time.

When you connect the Circle to two devices, the last device you connect is recognised as the primary device. The other device is recognised as the secondary device. If you connect the Circle to two smartphones, only one smartphone can be connected using the Samsung Gear app. The device that is connected using the Samsung Gear app is always the primary device.

If a call comes in to two devices at the same time, you can answer the primary device's call using the Circle. When you launch **S Voice** or answer a call using the Circle's Play/Talk key, the primary device will perform the actions.

- 1 Connect to the Circle with a device via Bluetooth.
- 2 Separate the earphones and press and hold the Play/Talk key for 3 seconds.
The Circle enters Bluetooth pairing mode and the first device will be disconnected.
- 3 On the second device, access the Bluetooth menu and connect with the Circle.
- 4 On the first device, reconnect the Circle.



- When the two connected devices play music simultaneously, the Circle only streams from one device. When you pause the currently-playing file, the file playing on the other device will play automatically.
- When streaming files from a computer to the Circle using a Bluetooth dongle, the streaming can be cut off.
- This feature may not be supported on some devices.

Reconnecting and disconnecting devices

Reconnecting the devices

The connection between the Circle and the connected device may disconnect when using the devices over long distances. When the connection is ended, the Circle will beep and vibrate. Place the Circle near the device to reconnect. When the devices are reconnected, the Circle will beep and vibrate.

If the connection is lost due to a problem with the device, press the Play/Talk key on the Circle or access the Bluetooth menu on the device. If the earphones are connected, separate them and reconnect the devices.

Disconnecting the devices

Turn off the Circle or deactivate the Bluetooth feature on the connected device.

Unpairing the devices

Use the connected device's Bluetooth menu to unpair the devices. For more details, refer to the device's user manual.

To reconnect the device and the Circle, pair the devices again.

Using the Circle

Wearing status of the Circle

The earphones contain magnets so that they can be connected.

The method for receiving calls differs depending on whether the earphones are connected or separated.



The Gear Circle contains magnets in its earbuds. The American Heart Association (US) and the Medicines and Healthcare Products Regulatory Agency (UK) both warn that magnets can affect the operation of implanted pacemakers, cardioverters, defibrillators, insulin pumps or other electro medical devices (collectively, “Medical Device”) within the range of 15 cm (6 inches). If you are a user of any of these Medical Devices, **DO NOT USE THE GEAR CIRCLE UNLESS YOU HAVE CONSULTED WITH YOUR PHYSICIAN.**



- Do not store your device near magnetic fields. Magnetic stripe cards, including credit cards, phone cards, passbooks, and boarding passes, may be damaged by magnetic fields.
- Do not bend or twist the device. Do not apply excessive pressure to the device.
- Do not pull on any part of the device excessively.
- Wearing the Circle: Putting the earphones on your ears or wearing the Circle around your neck while the earphones are not connected to each other.



- Connecting the earphones: The earphones are connected to each other.

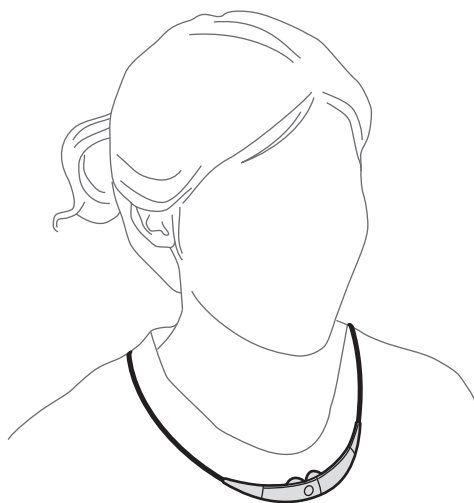

Calls

Answering and rejecting calls

Answering a call

When a call comes in while you are wearing the Circle, the Circle will beep and vibrate. Press the Play/Talk key to answer the call.

When a call comes in while the earphones are connected, the Circle will vibrate. Separate the earphones and put them on your ears. When you separate the earphones, the call will be received.

Rejecting a call

Press and hold the Play/Talk key for 1 second or connect the earphones.



- When a call comes in, the Circle will vibrate. To stop the vibration, swipe upwards or downwards on the Volume control touch pad.
- If a call comes in while the Circle is connected with a smartphone, the Circle reads the caller information. You can answer or reject calls using voice commands. Avoid saying a voice command while the Circle is vibrating.

Using options during a call

Adjusting the volume

During a call, swipe upwards or downwards on the Volume control touch pad.

Switching sound output

Use the related menu on the connected device to switch sound output between the Circle and the connected device.

When the earphones are connected, you can automatically switch the sound output to the Circle by separating the earphones.

Placing a call on hold

During a call, press and hold the Play/Talk key.

To retrieve the held call, press and hold the Play/Talk key again.

Answering a second call

When a call comes in during a call, the Circle will beep.

To end the first call and answer the second call, press the Play/Talk key.

To put the first call on hold and answer the second call, press and hold the Play/Talk key. To switch between the current call and the held call, press and hold the Play/Talk key.

Ending a call

Press the Play/Talk key or reconnect the earphones.

Playing music

Play music from the connected devices. When you answer a call while a file is playing, the file will pause and resume automatically when the call is ended.

Playing music

Press the Play/Talk key.

The most recently-played music file will play automatically in the default music app installed on the connected device.

Pausing and resuming playback

Press the Play/Talk key or connect the earphones to pause playback.

To resume playback, separate the earphones and press the Play/Talk key.

Skipping to the next song

Press the Play/Talk key twice to skip to the next song while playing music.

Adjusting the volume

Swipe upwards or downwards on the Volume control touch pad to adjust the volume.



Adjust the volume on the connected device when you cannot hear sounds on your Circle at full volume.

Launching S Voice

While you are wearing the Circle, press and hold the Play/Talk key for 1 second.

If the connected device support **S Voice**, you can use the app via the Circle.

Using the Samsung Gear app

Launching the Samsung Gear app

The Samsung Gear app allows wearable devices, such as the Gear, to connect to a smartphone. This app allows you to use additional features. If the Circle and the other device are connected using the Samsung Gear app, you can access the features, such as adjusting the sound effect or setting the notification feature.



- The Samsung Gear app is available for Samsung smartphones that have more than 1 GB of memory and runs Android 4.2.2 or higher.
- You can simultaneously connect the Circle, a smartphone, and a wearable device using the Samsung Gear app.
- If you connect the Circle to two smartphones, only one smartphone can be connected using the Samsung Gear app.
- Some features may not be available for some connected devices.

On the connected device, open the Apps screen and tap **Samsung Gear** to launch it.

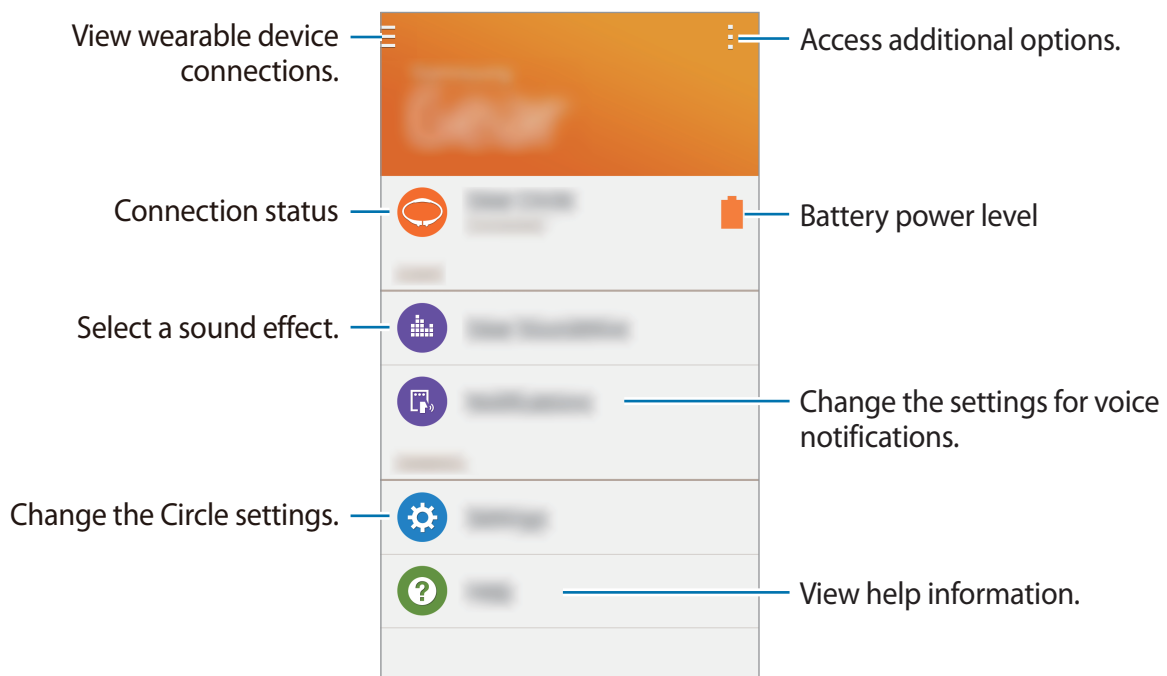

Connecting with a wearable device

On the Samsung Gear main screen, tap  → **Search for new devices**. You can connect to another wearable device only after disconnecting the connected Circle.

Gear SoundAlive

Select a sound effect or adjust the sound effect manually.

On the Samsung Gear main screen, tap **Gear SoundAlive**.

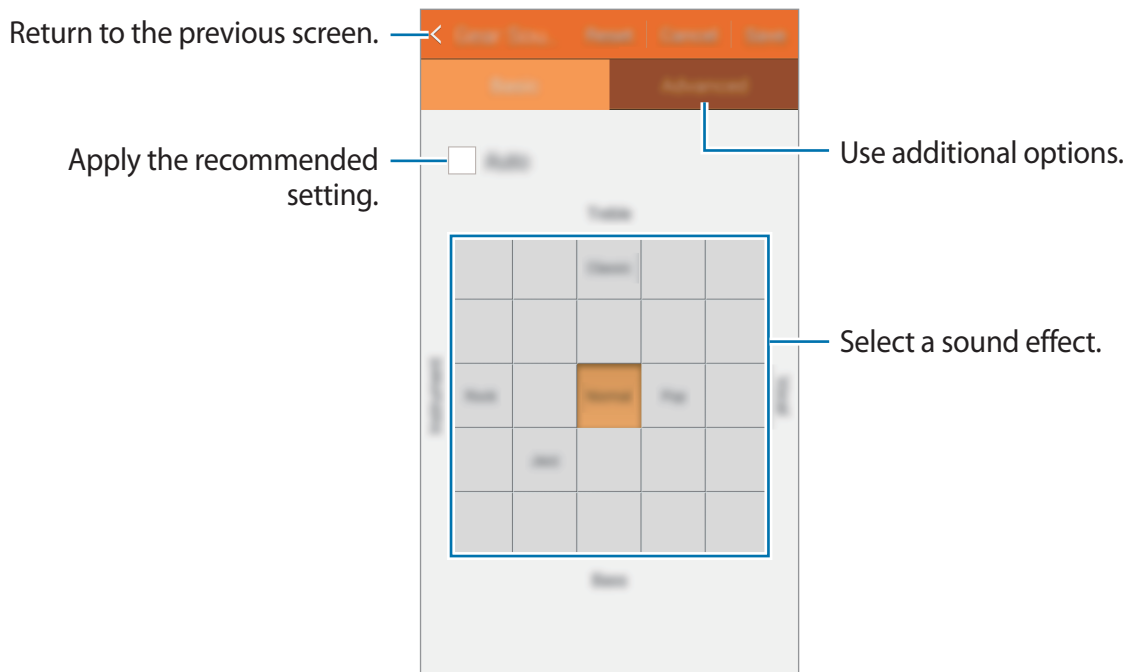

Notifications

Set the device to notify you of missed calls and new messages received on the connected device via voice notification to the Circle. You can skip to the next notification by pressing the Play/Talk key. To stop notifications, connect the earphones.

On the Samsung Gear main screen, tap **Notifications**, tap the **Notifications** switch to activate it, and then select apps.

Blocking notifications

Set the device to restrict voice notifications to the Circle when the screen of the connected device is turned on.

Tick **Limit notifications**.

Notification settings

Set the Circle to receive voice notifications from apps with or without detailed information.

Tap  next to the apps you want and select an option.

Settings

Configure the Circle and set various options.

On the Samsung Gear main screen, tap **Settings**.

Connected earphones settings

Set the Circle to end a call or pause playback when you connect the earphones together.

Tap **Clasp control** and tap the **Clasp control** switch to activate it.

To set whether the device resumes playback when you disconnect the earphones, tap  next to **Media control** and select an option.

To set the device not to pause playback when you connect the earphones, deselect **Media control**.

Using S Voice

Set the device to launch S Voice when you press and hold the Play/Talk key on the Circle for 1 second.

Tap **Voice control** and tap the **Voice control** switch to activate it.

To set the device to receive or reject calls using voice commands, tick **Incoming calls**.

To select a priority device to use with voice commands, tap **Default voice control dev** and select an option.



Setting the priority device is only available when the Circle is simultaneously connected with a smartphone and a wearable device.

Using the hearing monitor

View the hearing damage level that can occur when you are exposed to excessive volume.

It measures your exposure to loud sounds and shows as a percentage based on the daily noise exposure level by the Noise at Work Regulations.

Tap **Volume monitor** and tap the **Volume monitor** switch to activate it.

Setting the priority device

Select a priority device to play music file when the Circle is connected to two devices.

Tap **Default play back Device** and select an option.



This feature is only available when the Circle is simultaneously connected with a smartphone and a wearable device.

User manual

You can view information about using the Circle.

On the Samsung Gear main screen, tap **User manual**.

Appendix

Troubleshooting

Before contacting a Samsung Service Centre, please attempt the following solutions. Some situations may not apply to your Circle.

Your Circle does not turn on

When the battery is completely discharged, your Circle will not turn on. Charge the battery completely before turning on the Circle.

The battery does not charge properly (For Samsung-approved chargers)

- Ensure that the charger is connected properly.
- If the battery terminals are dirty, the battery may not charge properly or the device may turn off. Wipe both gold-coloured contacts and try charging the battery again.
- The battery in the Circle is not user-replaceable. To have the battery replaced, visit a Samsung Service Centre.

Another Bluetooth device cannot locate your Circle

- Ensure that your Circle is in Bluetooth pairing mode.
- Ensure that your Circle and the other Bluetooth device are within the Bluetooth connection range (10 m).

Another Bluetooth device is not located

- Ensure that the Bluetooth wireless feature is activated on the device you wish to connect to.
- Ensure that your Circle and the other Bluetooth device are within the maximum Bluetooth range (10 m).

Bluetooth connect is often disconnected

- Ensure there are no obstacles between the devices, the operating distance may be reduced.
- Ensure that your Circle and the other Bluetooth device are within the maximum Bluetooth range (10 m).

You cannot hear others speaking

- Adjust the Circle volume.
- Adjust the volume on the connected device when you cannot hear sounds on your Circle at full volume.

Sound echoes during a call

Adjust the volume by swiping upwards or downwards on the Volume control touch pad. Or, move to another area.

Others cannot hear you speaking on a call

Ensure that you are not covering the built-in microphone.

Audio quality is poor

- Wireless network services may be disabled due to issues with the service provider's network. Ensure to keep the Circle away from electromagnetic waves.
- Ensure that your Circle and the other Bluetooth device are within the maximum Bluetooth range (10 m).

The Circle works differently as described in the manual

- Available functions may differ depending on the connected device.
- Some features cannot be used when two devices are connected with the Circle at the same time.

Removing the battery (non-removable type)



- These instructions are only for your service provider or an authorised repair agent.
- Damage or faults caused by the unauthorised removal of the battery are not covered by the warranty.
- To remove or replace the battery, contact your service provider or an authorised repair agent.

- 1 Open the charger port cover, and insert a flat edged tool into the gap beside the charger port.

Then, open the cover by lifting the tool upwards as shown in the image below.

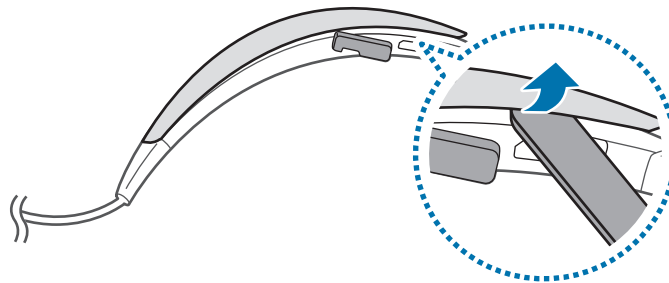

- 2 Remove the cover.



Be careful not to damage your fingernails when you remove the cover.

- 3 Disconnect the battery connector and remove the tape as shown in the image below.

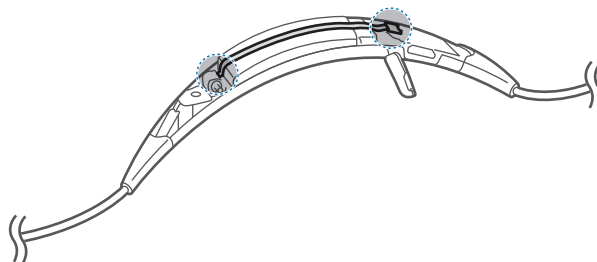

- 4 Pull up the battery and cut the cable where shown in the image below.

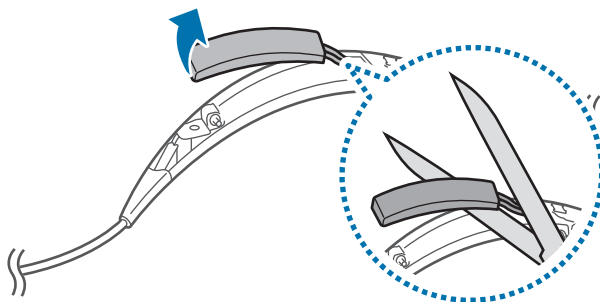

- 5 Remove the battery.

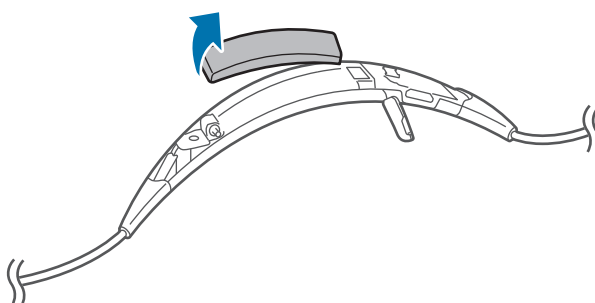

Copyright

Copyright © 2014 Samsung Electronics

This manual is protected under international copyright laws.

No part of this manual may be reproduced, distributed, translated, or transmitted in any form or by any means, electronic or mechanical, including photocopying, recording, or storing in any information storage and retrieval system, without the prior written permission of Samsung Electronics.

Trademarks

- SAMSUNG and the SAMSUNG logo are registered trademarks of Samsung Electronics.
- Bluetooth® is a registered trademark of Bluetooth SIG, Inc. worldwide.
- All other trademarks and copyrights are the property of their respective owners.