

1		This indicator turns on when power is supplied to the HUB.
2		This indicator blinks when the HUB is in pairing mode. After pairing is complete, this indicator stops flashing and operates in normal mode. <input checked="" type="checkbox"/> Pairing mode continues for a set time period. The indicator may keep blinking after pairing is completed.
3		This indicator turns on when the HUB is connected to a wireless router with an Ethernet cable.
4		This indicator turns on when the HUB is set to Repeater mode and used to expand wireless Wi-Fi coverage in a network that includes another HUB and a wireless router. <input checked="" type="checkbox"/> If you have trouble connecting the HUB and Wireless Audio - Multiroom because the signal is blocked or the distance between them is too great, add a new HUB in Repeater mode to expand wireless coverage.

# Wireless Audio - Multiroom HUB

## User Manual



AH68-02717A-01

## Rear Panel

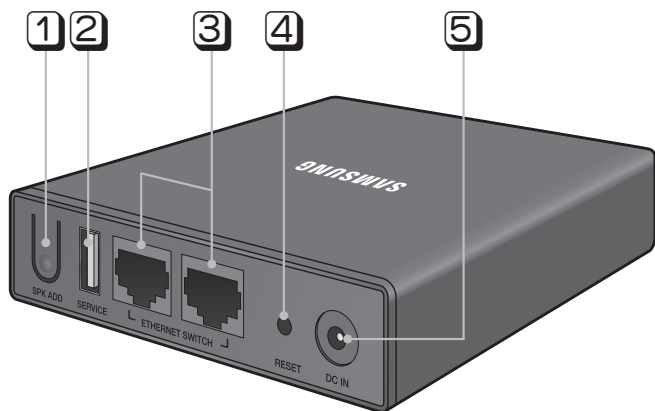

1	SPK ADD	Press this button to set the HUB to Pairing mode when adding an additional Wireless Audio - Multiroom or to switch the HUB to Repeater mode. (Press and hold for 1 second to switch to Pairing mode. Press and hold for 10 seconds to switch to Repeater mode.)
2	SERVICE	Used to update the firmware. <input checked="" type="checkbox"/> The <b>SERVICE</b> port is only for updating.
3	ETHERNET SWITCH	Used to connect a LAN cable. <input checked="" type="checkbox"/> If you want to connect another wired device to the router that the HUB is connected to, and all the router's wired ports are occupied, you can connect it to an unoccupied LAN port on the HUB. Connecting to the HUB provides the same functionality as being connected to the router. However, the link to the router will be lost if you power off (unplug) the HUB. Note : The HUB and the router must have a hard-wired connection.
4	RESET	Press the <b>RESET</b> button with a pen tip for 5 seconds to reset the HUB.
5	DC IN	Connector for the power cable.

## What's included



LAN cable

Power Adaptor

User Manual

## Connecting the HUB to Your Wi-Fi Network

- A Wireless Audio - Multirooms can be used anywhere your Wi-Fi signal reaches.

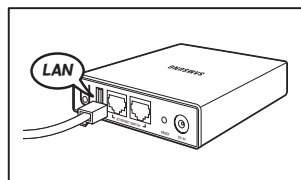

- 1 Connect the HUB to your router or modem using a LAN cable.

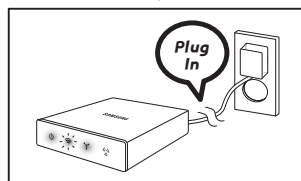

- 2 Plug the included power cable into the back of the HUB, and then plug the power cord into a wall socket.

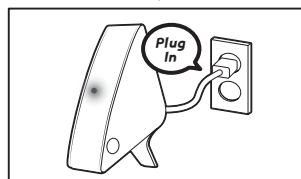

- 3 After the Pairing Indicator on the HUB lights, plug in the Wireless Audio - Multiroom.  
(For more information, see the User Manual.)

Adding a HUB

An Wireless Audio - Multiroom and a HUB may not pair successfully if the Wireless Audio - Multiroom and HUB are too far apart or are on different floors. In such cases, you can link two HUBs together by setting the second HUB to Repeater mode. The additional HUB amplifies the signal and lets you pair the Wireless Audio - Multiroom to the closest HUB.

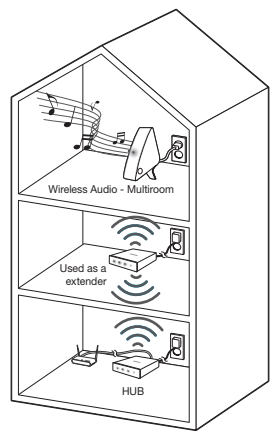

- 1 Set the HUB that is connected to the wireless router to Pairing mode by pressing its **SPK ADD** button for 1 second.
  - 2 Plug in the new HUB you are using as an extender, and then press its **SPK ADD** button for 10 seconds.
  - 3 The newly added HUB's LED indicators turn off and on, and it switches to Repeater mode.
  - 4 Once the connection between the two HUBs has been established, the added HUB's ( ) indicator stops blinking.
- If your smart device is not connected to the wireless router with a Wi-Fi connection, the Wireless Audio - Multiroom will not appear on the Samsung Multiroom app.
  - Place the HUB that is in Repeater mode in an appropriate location between the Wireless Audio - Multiroom and the HUB that is connected to the wireless router.
  - You can set only one HUB to Repeater mode.

Recommendation - EU Only

- Hereby, Samsung Electronics, declares that this WAM250 is in compliance with the essential requirements and other relevant provisions of Directive 1999/5/EC. The official Declaration of Conformity may be found at <http://www.samsung.com>, go to Support > Search Product Support and enter the model name. This equipment may be operated in all EU countries. This equipment may only be used indoors.



Correct Disposal of This Product (Waste Electrical & Electronic Equipment)

(Applicable in the European Union and other European countries with separate collection systems)

This marking on the product, accessories or literature indicates that the product and its electronic accessories (e.g. charger, headset, USB cable) should not be disposed of with other household waste at the end of their working life. To prevent possible harm to the environment or human health from uncontrolled waste disposal, please separate these items from other types of waste and recycle them responsibly to promote the sustainable reuse of material resources. Household users should contact either the retailer where they purchased this product, or their local government office, for details of where and how they can take these items for environmentally safe recycling. Business users should contact their supplier and check the terms and conditions of the purchase contract. This product and its electronic accessories should not be mixed with other commercial wastes for disposal.

- 8 Do not install near any heat sources such as radiators, heat registers, stoves, or other apparatus (including AV receivers) that produce heat.
- 9 Do not defeat the safety purpose of the polarized or grounding-type plug. A polarized plug has two blades with one wider than the other. A grounding type plug has two blades and a third grounding prong. The wide blade or the third prong are provided for your safety. If the provided plug does not fit into your outlet, consult an electrician for replacement of the obsolete outlet.
- 10 Protect the power cord from being walked on or pinched particularly at plugs, convenience receptacles, and the point where it exits the apparatus.
- 11 Only use attachments/accessories specified by the manufacturer.
- 12 Use only with the cart, stand, tripod, bracket, or table specified by the manufacturer, or sold with the apparatus. When a cart is used, use caution when moving the cart/apparatus combination to avoid injury from tip-over.
- 13 Unplug this apparatus during lightning storms or when unused for long periods of time.
- 14 Refer all servicing to qualified service personnel. Servicing is required when the apparatus has been damaged in any way, such as when the power-supply cord or plug is damaged, liquid has been spilled or objects have fallen into the apparatus, the apparatus has been exposed to rain or moisture, does not operate normally, or has been dropped.



Safety precautions

Power Supply Precautions

- Do not overload outlets or extension cords.
  - This may result in abnormal heat or fire.
- Do not plug in or unplug the power cord with wet hands.
- Do not place the product near heating equipment.
- To clean the power plug blades, remove the plug from the wall outlet and wipe the blades with a dry cloth only.
- Do not bend the power cord or pull it forcefully.
- Do not put heavy objects on the power cord.
- Do not plug the power cord into a loose or damaged outlet.
- Fully insert the power cord's plug into the the wall outlet so that the plug is firmly attached to the outlet.
  - If the connection is unstable, there is a risk of fire.

Regulatory Compliance Statements

	<b>CAUTION</b> <b>RISK OF ELECTRIC SHOCK</b> <b>DO NOT OPEN</b>	
The lighting flash and arrowhead within the triangle is a warning sign alerting you to dangerous voltage inside the product.	<b>CAUTION: TO REDUCE THE RISK OF ELECTRIC SHOCK, DO NOT REMOVE THE COVER (OR BACK). NO USER SERVICEABLE PARTS INSIDE. REFER SERVING TO QUALIFIED SERVICE PERSONNEL.</b>	The explanation point within the triangle is a warning sign alerting you to important instructions accompanying the product.

Warning

- To reduce the risk of fire or electric shock, do not expose this appliance to rain or moisture.
  - Do not expose this apparatus to dripping or splashing. Do not put objects filled with liquids, such as vases on the apparatus.
  - To turn this apparatus off completely, you must pull the power plug out of the wall socket. Consequently, the power plug must be easily and readily accessible at all times.
- CAUTION**
- TO PREVENT ELECTRIC SHOCK, MATCH WIDE BLADE OF PLUG TO WIDE SLOT, FULLY INSERT.
- This apparatus shall always be connected to a AC outlet with a protective grounding connection.
  - To disconnect the apparatus from the mains, the plug must be pulled out from the mains socket, therefore the mains plug shall be readily operable.

CAUTION

- Do not expose this apparatus to dripping or splashing. Do not put an object filled with liquid, such as a vase, on the apparatus.
- To turn this apparatus off completely, you must pull the power plug out of the wall socket. Consequently, the power plug must be easily and readily accessible at all times.

Wiring the Main Power Supply Plug (UK Only)

IMPORTANT NOTICE

The mains lead on this equipment is supplied with a moulded plug incorporating a fuse. The value of the fuse is indicated on the pin face of the plug and if it requires replacing, a fuse approved to BS1362 of the same rating must be used. Never use the plug with the fuse cover removed. If the cover is detachable and a replacement is required, it must be of the same colour as the fuse fitted in the plug.

- Do not drop the product. In case of a mechanical breakdown, disconnect the power cord and contact a Samsung service center.
  - There is a risk of fire or electric shock.
- Do not hold or pull the product by the power cord or the signal cable.
  - A damaged cable can cause the product to malfunction, cause a fire, and poses a risk of electric shock.
- Do not use or keep flammable materials near the product.
- If the product emits an abnormal sound or a burnt smell or smokes, unplug the power-cord immediately and contact a Samsung service center.
- If you smell gas, ventilate the room immediately. Do not touch the power plug of the product. Do not turn the product off or on.
- Do not strike or subject the product to a sudden shock. Do not pierce the product with a sharp object.

Cleaning Precautions

- Never use alcohol, solvents, waxes, benzene, thinners, air freshener, or lubricants to clean the product, or spray insecticide on the product.
  - Using any of these materials can discolor the exterior coating or cause it to split or peel off, or remove the labelling on the product.
- To clean the product, unplug the power cord, and then wipe the product with a clean, dry, soft cloth (Microfiber, cotton).
  - Avoid leaving dust on the product. Dust can scratch its surface.

About the Network Connection

- Depending on the wireless router used, some network operations may perform differently.
- For detailed information on networking with a wireless router or modem, refer to the router's or modem's documentation.
- Select one wireless channel that is not used currently. If the selected channel is used by another communication device nearby, radio interference may result in communication failure.
- In compliance with the newest Wi-Fi certification specifications, the HUB does not support WEP, TKIP, or TKIP-AES (WPA2 Mixed) security encryption in networks running in the 802.11n mode.
- By its nature, wireless LAN may experience radio interference depending on the environmental conditions (such as wireless router performance, distance, obstruction, interference with other wireless devices, etc.)
- WEP encryption does not work with WPS (PBC) / WPS (PIN).
- Connecting the HUB to an AP whose IP address is 10.0.0.x may not be successful.

Compatible products

Mobile	iOS	4.3 or above
	Android	2.3.3 (Gingerbread) or above

Some devices may not be compatible with the product.

Replacement covers are available from your dealer. If the fitted plug is not suitable for the power points in your house or the cable is not long enough to reach a power point, you should obtain a suitable safety approved extension lead or consult your dealer for assistance. However, if there is no alternative to cutting off the plug, remove the fuse and then safely dispose of the plug. Do not connect the plug to a mains socket as there is a risk of shock hazard from the bared flexible cord. Never attempt to insert bare wires directly into a mains socket. A plug and fuse must be used at all times.

IMPORTANT NOTICE

The wires in the mains lead are coloured in accordance with the following code:- BLUE = NEUTRAL BROWN = LIVE As these colours may not correspond to the coloured markings identifying the terminals in your plug, proceed as follows:- The wire coloured BLUE must be connected to the terminal marked with the letter N or coloured BLUE or BLACK. The wire coloured BROWN must be connected to the terminal marked with the letter L or coloured BROWN or RED.

**WARNING : DO NOT CONNECT EITHER WIRE TO THE EARTH TERMINAL WHICH IS MARKED WITH THE LETTER E OR BY THE EARTH SYMBOL , OR COLOURED GREEN OR GREEN AND YELLOW.**

Important Safety Instructions

Read these operating instructions carefully before using the unit. Follow all the safety instructions listed below. Keep these operating instructions handy for future reference.

- 1 Read these instructions.
- 2 Keep these instructions.
- 3 Heed all warnings.
- 4 Follow all instructions.
- 5 Do not use this apparatus near water.
- 6 Clean only with a dry cloth.
- 7 Do not block any ventilation openings. Install in accordance with the manufacturer's instructions.

Copyright

© 2014 Samsung Electronics Co.,Ltd. All rights reserved; No part or whole of this user's manual may be reproduced or copied without the prior written permission of Samsung Electronics Co.,Ltd.

Specifications

General	Weight	0.4 Kg (0.9 lbs)
	Dimensions	100 (W) x 106 (D) x 25 (H) mm (3.9 (W) x 4.1 (D) x 1 (H) inches)
	Operating Temperature Range	+41°F to +95°F (+5°C to +35°C)
	Operating Humidity Range	10 % to 75 %
Network	Ethernet	10/100BASE - TX Terminal
	Wireless LAN	Built-in
	Security	WEP (OPEN/SHARED) WPA-PSK (TKIP/AES) WPA2-PSK (TKIP/AES)
	WPS(PBC)	Supported

- Network speeds equal to or below 10Mbps are not supported.
- Design and specifications are subject to change without prior notice.
- For the power supply and power consumption, refer to the label attached to the product.
- Weight and dimensions are approximate.
- This User Manual is based on the product using the Android or iOS operating system.
- For further details on using the product, visit [www.samsung.com](http://www.samsung.com)

Contact Samsung World wide

- For information regarding Contact Samsung World wide, visit [www.samsung.com](http://www.samsung.com) and refer to the relevant information in the manual file. Go to: [www.samsung.com](http://www.samsung.com) → Support → Product name search → PDF download.

Open Source License Notice

- For further information on Open Sources used in this product, please visit the website: <http://opensource.samsung.com>