



Refrigerator user manual

English

imagine the possibilities

Thank you for purchasing this Samsung product.

SAMSUNG







Free Standing Appliance





safety information

SAFETY INFORMATION

- Before operating the appliance, please read this manual thoroughly and retain it at a safe place near the appliance for your future reference.
- Use this appliance only for its intended purpose as described in this instruction manual. This appliance is not intended for use by persons (including children) with reduced physical, sensory or mental capabilities, or lack of experience and knowledge, unless they have been given supervision or instruction concerning use of the appliance by a person responsible for their safety.
- Warnings and Important Safety Instructions in this manual do not cover all possible conditions and situations that may occur. It is your responsibility to use common sense, caution, and care when installing, maintaining, and operating your appliance.
- Because these following operating instructions cover various models, the characteristics of your refrigerator may differ slightly from those described in this manual and not all warning signs may be applicable. If you have any questions or concerns, contact your nearest service center or find help and information online at www.samsung.com.

Important safety symbols and precautions :

 WARNING	Hazards or unsafe practices that may result in severe personal injury or death.
 CAUTION	Hazards or unsafe practices that may result in minor personal injury or property damage.
	Do NOT attempt.
	Do NOT disassemble.
	Do NOT touch.
	Follow directions carefully.

	Unplug the power plug from the wall socket.
	Make sure the machine is grounded to prevent electric shock.
	Call the contact center for help.
	Note.

These warning signs are here to prevent injury to you and others. Please follow them carefully.

After reading this section, keep it in a safe place for future reference.

C E Notice

This product has been determined to be in compliance with the Low Voltage Directive (2006/95/EC), the Electromagnetic Compatibility Directive (2004/108/EC) and Energy efficiency Directive(96/57/EC) of the European Union.



SEVERE WARNING SIGNS FOR TRANSPORTATION AND SITE

- ★ • When transporting and installing the appliance, care should be taken to ensure that no parts of the refrigerating circuit are damaged.
- Refrigerant squirting out of the pipe could ignite or cause an eye injury. If a leak is detected, avoid any naked flames or potential sources of ignition and air the room in which the appliance is standing for several minutes.
- In order to avoid the creation of a flammable gas-air mixture if a leak in the refrigerating circuit occurs, the size of the room in which the appliance may be sited depends on the amount of refrigerant used.
- Never start up an appliance showing any signs of damage. If in doubt, consult your dealer. The room where the refrigerator will be sited must be 1m³ in size for every 8g of R600a refrigerant inside the appliance. The amount of refrigerant in your particular appliance is shown on the identification plate inside the appliance.



SEVERE WARNING SIGNS FOR INSTALLATION



- Do not install the refrigerator in a damp place or place where it may come in contact with water.
- Deteriorated insulation of electrical parts may cause an electric shock or fire.
- Do not place this refrigerator in direct sunlight or expose to the heat from stoves, room heaters or other appliance.
- Do not install this appliance in a humid, oily or dusty location, in a location exposed to direct sunlight and water (rain drops).
- Do not plug several appliances into the same multiple power board. The refrigerator should always be plugged into its own individual electrical which has a voltage rating that matched the rating plate.
- This provides the best performance and also prevents overloading house wiring circuits, which could cause a fire hazard from overheated wires.
- If the wall socket is loose, do not insert the power plug.
- There is a risk of electric shock of fire.
- Do not use a cord that shows cracks or abrasion damage along its length or at either end.
- Do not bend the power cord excessively or place heavy articles on it.
- Never unplug your refrigerator by pulling on the power cord. Always grip plug firmly and pull straight out from the outlet.
- Damage to the cord may cause short-circuit, fire and/or electric shock.
- Do not use aerosols near the refrigerator.
- Aerosols used near the refrigerator may cause an explosion or fire.



- This refrigerator must be properly installed and located in accordance with the manual before it is used.
- After unpacking, keep the packing materials out of reach of children.
- There is a risk of death from suffocation if children put them over their head.
- Connect the power plug in proper position with the cord hanging down.
- If you connect the power plug upside down, wire can get cut off and cause fire or electric shock.
- Make sure that the power plug is not squashed or damaged by the back of the refrigerator.

- When moving the refrigerator, be careful not to roll over or damage the power cord.
- This constitutes a fire hazard.
- The appliance must be positioned so that the plug is accessible after installation.



- The refrigerator must be grounded.
 - You must ground the refrigerator to prevent any power leakages or electric shocks caused by current leakage from the refrigerator.
- Never use gas pipes, telephone lines or other potential lightening rods as ground.
- Improper use of the ground plug can result in electric shock.



- If the power cord is damaged, have it replaced immediately by the manufacturer or its service agent.
- The fuse on the refrigerator must be changed by a qualified technician or service company.
- Failing to do so may result in electric shock or personal injury.



CAUTION SIGNS FOR INSTALLATION



- Allow sufficient space to install the refrigerator on the flat surface.
 - If your refrigerator is not level, the internal cooling system may not work correctly
- Keep ventilation opening in the appliance enclosure or mounting structure clear of obstruction.
- Allow the appliance to stand for 2 hours after installation.



SEVERE WARNING SIGNS FOR USING



- Do not insert the power plug with wet hands.
- Do not store articles on the top of the appliance.
- When you open or close the door, the articles may fall and cause personal injury and/or material damage.



SEVERE WARNING SIGNS FOR USING (CONT'D)



- Do not put items filled with water on the refrigerator.
- If spilled, there is a risk of fire or electric shock.
- Do not let children hang on the door.
- Failure to do so may cause serious personal injury.
- Do not leave the doors of the refrigerator open while the refrigerator is unattended and do not let children enter inside of the refrigerator.
- There is a risk of children entrapment and serious personal injury because of low temperature.
- Do not insert your hands into the bottom area under the appliance.
- Any sharp edges may cause personal injury.
- Do not let children step on drawer's cover.
- It may break and cause slip hazard.
- Do not overfill the refrigerator with food.
- When you open the door, an item may fall out and cause personal injury or material damage.
- Never put fingers or other objects into the dispenser hole.
- Failure to do so may cause personal injury or material damage.
- Do not store volatile or flammable substances such as benzene, thinner, alcohol, ether or LP gas in the refrigerator.
- The storage of any of such products may cause explosions.
- Do not store low temperature-sensitive pharmaceuticals products, scientific materials or other low temperature-sensitive products in the refrigerator.
- Products that require strict temperature controls must not be stored in the refrigerator.
- Do not place or use electrical appliance inside the refrigerator, unless they are of a type recommended by the manufacturer.
- Do not use a hair dryer to dry the inside of the refrigerator.
Do not place a lighted candle in the refrigerator for removing bad odors.
- This may result in electric shock or fire.
- Do not touch the inside walls of the freezer or products stored in the freezer with wet hands.
- This may cause frostbite.
- Do not use mechanical devices or any other means to accelerate the defrosting process, other than those recommended by the manufacturer.
- Do not damage the refrigerant circuit.

- Fill water tank, ice tray, water cubes only with potable water.



- This product is intended only for the storage of food in a domestic environment.
- Bottles should be stored tightly together so that they do not fall out.
- If a gas leak is detected, avoid any naked flames or potential sources of ignition and air the room in which the appliance is standing for several minutes.
- Use only the LED Lamps provided by manufacturer or service agents.
- Children should be supervised to ensure that they do not play with and/or climb into the appliance.



- Do not disassemble or repair the refrigerator by yourself.
- You run risk of causing a fire, malfunction and/or personal injury.
In case of malfunction, please contact your service agents.



- If you want to change the interior lamps of the refrigerator, please contact your service agents.



- If the appliance generates a strange noise, a burning or smell or smoke, unplug the power plug immediately and contact your nearest service center.
- Failing to do so may result in electric or fire hazards. Keep ventilation opening in the appliance enclosure or mounting structure clear of obstruction.
- If you experience difficulty when changing the light, contact service agents.
- If the products equipped with LED Lamp, do not disassemble Lamp Cover and LED Lamp by yourself.
- Please contact your service agents.
- If any dust or water is in refrigerator, pull out power plug and contact your Samsung Electronics service center.
- There is a risk of fire.



CAUTION SIGNS FOR USING



- If the refrigerator is disconnected from the power supply, you should wait for at least five minutes before plugging it back in.



- Unplug the power plug during a thunder/lightning storm.
- If you will be away for more than three weeks or the refrigerator will not be used for a long period of time, you must empty and clean the refrigerator out the power plug. Wipe excess and pull moisture from the inside and leave the doors open.
 - Otherwise, odor and mold may develop.
 - Deterioration in the insulation may cause fire.
- To get best performance of product,
 - Do not place foods too closely in front of the vents at the rear of the appliance as it can obstruct free air circulation in the refrigerator compartment.
 - Wrap the food up properly or place it in airtight containers before put it into the refrigerator.
- Do not re-freezer frozen foods that have thawed completely.
- Do not place carbonated or fizzy drinks in the freezer compartment. Do not put bottles or glasscontainers in the freezer.
 - When the contents freezer, the glass may break and cause personal injury and property damage.
- Do not change the functionality of or modify the refrigerator.
 - Changes or modifications may result in personal injury and/or property damage. Any changes or modifications performed by a 3rd party on this completed appliance is neither covered under Samsung warranty service, nor is Samsung responsible for safety issues and damages that result from 3rd party modifications.
- Do not block air holes.
 - If the air holes are blocked, especially with a plastic bag, the refrigerator can be over cold. If this cooling period lasts too long, the water filter may break and cause water leakage.
 - Do not put any newly introduced food for freezing near to already frozen food.
- Please observe maximum storage times and expiry dates of frozen goods.
- Fill water tank, ice tray, water cubes only with potable water.
- Do not place food inside the refrigerator in a haphazard way.
 - The food will not cool properly.
- Contains fluorinated greenhouse gases covered by the kyoto protocol.

- Hermetically sealed system.
- Do not vent gases into the atmosphere.
- Refrigerant type:R-134a Quantity: 0.18kg Global Warming Potential(GWP) = 1300



- If the appliance is flooded, cut the power immediately and contact your nearest service center.



CAUTION

CAUTION SIGNS FOR CLEANING AND MAINTENANCE



- Do not directly spray water inside or outside the refrigerator.
 - There is a risk of fire or electric shock.
- Do not spray inflammable gas near the refrigerator.
 - There is a risk of explosion or fire.
- Do not spray cleaning products directly on the display.
 - Printed letters on the display may come off.



- Remove any foreign matter or dust from the power plug pins.
But do not use a wet or damp cloth when cleaning the plug, remove any foreign material or dust from the power plug pins.
- Otherwise there is a risk of fire or electric shock.



- Unplug the refrigerator before cleaning and performing maintenance.



WARNING

SEVERE WARNING SIGNS FOR DISPOSAL



- Ensure that none of the pipes on the back of the appliance are damaged prior to disposal.
- R600a or R134a is used as a refrigerant. Check the compressor label on the rear of the appliance or the rating label inside the refrigerator to see which refrigerant is used for your refrigerator. When this product contains flammable gas (Refrigerant R600a), contact your local authority in regard to safe disposal of this product. Cyclopentane is used as an insulation blowing gas. The gases in insulation material require special disposal procedure. Please contact your local authorities in regard to the environmentally safe disposal of this product. Ensure that none of the pipes on the back of the appliances are damaged prior to disposal. The pipes shall be broke in the open space.

- ★ • If the appliance contains iso-butane refrigerant (R600a), a natural gas with high environmental compatibility that is, however, also combustible. When transporting and installing the appliance, care should be taken to ensure that no parts of the refrigerating circuit are damaged.
- When disposing of this product or other refrigerators, remove the door/door seals, door latch so that small children or animals cannot become trapped inside.
Leave the shelves in place so that children may not easily climb inside. Children should be supervised to ensure that they do not play with the old appliance.
- Please dispose of the packaging material for this product in an environmentally friendly manner.



ADDITIONAL TIPS FOR PROPER USAGE

- ★ • In the event of a power failure, call the local office of your Electricity Company and ask how long it is going to last.
- Most power failures that are corrected within an hour or two will not affect your refrigerator temperatures. However, you should minimize the number of door openings while the power is off.
- Should the power failure last more than 24 hours, remove all frozen foods.
- If keys are provided with the refrigerator, the keys should be kept out of the reach of children and not in vicinity of the appliance.

- The appliance might not operate consistently (possibility of temperature becoming too warm in refrigerator) when sited for an extended period of time below the cold end of the range temperature for which the refrigerating appliance is designed.
- Do not store food which spoils easily at low temperature, such as bananas, melons.
- Your appliance is frost free, which means there is no need to manually defrost your appliance, as this will be carried out automatically.
- Temperature rising during the defrost can comply with ISO requirement.
But if you want to prevent an undue rise in the temperature of the frozen food while defrosting the appliance, please wrap the frozen food in several layers of newspaper.
- Any increase in temperature of frozen food during defrosting can shorten its storage life.

Energy Saving Tips

- Install the appliance in a cool, dry room with adequate ventilation.
Ensure that it is not exposed to direct sunlight and never put it near a direct source of heat (radiator, for example).
- Never block any vents or grilles on the appliance.
- Allow warm food to cool down before placing it in the appliance.
- Put frozen food in the refrigerator to thaw.
Then you can use the low temperatures of the frozen products to cool food in the refrigerator.
- Do not keep the door of the appliance open for too long when putting food in or taking food out.
The shorter time for which the door is open, the less ice will form in the freezer.
- Allow clearance to the right, left, back and top when installing. This will help reduce power consumption and keep your energy bills lower.

contents

SETTING UP YOUR REFRIGERATOR	7
OPERATING YOUR REFRIGERATOR	8
APPENDIX	12

setting up your refrigerator

GETTING READY TO INSTALL THE REFRIGERATOR

Congratulations on your purchase of this Samsung Refrigerator.

We hope you enjoy state-of-the-art features and efficiencies that this new appliance offers.

- This refrigerator must be properly installed and located in accordance with the manual before it is used.
- Use this appliance only for its intended purpose as described in this instruction manual.
- We strongly recommend that any servicing be performed by a qualified individual.
- Please dispose of the packaging material for this product in an environmentally friendly manner.

Selecting the best location for the refrigerator

- A location without direct exposure to sunlight.
 - A location with flat floor surface.
 - A location with enough space for the refrigerator door to open easily.
 - Allow sufficient spec for air circulation for air circulation of the internal cooling system.
- If the refrigerator does not have enough space, the internal cooling system may not work properly.

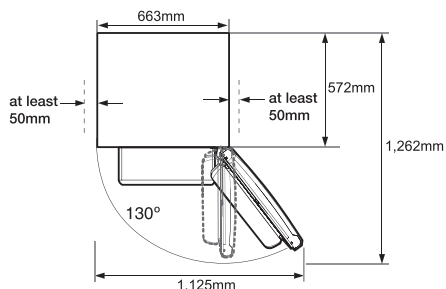
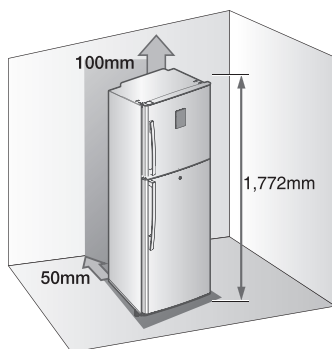

* The figure above shows a RT45GE.

Model	Width	Depth	Height
RT41G/H/J/K/L	670	698	1,687
RT41R	670	660	1,687
RT41TU	686	662	1,682
RT45G/H/J/K/L	670	698	1,772
RT45R	670	660	1,772
RT45TU	686	662	1,767



- Height of the product may be different depending on the models.
- Allow clearance to the right, left, back and top when installing.
This will help reduce power consumption and keep your energy bills lower.
- Do not install the refrigerator in a place with the temperature lower than 10°C.
- When you move the refrigerator, unplug and clearly arrange the power cord.
Also secure the glass shelf and the door with a tape.



CAUTION

Pull the unit straight out when installing, servicing or cleaning behind the refrigerator and push it straight back after work is complete.
Make sure your floor can support fully loaded refrigerator.

LEVELING THE REFRIGERATOR

If the front of the appliance is higher than the rear, the door can be opened and closed more easily. Turn the adjusting legs clockwise to raise and counter-clockwise to lower the height.



For safety operation and avoid the refrigerator fall over, do not remove the foot front from this appliance.

Case 1) The appliance tilts down to the left.

- Turn the left adjusting leg in the direction of the arrow until the appliance is level.

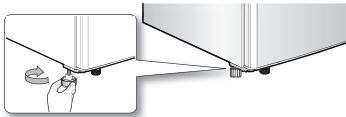

Case 2) The appliance tilts down to the right.

- Turn the right adjusting leg in the direction of the arrow until the appliance is level.

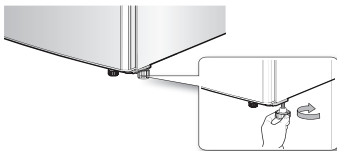

Standtable

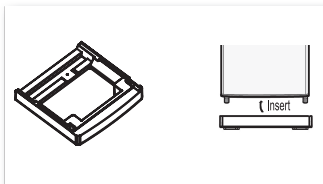

NOTE: Standtable is used as base of refrigerator and some country, when use standtable we can not turn the adjusting leg and there is not Foot Front in this model. (There is no Standtable according to the model).

operating your refrigerator

ADJUSTING THE TEMPERATURE CONTROL (TYPE A)

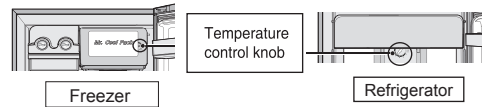

COLDEST

Turn the temperature control to **COLDER** if you want to store a lot of food in the refrigerator/freezer or make ice in the freezer or require fast freezing in the freezer.

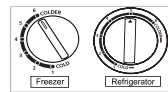

NORMAL

If you want to keep refrigerating or freezing to normal mode, turn the temperature control to the midway point between **COLDER** and **COLD**.

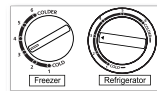

COLD

If you want to store only a small amount of food in the refrigerator or freezer, turn the temperature control to **COLD**.

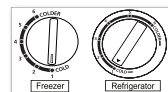

 • If the temperature where the refrigerator is placed is lower than 5 °C, set the temperature control to **COLD**. Because the temperature of the refrigerator is affected by the temperature around the refrigerator and it will be lower than the set value.

- Apart from knob settings mentioned above, if you desire to increase or reduce the cooling, turn the knob clockwise or anticlockwise to the degrees you want.
- If you need to freeze large amount of food stuff, set the temperature of freezer compartment to **COLDER** at least 24 hours before.

CHECKING THE CONTROL PANEL (TYPE B)

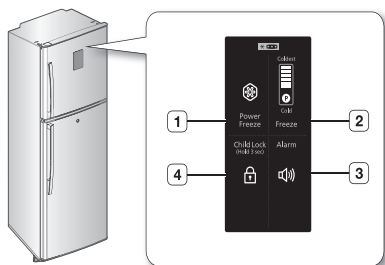

1 Power Freeze	Speeds up the time needed to freeze products in the freezer. This can be helpful if you need to quickly freeze items that spoil easily or if the temperature in the freezer has warmed dramatically (For example, if the door was left open, etc).
2 Freeze	You can set the desired temperature of the freezer. The freezer's temperature can be adjusted from the low cooling to high cooling.

3 Alarm	The alarm will alert you if the refrigerator door is kept open for longer than 2 minutes. To cancel the alarm, touch the Alarm button again.
4 Child Lock	You can activate or deactivate the Child Lock function by touching this button for 3 seconds.

USING THE CONTROL PANEL (TYPE B)

Power Freeze

Touch the **Power Freeze** button to activate the Power Freeze. Power Freeze indicator will light up and the refrigerator will speed up the time needed to freeze products in the freezer. Power Freeze will be activated for 72 hours.

The Power Freeze switches off automatically. When the Power Freeze process is completed, the Power Freeze indicator switches off and the freezer switches back to the previous temperature setting. When you use this mode, the energy consumption will increase. To deactivate the Power Freeze, touch the **Power Freeze** button again.



-  If you need to freeze large amount of food stuff, activate Power Freeze at least 24 hours before.

Freeze

Touch the **Freeze** button to set the freeze to desired temperature from the range between -15°C and -22°C.

Default set temperature is set on -20°C and each time you touch the **Freeze** button, temperature will change in following order and temperature indicator will display the desired temperature.



→ Cold (approximately -17°C) → Mid (approximately -19°C) → Coldest (approximately -23°C) ←

Adjusting the temperature control of the refrigerator

When you want to adjust the temperature of refrigerator, see page 8.



• If the temperature where the refrigerator is placed is lower than 5 °C, set the **Freeze** to **low point**. Because the temperature of the refrigerator is affected by the temperature around the refrigerator and it will be lower than the set value.

• If the refrigerator door is kept open for longer than 2 minutes, the refrigerator alarm will alert you with alarm sound.

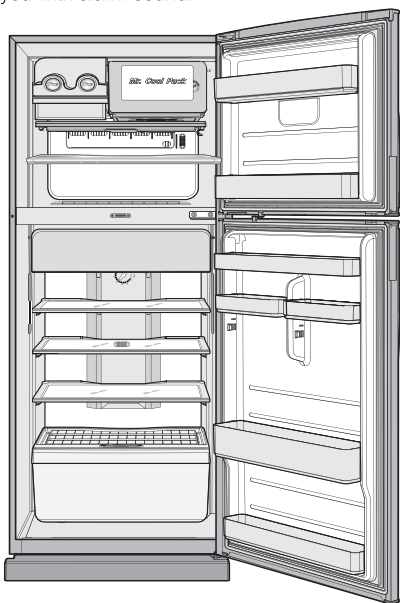

Some parts in the picture may differ from your refrigerator, depend on model and option.

- To get the best energy efficiency of this product, please leave all shelves, drawers and baskets on their original position like as above illustration.

MAKING ICE

Twist Type(select model)

1. Fill the ice cube tray with taking care not to overfill.



2. Slide the tray onto the cube shelf.

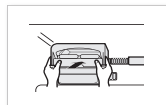

3. Remove the ice cubes from the ice cube tray by twisting the ice tray levers. Make sure the ice storage bin is beneath the ice cube tray (see diagram below)

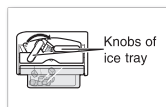

4. You can place on where you want by moving to the left or right. (select model)

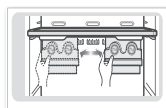

- Place the ice tray at the originally provided position by manufacturer in the order to achieve optimal ice-freezing.
- To get more space, you can remove the Ice tray and ice storage bin since it does not affect thermal and characteristics. A declared storage volume of frozen food storage compartment is calculated with these Ice tray and ice storage bin removed.



Freezing time

It is recommended that you wait about 1~2 hours after setting **Coldest of Freeze** on control panel or **COLDEST** of temperature control for the ice cubes to form.



Danger of explosion

- The coldest parts of the refrigerator is the rear panel. This is the best place to store delicate foodstuffs.
- Glass bottles containing liquids should never be stored in the freezer as the glass can shatter when the contents freeze.

REMOVING THE INTERIOR PARTS

Freezer Shelf

Pull the ice cube tray unit forward and of the freezer compartment. Lift the front of the freezer shelf upward to release the hooks and pull the shelf out of the freezer.



Refrigerator Shelves

Pull the shelves towards you until it meets the stopper. Tilt the front of the shelves up and continue pulling the shelves out.



Chiller Compartment

Pull the chiller compartment towards you until it meets the stopper. Tilt the front upward and continue pulling the compartment out.



Vegetable Bin and Cover

Pull the vegetable bin towards you and out of the refrigerator. Lift the cover up and pull it out of the refrigerator.



Bottle Bin and Guards

Lift straight upwards to release the tabs, then pull it out of the refrigerator. (This bottle storage guard is not adjustable; it fits in only one position.)

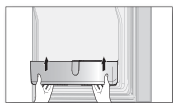

CLEANING THE REFRIGERATOR

Caring for your Samsung Refrigerator prolongs the life of the product and helps keep it from odor and germs.



CAUTION

Make sure to unplug the power cord before cleaning the refrigerator.

Cleaning the Interior

Clean the inside walls and interior parts with a mild detergent and then wipe it with dry soft cloth. You may remove the drawers and shelves for a more thorough cleaning. Make sure to dry them before putting them back into place.

Cleaning the Exterior

Wipe the control panel and display panel with a clean, soft cloth. Spray water onto the cleaning cloth instead of spraying directly on the surface of the refrigerator to ensure even distribution of moisture on the surface. Doors, handles and cabinet surfaces should be cleaned with a mild detergent and then wiped with a dry soft cloth. To keep your appliance looking its best, the exterior should be polished once or twice a year.



WARNING Do not use Benzene, Thinner or Clorox™ for cleaning.

They may damage the surface of the appliance and can create a risk of fire.

Cleaning the rubber door seals

If the rubber door seals are dirty, doors may not close properly and the refrigerator will not operate efficiently. Keep the door seals free of grit or grime by cleaning the doors with a mild detergent and damp cloth. Wipe dry with a clean, soft cloth.



CAUTION

- Do not spray the refrigerator with water while it is plugged in, as it may cause an electric shock. Do not clean the refrigerator with benzene, thinner or car detergent for risk of fire.
- You may remove the rubber door seal from the door to clean it. Make sure that you put the rubber door seal back correctly or the refrigerator will not operate efficiently.

REPLACING THE LED LAMP

When the interior or exterior LED lamp has gone out, please contact your service agents.

appendix

TROUBLESHOOTING

PROBLEM	SOLUTION
The appliance is not operating at all or the temperature is too high or low.	<p>Check the refrigerator for the following:</p> <ul style="list-style-type: none">• Check if the power plug is correctly connected.• Check if the power fuse is blown.• Is the temperature control or control panel correctly set?• Does sun shine on the appliance or are there any heat sources nearby?• Is the back of the appliance too close to the wall?• Do not store the hot food till it comes to room temperature.• Did you leave the refrigerator or freezer door open for a long time? <p>If a problem occurs, contact your service agents.</p>
The food in the refrigerator is frozen.	<ul style="list-style-type: none">• Is the temperature control or control panel set to the coldest temperature?• Is the surrounding temperature too low?
There are unusual noises.	<ul style="list-style-type: none">• Check if the appliance is installed on a stable and even floor.• Is the back of the appliance too close to the wall?• Have any foreign objects fallen behind or under the appliance?• Is the noise coming from the compressor in the appliance?• A ticking sound occurs when the various accessories contract or expand.
The front corners and sides of the appliance are warm and condensation starts to form.	<ul style="list-style-type: none">• Heat-proof pipes are installed in the front corners of the appliance to prevent condensation from forming. When the surrounding temperature rises, this may not always be effective. However, this is not abnormal.• In very humid weather, condensation may form on the outer surface of the appliance when the moisture in the air comes into contact with the cool surface of the appliance.
You can hear a liquid bubbling in the appliance.	<ul style="list-style-type: none">• This is the refrigerant, which cools the inside of the appliance.
There is a bad smell inside the appliance.	<ul style="list-style-type: none">• Is there any spoiled food inside of the refrigerator?• Make sure that strong smelling food (for example, fish) is wrapped so that it is airtight.• Clean out your refrigerator periodically and throw away any spoiled or suspect food.
There is a layer of frost on the appliances walls.	<ul style="list-style-type: none">• Are the air outlet vents blocked by food stored inside the refrigerator?• Space the food out as much as possible to improve ventilation.• Is the door fully closed?
Condensation forms on the inside wall of the appliance and around vegetables.	<ul style="list-style-type: none">• Food with a high water content is stored uncovered with a high humidity level or the door has been left open for a long time.• Store the food with a cover or in sealed containers.

memo

memo

memo

Ambient Room Temperature Limits

This refrigerator is designed to operate in ambient temperatures specified by its temperature class marked on the rating plate.

Class	Symbol	Ambient Temperature range (°C)
Extended Temperature	SN	+10 to +32
Temperate	N	+16 to +32
Subtropical	ST	+16 to +38
Tropical	T	+16 to +43



Internal temperatures may be affected by such factors as the location of the refrigerator, ambient temperature and the frequency with which you open the door. Adjust the temperature as required to compensate for these factors.



Correct Disposal of This Product (Waste Electrical & Electronic Equipment) (Applicable in the European Union and other European countries with separate collection systems)

This marking on the product, accessories or literature indicates that the product and its electronic accessories (e.g. charger, headset, USB cable) should not be disposed of with other household waste at the end of their working life. To prevent possible harm to the environment or human health from uncontrolled waste disposal, please separate these items from other types of waste and recycle them responsibly to promote the sustainable reuse of material resources.

Household users should contact either the retailer where they purchased this product, or their local government office, for details of where and how they can take these items for environmentally safe recycling.

Business users should contact their supplier and check the terms and conditions of the purchase contract. This product and its electronic accessories should not be mixed with other commercial wastes for disposal.

Contact SAMSUNG WORLD WIDE

If you have any questions or comments relating to Samsung products, please contact the SAMSUNG customer care center.

COUNTRY	CONTACT CENTER ☎	Web site
AUSTRIA	0810 - SAMSUNG (7267864, 1 € 0.07/min)	www.samsung.com
CZECH	800 - SAMSUNG (800-726786)	www.samsung.com
DENMARK	70 70 19 70	www.samsung.com
FINLAND	030 - 8227 515	www.samsung.com
FRANCE	01 48 63 00 00	www.samsung.com
GERMANY	01805 - SAMSUNG(726-7864 1 € 0,14/Min)	www.samsung.com
HONG KONG	(852) 3698-4698	www.samsung.com/hk www.samsung.com/hk_en/
HUNGARY	06-80-SAMSUNG(726-7864)	www.samsung.com
INDIA	3030 8282 1800 110011 1800 3000 8282 1800 266 8282	www.samsung.com
INDONESIA	0800-112-8888 021-5699-7777	www.samsung.com
ITALIA	800-SAMSUNG(726-7864)	www.samsung.com
MALAYSIA	1800-88-9999	www.samsung.com
NETHERLANDS	0900-SAMSUNG (0900-7267864) (1 € 0,10/Min)	www.samsung.com
NORWAY	815-56 480	www.samsung.com
PHILIPPINES	1-800-10-SAMSUNG(726-7864) 1-800-3-SAMSUNG(726-7864) 1-800-8-SAMSUNG(726-7864) 02-5805777	www.samsung.com
POLAND	0 801 1SAMSUNG(172678) 022-607-93-33	www.samsung.com
PORTUGAL	80820-SAMSUNG(726-7864)	www.samsung.com
RUSSIA	8-800-555-55-55	www.samsung.com
SINGAPORE	1800-SAMSUNG(726-7864)	www.samsung.com
SLOVAKIA	0800-SAMSUNG(726-7864)	www.samsung.com
SPAIN	902 - 1 - SAMSUNG (902 172 678)	www.samsung.com
SWEDEN	0771 726 7864 (SAMSUNG)	www.samsung.com
THAILAND	1800-29-3232 02-689-3232	www.samsung.com
Turkey	444 77 11	www.samsung.com
U.A.E	800-SAMSUNG (726-7864)	www.samsung.com
VIETNAM	1 800 588 889	www.samsung.com
GREECE	80111-SAMSUNG (80111 7267864) from land line, local charge/ 210 6897691 from mobile	www.samsung.com
Egypt	08000-726786	www.samsung.com
JORDAN	800-22273	www.samsung.com
Morocco	080 100 2255	www.samsung.com
Saudi Arabia	9200-21230	www.samsung.com
NIGERIA	0800 - SAMSUNG (726-7864)	www.samsung.com
SOUTH AFRICA	0860-SAMSUNG (726-7864)	www.samsung.com



In an effort to promote recycling this user manual is printed on recycled paper.