



OWNER'S MANUAL

REFRIGERATOR

Before operating the unit, please read this manual thoroughly,
and retain it for future reference.

- If you disconnect from the power supply, plug in again after five minutes.
- How to install and disassemble the door handle. (reference 15page)

FEATURES

Digital temperature control display (option)

- The display shows all functions of the appliance which can be easily controlled.

Vacation (option)

- Save on energy consumption by switching off the fridge and maintaining only the freezer.

SUPER fast freezing function (option)

- The Super Freeze function allows you to freeze food quickly. Ice can be produced faster.

Surround Cooling System

- Freshness depends on cooling speed. The surround cooling system blows cold air to every corner for even cooling.

Quick opening and closing system!

- Vegetables and fruits can be rapidly accessible to prevent loss of cold temp using a rail system design in high-humidity vegetable bin and special fresh bin which operates smoothly only by pulling and pushing the handle.

A slightly opened door is closed automatically.

- In case of a slight opening of the refrigerator door, it will close automatically by using an energy saving automatic closing function.

- Because this operating instruction book covers various models, the characteristics of your refrigerator may differ slightly from those described in this manual.



Warning

- The appliance is not intended for use by children without adult supervision.
- Children should be supervised to ensure that they do not interfere with the appliance.
- The appliance must be positioned so that the plug is accessible after installation.

CONTENTS

FEATURES.....	3
WARNINGS / SAFETY PRECAUTIONS	4
INSTALLING THE FRIDGE/FREEZER	6
USING THE CONTROL FEATURES (ELECTRONIC CONTROL TYPE).....	7
USING THE CONTROL FEATURES (DIAL CONTROL TYPE).....	8
MAKING ICE.....	9
FUNCTIONS OF WATER DISPENSER (OPTION)	10
HOW TO CLEAN	11
GENERAL CLEANING	12
HOW TO DISASSEMBLE THE ACCESSORIES	13
REPLACING THE INTERIOR LIGHT	14
HOW TO INSTALL AND DISASSEMBLE THE DOOR HANDLE	15
PROBLEMS AND SOLUTIONS	16
USAGE PRECAUTIONS.....	17
VIEW OF YOUR FRIDGE / FREEZER.....	18

WARNINGS / SAFETY PRECAUTIONS

To avoid any risk of personal injury, material damage or incorrect use of the appliance, be sure to observe the following safety precautions. (After reading these owner's instructions, please keep them in a safe place for reference). Remember to hand them over to any subsequent owner.



Warning

Indicates that a danger of death or serious injury exists.



Caution

Indicates that a risk of personal injury or material damage exists.



Warning

Do not plug several appliances into the same sockets.

- This could cause overheating and the risk of fire.

Keep the power plug away from the rear of the fridge/freezer.

- A damaged power plug may cause fire due to overheating.

Do not directly spray water inside or outside the fridge/freezer.

- There is a risk of fire or electric shock.

Do not spray inflammable gas near the fridge/freezer.

- There is a risk of explosion or fire.

Do not bend the power cord excessively or place heavy articles on it.

This constitutes a fire hazard. If the power cord is damaged, have it replaced immediately by the manufacturer, its service agent or a similarly qualified person.

Do not insert the power plug with wet hands.

- You may receive an electric shock.

Do not put a container filled with water on top of the appliance.

- If the water spills on to any electrical parts, it may lead to fire or electric shock.

Do not install the fridge/freezer in a damp place, where it could be splashed with water.

- Incorrect insulation of the electrical parts may cause an electric shock or fire.
- Do not place the equipment directly under the sunlight.

Do not store volatile and inflammable substances in the refrigerator.

- The storage of benzene, thinner, alcohol, ether, LP gas or other such substances may cause an explosion.

Do not disassemble, repair or alter the appliance.

- It may cause fire or abnormal operations, which may lead to injury.

Pull the power plug out of the socket before replacing the interior light in the refrigerator.

- Otherwise, there is a risk of electric shock.

Make sure that appliance is correctly earthed.

- Otherwise, it may cause material damage and electric shock.

If you wish to dispose of the fridge/freezer, throw it away after removing the door or its seals.

- In this way, it is not possible for a child to remain trapped inside it.
- The gases in the insulation material required special disposal procedure.



Warning

- Keep ventilation openings in the appliance enclosure or mounting structure clear of obstruction.
- Do not use mechanical devices or any other means to accelerate the defrosting process, other than those recommended by the manufacturer.
- Do not damage the refrigerant circuit.
- Do not use electrical appliances inside the fridge/freezer, unless they are a type recommended by the manufacturer.



Caution

Do not store too much food in the appliance.

- When you open the door, an item may fall out and cause personal injury or material damage.

Do not put bottles or any kinds of glass in the freezer.

- The container may break and cause personal injury.

If the wall socket is loose, do not insert the power plug.

- It May cause electric shock or fire.

Do not disconnect the power cord by pulling on it.

- You may disconnect a wire and cause a short circuit.

Do not store articles on top of the appliance.

- When you open or close the door, the articles may fall and cause personal injury or material damage.

Do not store pharmaceutical products, scientific materials or other temperature-sensitive products in the refrigerator.

- Products that require strict temperature controls must not be stored in the refrigerator.

Do not let a child hang from the door.

Do not touch any containers and food in the freezer with wet hands.

- It may cause frostbite.

Remove any foreign matter from the power plug pins.

- Otherwise, there is a risk of fire.

Do not insert your hand into the bottom area of the appliance.

- Any sharp edges may cause personal injury.

After unplugging the appliance, wait for at least five minutes before plugging it in again to the wall socket.

- Abnormal operation of the freezer may cause material damage.

If the appliance is not to be used for a long period of time, pull out the power plug.

- Any deterioration in the wire insulation may cause fire.

Do not let children touch or play with the controller of the appliance.

- Do not allow children to interfere with the appliance.
- Repairs and maintenance of the appliance should only be performed by a qualified technician. Incorrect repairs by an unqualified person are a potential source of danger that may have critical consequences for the user of the appliance.
- Never put ice cubes or ice lollies straight from the freezer into your mouth. (The low temperature may cause "freezer burns".)

INSTALLING THE FRIDGE/FREEZER

1 Allow an adequate space and install the fridge/freezer on a firm, level floor.

- If the appliance is not level, there may be unusual noises and poor cooling.
- Wait for at least five minutes before plugging the appliance in.

2 Clean the fridge/freezer.

- Wipe and clean the appliance inside and outside with a damp cloth.

3 Plug the fridge/freezer into a wall socket used exclusively by this appliance.

- This appliance must be properly earthed.

4 Place the food in the fridge/freezer.

- Set the temperature control to the colder temperature and let the refrigerator operate for one hour. The freezer should get slightly chilled and the motor should run smoothly with a soft hum and no noise. Your fridge/freezer is operated by a compressor which switches "on and off" to maintain the internal temperature. When the compressor is new, it requires running in for a period of up to five months. During this period, it may be slightly noisy. This is quite normal and does not represent a fault.



Warning

Use of an grounded socket exclusively for the appliance:

- If you are using a socket with an earthing terminal, you do not require a separate earthing connection.

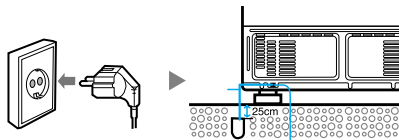

Use of a no grounded wire socket:

- Connect the "grounding wire" to the copper plate and bury it at a depth of at least 25 cm² in the ground.

LEVELLING

If the front of the appliance is slightly higher than the rear, the door can be opened and closed more easily.

1 The appliance tilts down to the left.

Turn the left adjusting leg in the direction of the arrow until the appliance is level.

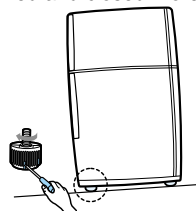

2 The appliance tilts down to the right.

Turn the right adjusting leg in the direction of the arrow until the appliance is level.

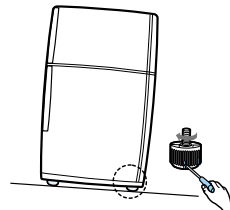

Caution

- When the level adjustment legs are not fixed on the floor, the refrigerator could move.
- Please tie up the extra length of the power cord at the back of the refrigerator so as not to be touched on the floor preventing the power cord from being crushed by the rollers upon relocation.

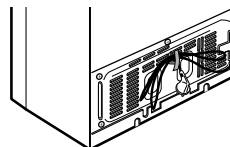

* What if they do not make the ground circuit correctly.
They acted on samsung advice.

USING THE CONTROL FEATURES (ELECTRONIC CONTROL TYPE)

Super Freeze

- You can push this button, when you want to make ice or cool food quickly.
- If you push Super Freeze button the indicator will work for 2.5hrs nonstop.
- To stop Super Freeze, simply press the Super Freeze button once more.

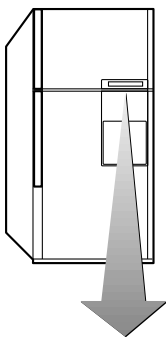

Vacation

- If you are going on a long vacation or business trip or you do not need to use the refrigerator, press the vacation button.
- The refrigerator is switched off but the freezer remains on.
- The vacation indicator remains on while in vacation mode.



Caution

- You must empty the refrigerator before pressing the vacation button.



1. Freezer Temp Setting

- 1) With the initial power is on, Freezer will be set at -19°C and Fridge will be set at 3°C automatically. At this time, the temp on the display panel means the temp in the fridge/freezer and as the temp decreases the displayed temp also decreases down to the set temp. Afterward, the displayed temp is the set temp.
- 2) Freezer Temp can be set from -14°C to -25°C with Freezer temp setting button.

2. Fridge Temp Setting

- 1) Fridge Temp can be set from 7°C to 1°C with Fridge temp setting button.
- 2) Fridge set temp varies slightly from actual temperature according to the user's way of storing food and Ambient temp.

3. Door Alarm

- 1) you can check the airtight of door with the alarm.
- 2) If the door of refrigerator is left opened over the angle 5°, the alarm will operate for 10 second every 2 minute repeatedly.
As soon as you plug in a refrigerator, this function will operate. If you don't want to use this function, push this button and then you will see the lamp off.

4. TriCool Zone Temp Setting(Optional)

Specially designed bin with temperature control function for customized life styles.

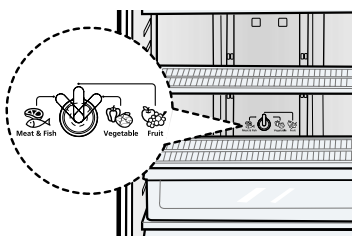

Meat & Fish

Chilled room : To store dairy products or thawed-out meat /fish before cooking.



Caution

Do not adjust this position when storing fruits or vegetables.



Fruit

Fridge Drawer : When there is a large quantity of food products to store, it can be used as the same as the fridge compartment.



Vegetable

Crisper Drawer : When additional room for fruits or vegetables is needed, it can be used to store a large quantity of them in fresh conditions.

USING THE CONTROL FEATURES (DIAL CONTROL TYPE)

- Freezer -

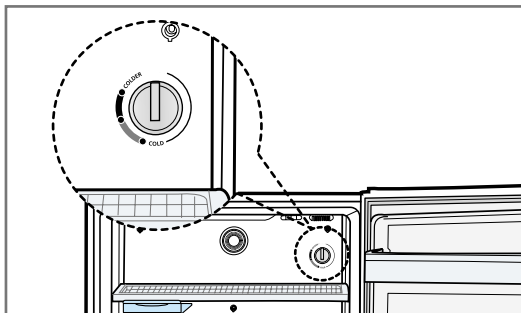

COLDER:

When storing large quantities of foods to be frozen, or to produce ice quickly.

- Adjust the temperature control to the "COLDER" position.

COLDER to COLD:

When using MID range.

- Adjust the temperature control to the halfway position between COLDER and COLD.

COLD:

When storing a small quantity of food to be frozen.

- Adjust the temperature control to the COLD position.

- Fridge -



Caution

- You must empty the refrigerator before adjusting the vacation position.

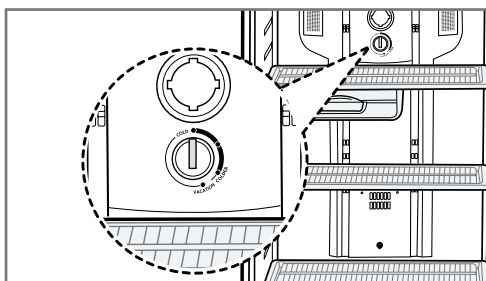

Vacation

- If you are going on a long vacation or business trip or you do not need to use the refrigerator, adjust the temperature control to the "VACATION" position.
- The refrigerator is switched off but the freezer remains on.

COLDER:

When storing large quantities of food to be refrigerated or temperature is not cold enough.

- Adjust the temperature control to the "COLDER" position.

COLDER to COLD:

When using MID range.

- Adjust the temperature control to the halfway position between COLDER and COLD.

COLD:

When the food refrigerated is frozen, or there is a small quantity of food.

- Adjust the temperature control to the COLD position.

MAKING ICE

- TWIST ICE MAKER

Making Ice Cubes

- 1 Remove the ice cube tray by pulling it towards you.
- 2 Fill the tray with water up to the maximum water level marked on the rear of the tray.
- 3 Slide the tray back into the holder, taking care not to spill the water.
- 4 Wait until the ice cubes are formed.
Freezing time :
It is recommended that you wait for about one hour with the temperature set to Super Freeze for the ice cubes to form.

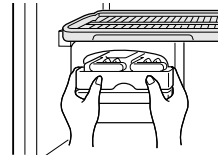
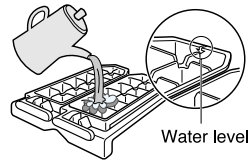

Removing the Ice Cubes

- 1 Make sure that the ice cube storage bin is in place under the ice cube tray. If not, slide it into place.
- 2 Twist one of the levers firmly in the clockwise direction until the tray twists slightly.
Result : The ice cubes fall into the storage bin.
- 3 Repeat Step 2 for the other half of the tray, if necessary.
- 4 Remove the storage bin by:
 - Lifting it slightly
 - Pulling it towards you

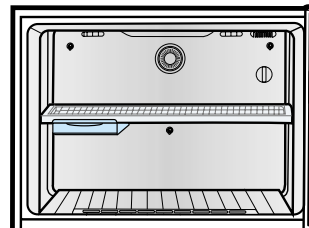

- REMOVABLE ICE TRAY

Making ice cubes

- 1 Remove the ice cube tray by pulling it towards you.
- 2 Fill the tray with water up to the maximum water level marked on the rear of the tray.
- 3 Place it under the freezer shelf or on the freezer shelf .

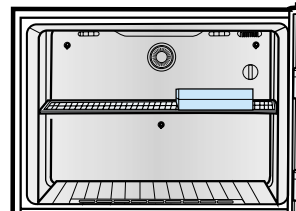

Removing the ice cubes

To remove ice cubes, hold the tray at its ends and twist gently.



Danger of explosion

- Glass bottles containing liquids that can freeze should never be stored in the freezer as the glass will explode when the contents freeze.

FUNCTIONS OF WATER DISPENSER(OPTION)

With the water dispenser, you can obtain chilled water easily without opening the refrigerator door.

HOW TO USE WATER DISPENSER

1

Lift up and pull out the water tank.

- Hold the handgrips on both sides to lift out the water tank.
- Clean the inside of water tank when using it for the first time.

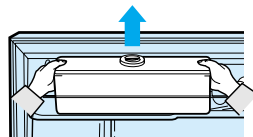

2

Fill the water tank with water, ensuring that it is in a stable position, allowing for the extended water supply outlet.

- Fill with water up to 2.5 l. If it is filled higher than this, it may overflow when the lid is closed.
- It is impossible to fill the tank with water while it is positioned in the refrigerator.

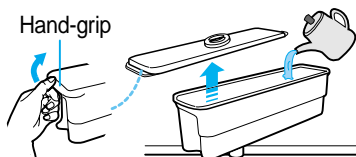
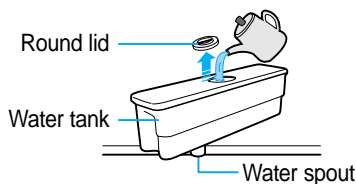

Method 1.

Fill the water lifting the round lid in the arrow direction to open.

Method 2.

Please fill the water after holding and lifting the large lid to open it.

3

Close the refrigerator door after fitting the water tank.

- Confirm that the water spout is outside after closing the door.

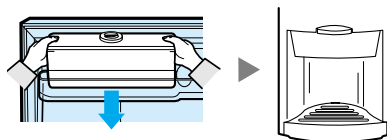

4

Press down the water supply lever after placing a cup on platform.

- Place the cup deep inside to touch the back wall.
- Check that the locking device is set to "open". Water can only be dispensed on this setting.
- Throw away 2~3 cups of water when using the water dispenser for the first time after installation.
- Approximately 1 0~1 5 cups of water are available.

Water supply lever

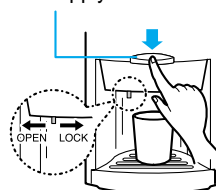

When the water dispenser is not in use.

After removing water tank, tightly insert the cap for sealing in place of water spout, so that cool air escapes.

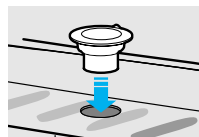

HOW TO CLEAN

HOW TO CLEAN WATER DISPENSER (OPTION)

- 1** **Separate the large lid from water tank after pulling it out.**
- It can be separated from water tank by pulling up the hand-grip.

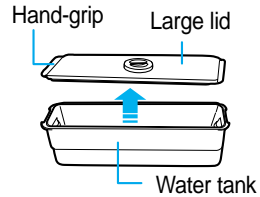

- 2** **Separate the water tank from water spout.**
- Hold the upper part of water spout and unscrew it in arrow direction.

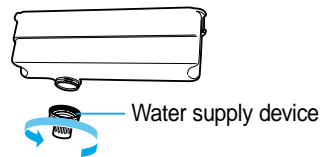

- 3** **After washing water tank and lid with dishwashing detergent, rinse them with water.**

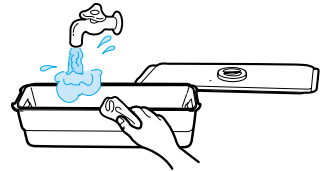

- 4** **Clean the water spout with a soft brush.**
- Disassemble and clean occasionally.

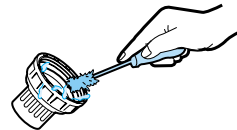

- 5** **How to use the water tray**
- Frequently empty water collected in the water-tray and wipe it out with dry clothe after separating it from cup platform by slightly pressing "PUSH".

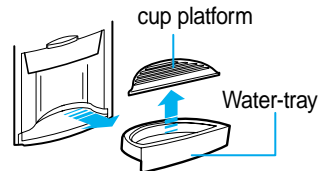

- Do not store hot water in the water tank.
- Be careful not to damage or lose the water spout.
- Do not let children mishandle the water spout. It may cause water overflow.

GENERAL CLEANING

1 Storage bin

- Wipe and clean the high humidity special fresh bin with water and dishwashing detergent after pulling it out.



2 Freezer / Fridge Shelf

- In case of foods spillages, pull out the freezer/refrigerator self and wipe it with clean cloth.



3 Door Gasket

- Clean the door gasket with dishwashing detergent the door can not easily close if it is dirty.
- Wipe the gaps along the grooves with cloth.
- Care should be taken not to damage the door gasket while cleaning.
- If gasket is damaged during cleaning, it may not be durable enough.

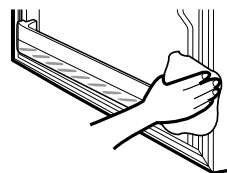

4 Low temperature catalysing deodorizer (option)

- In case of food smells in the fridge, Clean the low temperature catalyzing deodorizer.
- After disassembling, dip into clean water and leave to dry completely in sunlight before reinserting.

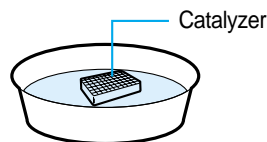

Note

- This refrigerator has wheels as its rear and front so that it can easily move forward and back whenever necessary and it is convenient for adjusting its position as well as for cleaning front leveling.

HOW TO DISASSEMBLE THE ACCESSORIES

Freezer shelf

- Pull out the ice tray first and then lift up the front part of freezer shelf and pull it out forward.

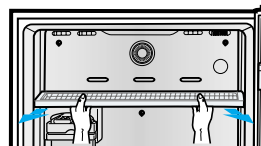

Freezer shelf

Fridge shelf

- Lift up the fridge shelf and pull it forward.

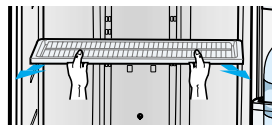

Fridge shelf

High humidity vegetable bin and Tray Chilled (option)

- Lift up the vegetable bin lid and pull it forward.
- Pull out vegetable box and high humidity special fresh bin while lifting it up pulling forward after it has reached the middle of the slide.

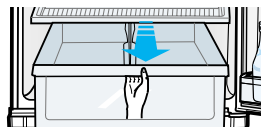

Vegetable bin



Tray Chilled

Water tank (option)

- Lift up and pull out the water tank as shown in the diagram.

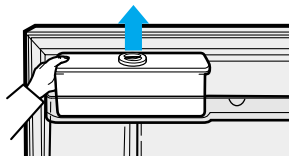

Low temperature catalyzing deodorizer

- Pull it out while pressing the end of the sill on the low temperature catalyzing deodorizer.

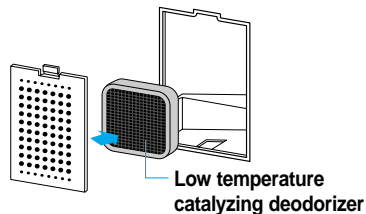

Low temperature catalyzing deodorizer

Door guards

- Lift up and pull out the door guards.

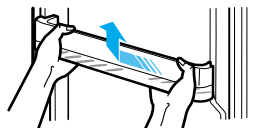

Note

- It is possible, if you need more space to store vegetable and fruits, to remove the drawers and ice tray.
- Do not store fruits or vegetables in the fresh control compartment. The fruits or the vegetables could get frozen.

REPLACING THE INTERIOR LIGHT



Warning

Always unplug the appliance when replacing the refrigerator light. This eliminates the danger of electric shock.

Freezer lamp

1. Remove the indoor lamp cover by using a \oplus driver, fit the front part of indoor lamp cover into the groove and then fit the rear part.
2. Turn(ccw) the indoor lamp to remove and replace it with a new one.
3. After fitting the front part of the indoor lamp cover, fit the rear sill area and then re-fit the screw.

Front

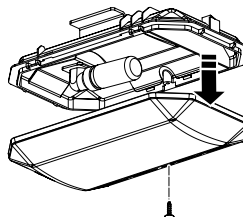

Fridge lamp

1. Remove the screws.
Unlock the sills and pull the Lamp cover down to remove it.
 2. Turn(ccw) the indoor lamp, remove it and replace it with a new one.
- ※ If you have difficulties in replacing and purchasing parts, contact the nearest Samsung Electronics Service Center.

Front

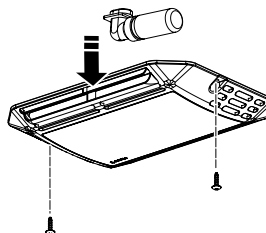

HOW TO INSTALL AND DISASSEMBLE THE DOOR HANDLE

- When assembling the handle...

1

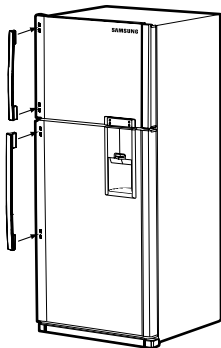

- Match the Handle Locking Tabs installed on the left hand side of the door and the handle inserts.

2

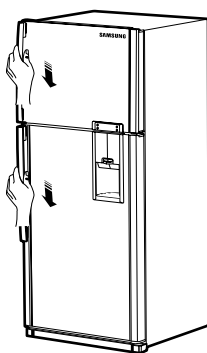

- Fix the handle by pulling it down or tapping it lightly with a tool like a rubber hammer.

3

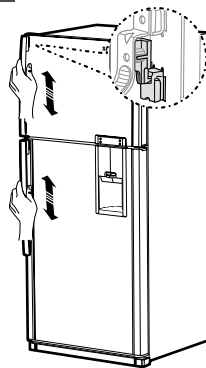

- Check whether the locking tabs inside the handle are assembled by pulling it up and down.

- When disassembling the handle...

1

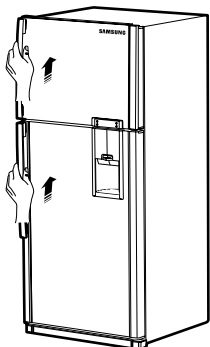

- Separate the locking tabs by tapping the lower part of the handle with a tool like a rubber hammer.

2

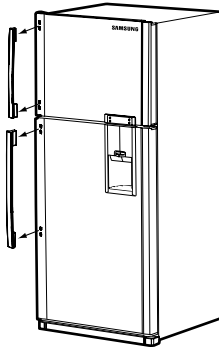

- Pull the handle up to detach the locking tabs from the handle inserts and separate each other.



Caution

- There is a possibility of the handle detachment when excessive force is applied to the handle during relocation of the refrigerator, so do not grab the handle.

PROBLEMS AND SOLUTIONS

The appliance is not operating at all or the temperature is too high

- Check that the power plug is correctly connected.
- Is the temperature controller in the fridge/freezer correctly set?
- Is there direct sunlight on the appliance or are there heat sources nearby?
- Is the back of the appliance too near to the wall?

The food in the refrigerator is frozen

- Is the temperature controller in the fridge set to the colder temperature?
- Is the ambient temperature too low?
- Did you put food with a high water content in the refrigerator?

There are unusual noises

- Check that the appliance is installed on a stable, level floor.
- Is the back of the appliance too near to the wall?
- Have any foreign objects fallen behind or under the appliance?
- Is the noise coming from the compressor in the appliance?
- A ticking sound may be heard inside the appliance; this is normal. This sound occurs when the various accessories contract or expand.

The front corners and sides of the appliance are warm and condensation starts to form

- Heat-proof pipes are installed in the front corners of the appliance to prevent condensation from forming. When the surrounding temperature rises, this may not always be effective. However, this is not abnormal.
- In very humid weather, condensation may form on the outer surface of the appliance when the moisture in the air comes into contact with the cool surface of the appliance.

You can hear a liquid gurgling in the appliance.

- This is the refrigerant, which cools the inside of the appliance.

There is a smell inside the appliance

- Food may not be sealed correctly in a container.
- If there is a smell, the low temperature catalysing deodorizer may require cleaning.

There is a layer of frost on the appliance's walls

- Is the air outlet on the appliance blocked?
- Space the food out as much as possible to improve ventilation.
- Is the door fully closed?

Condensation forms on the inside wall of the appliance and around vegetables

- Food with a high water content is stored uncovered with a high humidity level or the door has been left open for a long time.
- Store the food with a cover or in sealed containers.

USAGE PRECAUTIONS

Store food with a high water content at the front of a refrigerator shelf.

Store hot food in the appliance after it has cooled.

- If you store cold food, you save on electricity and improve refrigeration.



Power Saving Tips

- Install the appliance in a cool, dry place with adequate ventilation. Ensure that it is not exposed to direct sunlight and never put it near a direct source of heat (radiator, for example).
- Never block any vents or grilles on the appliance.
- Allow warm food to cool down before placing it in the appliance.
- Put frozen food in the refrigerator to thaw. You can then use the low temperatures of the frozen products to cool food in the refrigerator.
- Do not keep the door of the appliance open for too long when putting food in or taking food out. The shorter the time for which the door is opened, the less ice will form in the freezer.
- When freezing food or storing it in the freezer, place the food in freezer compartment in sealed containers.

VIEW OF YOUR FRIDGE / FREEZER

ELECTRONIC CONTROL

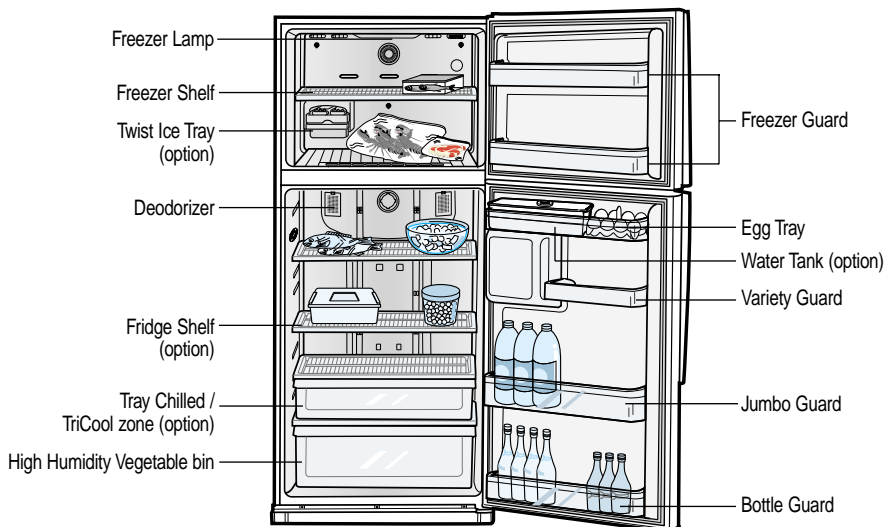

MECHANICAL CONTROL

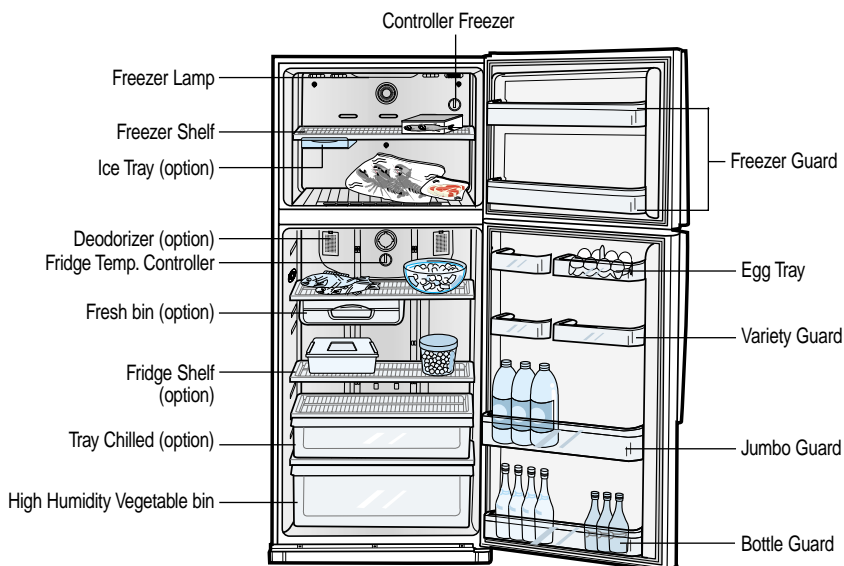

MEMO



