

quick start guide

English



RH56J69*

1. Safety Information









Safety information

- Before operating the appliance, please read this manual thoroughly and retain it at a safe place near the appliance for your future reference.
- Use this appliance only for its intended purpose as described in this instruction manual. This appliance is not intended for use by persons (including children) with reduced physical, sensory or mental capabilities, or lack of experience and knowledge, unless they have been given supervision or instruction concerning use of the appliance by a person responsible for their safety.
- This appliance can be used by children aged from 8 years and above and persons with reduced physical, sensory or mental capabilities or lack of experience and knowledge if they have been given supervision or instruction concerning use of the appliance in a safe way and understand the hazards involved.
Children shall not play with the appliance. Cleaning and user maintenance shall not be made by children without supervision.
- Warnings and Important Safety Instructions in this manual do not cover all possible conditions and situations that may occur. It is your responsibility to use common sense, caution, and care when installing, maintaining, and operating your appliance.
- Because these following operating instructions cover various models, the characteristics of your refrigerator may differ slightly from those described in this manual and not all warning signs may be applicable. If you have any questions or concerns, contact your nearest service center or find help and information online at www.samsung.com.

Important safety symbols and precautions:

	Hazards or unsafe practices that may result in severe personal injury or death.
	Hazards or unsafe practices that may result in minor personal injury or property damage.

OTHER SYMBOLS USED

	Do NOT attempt.
	Do NOT disassemble.
	Do NOT touch.
	Follow directions carefully.
	Unplug the power plug from the wall socket.
	Make sure the machine is grounded to prevent electric shock.
	Call the contact center for help.
	Note.

These warning symbols are here to prevent injury to you and others.

Please follow them carefully.

After reading this section, keep it in a safe place for future reference.

SEVERE WARNING SIGNS FOR TRANSPORTATION AND SITE



- When transporting and installing the appliance, care should be taken to ensure that no parts of the refrigerating circuit are damaged.
 - Refrigerant leaking from the pipe work could ignite or cause an eye injury.
If a leak is detected, avoid any naked flames or potential sources of ignition and air the room in which the appliance is standing for several minutes.
 - In order to avoid the creation of a flammable gas-air mixture if a leak in the refrigerating circuit occurs, the size of the room in which the appliance may be sited depends on the amount of refrigerant used.
 - Never start up an appliance showing any signs of damage.
If in doubt, consult your dealer. The room where the refrigerator will be sited must be 1 m³ in size for every 8 g of R-600a refrigerant inside the appliance.
The amount of refrigerant in your particular appliance is shown on the identification plate inside the appliance.
-

SEVERE WARNING SIGNS FOR INSTALLATION



- Do not install the refrigerator in a damp place or place where it may come in contact with water.
 - Deteriorated insulation of electrical parts may cause an electric shock or fire.
 - Do not place this refrigerator in direct sunlight or expose to the heat from stoves, room heaters or other appliance.
 - Do not plug several appliances into the same multiple power board.
The refrigerator should always be plugged into its own individual electrical which has a voltage rating that matched the rating plate.
 - This provides the best performance and also prevents overloading house wiring circuits, which could cause a fire hazard from overheated wires.
 - If the wall socket is loose, do not insert the power plug.
 - There is a risk of electric shock or fire.
 - Do not use a cord that shows cracks or abrasion damage along its length or at either end.
 - Do not bend the power cord excessively or place heavy articles on it.
 - Do not use aerosols near the refrigerator.
 - Aerosols used near the refrigerator may cause an explosion or fire.
-



- This refrigerator must be properly installed and located in accordance with the manual before it is used.
 - Connect the power plug in proper position with the cord hanging down.
 - If you connect the power plug upside down, wire can get cut off and cause fire or electric shock.
 - Make sure that the power plug is not squashed or damaged by the back of the refrigerator.
 - When moving the refrigerator, be careful not to roll over or damage the power cord.
 - This constitutes a fire hazard.
 - The appliance must be positioned so that the plug is accessible after installation.
-



- The refrigerator must be grounded.
 - You must ground the refrigerator to prevent any power leakages or electric shocks caused by current leakage from the refrigerator.
 - Never use gas pipes, telephone lines or other potential lightening rods as ground.
 - Improper use of the ground plug can result in electric shock.
-



- If the power cord is damaged, have it replaced immediately by the manufacturer or its service agent.
- The fuse on the refrigerator must be changed by a qualified technician or service company.
 - Failing to do so may result in electric shock or personal injury.

CAUTION SIGNS FOR INSTALLATION



- Keep ventilation opening in the appliance enclosure or mounting structure clear of obstruction.
 - Allow the appliance to stand for 2 hours after installation.
 - When installing the refrigerator, make sure both legs contact the floor for secure installation.
Legs are located at the bottom back of each door.
Insert a flathead screwdriver and turn it in the direction of the arrow until it is level.
 - Always balance the load on each door.
 - Overload on any one door may fell the refrigerator, causing physical injury.
-

SEVERE WARNING SIGNS FOR USING



- Do not insert the power plug with wet hands.
 - Do not store articles on the top of the appliance.
 - When you open or close the door, the articles may fall and cause personal injury and/or material damage.
 - Do not put items filled with water on the refrigerator.
 - If spilled, there is a risk of fire or electric shock.
 - Do not let children hang on the door.
 - Failure to do so may cause serious personal injury.
 - Do not leave the doors of the refrigerator open while the refrigerator is unattended and do not let children enter inside of the refrigerator.
 - There is a risk of children entrapment and serious personal injury because of low temperature.
 - Never put fingers or other objects into the dispenser hole.
 - Failure to do so may cause personal injury or material damage.
 - Do not store volatile or flammable substances such as benzene, thinner, alcohol, ether or LP gas in the refrigerator.
 - The storage of any of such products may cause explosions.
-



- Do not store low temperature-sensitive pharmaceuticals products, scientific materials or other low temperature-sensitive products in the refrigerator.
 - Products that require strict temperature controls must not be stored in the refrigerator.
 - Do not place or use electrical appliance inside the refrigerator, unless they are of a type recommended by the manufacturer.
 - Do not use a hair dryer to dry the inside of the refrigerator. Do not place a lighted candle in the refrigerator for removing bad odors.
 - This may result in electric shock or fire.
 - Do not touch the inside walls of the freezer or products stored in the freezer with wet hands.
 - This may cause frostbite.
 - Do not use mechanical devices or any other means to accelerate the defrosting process, other than those recommended by the manufacturer.
 - Do not damage the refrigerant circuit.
-



- This product is intended only for the storage of food in a domestic environment.
 - Bottles should be stored tightly together so that they do not fall out.
 - If a gas leak is detected, avoid any naked flames or potential sources of ignition and air the room in which the appliance is standing for several minutes.
 - Use only the LED Lamps provided by manufacturer or service agents.
 - Children should be supervised to ensure that they do not play with and/or climb into the appliance.
-



- Do not disassemble or repair the refrigerator by yourself.
 - You run risk of causing a fire, malfunction and/or personal injury.
In case of malfunction, please contact your service agents.
-



- If the appliance generates a strange noise, a burning or smell or smoke, unplug the power plug immediately and contact your nearest service center.
 - Failing to do so may result in electric or fire hazards. Keep ventilation opening in the appliance enclosure or mounting structure clear of obstruction.
 - If you experience difficulty when changing the light, contact service agents.
 - If the products equipped with LED Lamp, do not disassemble Lamp Cover and LED Lamp by yourself.
 - Please contact your service agents.
 - If any dust or water is in refrigerator, pull out power plug and contact your Samsung Electronics service center.
 - There is a risk of fire.
-

CAUTION SIGNS FOR USING



- To get best performance of product,
 - Do not place foods too closely in front of the vents at the rear of the appliance as it can obstruct free air circulation in the refrigerator compartment.
 - Wrap the food up properly or place it in airtight containers before put it into the refrigerator.
 - Do not place carbonated or fizzy drinks in the freezer compartment.
Do not put bottles or glass containers in the freezer.
 - When the contents freeze, the glass may break and cause personal injury and property damage.
 - Do not change the functionality of or modify the refrigerator.
 - Changes or modifications may result in personal injury and/or property damage.
Any changes or modifications performed by a 3rd party on this completed appliance is neither covered under Samsung warranty service, nor is Samsung responsible for safety issues and damages that result from 3rd party modifications.
 - Do not block air holes.
 - If the air holes are blocked, especially with a plastic bag, the refrigerator can be over cooled. If this cooling period lasts too long, the water filter may break and cause water leakage.
 - Do not put any newly introduced food for freezing near to already food.
 - Please observe maximum storage times and expiry dates of frozen goods.
 - Fill water tank, ice tray, water cubes only with potable water.
 - Use only the ice maker provided with the refrigerator.
 - The water supply to this refrigerator must only be installed/connected by a suitably qualified person and connect to a potable water supply only.
 - In order to operate the ice maker properly, water pressure of 138 ~ 862 kPa (19.9 ~ 125.1 psi) is required.
-

CAUTION SIGNS FOR CLEANING AND MAINTENANCE



- Do not directly spray water inside or outside the refrigerator.
 - There is a risk of fire or electric shock.
 - Do not spray inflammable gas near the refrigerator.
 - There is a risk of explosion or fire.
 - Do not spray cleaning products directly on the display.
 - Printed letters on the display may come off.
 - Remove any foreign matter or dust from the power plug pins.
But do not use a wet or damp cloth when cleaning the plug, remove any foreign material or dust from the power plug pins.
 - Otherwise there is a risk of fire or electric shock.
 - Never put fingers or other objects into the dispenser hole and ice chute.
 - It may cause personal injury or material damage.
-



- Unplug the refrigerator before cleaning and performing maintenance.
-

SEVERE WARNING SIGNS FOR DISPOSAL



- Ensure that none of the pipes on the back of the appliance are damaged prior to disposal.
- R-600a or R-134a is used as a refrigerant.
Check the compressor label on the rear of the appliance or the rating label inside the refrigerator to see which refrigerant is used for your refrigerator.
When this product contains flammable gas (Refrigerant R-600a), contact your local authority in regard to safe disposal of this product. Cyclopentane is used as a insulation blowing gas.
The gases in insulation material require special disposal procedure. Please contact your local authorities in regard to the environmentally safe disposal of this product.
Ensure that none of the pipes on the back of the appliances are damaged prior to disposal.
The pipes shall be broke in the open space.
- If the appliance contains iso-butane refrigerant (R-600a), a natural gas with high environmental compatibility that is, however, also combustible.
When transporting and installing the appliance, care should be taken to ensure that no parts of the refrigerating circuit are damaged.
- When disposing of this product or other refrigerators, remove the door/door seals, door latch so that small children or animals cannot become trapped inside.
Leave the shelves in place so that children may not easily climb inside.
Children should be supervised to ensure that they do not play with the old appliance.
- Please dispose of the packaging material for this product in an environmentally friendly manner.

ADDITIONAL TIPS FOR PROPER USAGE



- In the event of a power failure, call the local office of your Electricity Company and ask how long it is going to last.
 - Most power failures that are corrected within an hour or two will not affect your refrigerator temperatures. However, you should minimize the number of door openings while the power is off.
 - Should the power failure last more than 2 hours, remove all ice in the Ice Bucket.
 - Should the power failure last more than 24 hours, remove all frozen food.
 - If keys are provided with the refrigerator, the keys should be kept out of the reach of children and not in vicinity of the appliance.
 - The appliance might not operate consistently (possibility of temperature becoming too warm in refrigerator) when sited for an extended period of time below the cold end of the range of temperature for which the refrigerating appliance is designed.
 - Do not store food which spoils easily at low temperature, such as bananas, melons.
 - Your appliance is frost free, which means there is no need to manually defrost your appliance, as this will be carried out automatically.
 - Temperature rising during the defrost can comply with ISO requirement. But if you want to prevent an undue rise in the temperature of the frozen food while defrosting the appliance, please wrap the frozen food in several layers of newspaper.
 - Any increase in temperature of frozen food during defrosting can shorten its storage life.
 - The temperature of two star section (sections) or compartment (compartments) which have two star symbol (☆☆) is slightly higher than other freezer compartment (compartments).
The two star section (sections) or compartment (compartments) is (are) based on the instruction and/or the condition as delivered.
-

Saving Energy Tips

- Install the appliance in a cool, dry room with adequate ventilation.
Ensure that it is not exposed to direct sunlight and never put it near a direct source of heat (radiator, for example).
- Never block any vents or grilles on the appliance.
- Allow warm food to cool down before placing it in the appliance.
- Put frozen food in the refrigerator to thaw.
You can then use the low temperatures of the frozen products to cool food in the refrigerator.
- Do not keep the door of the appliance open for too long when putting food in or taking food out.
The shorter time for which the door is open, the less ice will form in the freezer.
- Clean the rear of the refrigerator regularly. Dust increases energy consumption.
- Do not set temperature colder than necessary.
- Ensure sufficient air exhaust at the refrigerator base and at the back wall of the refrigerator.
Do not cover air vent openings.
- Allow clearance to the right, left, back and top when installing.
This will help reduce power consumption and keep your energy bills lower.
- For the most efficient use of energy, please keep the all inner fittings such as baskets, drawers, shelves on the position supplied by manufacturer.
- This appliance is intended to be used in household and similar applications such as
 - staff kitchen areas in shops, offices and other working environments;
 - farm houses and by clients in hotels, motels and other residential type environments;
 - bed and breakfast type environments;
 - catering and similar non-retail applications.

2. The Installation Space

Selecting the best location for the Refrigerator

- Select a location with easy access to the water supply.
- Select a location without direct exposure to sunlight.
- Select a location with level (or nearly level) flooring.
- Select a location with enough space for the refrigerator doors to open easily.
- Overall space required in use. Refer to drawing and dimension as below.
- Please ensure that appliance can be moved freely in the event of maintenance & service.

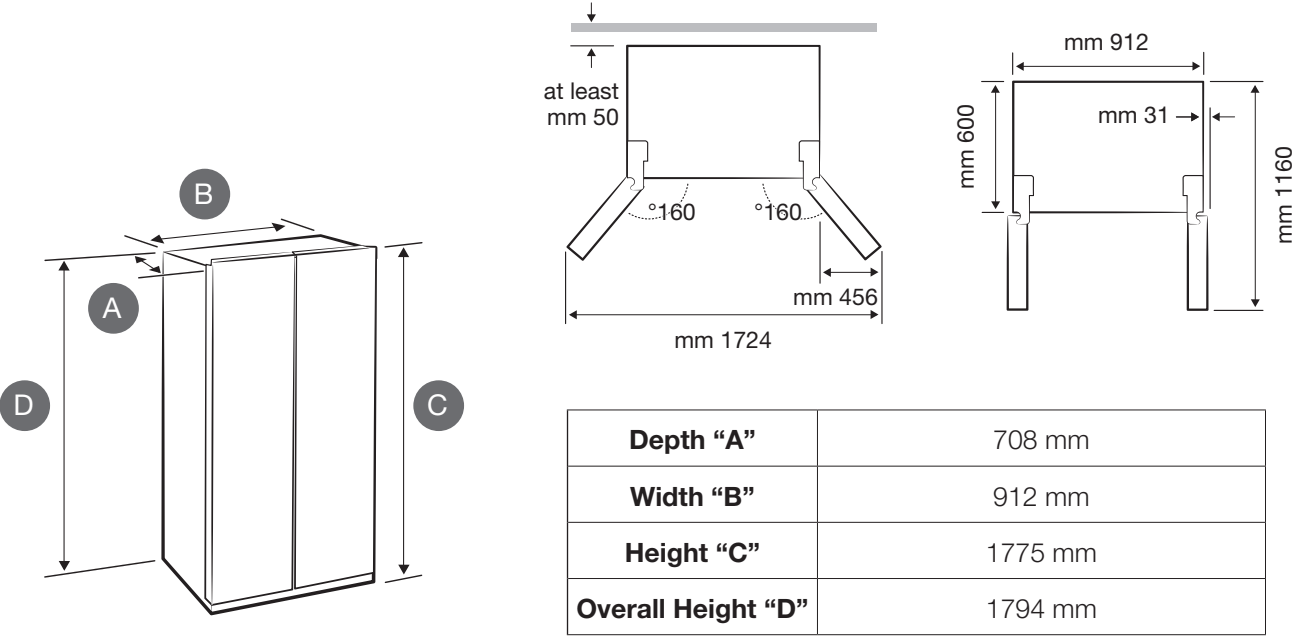

-  **Spacer (gray block) installation**
For better performance, please certainly fix the spacer on the rear of unit when installing the refrigerator. It is improving refrigerator performance.

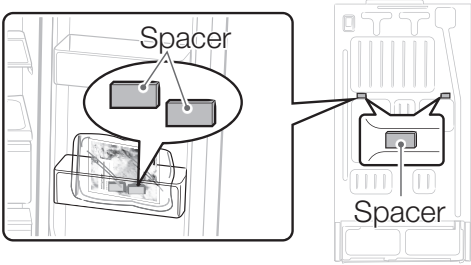

-  **CAUTION** When installing, servicing or cleaning behind the refrigerator, be sure to pull the unit straight out and push back in straight after finishing.

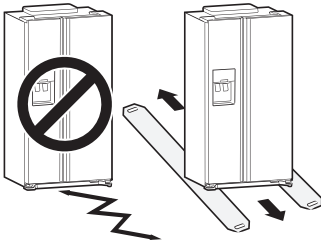

3. Names and basic functions

PARTS AND FEATURES



(01) Ice maker bucket	<p>Designed to store lots of easily.</p> <p> Do not put your fingers, hands or any other objects in the ice chute or the ice maker bucket. This may result in personal injury or material damage.</p>
(02) Multipurpose Freezer Compartments	<p>Features tall freezer compartments for more efficient food storage. Do not use these compartments for ice cream or items you intend to store for a long time.</p>
(03) Freezer shelves	<p>Use for storing meat, fish, frozen dumplings, ice cream and other types of frozen food.</p>
(04) Drawers	<p>Best used to store meats or dry foods. Stored food should be wrapped securely using foil or other suitable wrapping materials or containers.</p>
(05) Refrigerator shelves	<p>Use for storing general types of food that require refrigeration.</p>
(06) Door bins	<p>Designed to handle large, bulky items such as gallons of milk or other large bottles and containers.</p>
(07) Fruit & vegetable drawer	<p>Used to preserve the freshness of your stored vegetables and fruits. It has been specifically designed to control the level of humidity within the drawer.</p>

4. Operating your Refrigerator

USING THE CONTROL PANEL / DIGITAL DISPLAY

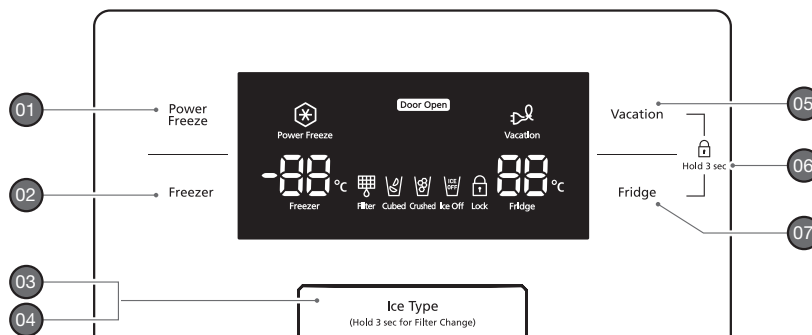

(01) Power freeze button	Speeds up the time needed to freeze products in the freezer. This can be helpful if you need to quickly freeze items that spoil easily or if the temperature in the freezer has warmed dramatically (For example, if the door was left open).
(02) Freezer button	Press the Freezer button to set the freezer to your desired temperature, You can set the temperature between -15 °C and -23 °C.
(03) Ice type button	Use this button to choose Cubed, Crushed or to turn the Ice feature off.
(04) Filter change button	When you change the filter, press this button for 3 seconds to reset the filter schedule.
(05) Vacation button	<p>If you are going on vacation or business trip or you do not need to use the refrigerator, press the Vacation button. When you select vacation button for fridge compartment off, display LED of Vacation will be on.</p> <p> It is strongly requested to remove foods in the fresh-food compartment and do not leave the door open when you select Vacation function.</p>
(06) Child lock function	By pressing the Vacation button and the Fridge button simultaneously for 3 seconds, all buttons will be locked. The Water dispenser lever and the Ice lever will not work either. To cancel this function, Press these two buttons for 3 seconds again.
(07) Fridge button	Press the Fridge button to set the fridge to your desired temperature. You can set temperature between 1 °C and 7 °C.
(08) Door open function	<ol style="list-style-type: none">1. If the fridge or the freezer door is open, the Door Open icon is lit.2. If the condition that generates a door alarm is satisfied because the fridge or the freezer door is open, the Door Open icon blinks.
Cooling OFF Mode	<p>Cooling Off mode (also called Shop mode), is designed for use by retailers when they are displaying refrigerators on the shop floor.</p> <p>In Cooling Off mode, the refrigerator's fan motor and lights work normally, but the compressors do not run, and the refrigerator and freezer do not get cold. To start Cooling Off mode, touch and hold the Power Freeze button and the Freezer button and the Vacation button for 5 seconds during normal operation. The refrigerator chime sounds and the temperature display flashes OFF.</p> <p>To cancel Cooling Off mode, touch and hold the Power Freeze and the Freezer and the Vacation buttons again for 5 seconds.</p>



When you use Power Freeze the energy consumption of the refrigerator will increase. Remember to turn it off when you don't need it and return the freezer to your original temperature setting.
If you need to freeze large amount of food stuff, activate Power Freeze function at least 20 hours before.

5. Troubleshooting

PROBLEM	SOLUTION
The refrigerator does not work at all or it does not chill sufficiently.	<ul style="list-style-type: none">• Check that the power plug is properly connected.• Is the temperature control on the display panel set to the correct temperature? Try setting it to a lower temperature.• Is the refrigerator in direct sunlight or located too near a heat source? If so, it may not be able to cool sufficiently. Install it in a location that is out of direct sunlight and not near a heat source.• Is the back of the refrigerator too close to the wall, preventing proper ventilation? If so, it may not be able to cool sufficiently. Keep it an appropriate distance from the wall.• Is there too much food inside so that the food is blocking the outlet vent? To keep the refrigerator at a suitable temperature, do not fill the refrigerator with too much food.
The food in the fridge is frozen.	<ul style="list-style-type: none">• Is the temperature control on the display panel set to the correct temperature? Try setting it to a warmer temperature.• Is the temperature in the room very low?• Did you store the food with a high water content in the coldest part of the fridge? Try moving those items into the body of the fridge instead of keeping them in the CoolSelect Zone™ drawer.
You hear unusual noises or sounds.	<ul style="list-style-type: none">• Check that the refrigerator is level and stable.• Is the back of the refrigerator too close to the wall and therefore keeping air from circulating?• Was anything dropped behind or under the refrigerator?• A “ticking” sound is heard from inside the refrigerator. This is normal and occurs because various accessories are contracting or expanding in relation to the temperature of the refrigerator interior.
The front corners of the appliance are hot and condensation is occurring.	<ul style="list-style-type: none">• Some heat is normal as anti-condensators are installed in the front corners of the refrigerator to prevent condensation.• Is the refrigerator door ajar? Condensation can occur when you leave the door open for a long time.
Ice is not dispensing.	<ul style="list-style-type: none">• Did you wait for 12 hours after installation of the water supply line before making ice? It may take longer to make ice if it is not sufficiently cool, such as when first installed.• Is the water line connected and the shut-off valve open?• Did you manually stop the ice making function? Make sure Ice Type is set to Cubed or Crushed.• Is there any ice blocked within the ice maker bucket?• Is the freezer temperature too warm? Try setting the freezer temperature lower.
You can hear water bubbling in the refrigerator.	<ul style="list-style-type: none">• This is normal. The bubbling comes from the refrigerant coolant liquid circulating through the refrigerator.
There is a bad smell in the refrigerator.	<ul style="list-style-type: none">• Has a food item spoiled?• Make sure that strong smelling food (for example, fish) is wrapped so that it is airtight.• Clean out your freezer periodically and throw away any spoiled food. <p>When cleaning the inside of the fridge, store food elsewhere and unplug the appliance. Wipe with a dry dishcloth after 2-3 hours and then circulate air inside the refrigerator.</p>
Frost forms on the walls of the freezer.	<ul style="list-style-type: none">• Is the air vent blocked? Remove any obstructions so air can circulate freely.• Allow sufficient space between the foods stored for efficient air circulation.• Is the freezer drawer closed properly? If the freezer drawer is not completely closed or is blocked, humidity from outside may enter and cause severe frost to form.
Water dispenser is not functioning.	<ul style="list-style-type: none">• Is the water line connected and the shut-off valve open?• Has the water supply line tubing been crushed or kinked? Make sure the tubing is free and clear of any obstruction.• Is the water tank frozen because the refrigerator temperature is too low? Try selecting a warmer setting on the main display panel.• Check if the filter is properly installed. If it is not properly installed, the water dispenser may not work.