

The Samsung logo, consisting of the word "SAMSUNG" in white, bold, sans-serif capital letters, is centered within a white, horizontally-oriented oval shape. This logo is positioned in the upper left corner of a dark blue rectangular header.

**SAMSUNG**

# Installation Guide

A solid blue vertical line is located to the left of the product series text, extending from the top of the text block to the bottom.

X422x/X425x/X430x series  
K425x/K430x/K435x series

# Machine overview

**DE** Übersicht über das Gerät

**FR** Aperçu de l'appareil

**IT** Panoramica del dispositivo

**ES** Descripción general de la impresora

**NL** Apparaatoverzicht

**HU** A készülék áttekintése

**NO** Oversikt over maskinen

**SE** Maskinöversikt

**FI** Laitteen yleiskuva

**DK** Oversigt over maskinen

**PL** Opis urządzenia

**GR** Επισκόπηση του μηχανήματος

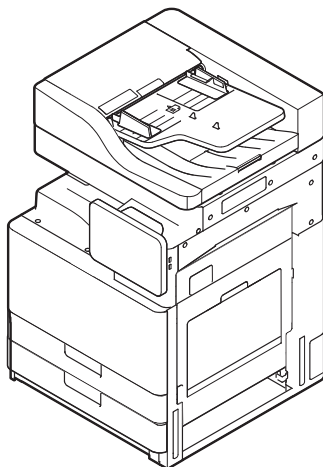

X422x Series / X425x Series / X430x Series

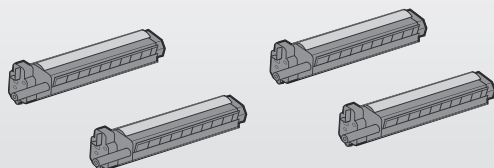

K425x Series  
/ K430x Series  
/ K435x Series

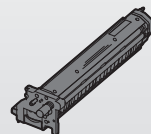

Included items may differ depending on the country.

**DE** Der Lieferumfang variiert je nach Auslieferungsland.

**FR** Les éléments inclus peuvent varier en fonction du pays.

**IT** Gli elementi inclusi possono differire da paese a paese.

**ES** Los elementos incluidos pueden variar en función del país.

**NL** Meegeleverde items kunnen afhankelijk van het land afwijken.

**NO** Hvilke enheter som er inkludert kan variere etter land.

**SE** De delar som ingår kan variera i olika länder.

**FI** Laitteen mukana toimitetut osat voivat vaihdella maittain.

**DK** Medfølgende elementer kan være anderledes, afhængigt af landet.

**PL** Dostarczone elementy mogą różnić się w zależności od kraju.

**HU** A mellékelt tételek országtól függően eltérők lehetnek.

**GR** Τα στοιχεία που περιλαμβάνονται μπορεί να διαφέρουν σύμφωνα με τη χώρα.

## Installation flow

---

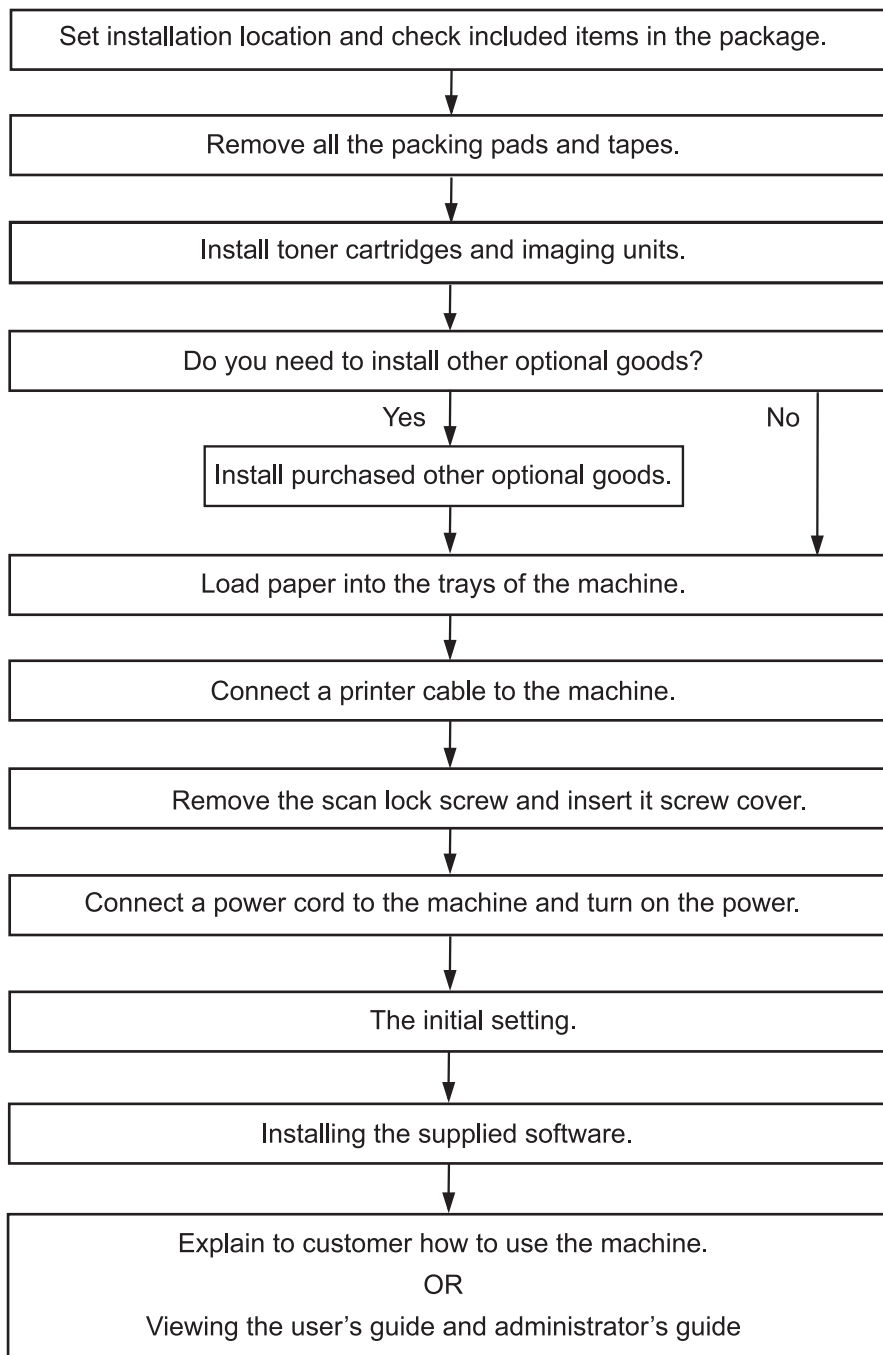

## DE Installationsablauf

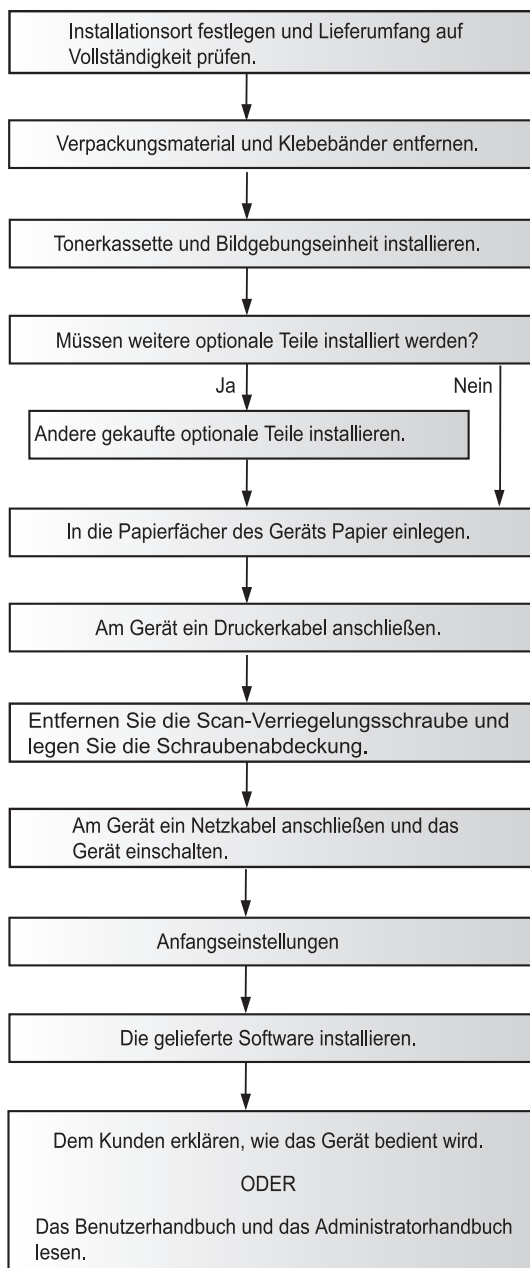

## FR Diagramme d'installation

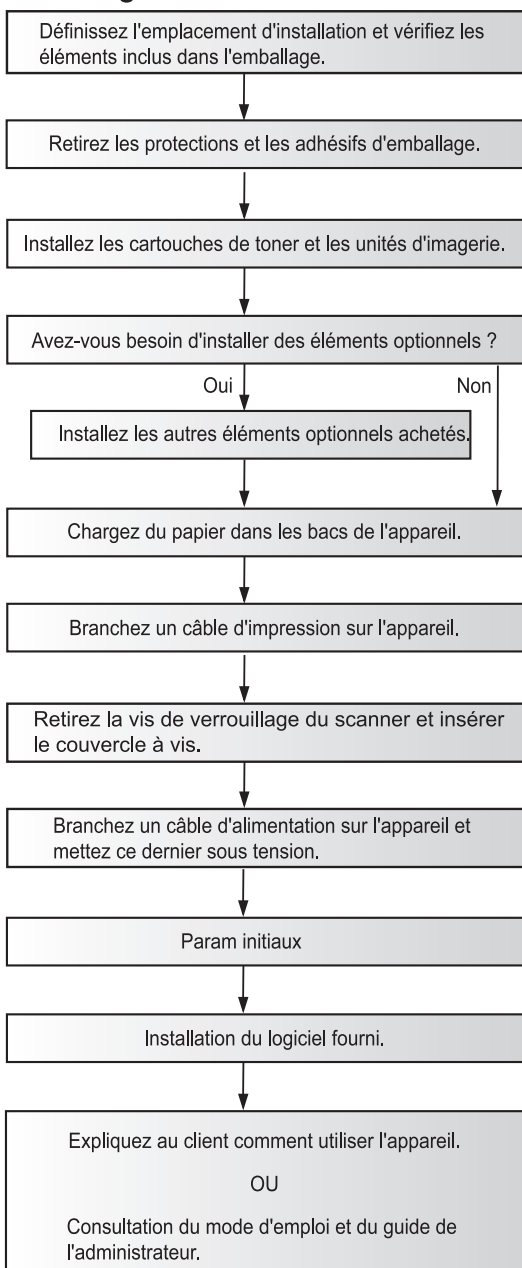



## IT Flusso dell'installazione

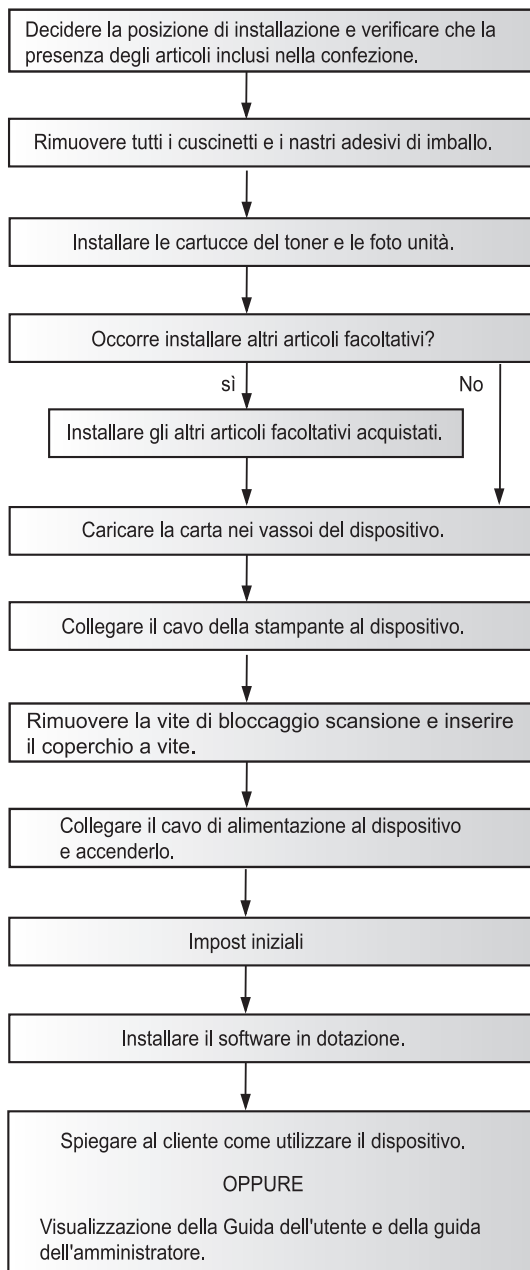

## ES Proceso de instalación

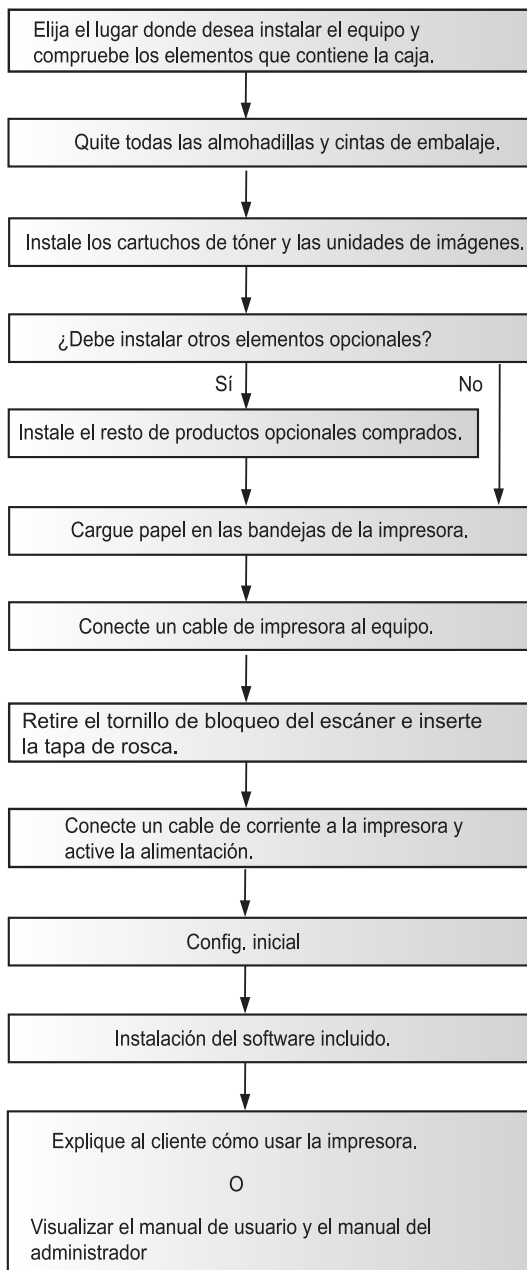

## NL Installatieprocedure

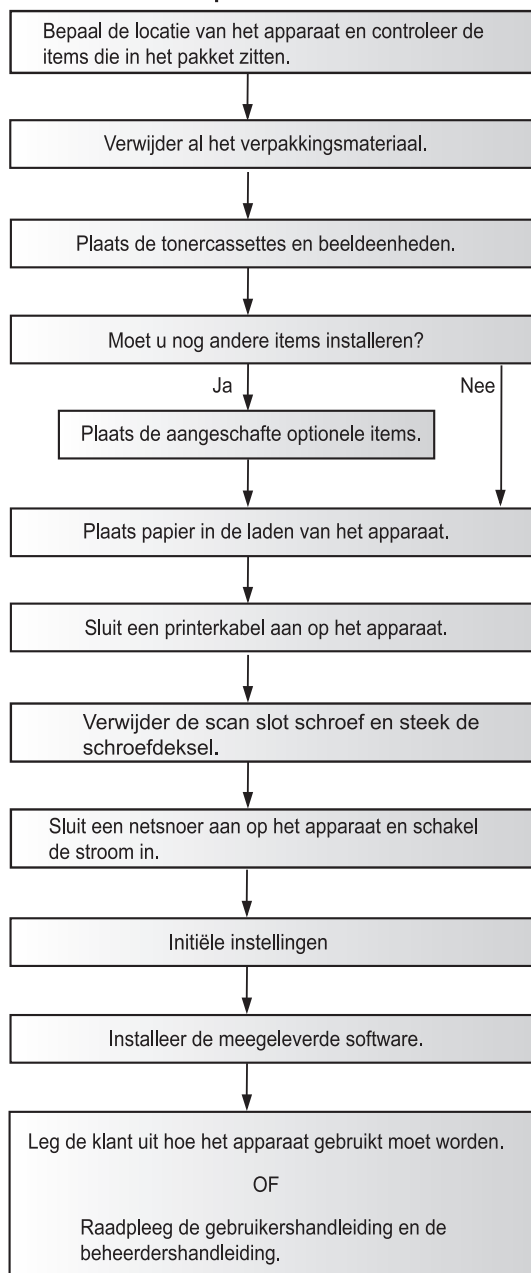

## NO Monteringsflyt

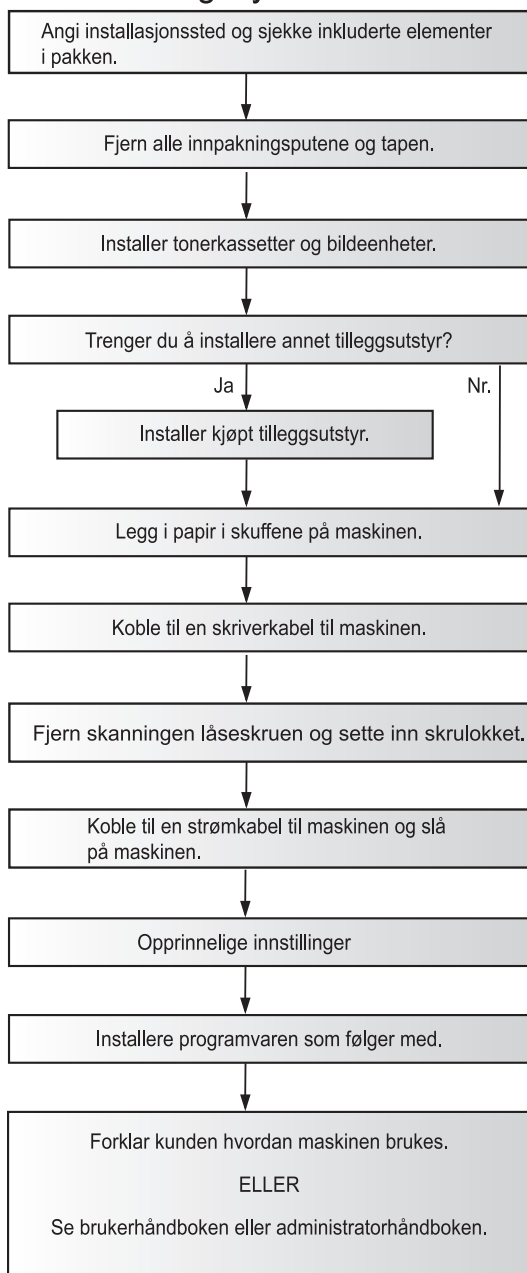

## SE Installationsflöde

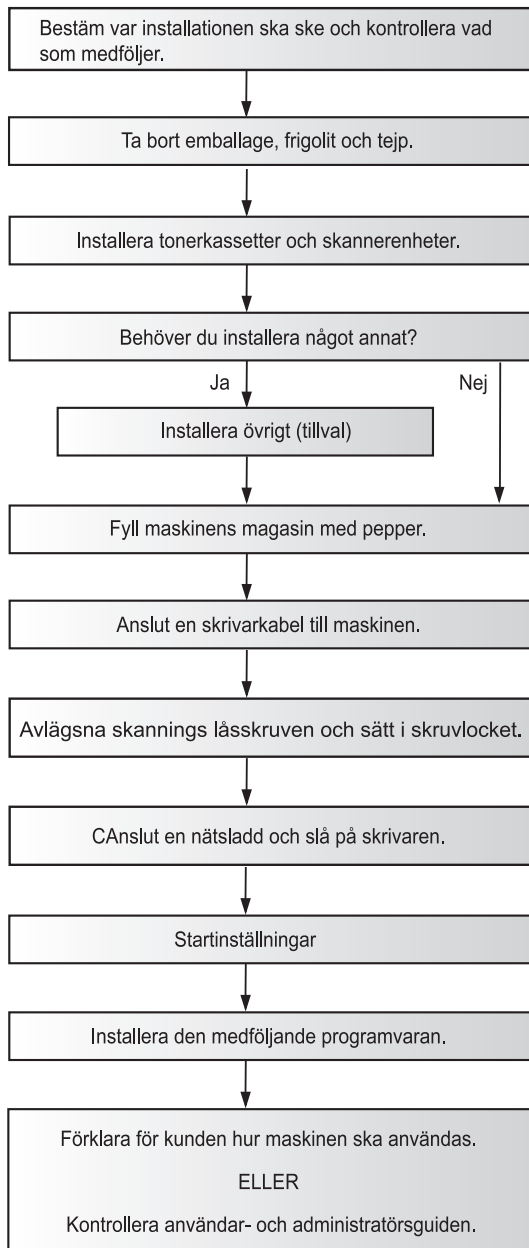

## FI Asennusjärjestys

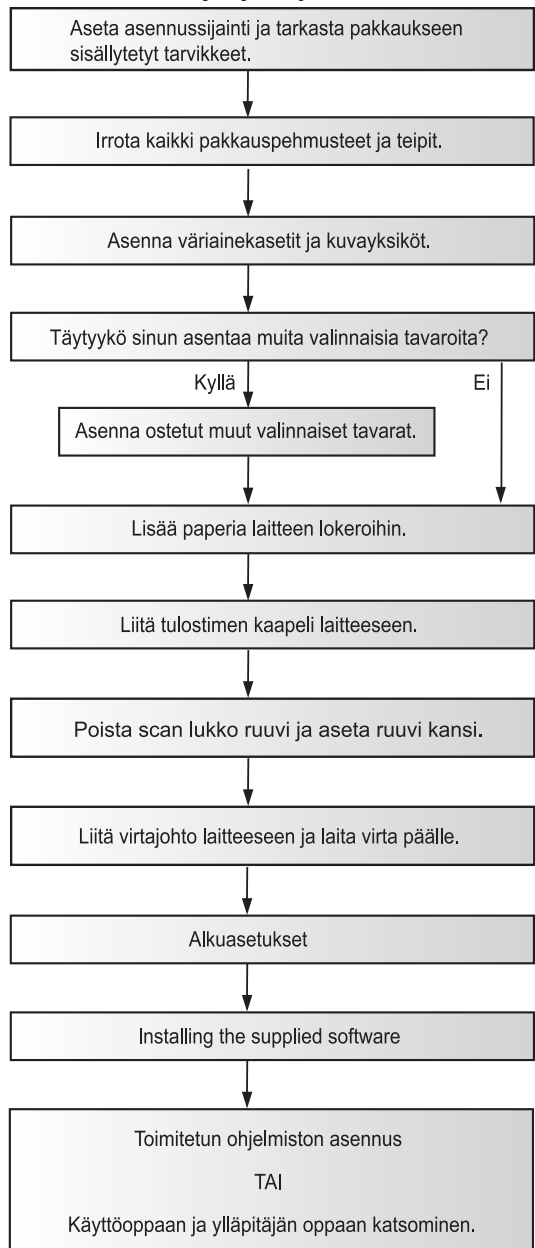

## DK Installationsflow

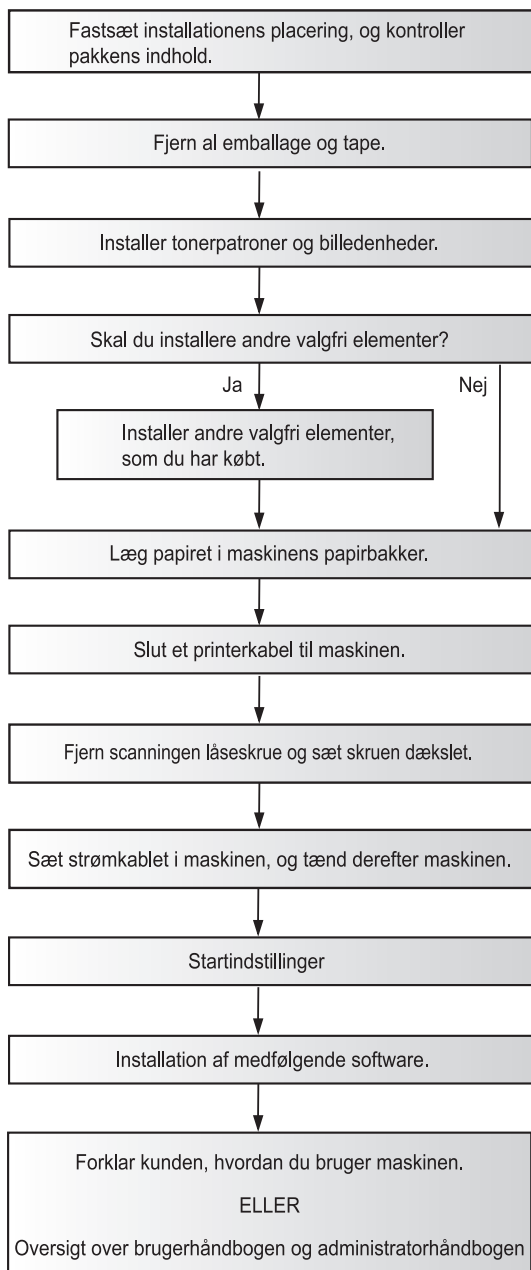

## PL Proces instalacji

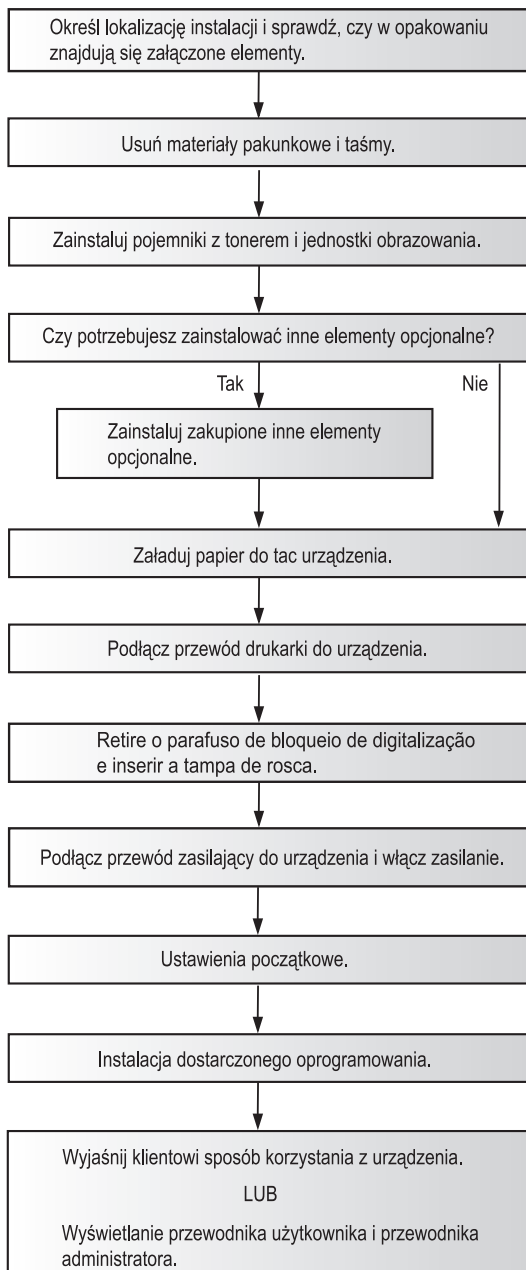

## HU A felszerelés menete

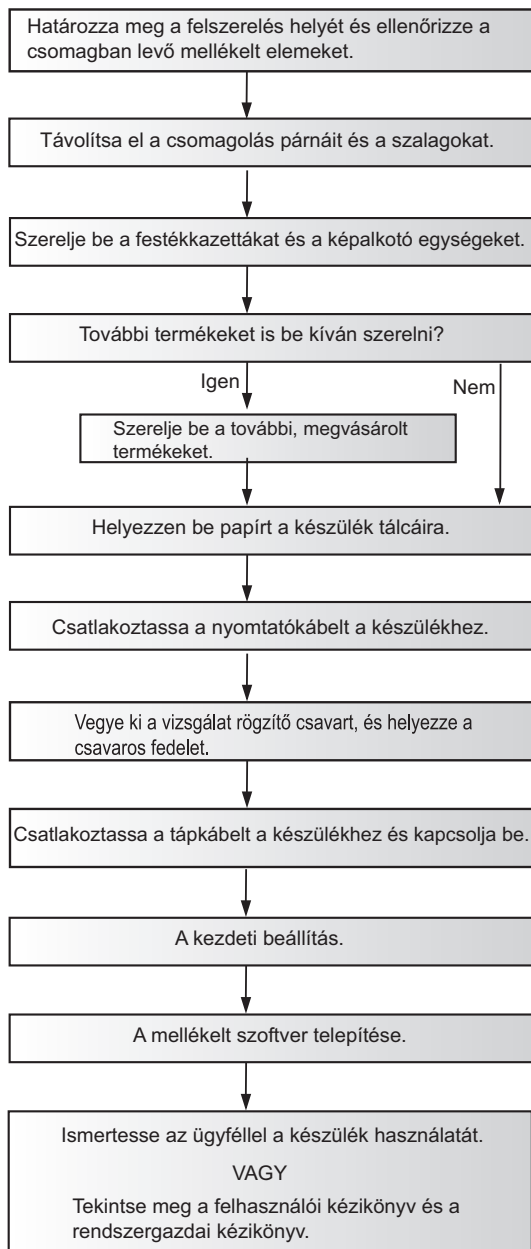

## GR Πορεία εγκατάστασης

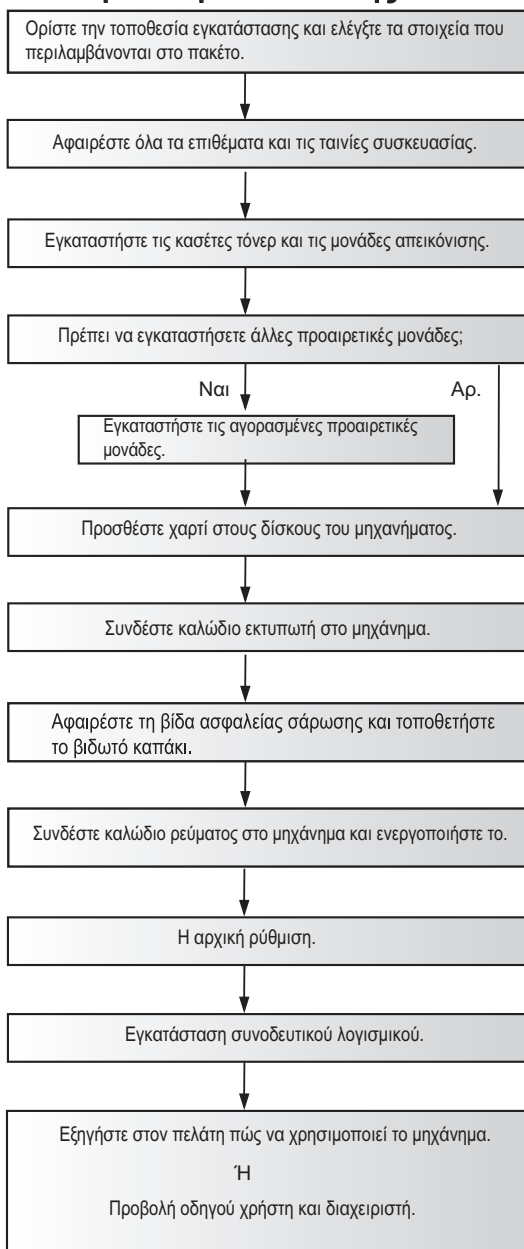

# Body installation

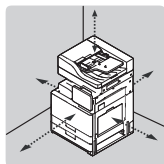

**DE** Gerätekörper installieren  
**FR** Installation du corps  
**IT** Installazione del corpo  
**ES** Instalación del equipo  
**NL** Het apparaat plaatsen  
**HU** Ház felszerelése

**NO** Installasjon av hoveddel  
**SE** Huvudinstallation  
**FI** Rungon asennus  
**DK** Installation af hovedelementet  
**PL** Instalacja obudowy  
**GR** Εγκατάσταση σώματος

1

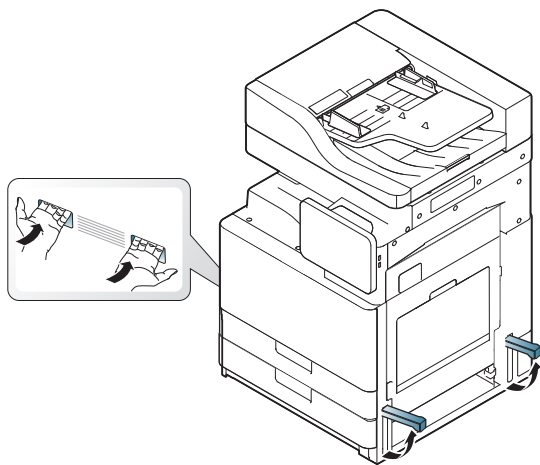

2

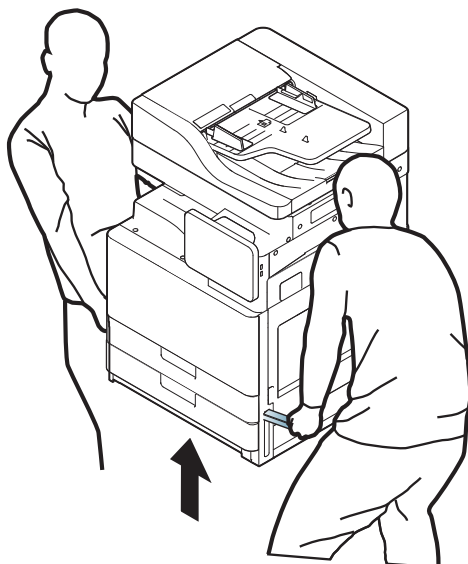

3

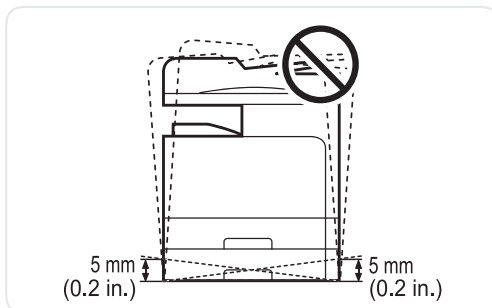
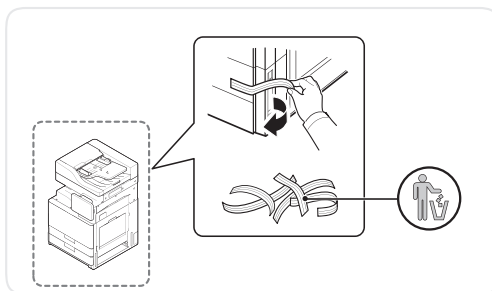
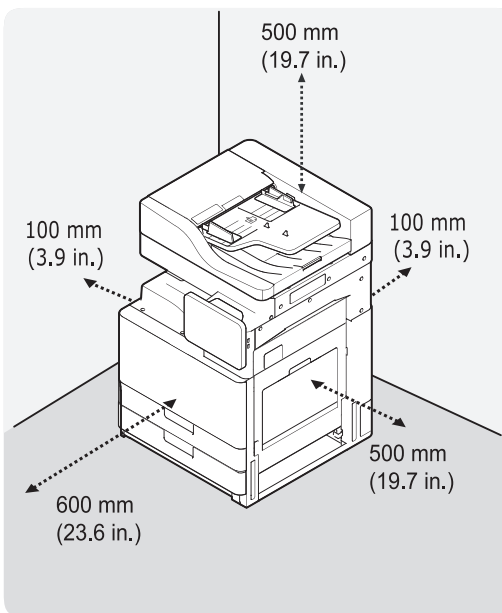

# Toner cartridges installation

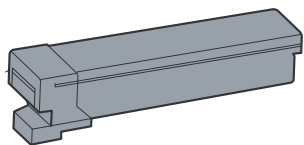

**DE** Tonerkartusche installieren

**FR** Installation des cartouches de toner

**IT** Installazione delle cartucce del toner

**ES** Instalación de los cartuchos de tóner

**NL** Tonercassettes plaatsen

**HU** Festékkazetták beszerelése

**NO** Sette inn tonerkassetter

**SE** Installera tonerkassetter

**FI** Väriainekasettien asennus

**DK** Installation af tonerpatroner

**PL** Instalacja pojemników z tonerem

**GR** Εγκατάσταση κασετών τόνερ

1

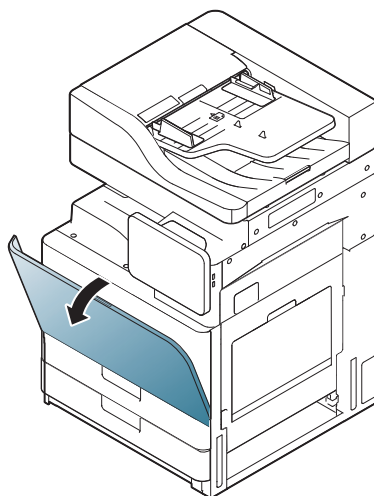

2

X422x Series / X425x Series / X430x Series

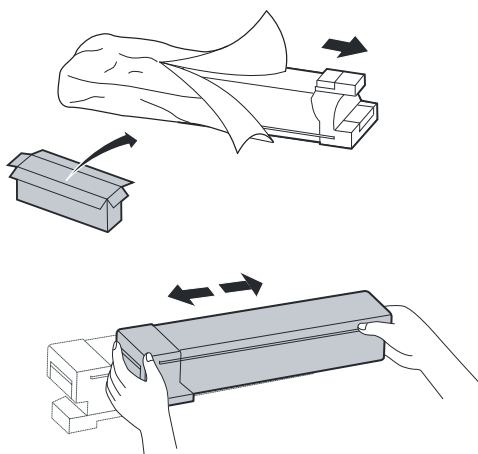

K425x Series / K430x Series / K435x Series

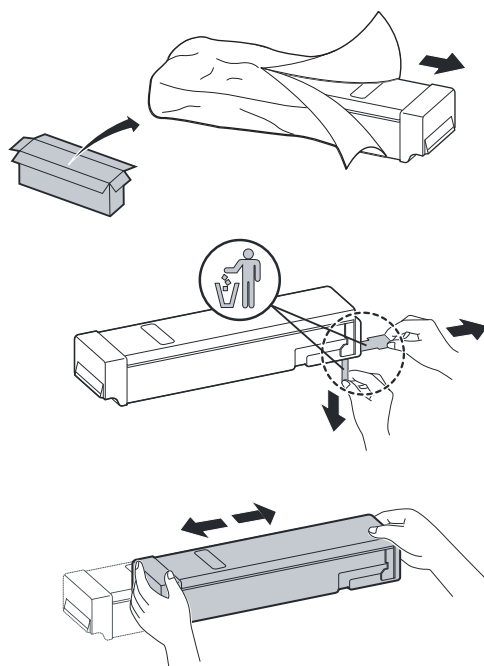

X422x Series / X425x Series / X430x Series

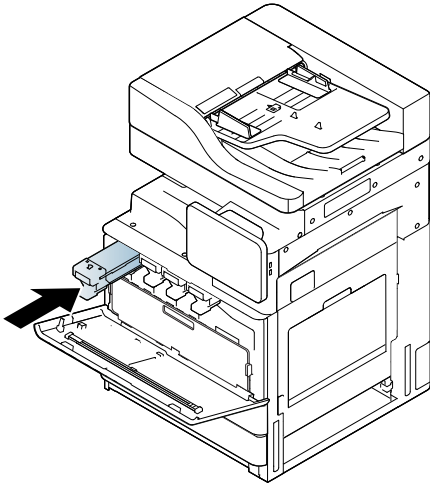

K425x Series / K430x Series / K435x Series

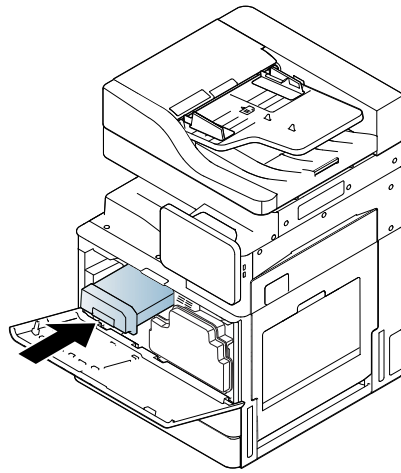

X422x Series / X425x Series / X430x Series

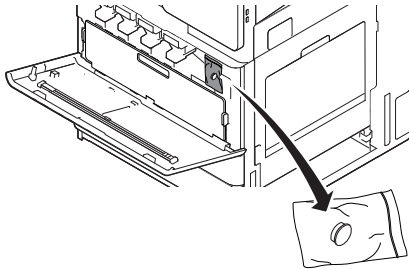

K425x Series / K430x Series / K435x Series

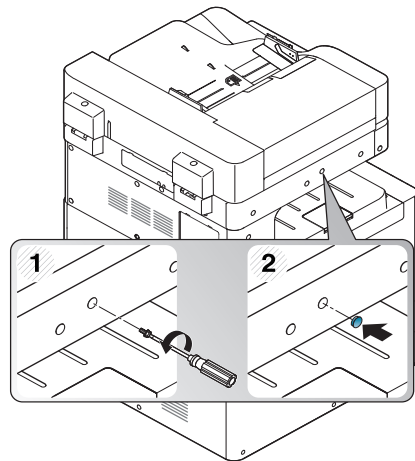
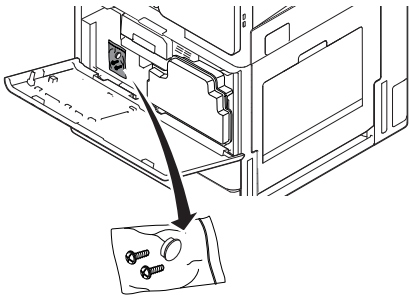



# Imaging units installation (X422x/X425x/X430x series)

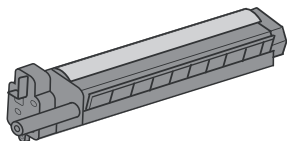

**DE** Bildgebungseinheit installieren

**FR** Installation des unités d'imagerie

**IT** Installazione foto unità

**ES** Instalación de las unidades de imagen

**NL** Beeldeenheden plaatsen

**HU** Képfalkotó egységek beszerelése

**NO** Sette inn bildeenheter

**SE** Installera skannerenheter

**FI** Kuvayksiköiden asennus

**DK** Installation af billedenheder

**PL** Instalacja jednostek obrazowania

**GR** Εγκατάσταση μονάδων απεικόνισης

1

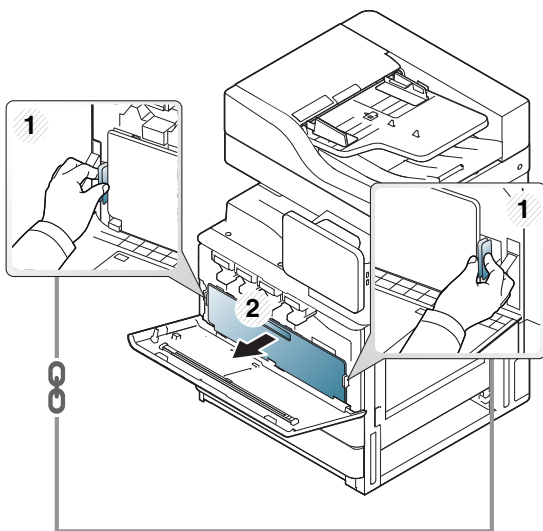

2

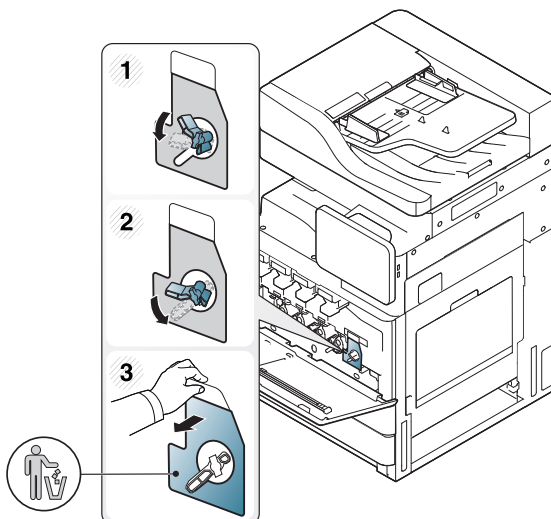

3

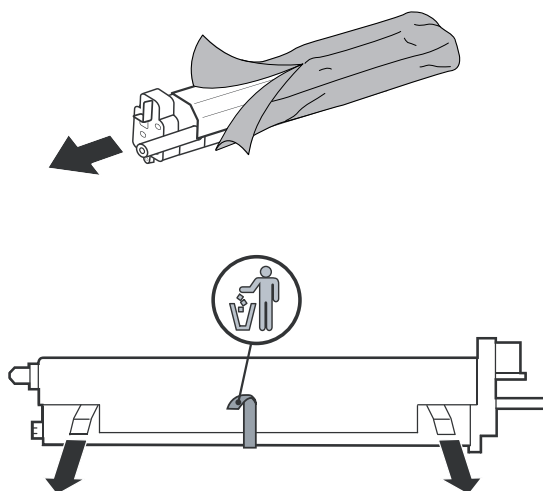

4

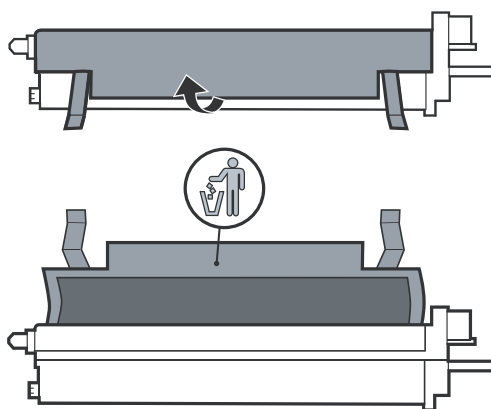

5

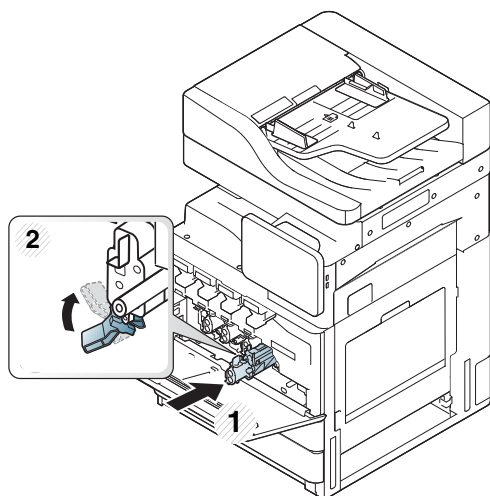

6

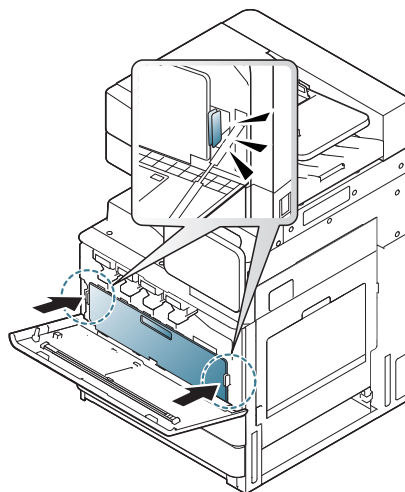

7

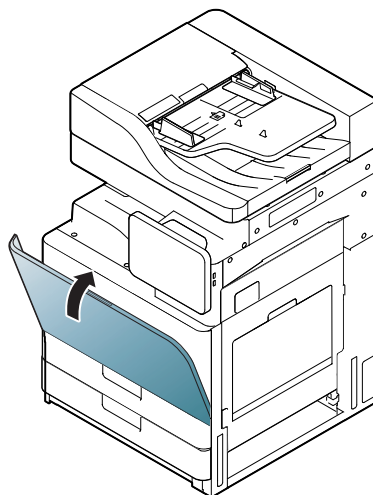

# Imaging units installation (K425x/K430x/K435x series)

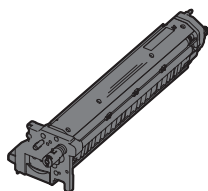

**DE** Bildgebungseinheit installieren  
**FR** Installation des unités d'imagerie  
**IT** Installazione foto unità  
**ES** Instalación de las unidades de imagen  
**NL** Beeldeenheden plaatsen  
**HU** Képkalkotó egységek beszerelése

**NO** Sette inn bildeenheter  
**SE** Installera skannerenheter  
**FI** Kuvayksiköiden asennus  
**DK** Installation af billedenheder  
**PL** Instalacja jednostek obrazowania  
**GR** Εγκατάσταση μονάδων απεικόνισης

1

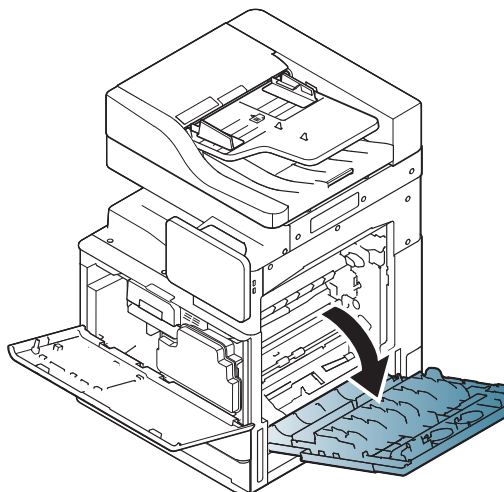

2

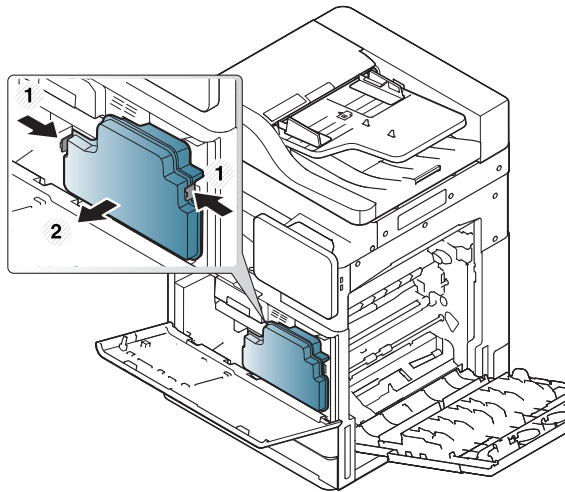

3

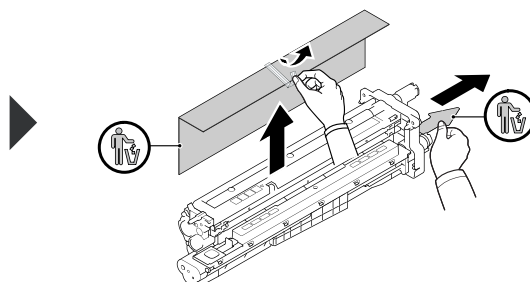
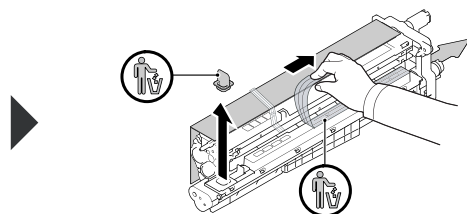
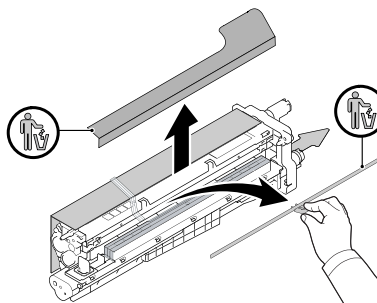
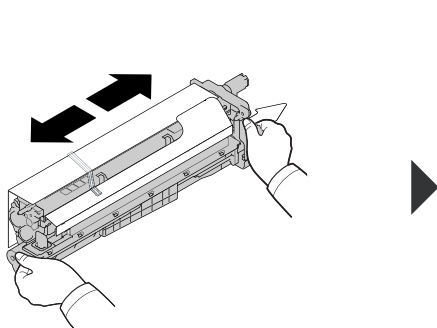

4

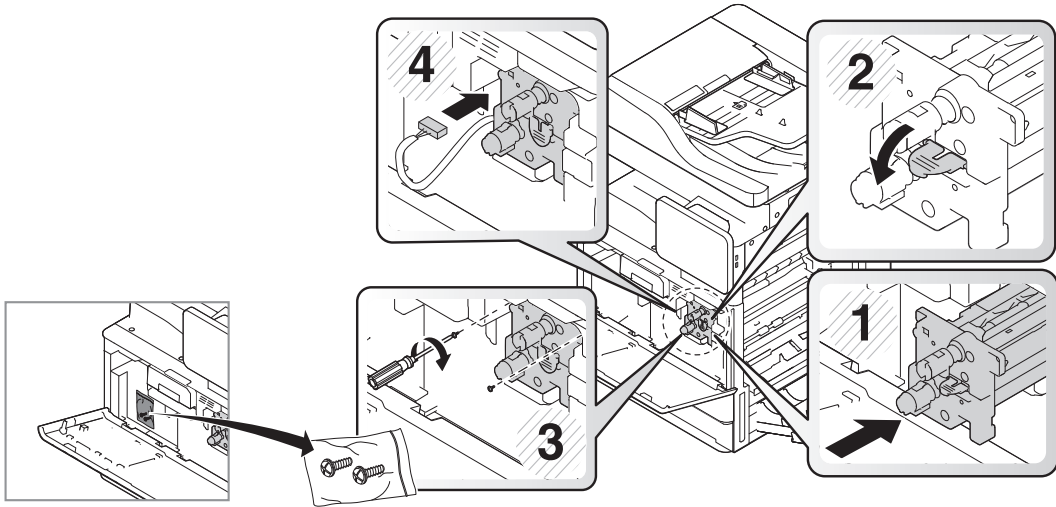

5

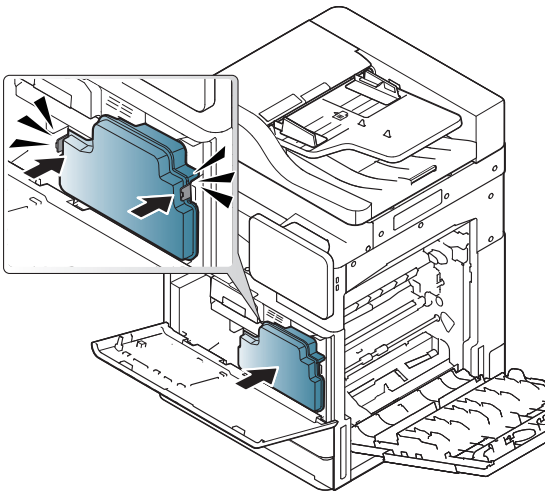

6

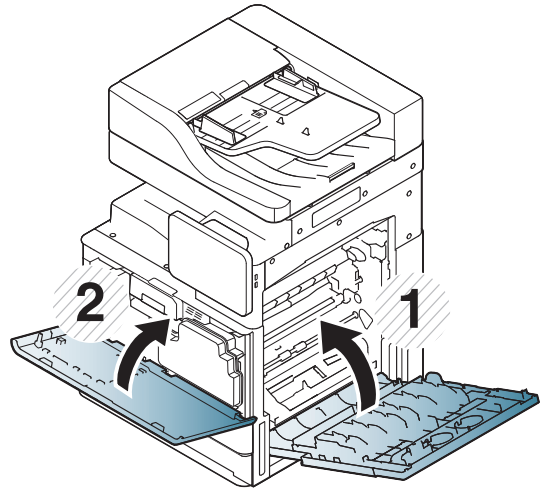

# Loading paper



**DE** Papier einlegen  
**FR** Chargement du papier  
**IT** Caricamento della carta  
**ES** Carga de papel  
**NL** Papier plaatsen  
**HU** Papír behelyezése

**NO** Legge i papir  
**SE** Fylla på papper  
**FI** Paperin lisääminen  
**DK** Ilægning af papir  
**PL** Ładowanie papieru  
**GR** Τοποθέτηση χαρτιού

1

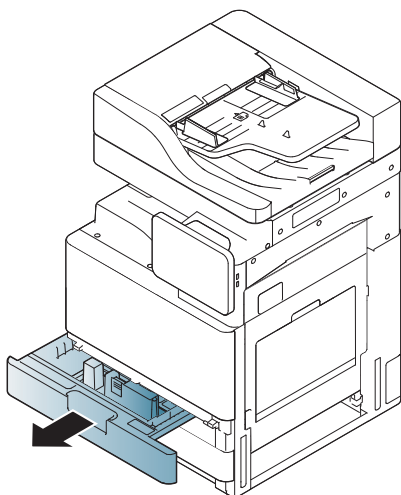

2

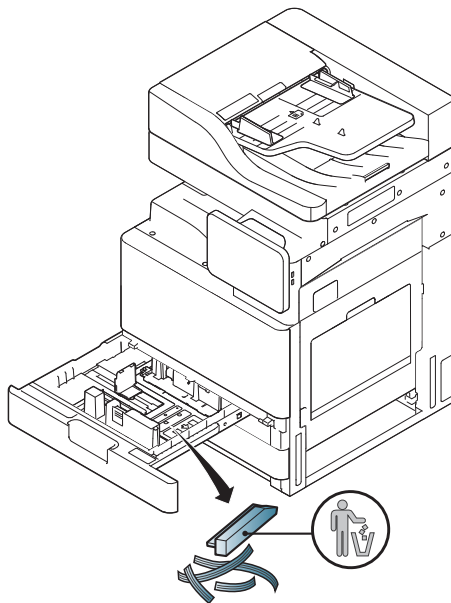

3

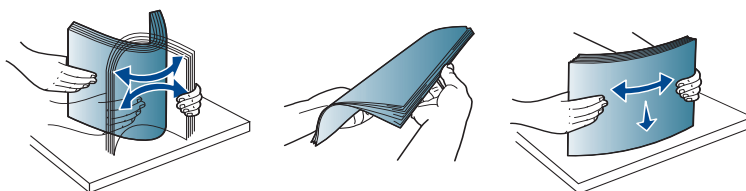

4

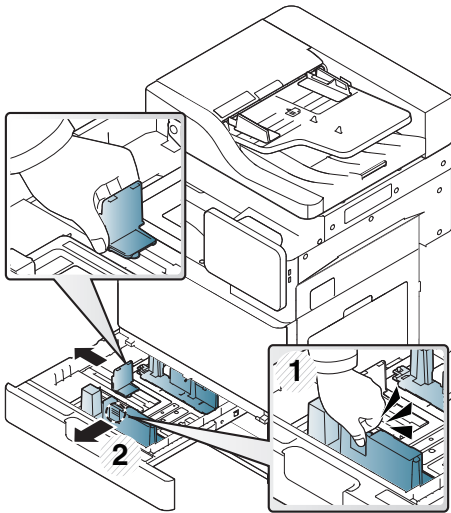

5

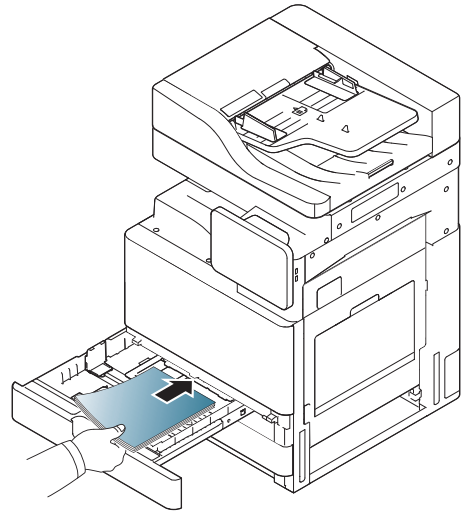

6

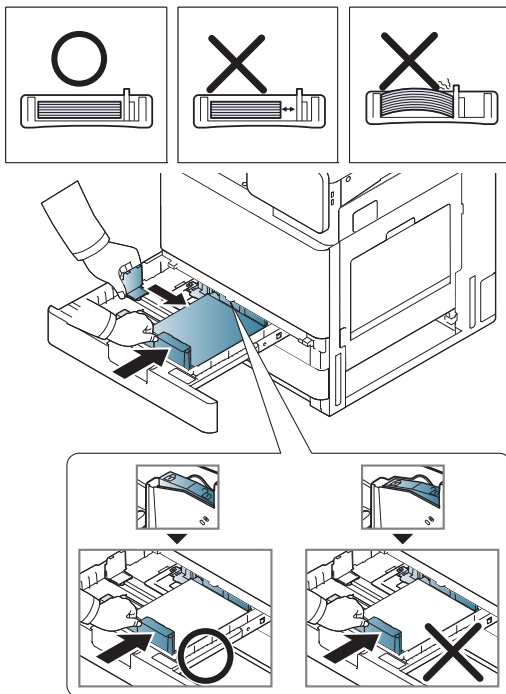

7

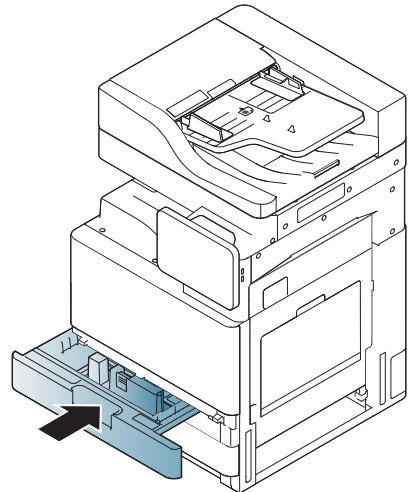

## Connecting network cable



- |  |   |
|--|---|
| <b>DE</b> Netzwerkkabel anschließen      | <b>NO</b> Koble til nettverkskabel        |
| <b>FR</b> Branchement du câble réseau    | <b>SE</b> Ansluta nätverkskabel           |
| <b>IT</b> Collegamento del cavo di rete  | <b>FI</b> Verkkokaapelin liittäminen      |
| <b>ES</b> Conexión del cable de red      | <b>DK</b> Tilslutning af netværkskablet   |
| <b>NL</b> Netwerkkabel aansluiten        | <b>PL</b> Podłączanie przewodu sieciowego |
| <b>HU</b> Hálózati kábel csatlakoztatása | <b>GR</b> Σύνδεση καλωδίου δικτύου        |

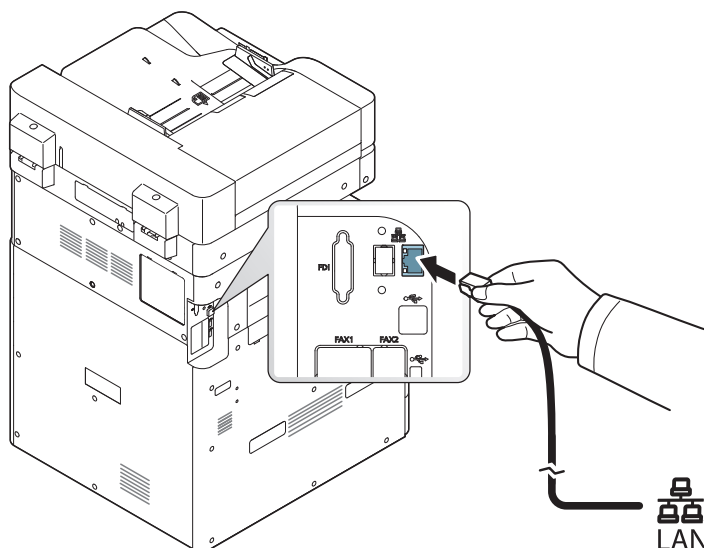

## Turning the machine on



- |   |                                       |
|---|---------------------------------------|
| <b>DE</b> Das Gerät einschalten           | <b>NO</b> Slå på maskinen             |
| <b>FR</b> Mise sous tension de l'appareil | <b>SE</b> Slå på maskinen             |
| <b>IT</b> Accensione del dispositivo      | <b>FI</b> Laitteen päälle laittaminen |
| <b>ES</b> Encendido de la impresora       | <b>DK</b> Sådan tænder du maskinen    |
| <b>NL</b> Het apparaat inschakelen        | <b>PL</b> Włączanie urządzenia        |
| <b>HU</b> A készülék bekapcsolása         | <b>GR</b> Ενεργοποίηση μηχανήματος    |

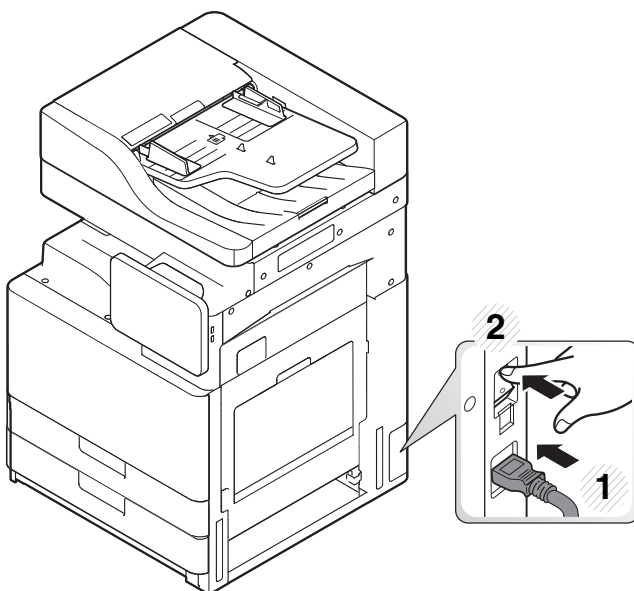

# Initial settings



- |                                 |                                      |
|---------------------------------|--------------------------------------|
| <b>DE</b> Anfangseinstellungen  | <b>NO</b> Opprinnelige innstillinger |
| <b>FR</b> Param initiaux        | <b>SE</b> Startinställningar         |
| <b>IT</b> Impost iniziali       | <b>FI</b> Alkuasetukset              |
| <b>ES</b> Config. inicial       | <b>DK</b> Startindstillinger         |
| <b>NL</b> Initiële instellingen | <b>PL</b> Ustawienia początkowe      |
| <b>HU</b> Kezdeti beállítások   | <b>GR</b> Αρχικές ρυθμίσεις          |

Press the language to use on the display screen and then press **Next**.

- DE** Wählen Sie die gewünschte Bildschirmsprache aus und drücken Sie dann auf **Weiter**.
- FR** Appuyez sur la langue à utiliser pour l'écran d'affichage, puis appuyez sur **Suivant**.
- IT** Selezionare la lingua da utilizzare sulla schermata del display, quindi premere **Avanti**.
- ES** Pulse un idioma para usarlo en la pantalla y, entonces, pulse **Siguiente**.
- NL** Druk op de taal die u voor het weergavescherm wilt gebruiken en druk vervolgens op **Volg..**
- NO** Trykk på språket som skal brukes på displayet, og trykk deretter **Neste**.
- SE** Tryck på det språk som ska användas på displayen och tryck sedan på **Nästa**.
- FI** Valitse näyttön kieli ja valitse sitten **Seuraava**.
- DK** Tryk på det sprog, du vil anvende på displayet, og tryk på **Næste**.
- PL** Naciśnij język, który ma być używany na ekranie, a następnie naciśnij **Dalej**.
- HU** Nyomja meg a használni kívánt nyelvet a kijelzőn, majd nyomja meg a **Tovább** gombot.
- GR** Πατήστε τη γλώσσα που θα χρησιμοποιείται στην οθόνη και πατήστε **Επόμενο**.

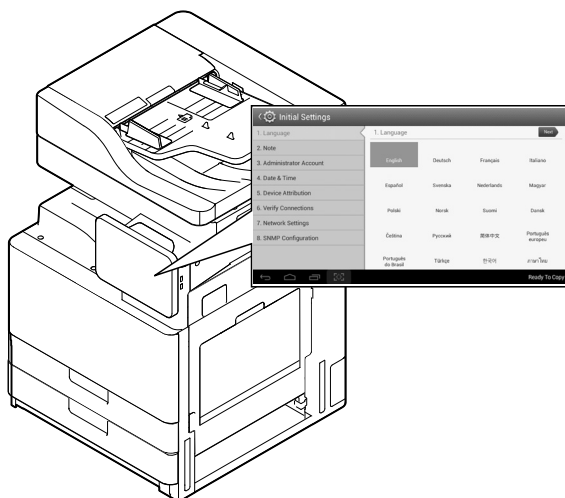



# Installing the supplied software



**DE** Die gelieferte Software installieren

**FR** Installation du logiciel fourni

**IT** Installazione del software in dotazione

**ES** Instalación del software incluido

**NL** Meegeleverde software installeren

**HU** A mellékelt szoftver telepítése

**NO** Installere programvaren som følger med

**SE** Installera medföljande programvara

**FI** Toimitetun ohjelmiston asennus

**DK** Installation af medfølgende software

**PL** Instalowanie dostarczonego oprogramowania

**GR** Εγκατάσταση συνοδευτικού λογισμικού

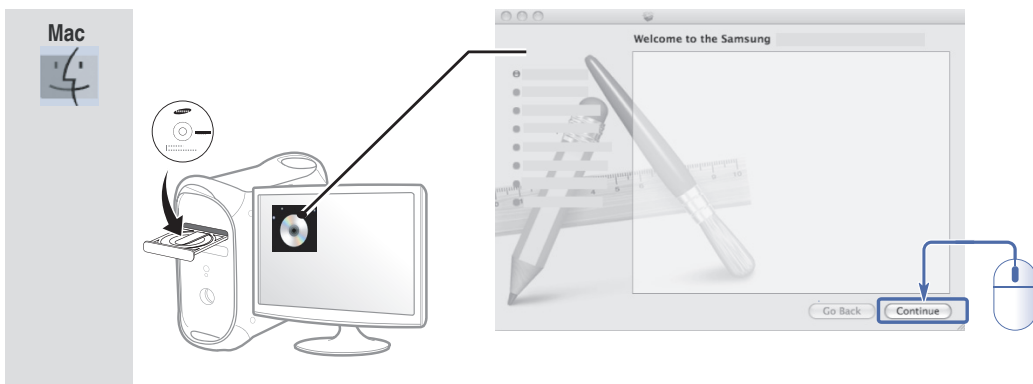
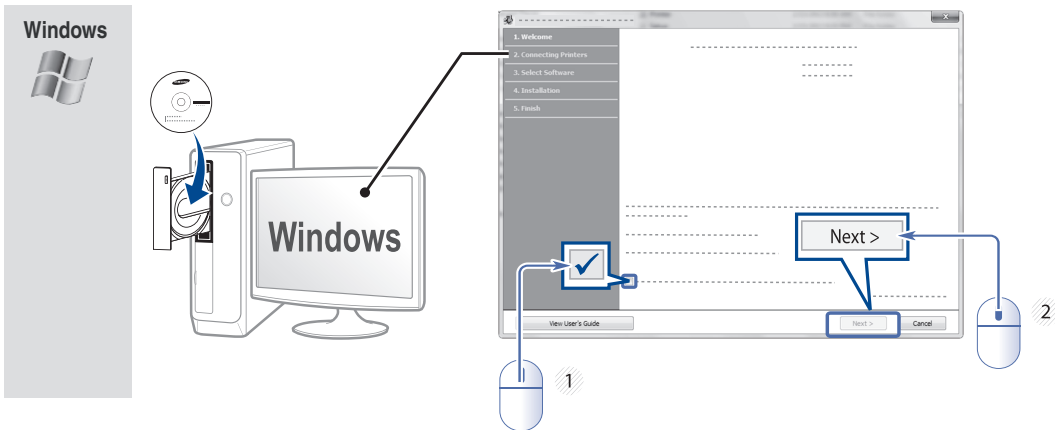

UNIX®  
/  
Linux

Download

<http://www.samsung.com>



## Viewing the user's guide and administrator's guide



- DE** Das Benutzerhandbuch und das Administratorhandbuch lesen
- FR** Consultation du mode d'emploi et du guide de l'administrateur
- IT** Visualizzazione della Guida dell'utente e della guida dell'amministratore
- ES** Visualizar el manual de usuario y el manual del administrador
- NL** De gebruikershandleiding en de beheerdershandleiding raadplegen
- NO** Se brukerhåndboken eller administratorhåndboken
- SE** Kontrollera användar- och administratörsguiden
- FI** Käyttöoppaan ja ylläpitäjän oppaan katsominen
- DK** Oversigt over brugerhåndbogen og administratorhåndbogen
- PL** Wyświetlanie przewodnika użytkownika i przewodnika administratora
- HU** Tekintse meg a felhasználói kézikönyv és a rendszergazdai kézikönyv
- GR** Προβολή οδηγού χρήστη και διαχειριστή

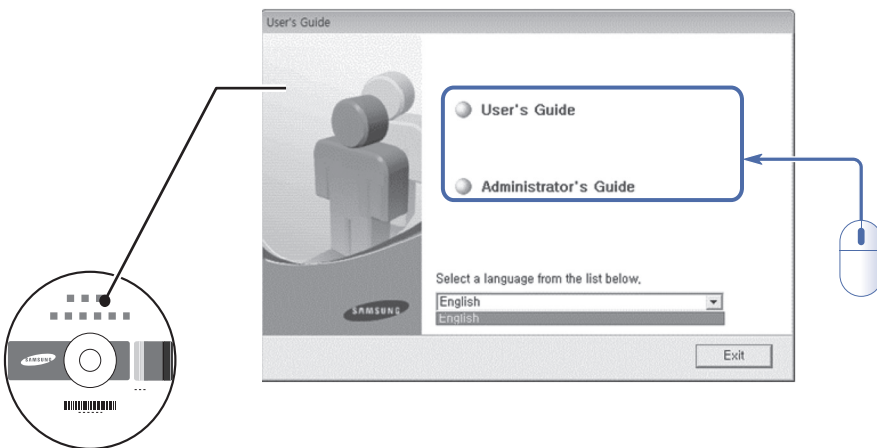

**SAMSUNG**



JC68-03192A00