

SERIES
5

LCD TV

quick start guide

imagine the possibilities

Thank you for purchasing a Samsung product.
To receive a more complete service, please
register your product at

www.samsung.com/global/register

SAMSUNG

connections

⚠ Caution

- When connecting an external device, match the colour of the connection terminal to the cable.
- The product colour and shape may vary depending on the model.
- Each Cable Box/Satellite receiver (Set-Top Box) has a different back panel configuration.
- Whenever you connect an external device to your TV, make sure that power on the unit is turned off.

CONNECTING A CABLE BOX/SATELLITE RECEIVER (SET-TOP BOX) VIA HDMI

LA32C530 / LA32C531 / LA37C530 / LA40C530 / LA40C531/ LA46C530

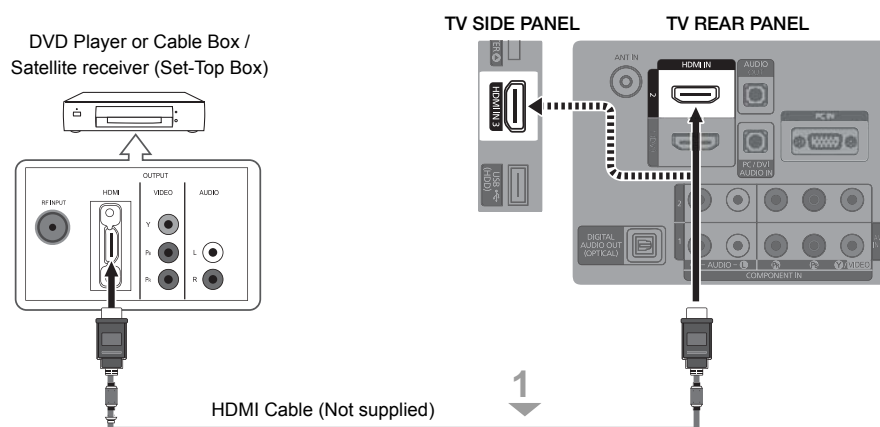

1. Connect an HDMI Cable(Not supplied) between the HDMI IN (1or 2(DVI)) jack on the TV and the HDMI jack on the Cable Box/Satellite receiver (Set-Top Box).

- No additional Audio connection is needed for an HDMI to HDMI connection.
- When using an HDMI/DVI cable connection, you must use the HDMI IN 2(DVI) jack.

CONNECTING A CABLE BOX/SATELLITE RECEIVER (SET-TOP BOX) VIA DVI

LA32C530 / LA32C531 / LA37C530 / LA40C530 / LA40C531 / LA46C530

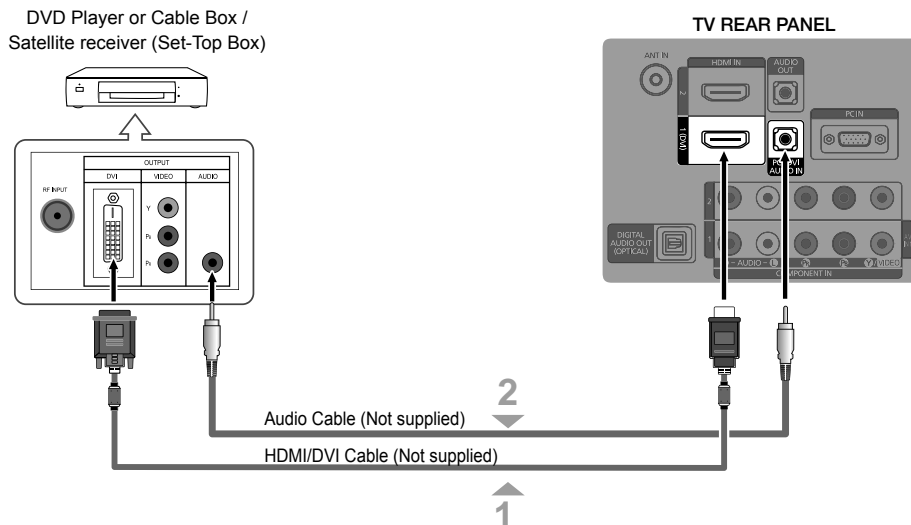

1. Connect an HDMI Cable(Not supplied) between the HDMI IN 2(DVI) jack on the TV and the HDMI jack on the Cable Box/Satellite receiver (Set-Top Box).
 2. Connect Audio Cables(Not supplied) between the DVI AUDIO IN jack on the TV and the Cable Box/Satellite receiver (Set-Top Box).
- When using an HDMI/DVI cable(Not supplied) connection, you must use the HDMI IN 2 jack.

CONNECTING A CABLE BOX/SATELLITE RECEIVER (SET-TOP BOX) VIA COMPONENT CABLES

LA32C530 / LA32C531 / LA37C530 / LA40C530 / LA40C531 / LA46C530

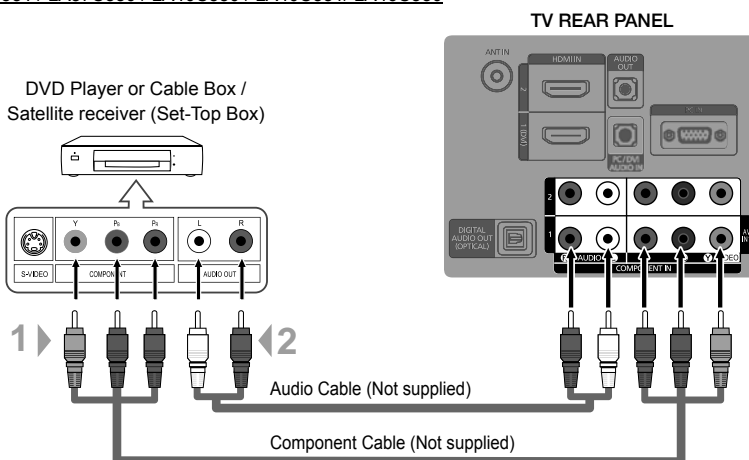

1. Connect a Component Cable(Not supplied) between the COMPONENT IN 1, 2 [Y, Pb, Pr] jacks on the TV and the COMPONENT jacks on the Cable Box/Satellite receiver (Set-Top Box).
2. Connect Audio Cables(Not supplied) between the COMPONENT IN 1, 2 [R-AUDIO-L] jacks on the TV and the AUDIO OUT jacks on the Cable Box/Satellite receiver (Set-Top Box).

How to Navigate Menus

Before using the TV, follow the steps below to learn how to navigate the menu and select and adjust different functions.

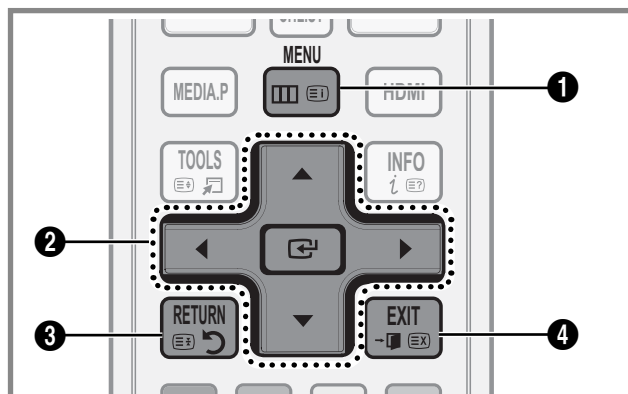

- ❶ MENU button: Displays the main on-screen menu.
- ❷ ENTER / Direction button: Move the cursor and select an item. Confirm the setting.
- ❸ RETURN button: Returns to the previous menu.
- ❹ EXIT button: Exits the on-screen menu.

HOW TO OPERATE THE OSD (ON SCREEN DISPLAY)

The access step may differ depending on the selected menu.

| | | | | | |
|---|-------|---|---|-------|--|
| 1 | MENU | The main menu options appears on the screen: Picture, Sound, Channel, Setup, Input. | 5 | ◀ / ▶ | Adjust the value of an item with the ◀ or ▶ button. The adjustment in the OSD may differ depending on the selected menu. |
| 2 | ▲ / ▼ | Select an icon with the ▲ or ▼ button. | 6 | ENTER | Press ENTER to complete the configuration. |
| 3 | ENTER | Press ENTER to access the sub-menu. | 7 | EXIT | Press EXIT. |
| 4 | ▲ / ▼ | Select the desired submenu with the ▲ or ▼ button. | | | |



Contact SAMSUNG WORLDWIDE

If you have any questions or comments relating to Samsung products, please contact the SAMSUNG customer care centre.

| Country | Customer Care Centre ☎ | Web Site |
|--------------|--|--|
| AUSTRALIA | 1300 362 603 | www.samsung.com |
| BAHRAIN | 8000-4726 | - |
| CHINA | 400-810-5858 010-6475 1880 | www.samsung.com |
| HONG KONG | (852) 3698-4698 | www.samsung.com/hk www.samsung.com/hk_en/ |
| INDIA | 3030 8282 1800 110011 1800 3000 8282 1800 266 8282 | www.samsung.com |
| INDONESIA | 0800-112-8888 021-5699-7777 | www.samsung.com |
| JAPAN | 0120-327-527 | www.samsung.com |
| JORDAN | 800-22273 | - |
| MALAYSIA | 1800-88-9999 | www.samsung.com |
| NEW ZEALAND | 0800 SAMSUNG (0800 726 786) | www.samsung.com |
| PHILIPPINES | 1-800-10-SAMSUNG(726-7864) 1-800-3-SAMSUNG(726-7864) 1-800-8-SAMSUNG(726-7864) 02-5805777 | www.samsung.com |
| SINGAPORE | 1800-SAMSUNG(726-7864) | www.samsung.com |
| SOUTH AFRICA | 0860-SAMSUNG(726-7864) | www.samsung.com |
| TAIWAN | 0800-329-999 | www.samsung.com |
| THAILAND | 1800-29-3232 02-689-3232 | www.samsung.com |
| U.A.E | 800-SAMSUNG (726-7864) | www.samsung.com |
| VIETNAM | 1 800 588 889 | www.samsung.com |