

SERIES  
**4**

# LCD TV

## quick start guide

imagine the possibilities

Thank you for purchasing a Samsung product.  
To receive a more complete service, please  
register your product at

[www.samsung.com/global/register](http://www.samsung.com/global/register)



# connections

## ⚠ Caution

- When connecting an external device, match the colour of the connection terminal to the cable.
- The product colour and shape may vary depending on the model.
- Each Cable Box/Satellite receiver (Set-Top Box) has a different back panel configuration.
- Whenever you connect an external device to your TV, make sure that power on the unit is turned off.

## CONNECTING A CABLE BOX/SATELLITE RECEIVER (SET-TOP BOX) VIA HDMI

### LA22C450

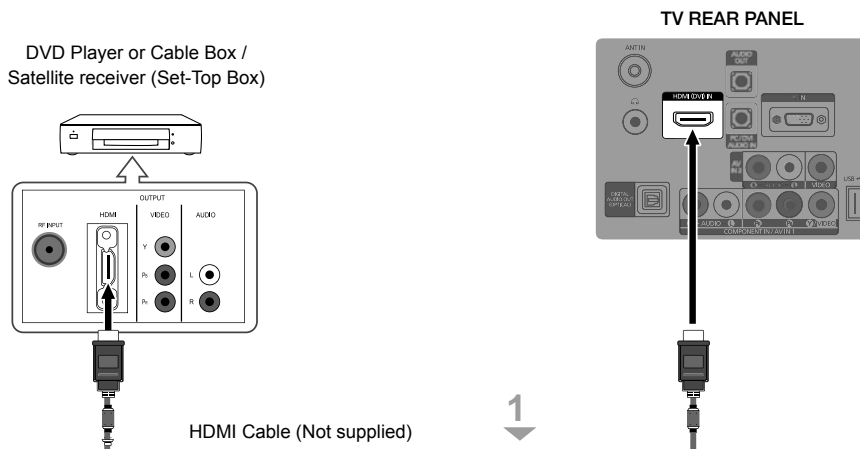

### LA26C450 / LA32C450 / LA32C454

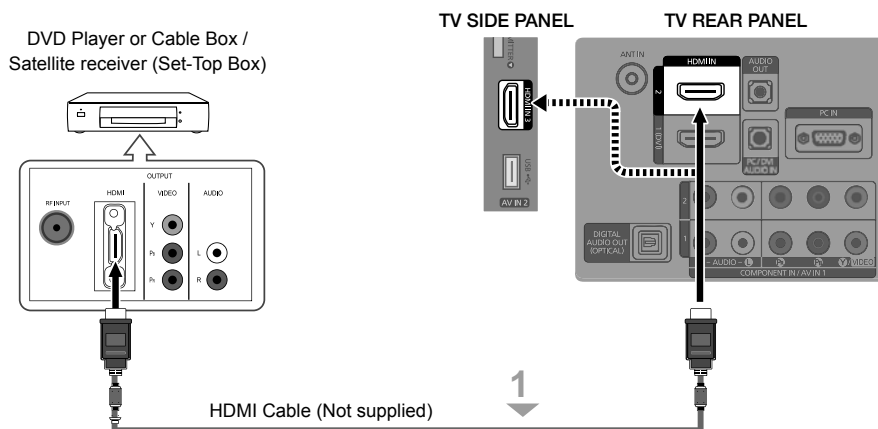

**1.** Connect an HDMI Cable(Not supplied) between the HDMI IN (1or 2(DVI)) jack on the TV and the HDMI jack on the Cable Box/Satellite receiver (Set-Top Box).

- No additional Audio connection is needed for an HDMI to HDMI connection.
- When using an HDMI/DVI cable connection, you must use the HDMI IN 2(DVI) jack.

# CONNECTING A CABLE BOX/SATELLITE RECEIVER (SET-TOP BOX) VIA DVI

LA22C450

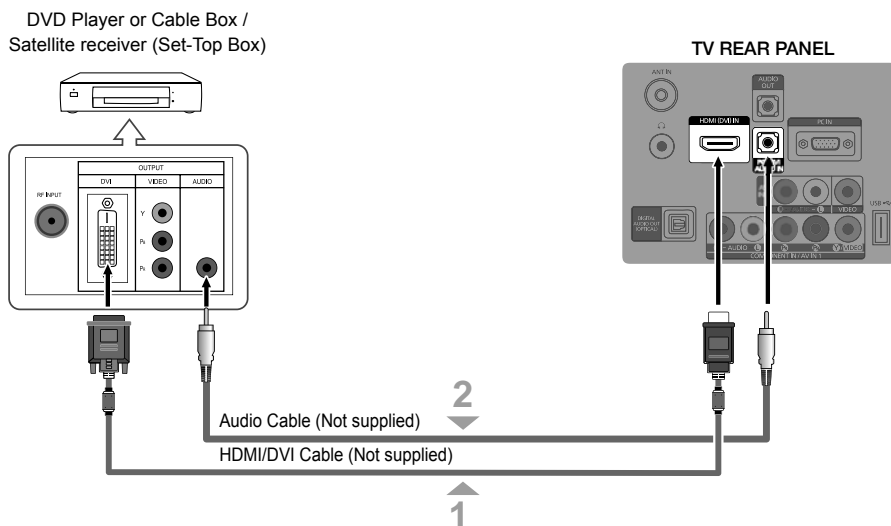

LA26C450 / LA32C450 / LA32C454

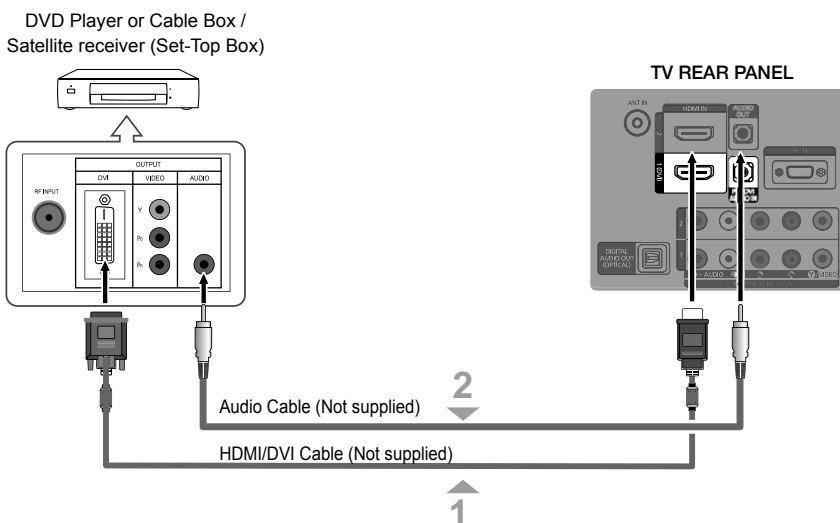

1. Connect an HDMI Cable(Not supplied) between the HDMI IN 2(DVI) jack on the TV and the HDMI jack on the Cable Box/Satellite receiver (Set-Top Box).
  2. Connect Audio Cables(Not supplied) between the DVI AUDIO IN jack on the TV and the Cable Box/Satellite receiver (Set-Top Box).
- When using an HDMI/DVI cable(Not supplied) connection, you must use the HDMI IN 2 jack.

## CONNECTING A CABLE BOX/SATELLITE RECEIVER (SET-TOP BOX) VIA COMPONENT CABLES

LA22C450

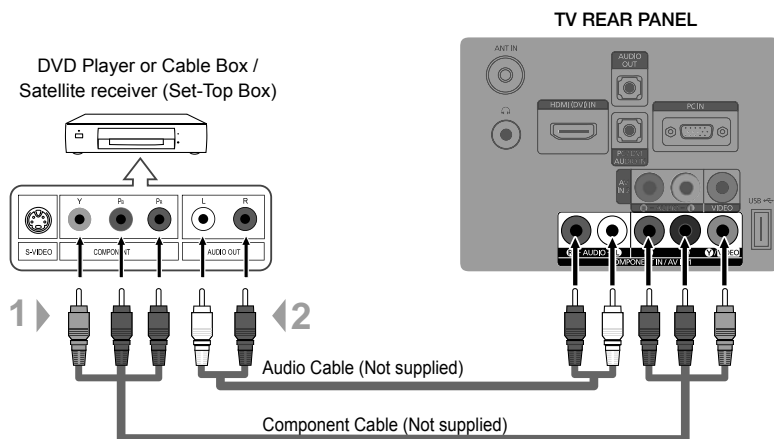

LA26C410 / LA32C410 / LA32C454

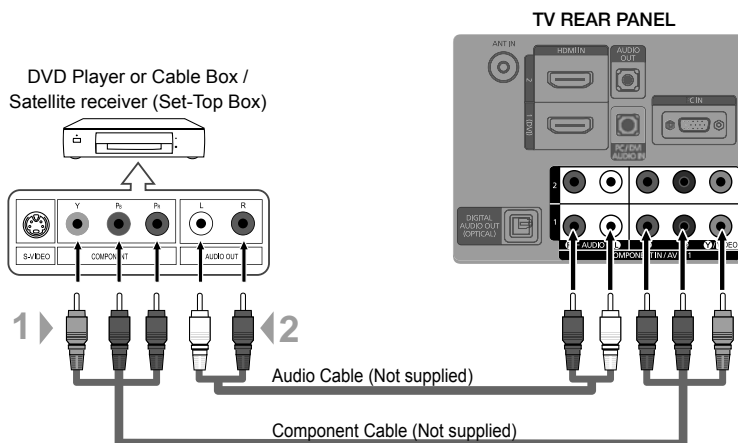

1. Connect a Component Cable (Not supplied) between the COMPONENT IN 1, 2 [Y, Pb, Pr] jacks on the TV and the COMPONENT jacks on the Cable Box/Satellite receiver (Set-Top Box).
2. Connect Audio Cables (Not supplied) between the COMPONENT IN 1, 2 [R-AUDIO-L] jacks on the TV and the AUDIO OUT jacks on the Cable Box/Satellite receiver (Set-Top Box).

# How to Navigate Menus

Before using the TV, follow the steps below to learn how to navigate the menu and select and adjust different functions.

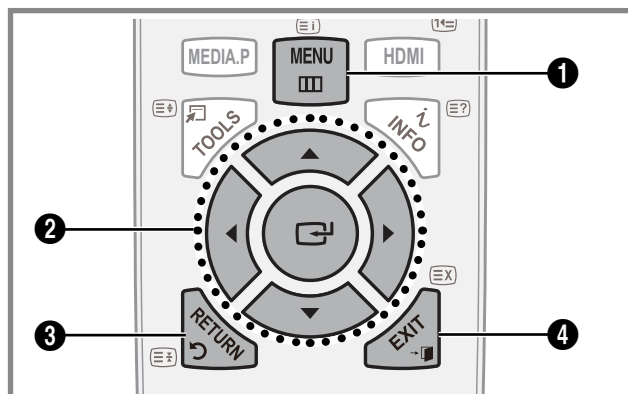

- ❶ MENU button: Displays the main on-screen menu.
- ❷ ENTER / Direction button: Move the cursor and select an item. Confirm the setting.
- ❸ RETURN button: Returns to the previous menu.
- ❹ EXIT button: Exits the on-screen menu.

## HOW TO OPERATE THE OSD (ON SCREEN DISPLAY)

The access step may differ depending on the selected menu.

1	MENU	The main menu options appears on the screen: <b>Picture, Sound, Channel, Setup, Input.</b>	5	◀ / ▶	Adjust the value of an item with the ◀ or ▶ button. The adjustment in the OSD may differ depending on the selected menu.
2	▲ / ▼	Select an icon with the ▲ or ▼ button.	6	ENTER	Press ENTER to complete the configuration.
3	ENTER	Press ENTER to access the sub-menu.	7	EXIT	Press EXIT.
4	▲ / ▼	Select the desired submenu with the ▲ or ▼ button.			



## Contact SAMSUNG WORLDWIDE

If you have any questions or comments relating to Samsung products, please contact the SAMSUNG customer care centre.

Country	Customer Care Centre ☎	Web Site
AUSTRALIA	1300 362 603	<a href="http://www.samsung.com">www.samsung.com</a>
BAHRAIN	8000-4726	-
CHINA	400-810-5858 010-6475 1880	<a href="http://www.samsung.com">www.samsung.com</a>
HONG KONG	(852) 3698-4698	<a href="http://www.samsung.com/hk">www.samsung.com/hk</a> <a href="http://www.samsung.com/hk_en/">www.samsung.com/hk_en/</a>
INDIA	3030 8282 1800 110011 1800 3000 8282 1800 266 8282	<a href="http://www.samsung.com">www.samsung.com</a>
INDONESIA	0800-112-8888 021-5699-7777	<a href="http://www.samsung.com">www.samsung.com</a>
JAPAN	0120-327-527	<a href="http://www.samsung.com">www.samsung.com</a>
JORDAN	800-22273	-
MALAYSIA	1800-88-9999	<a href="http://www.samsung.com">www.samsung.com</a>
NEW ZEALAND	0800 SAMSUNG (0800 726 786)	<a href="http://www.samsung.com">www.samsung.com</a>
PHILIPPINES	1-800-10-SAMSUNG(726-7864) 1-800-3-SAMSUNG(726-7864) 1-800-8-SAMSUNG(726-7864) 02-5805777	<a href="http://www.samsung.com">www.samsung.com</a>
SINGAPORE	1800-SAMSUNG(726-7864)	<a href="http://www.samsung.com">www.samsung.com</a>
SOUTH AFRICA	0860-SAMSUNG(726-7864 )	<a href="http://www.samsung.com">www.samsung.com</a>
TAIWAN	0800-329-999	<a href="http://www.samsung.com">www.samsung.com</a>
THAILAND	1800-29-3232 02-689-3232	<a href="http://www.samsung.com">www.samsung.com</a>
U.A.E	800-SAMSUNG (726-7864)	<a href="http://www.samsung.com">www.samsung.com</a>
VIETNAM	1 800 588 889	<a href="http://www.samsung.com">www.samsung.com</a>